

Register Now 
www.delonghi.com/register

XLM21

SCOPA RICARICABILE
MULTIFUNZIONE
Istruzioni per l'uso



DeLonghi

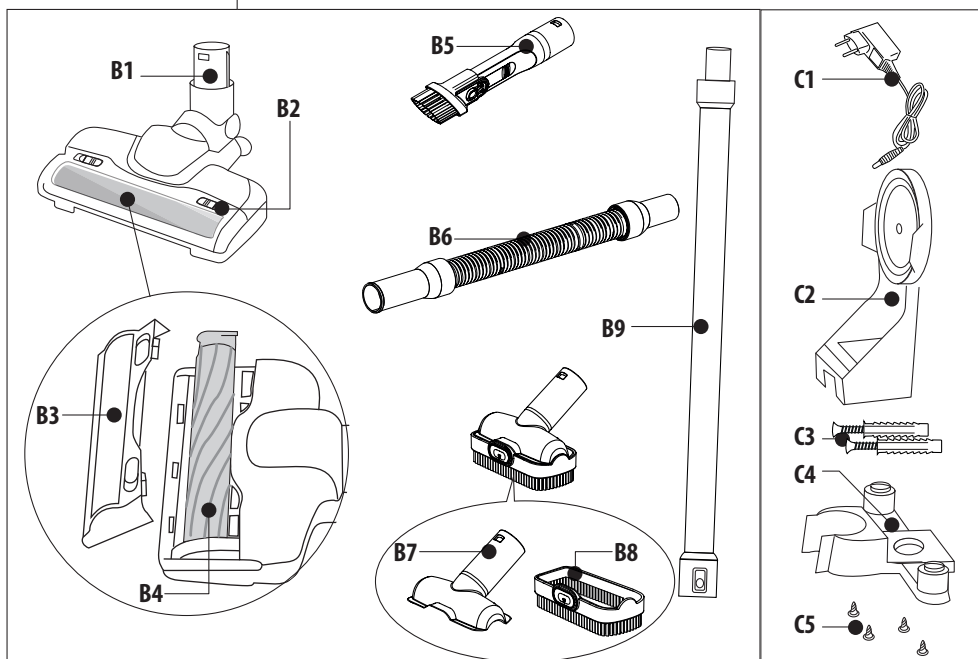
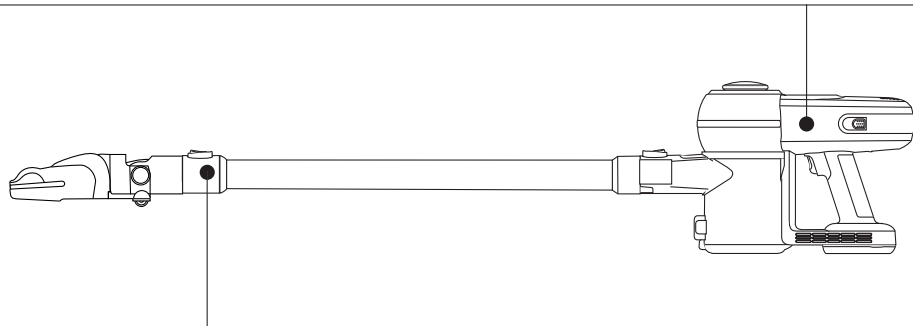
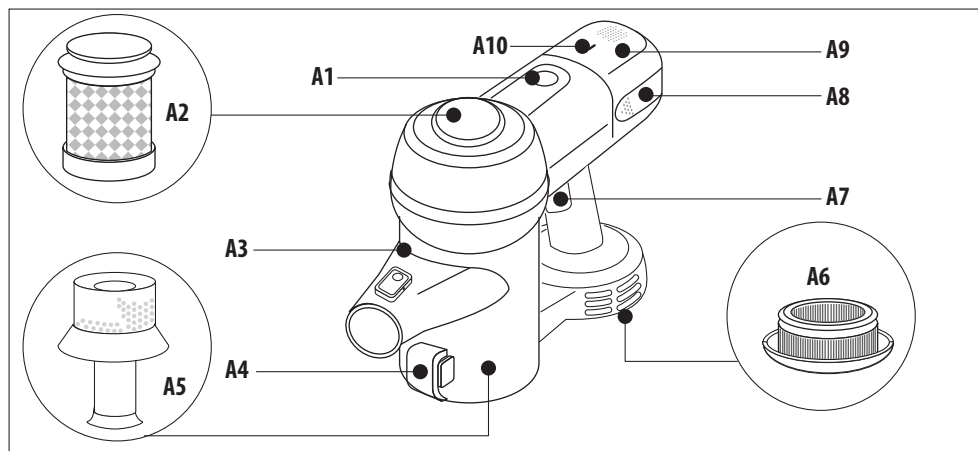

1.1 Descrizione dell'apparecchio

- A1. Tasto selezione/deselezione potenza MAX
- A2. Filtro
- A3. Tanica raccogliipolvere da 0,5l
- A4. Dispositivo apertura coperchio per svuotamento
- A5. Filtro
- A6. Filtro EPA
- A7. Tasto ON/OFF
- A8. Pulsante di sgancio batteria ricaricabile
- A9. Batteria ricaricabile
- A10. Led indicatore di carica e funzionamento:
 - Spento: apparecchio spento
 - Acceso luce verde: apparecchio acceso e batteria carica
 - Lampeggiante luce verde: apparecchio acceso e batteria ormai scarica
 - Acceso luce arancione: caricabatterie collegato e apparecchio in carica
 - Acceso luce verde: caricabatterie collegato e carica completa

1.2 Descrizione degli accessori

- B1. Spazzola motorizzata per pavimenti duri e tappeti a pelo corto
- B2. Pulsante di sgancio
- B3. Visore rullo con setole
- B4. Rullo con setole
- B5. Accessorio 2 in 1: bocchetta a lancia e spazzola per mobili
- B6. Tubo flessibile (*solo alcuni modelli)
- B7. Mini spazzola (*solo alcuni modelli)
- B8. Inserto setole per mini spazzola (*solo alcuni modelli)
- B9. Tubo aspirazione

1.3 Descrizione supporto a muro

- C1. Caricabatterie
- C2. Supporto a muro
- C3. Tasselli per supporto a muro
- C4. Base supporto portaccessori
- C5. Viti per fissare base al supporto

Prima di utilizzare l'apparecchio leggere sempre il fascicolo delle avvertenze di sicurezza.

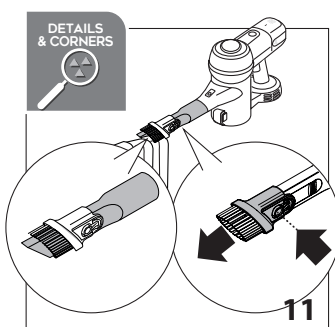
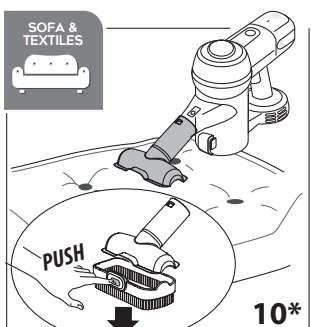
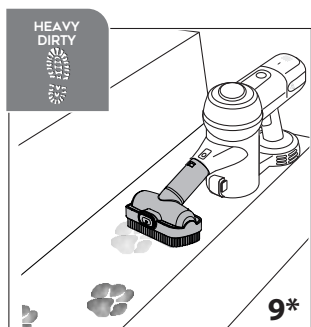
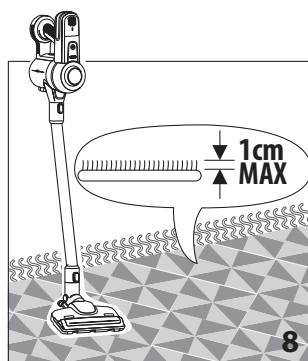
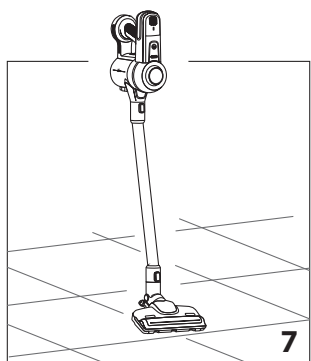
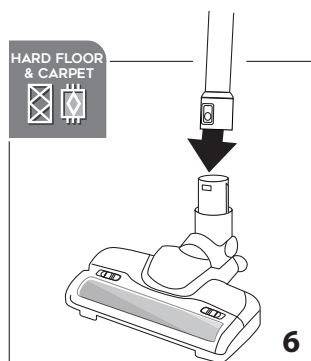
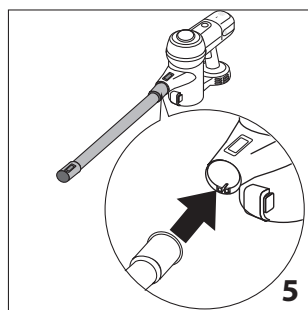
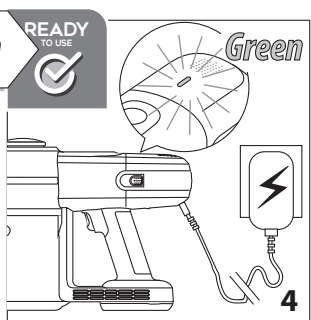
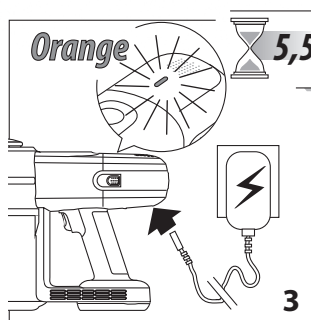
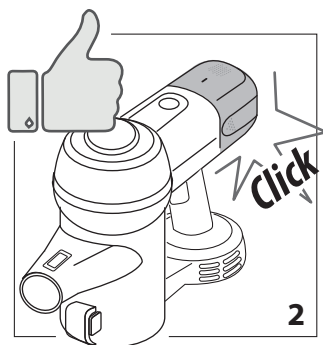
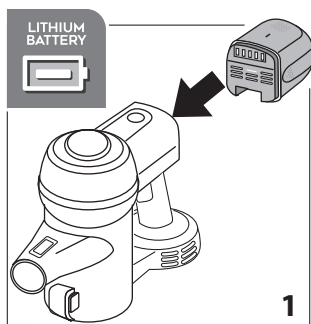
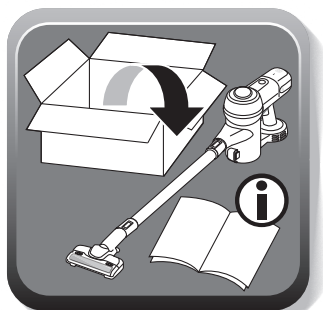

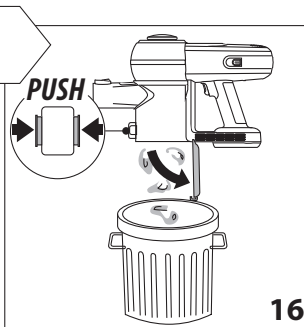
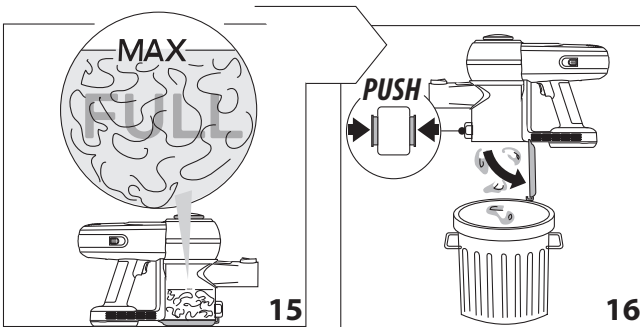
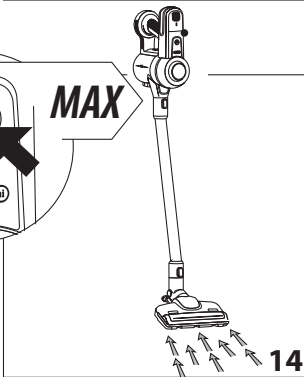
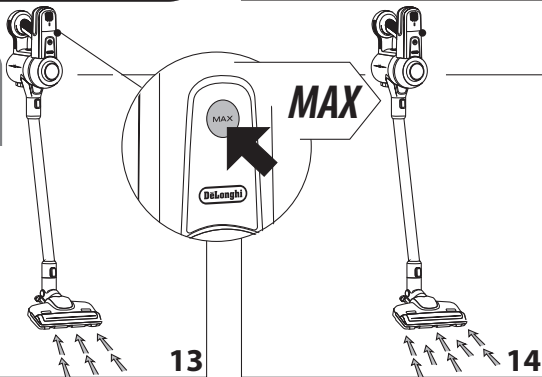
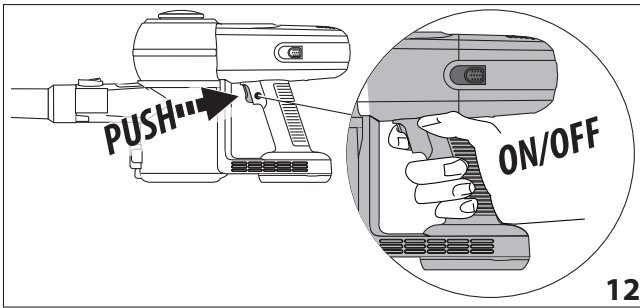
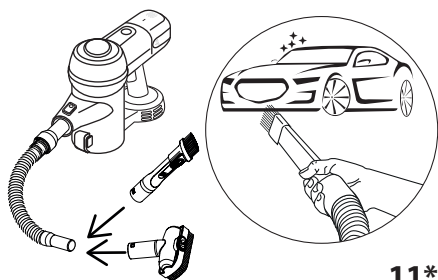
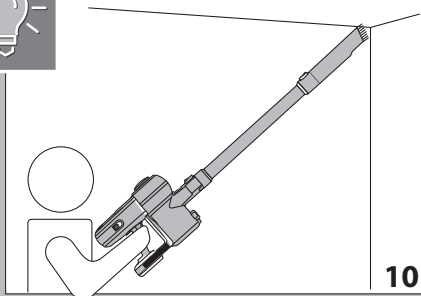

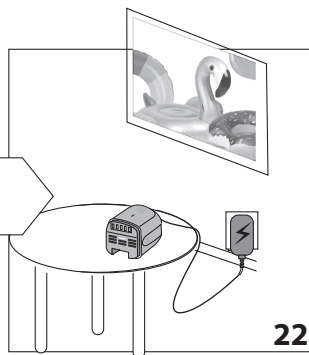
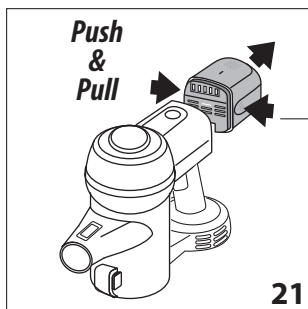
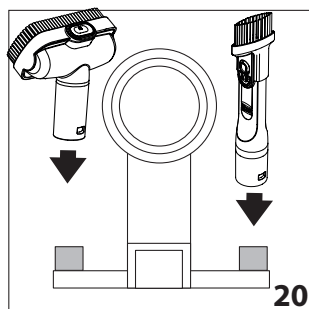
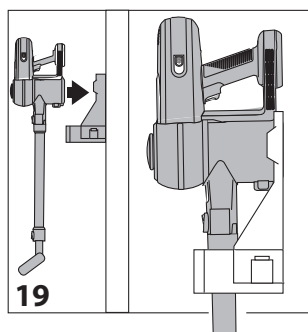
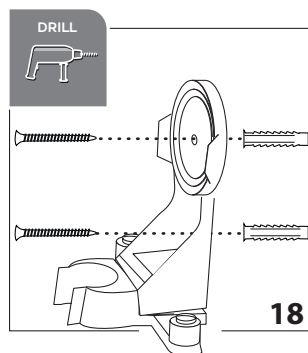
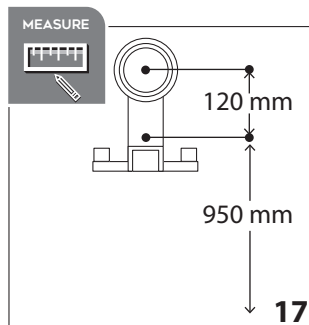
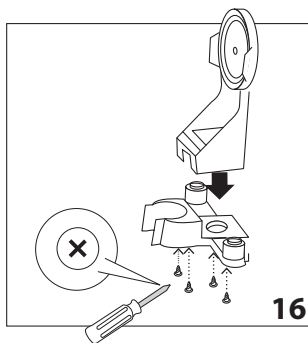
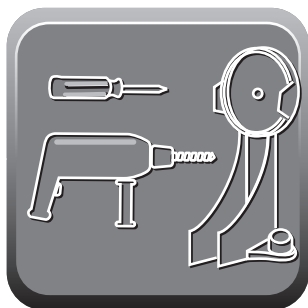

CLEANING

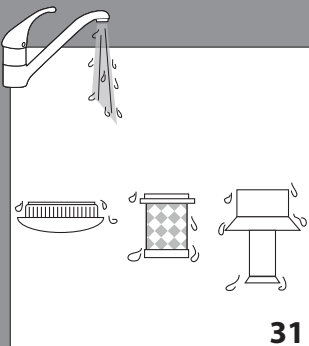
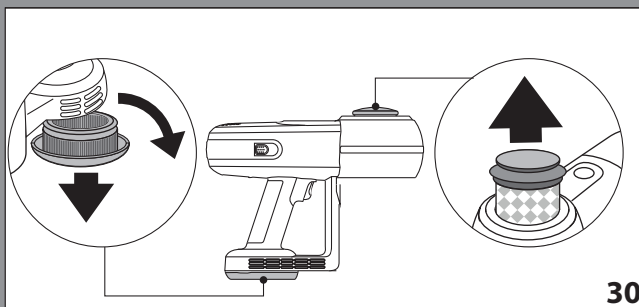
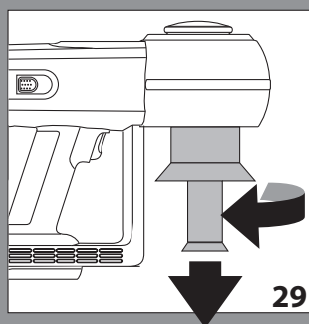
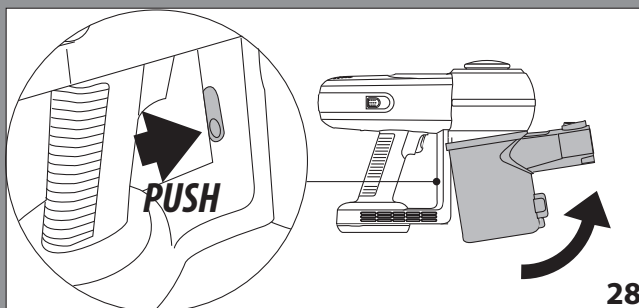
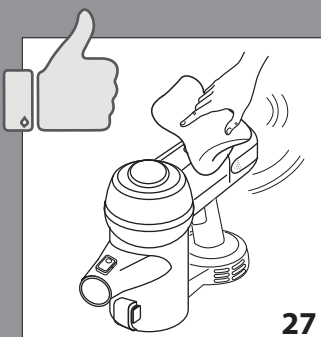
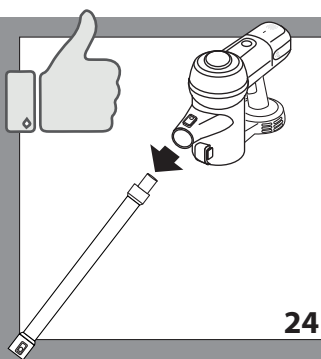
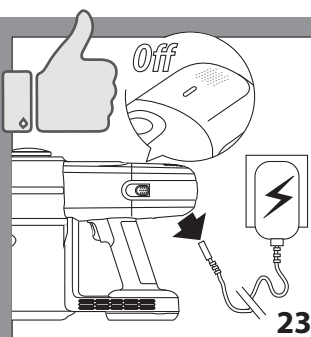

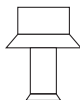

32

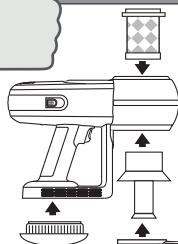

33

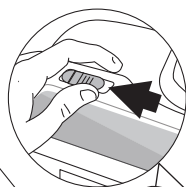
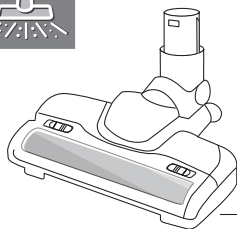

34



unlock & remove

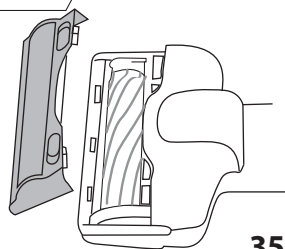

35

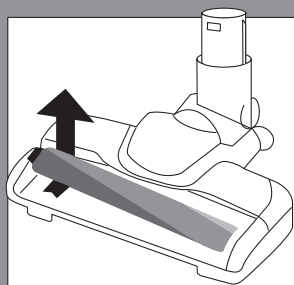

36

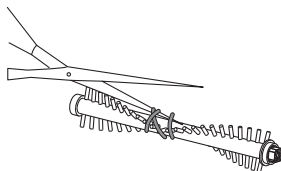

37

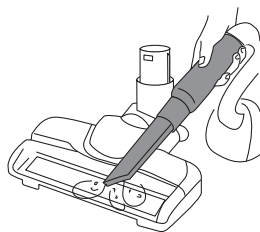

38

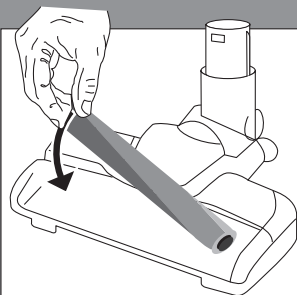

39

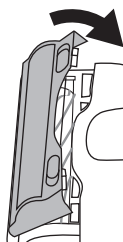

40



Click

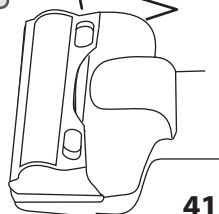

41