



Questo manuale d'istruzione è fornito da trovaprezzi.it. Scopri tutte le offerte per **IP-COM G3326P-24-410W** o cerca il tuo prodotto tra le **migliori offerte di Switch**



Questo manuale d'istruzione è fornito da trovaprezzi.it. Scopri tutte le offerte per **IP-COM G3326P-24-410W** o cerca il tuo prodotto tra le **migliori offerte di Switch**

IP-COM

Quick Installation Guide

8GE+2SFP Cloud Managed PoE Switch
16GE+2SFP Cloud Managed PoE Switch
24GE+2SFP Cloud Managed PoE Switch

G3310P-8-150W / G3318P-16-250W / G3326P-24-410W

Package contents

- Switch x 1
- Power cord x 1
- Screw (KM3*8 mm) x 8
- Footpad x 4
- L-shaped bracket x 2
- Quick installation guide x 1

This guide instructs how to install, connect and log in to the device. G3326P-24-410W is used as an example for illustration in this guide unless otherwise specified. For details, please download the user guide of the device.

1 Install the device

Preparations

You shall prepare the following tools and materials for device installation.

- Rack mounting: ESD bracelet (or ESD gloves), screwdriver, 4 screws (to secure the switch to the rack)
- Wall mounting: ESD bracelet (or ESD gloves), marker, hammer drill, rubber hammer, screwdriver, spirit level, ladder, 4 expansion bolts (M5*40 mm), 4 screws (PA5*25 mm, head diameter: 10 mm)
- Desktop mounting: ESD bracelet (or ESD gloves)

Installation

Rack mounting (to a standard 19-inch rack)

- Step 1 Ensure that the rack is stable and level, and is properly grounded.
- Step 2 Fix the two L-shaped brackets to both sides of the switch using the included screws.
- Step 3 Choose a proper height and fix the L-shaped brackets to the rack using screws (self-prepared). Ensure that the switch is seated securely on the rack.

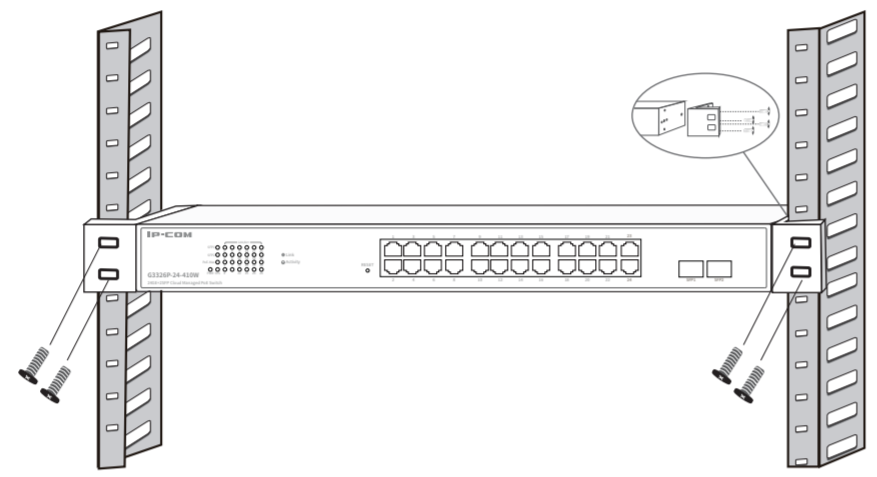

Wall mounting

- Note:**
- This switch can only be installed on a concrete or non-flammable wall.
 - Do NOT install the switch with its air vents facing downward; otherwise, there will be potential safety hazards.

- Step 1 Rotate the two L-shaped brackets by 90 degrees and fix them to both sides of the switch with the included screws.
- Step 2 Horizontally place the switch onto the wall with its RJ45 ports facing upward. Then mark the screw holes with the marker.
- Step 3 Drill holes in the marked positions, and then knock the expansion bolts (self-prepared, M5*40 mm) into the holes.
- Step 4 Insert the screws (self-prepared, PA5*25 mm, head diameter: 10 mm) through the holes of the two L-shaped brackets, and secure expansion bolts with a screwdriver. Ensure that the switch is installed firmly with its RJ45 ports facing upward.

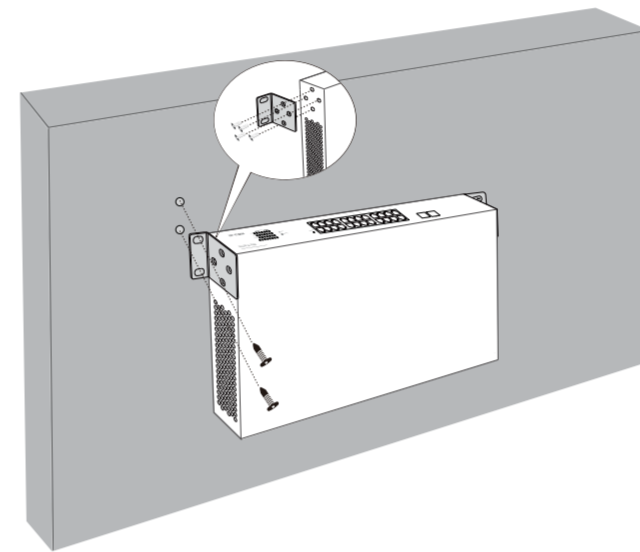

Desktop mounting

Paste the four footpads to the four recesses on the bottom of the switch. Then turn the switch upside down, and place it on a big enough, clean, stable and flat desktop.

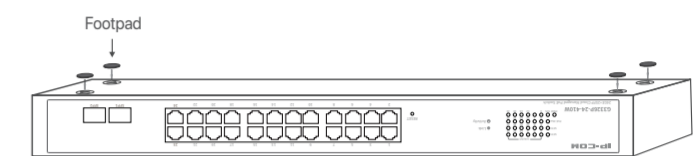

2 Connect the device

The typical network topology of the switch series is as shown below.

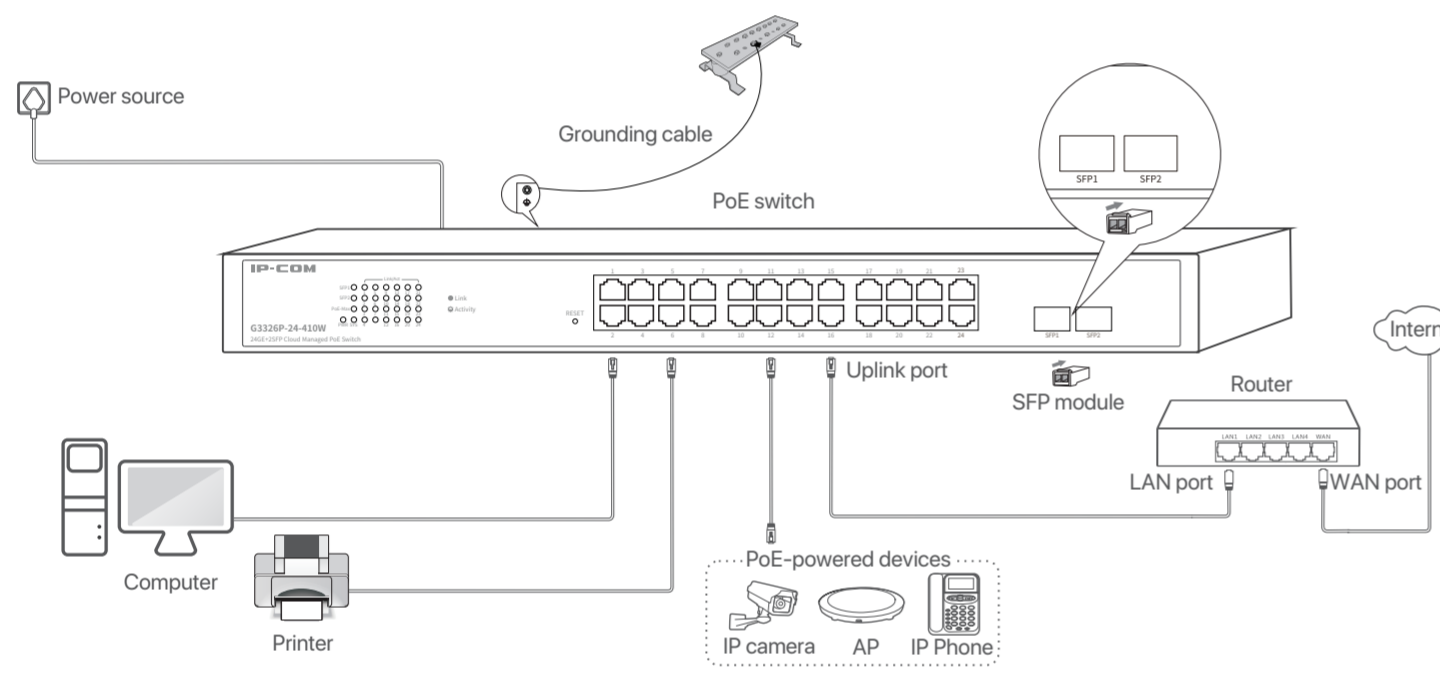

- Note:**
- The switch supports auto MDI/MDIX. You can use either a straight through cable or a crossover cable to connect the switch to Ethernet devices.
 - SFP ports of G3318P-16-250W and G3310P-8-150W are independent ports. For G3326P-24-410W, ports 23 and SFP1 compose a combo port, ports 24 and SFP2 compose a combo port, and SFP ports own higher priority.
 - When the total power consumption of all PoE-powered devices exceeds the maximum output of the switch, the switch cuts the power supply from the port with the largest port number until the total power consumption is less than the maximum output of the switch.

After connection, you can check whether the switch is connected properly according to the following table.

LED indicator	Status	Description
SFP1, SFP2 Link/Act	Solid on	Connected but not active
	Blinking	Active in data transmission
	Off	Not connected or connected improperly
PoE-Max	Solid on	Reach max. PoE budget
	Off	Not reach max. PoE budget
PWR	Solid on	Powered on
	Off	Powered off or powered improperly
SYS	Solid on	System works improperly
	Blinking	System works properly
	Off	System is starting up or works improperly

3 Log in to the device

- Step 1 Use an Ethernet cable to connect the computer to one of the port 1 - 24 of the switch (port 1 - 16 for G3318P-16-250W, port 1 - 8 for G3310P-8-150W).

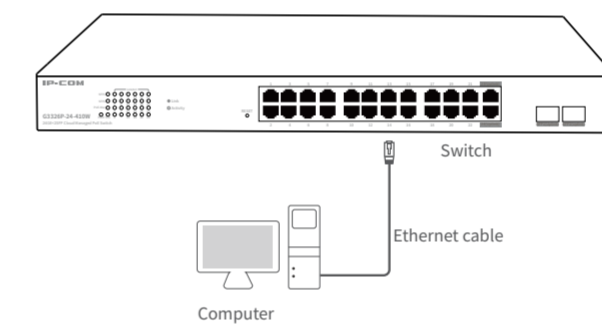

- Step 2 Set the IP address of Ethernet (or Local Area Connection) of the computer to the same network segment of the switch's IP address. The default IP address of the switch is **10.16.16.168**. You can set the IP address of the computer to **10.16.16.X** (X ranges from 2 to 254 excluding 168, and is not occupied) and the subnet mask to **255.255.255.0**.

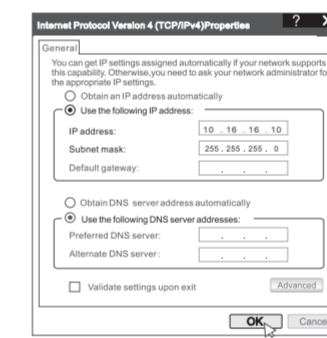

- Step 3 Start a web browser (such as Chrome) on the computer, enter the management IP address of the switch (default: **10.16.16.168**) in the address bar, and press **Enter** on the keyboard.

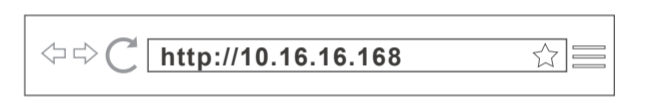

- Step 4 Enter the login user name and password (both are **admin** by default) on the login page of the switch, and click **Login**.



- Tips:**
- If you fail to access the above page, please refer to question 1 in **FAQ**.
 - For network security, please change the user name and password after login.

After successfully logging in to the web UI of the switch, you can configure the switch now.

4 IP-COM IMS cloud management

This series of switches support IMS cloud management. You can remotely manage switch on IP-COM IMS Cloud or IP-COM IMS app.

Management on IP-COM IMS Cloud

- Tips:**
- Before configuring the IMS Cloud Management function, please ensure that the switch has connected to the internet.

Step 1 Log in to IP-COM IMS Cloud and obtain Unique Cloud Code.

- 1) On a computer that has connected to the internet, start a web browser, visit <https://imsen.ip-com.com.cn>, and log in to IP-COM IMS Cloud.
- 2) Click the personal avatar at the upper right corner and select **Device-Joining Alert**.
- 3) Locate this switch and add it to your project.
- 4) Done. You can manage and maintain the switch on IMS Cloud.



- Step 2 Enable the IMS Cloud Management function of the switch.
- 1) Refer to chapter 3 Log in to the device to log in to the web UI of the switch.
- 2) Click **Device Management** > **IMS Cloud Management**.
- 3) Enable the **IMS Cloud Management** function, paste the copied Unique Cloud Code in the input box, enable the **Report** function, and click **Apply**.

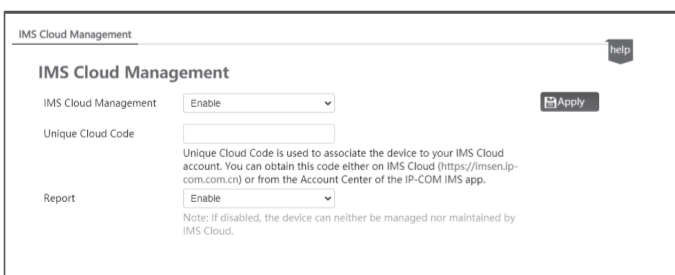

Management on IP-COM IMS app (app v1.3.1 is used for illustration below)

- Step 1 Scan the following QR code or search for the IP-COM IMS app in App Store or the app market to download and install the IP-COM IMS app on your mobile phone.



- Step 2 Log in to the IP-COM IMS app. On the **Network** page, add a **Traditional WLAN** project.
- Scan Code (recommended): Scan the **Scan to Add Device QR code** on the Ethernet port surface of the switch to automatically recognize project type and create project.
- Manually Create: Manually choose project type and create project.
- Scan Code** method is used for illustration below.

1) Create project.

- 1) Click **Add Project**

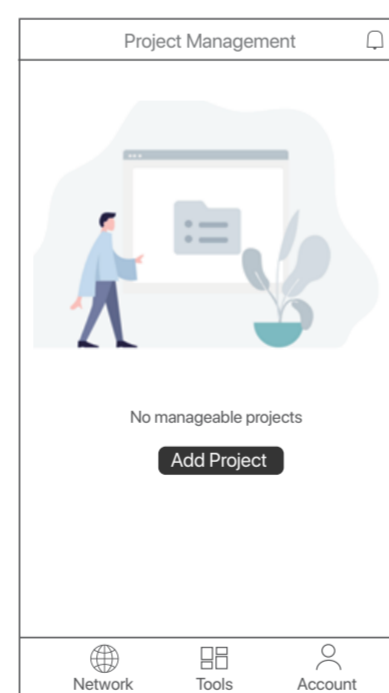

- 2) Click **Scan Code**

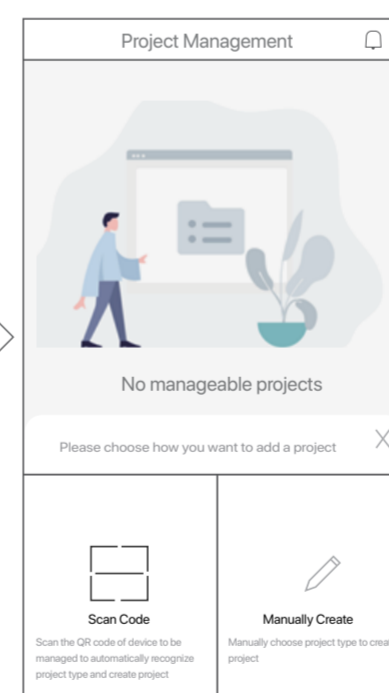

- 3) Scan the QR code on the Ethernet port surface

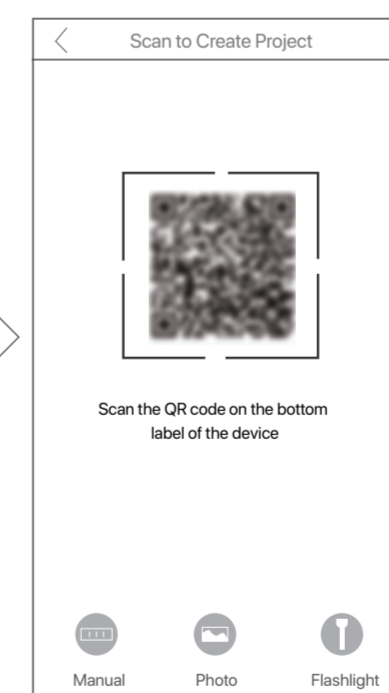

- 4) Project type is automatically recognized

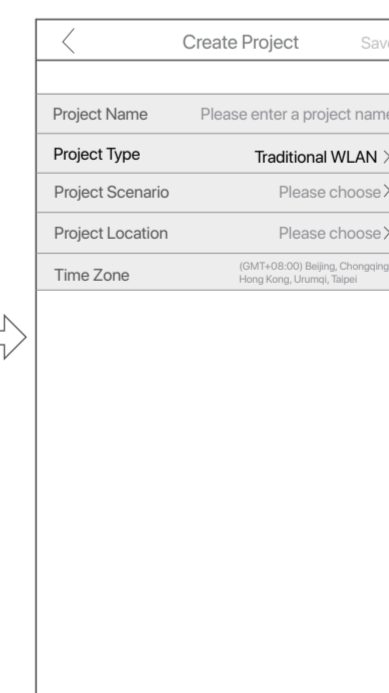

- 5) Set other project parameters and click **Save**

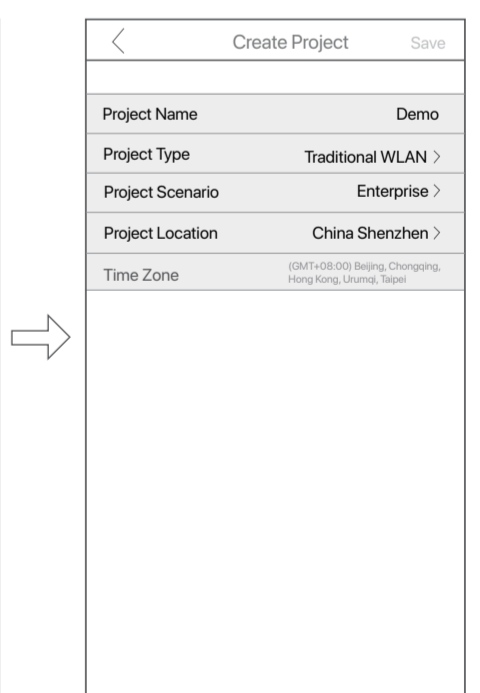

2) Add device.

- 1) Enter the project, click **Add Device** in the lower left corner

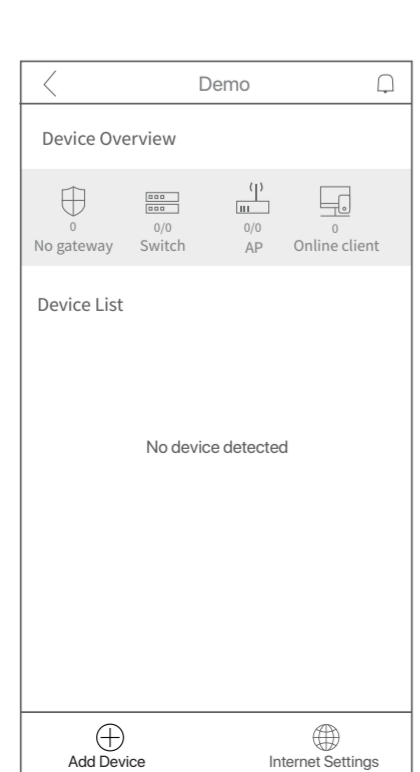

- 2) The following prompt appears

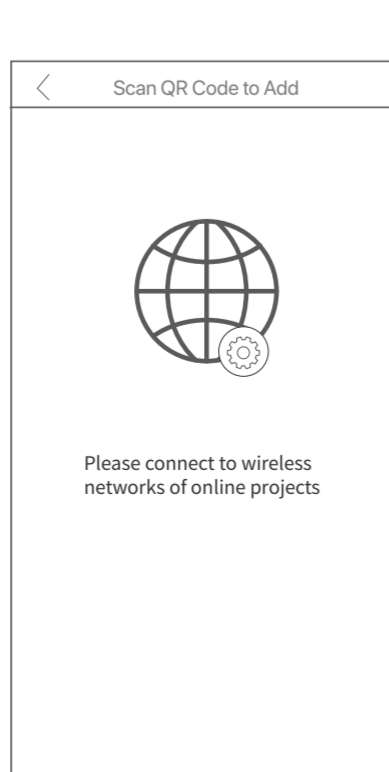

- 3) On the **Settings** page, connect to the WiFi network of the LAN where this switch is deployed (this WiFi network should have internet access)

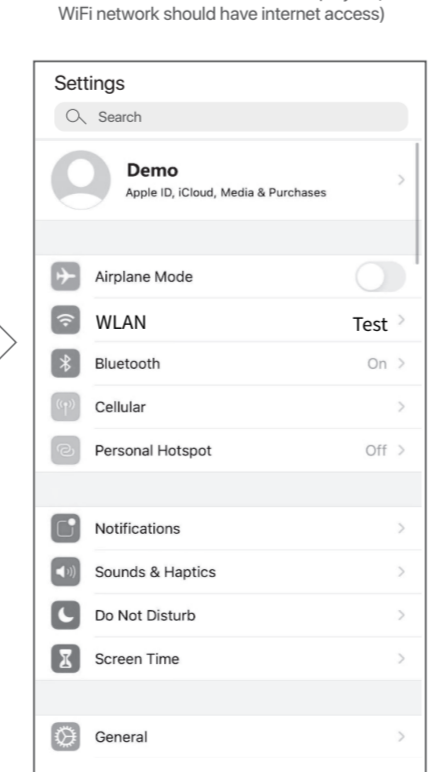

- 4) Go back to the app. Wait until the switch to be added is automatically detected, tick the switch, and tick **Agree to enable Cloud Management**, and activate report function of the device to add the switch.

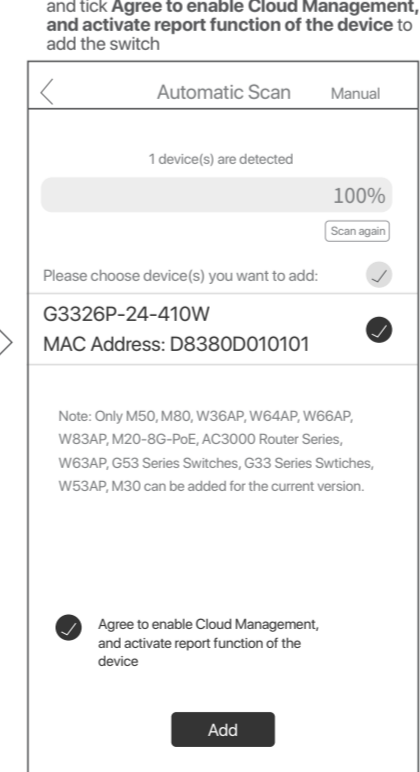

- 5) The switch is added successfully

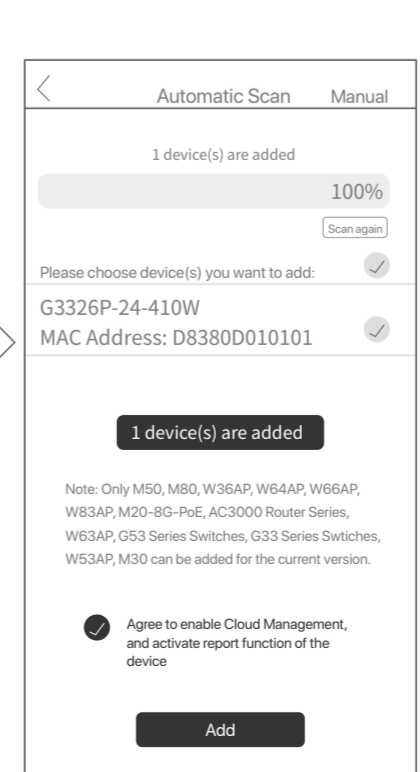

- 6) Done. You can manage and maintain the switch on IP-COM IMS app.

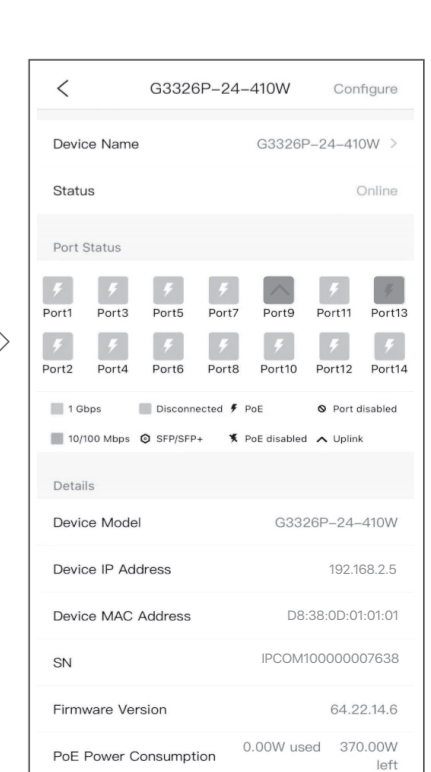

Model	G3310P-8-150W	G3318P-16-250W	G3326P-24-410W	
Port	10/100/1000 Mbps RJ45 port	8	16	24
	1000 Mbps SFP port	2		
Performance	Switching mode	Store-and-forward		
	MAC address table learning	Auto learning, auto aging		
	MAC address table	8 K		
	PoE standard	IEEE 802.3af, IEEE 802.3at		
	PoE power cable core	8 cores: voltage of cores 1, 2, 4, 5 is +, and cores 3, 6, 7, 8 is -		
PoE power supply	PoE port	1- 8	1- 16	1- 24
	Maximum output power of a single port	30 W		
	Maximum output power of the switch	130 W	230 W	370 W
Dimensions (L x W x H)	294mm x 179.6 mm x 44mm	440 mm x 178.8 mm x 44 mm	440 mm x 284 mm x 44 mm	
Input voltage	100- 240V AC, 50/60Hz, 2A	100- 240V AC, 50/60Hz, 4A	100- 240V AC, 50/60Hz, 6A	
Lightning protection	RJ45 port	Common mode: 6 kV		
	Power supply	Common mode: 6 kV Differential mode: 4 kV		
Operating environment	Temperature: 0°C - 45°C Humidity: (10% - 90%) RH, non-condensing			
Storage environment	Temperature: -40°C - 70°C Humidity: (5% - 90%) RH, non-condensing			
Data transmission rate	Ethernet: 10 Mbps (half duplex)/20 Mbps (full duplex) Fast Ethernet: 100 Mbps (half duplex)/200 Mbps (full duplex) Gigabit Ethernet: 2000 Mbps (full duplex)			
Transmission media	Ethernet: CAT3 or better UTP/STP cable Fast Ethernet: CAT5 or better UTP/STP cable Gigabit Ethernet: CAT5e or CAT6 UTP/STP cable 1000Base-SX, MMF 1000Base-LX, MMF or SMF			
Network standards	IEEE 802.3, IEEE 802.3u, IEEE 802.3x, IEEE 802.3ab, IEEE 802.3af, IEEE 802.3at, IEEE 802.3z			

Specifiche

Modello	G3310P-8-150W	G3318P-16-250W	G3326P-24-410W	
Porte	Porta RJ45 10/100/1000 Mbps	8	16	24
	Porta SFP 1000 Mbps	2		
Prestazioni	Modalità switching	Store-and-forward		
	Apprendimento degli indirizzi MAC	Auto invecchiamento, auto apprendimento		
	Tabella degli indirizzi MAC	8 K		
	Standard PoE	IEEE 802.3af, IEEE 802.3at		
	Nucleo del cavo di alimentazione PoE	8 nuclei: la tensione dei nuclei 1, 2, 4, 5 è +, quella dei nuclei 3, 6, 7, 8 è -		
Alimentazione PoE	Porta PoE	1- 8	1- 16	1- 24
	Reaa massima di una singola porta	30 W		
	Reaa massima dell'interruttore	130 W	230 W	370 W
Dimensioni (L x P x A)	294 mm x 179,6 mm x 44 mm	440 mm x 178,8 mm x 44 mm	440 mm x 284 mm x 44 mm	
Tensione di ingresso	100 - 240 V CA, 50/60Hz, 2A	100 - 240 V CA, 50/60Hz, 4A	100 - 240 V CA, 50/60Hz, 6A	
Protezione contro i fulmini	Port RJ45	Modalità comune: 6 kV		
	Alimentazione	Modalità comune: 6 kV Modalità differenziale: 4 kV		
Ambiente operativo	Temperatura: 0°C - 45°C Umidità: (10% - 90%) UR, senza condensa			
Ambiente di immagazzinaggio	Temperatura: -40°C - 70°C Umidità: (5% - 90%) UR, senza condensa			
Velocità di trasmissione dati	Ethernet: 10 Mbps (half duplex) / 20 Mbps (full duplex) Fast Ethernet: 100 Mbps (half duplex) / 200 Mbps (full duplex) Gigabit Ethernet: 2000 Mbps (full duplex)			
Mezzi di trasmissione	Ethernet: Cavo UTP/STP CAT3 o superiore Fast Ethernet: Cavo UTP/STP CAT5 o superiore Gigabit Ethernet: Cavo UTP/STP CAT5e o CAT6 1000Base-SX, MMF 1000Base-LX, MMF o SMF			
Standard di rete	IEEE 802.3, IEEE 802.3u, IEEE 802.3x, IEEE 802.3ab, IEEE 802.3af, IEEE 802.3at, IEEE 802.3z			

Dane techniczne

Model	G3310P-8-150W	G3318P-16-250W	G3326P-24-410W	
Port	Port RJ45 10/100/1000 Mb/s	8	16	24
	Port SFP 1000 Mb/s	2		
Wydajność	Tryb przelazczania	Zapis-i-wprzód		
	Nauka adresów MAC	Nauka samodzielna, automatyczne starzenie		
	Tabela adresów MAC	8 K		
	Standard PoE	IEEE 802.3af, IEEE 802.3at		
	Rdzian kabla zasilajacego PoE	8 rdzeni: napiecie rdzeni 1, 2, 4, 5 wynosi +, a rdzeni 3, 6, 7, 8 wynosi -		
System zasilania PoE	Port PoE	1- 8	1- 16	1- 24
	Maksymalna moc wyjciowa pojedynczego portu	30 W		
	Maksymalna moc wyjciowa przelazcznika	130 W	230 W	370 W
Wymiary (dl. x szer. x wys.)	294 mm x 179,6 mm x 44 mm	440 mm x 178,8 mm x 44 mm	440 mm x 284 mm x 44 mm	
Napiecie wyjsciowe	100 - 240V AC, 50/60Hz, 2A	100 - 240V AC, 50/60Hz, 4A	100 - 240V AC, 50/60Hz, 6A	
Ochrona odgromowa	Port RJ45	Tryb wspolny: 6 kV		
	Zasilanie	Tryb wspolny: 6 kV Tryb roznicowy: 4 kV		
Środowisko pracy	Temperatura: 0°C - 45°C Wilgotność: (10–90%) wilgotności względnej, bez kondensacji			
Środowisko przechowywania	Temperatura: -40°C - 70°C Wilgotność: (5–90%) wilgotności względnej, bez kondensacji			
Szybkość transmisji danych	Sieć Ethernet: 10 Mb/s (półduplex) / 20 Mb/s (pełny duplex) Szybka sieć Ethernet: 100 Mb/s (półduplex) / 200 Mb/s (pełny duplex) Gigabitowa sieć Ethernet: 2000 Mb/s (pełny duplex)			
Środki transmisji	Sieć Ethernet: Kabel CAT3 UTP/STP lub lepszy Szybka sieć Ethernet: Kabel CAT5 UTP/STP lub lepszy Gigabitowa sieć Ethernet: Kabel CAT5e lub CAT6 UTP/STP 1000Base-SX, MMF 1000Base-LX, MMF lub SMF			
Standardy sieciowe	IEEE 802.3, IEEE 802.3u, IEEE 802.3x, IEEE 802.3ab, IEEE 802.3af, IEEE 802.3at, IEEE 802.3z			

الطرز	G3326P-24-410W	G3318P-16-250W	G3310P-8-150W
المشغل	24	16	8
			2
الأداء	تعزير وإعادة توجيه	تعلم جدول عناوين MAC الشبكية الشبكية التلقائية ، التعلم التلقائي	
		8 K	جداول عناوين MAC
		IEEE 802.3af ، IEEE 802.3at	معايير PoE (التعاقة عبر الإنترنت)
	إمداد الطاقة PoE	لواكيمثل لكل الطاقة PoE	لواكيمثل لكل الطاقة PoE
	من 1 إلى 24	من 1 إلى 16	من 1 إلى 8
	من 30 وات	من 130 وات	من 370 وات
الأبعاد (الطول × العرض × الارتفاع)	294 مم × 179,6 مم × 44 مم	440 مم × 178,8 مم × 44 مم	440 مم × 284 مم × 44 مم
جهد الإدخال	100 - 240 V التيار المتردد، 50/60 هرتز، 2 أمبير	100 - 240 V التيار المتردد، 50/60 هرتز، 4 أمبير	100 - 240 V التيار المتردد، 50/60 هرتز، 6 أمبير
جهد الإخراج	30 واط	130 واط	370 واط
الوسائط البصرية	RJ45	إمداد الطاقة	
	المواضع	إمداد الطاقة	
بيئة التشغيل	درجة الحرارة: 0 درجة مئوية - 45 درجة مئوية الرطوبة: رطوبة نسبية (10% - 90%) بدون تكثف		
بيئة التخزين	درجة الحرارة: -40 درجة مئوية - 70 درجة مئوية الرطوبة: رطوبة نسبية (5% - 90%) بدون تكثف		
معدل نقل البيانات	يأتمثل: 10 ميجابت في الثانية (إرسال نصف مزدوج) / 20 ميجابت في الثانية (إرسال كامل الألياف) شبكة الألياف البصرية: 100 ميجابت في الثانية (إرسال نصف مزدوج) / 200 ميجابت في الثانية (إرسال كامل الألياف) Ethernet: 2000 ميجابت في الثانية (إرسال كامل الألياف)		
وسائط الإرسال	يأتمثل: CAT3 UTP/STP أو أفضل شبكة الألياف البصرية: CAT5 UTP/STP أو أفضل شبكة جيجابت إيثرنت: CAT5e أو CAT6 UTP/STP 1000Base-SX, MMF 1000Base-LX, MMF أو SMF		
معايير الشبكة	IEEE 802.3, IEEE 802.3u, IEEE 802.3at, IEEE 802.3ab, IEEE 802.3af, IEEE 802.3z		

Model	G3310P-8-150W	G3318P-16-250W	G3326P-24-410W	
Port	Port RJ45 10/100/1000 Mbit/c	8	16	24
	Port SFP 1000 Mbit/c	2		
выполнение	Режим переключения	Сохранение и дальнейшая передача		
	Изучение MAC-адресов	Автоматическое старение, автоматическое обучение		
	Таблица MAC-адресов	8 К		
	Стандарт PoE	IEEE 802.3af, IEEE 802.3at		
	Жила силового кабеля PoE	8 ядёр: напряжение ядёр 1, 2, 4, 5 — "+", а для ядёр 3, 6, 7, 8 — "-"		
Электрические Pe	PoE порт	1- 8	1- 16	1- 24
	Максимальная выходная мощность одного порта	30 Вт		
	Максимальная выходная мощность коммутатора	130 Вт	230 Вт	370 Вт
Размеры (Дl x Ш x B)	294 мм x 179,6 мм x 44 мм	440 мм x 178,8 мм x 44 мм	440 мм x 284 мм x 44 мм	
Входное напряжение	100- 240 В перем. тока, 50/60 Гц, 2А	100- 240 В перем. тока, 50/60 Гц, 4А	100- 240 В перем. тока, 50/60 Гц, 6А	
Молниезащита	Port RJ45	Обычный режим: 6 kV		
	Источник питания	Обычный режим: 6 kV Дифференциальный режим: 4 kV		
Рабочая среда	Температура: 0°C - 45°C Влажность: (10-90%) без конденсации			
Условия хранения	Температура: -40°C - 70°C Влажность: (5-90%) без конденсации			
Скорость передачи информации	Ethernet: 10 Мбит/с (полудуплексный)/20 Мбит/с (полнодуплексный) Fast Ethernet: 100 Мбит/с (полудуплексный)/200 Мбит/с (полнодуплексный) Гигабитный Ethernet: 2000 Мбит/с (полнодуплексный)			
Средства передачи	Ethernet: Кабель CAT3 UTP/STP или выше Fast Ethernet: Кабель CAT5 UTP/STP или выше Гигабитный Ethernet: Кабель CAT5e или CAT6 UTP/STP 1000Base-SX, MMF 1000Base-LX, MMF или SMF			
Стандарты сети	IEEE 802.3, IEEE 802.3u, IEEE 802.3x, IEEE 802.3ab, IEEE 802.3af, IEEE 802.3at, IEEE 802.3z			

Especificações

Modelo	G3310P-8-150W	G3318P-16-250W	G3326P-24-410W	
Porta	Porta RJ45 10/100/1000 Mbps	8	16	24
	Porta SFP 1000 Mbps	2		
Desempenho	Modo de comutação	Guardar e reencaminhar		
	Aprendizagem de endereços MAC	Envelhecimento automático, aprendizagem automática		
	Tabела de endereços MAC	8 K		
	Norma PoE	IEEE 802.3af, IEEE 802.3at		
	Núcleo de cabo de energia PoE	8 núcleos: a tensão dos núcleos 1, 2, 4, 5 é superior e a dos núcleos 3, 6, 7, 8 é -		
Fonte de alimentação PoE	Porta de PoE	1- 8	1- 16	1- 24
	Saída máxima de uma única porta	30 W		
	Saída máxíma do comutador	130 W	230 W	370 W
Dimensões (C x L x A)	294 mm x 179,6 mm x 44 mm	440 mm x 178,8 mm x 44 mm	440 mm x 284 mm x 44 mm	
Tensão de entrada	100-240V AC, 50/60Hz, 2A	100-240V AC, 50/60Hz, 4A	100-240V AC, 50/60Hz, 6A	
Proteção contra raios	Porta RJ45	Modo comum: 6 kV		
	Fonte de energia	Modo comum: 6 kV Modo diferencial: 4 kV		
Ambiente operacional	Temperatura: 0°C - 45°C Humidade: (10% - 90%) de HR, sem condensação			
Ambiente de armazenamento	Temperatura: -40°C - 70°C Humidade: (5% - 90%) de HR, sem condensação			
Taxa de transmissão de dados	Ethernet: 10 Mbps (half duplex)/20 Mbps (full duplex) Fast Ethernet: 100 Mbps (half duplex)/200 Mbps (full duplex) Gigabit Ethernet: 2000 Mbps (full duplex)			
Meios de transmissão	Ethernet: Cabo CAT3 UTP/STP ou superior Ethernet rápido: Cabo CAT5 UTP/STP ou superior Gigabit Ethernet: Cabo CAT5e ou CAT6 UTP/STP 1000Base-SX, MMF 1000Base-LX, MMF ou SMF			
Padrões de rede	IEEE 802.3, IEEE 802.3u, IEEE 802.3x, IEEE 802.3ab, IEEE 802.3af, IEEE 802.3at, IEEE 802.3z			

Specificații

Model	G3310P-8-150W	G3318P-16-250W	G3326P-24-410W	
Port	Port RJ45 10/100/1000 Mbps	8	16	24
	Port SFP 1000 Mbps	2		
Performanță	Switching mode	Store-and-forward		
	MAC address table learning	Auto learning, auto aging		
	MAC address table	8 K		
	PoE standard	IEEE 802.3af, IEEE 802.3at		
	Conductor cablu de alimentare PoE	8 conductori: tensiunea conductorilor 1, 2, 4, 5 este +, iar a conductorilor 3, 6, 7, 8 este -		
Alimentare PoE	Port PoE	1- 8	1- 16	1- 24
	Putere maximă per port	30 W		
	Putere maximă totală a switch-ului	130 W	230 W	370 W
Dimensiuni (L x l x l)	294 x 179,6 x 44 mm	440 x 178,8 x 44 mm	440 x 284 x 44 mm	
Tensiune de intrare	100 - 240 V ca., 50/60Hz, 2A	100 - 240 V ca., 50/60 Hz, 4A	100 - 240 V ca., 50/60 Hz, 6A	
Protecție împotriva descărcărilor electrice	Port RJ45	Mod obișnuit: 6 kV		
	Sursa de alimentare	Mod obișnuit: 6 kV Mod diferențial: 4 kV		
Mediu de funcționare	Temperatura: 0°C - 45°C Umiditate: (10% - 90%) umiditate relativă, fără condens			
Mediu de depozitare	Temperatura: -40°C - 70°C Umiditate: (5% - 90%) umiditate relativă, fără condens			
Viteză de transmisie a datelor	Ethernet: 10 Mbps (semi duplex)/20 Mbps (duplex complet) Fast Ethernet: 100 Mbps (semi duplex)/200 Mbps (duplex complet) Ethernet Gigabit: 2000 Mbps (duplex complet)			
Mediu de transmitere	Ethernet: Cablu CAT3 UTP/STP sau o versiune mai nouă Fast Ethernet: Cablu CAT5 UTP/STP sau o versiune mai nouă Ethernet Gigabit: CAT5e sau CAT6 UTP/STP 1000Base-SX, MMF 1000Base-LX, MMF sau SMF			
Standard rețea	IEEE 802.3, IEEE 802.3u, IEEE 802.3x, IEEE 802.3ab, IEEE 802.3af, IEEE 802.3at, IEEE 802.3z			

FAQ

- I cannot log in to the web UI of the switch. What should I do?

Try the following solutions:

- Check whether the switch is powered on properly: The PWR LED indicator is solid on.
- Check whether the computer is connected to the switch properly with an Ethernet cable.
- Check whether the IP address of Ethernet (or Local Area Connection) of the computer is set to **10.16.16.X** (X ranges from 2 to 254 excluding 168, and is not occupied).
- Clear the cache of the web browser or try another browser.
- Disable the firewall of the computer, or try another computer.
- Check whether only one device with the IP address **10.16.16.168** exists in the local network.

If the problem persists, reset the switch and try again.

Reset method: When the SYS LED indicator is blinking, hold down the **RESET** button with a needle-like object for about 7 seconds, and then release it when all indicators are solid on. When the **SYS** LED indicator blinks again, the switch is restored to factory settings.

- I forget the login user name and password when logging in to the web UI. What should I do?

Try entering the default login user name and password (both are admin). If you still fail to log in to the web UI, reset the switch, then use the default user name and password to log in.

For more FAQs, please visit our official website for technical support.

Safety and statement

Safety Precautions

Before performing an operation, read the operation instructions and precautions to be taken, and follow them to prevent accidents. The warning and danger items in other documents do not cover all the safety precautions that must be followed. They are only supplementary information, the installation and maintenance personnel need to understand the basic safety precautions to be taken.

- Do not use this apparatus near water.
- Clean only with dry cloth.
- Do not block any ventilation openings, such as newspapers, table-cloth, curtains, etc.
- Do not install near any heat sources such as radiators, heat registers, stoves or other apparatus that produce heat.
- Do not damage the ground conductor or operate the device in the absence of well installed ground conductor. Conduct the appropriate electrical inspection.
- Protect the power cord from being walk on or pinched particularly at the plugs, convenience receptacles and at the point where they exit from the apparatus.
- Only use attachments/accessories specified by the manufacturer.
- Unplug this apparatus during lighting storms or when unused for long periods of time.
- Mains plug is used as the disconnect device, the disconnect device shall remain readily operable.
- Mains plug is provided to qualified service personnel. Servicing is required when the apparatus has been damaged in any way, such as power-supply cord or plug is damaged, liquid has been spilled or objects have fallen into the apparatus, the apparatus has been exposed to rain or moisture, does not operate normally, or has been dropped.
- Warning: To reduce the risk of fire or electric shock, do not expose this apparatus to rain or moisture. The apparatus shall not be exposed to dripping or splashing.
- Warning: To reduce the risk of electric shock, do not remove cover as there is no user-serviceable parts inside. Refer servicing to qualified personnel.

Спецификации

Model	G3310P-8-150W	G3318P-16-250W	G3326P-24-410W	
Port	10/100/1000 Mbps RJ45 порт	8	16	24
	1000 Mbps SFP порт	2		
Технически показатели	Режим на превключване	Съхраняване и прераждане		
	Обучение на MAC адреси	Самуобучение, автоматично остаряване на остарели MAC адреси		
	Таблица с MAC адреси	8 К		
	PoE стандарт	IEEE 802.3af, IEEE 802.3at		
	PoE захранване кабелно ядро	8 ядра: напрежение на ядра 1, 2, 4, 5 е +, и ядра 3, 6, 7, 8 е -		
PoE захранване	PoE порт	1- 8	1- 16	1- 24
	Максимална изходна мощност на един порт	30 W		
	Максимална изходна мощност на превключвателя	130 W	230 W	370 W
Размери (Дl x Ш x B)	294 mm x 179,6 mm x 44 mm	440 mm x 178,8 mm x 44 mm	440 mm x 284 mm x 44 mm	
Входно напрежение	100- 240 V AC, 50/60Hz, 2A	100- 240 V AC, 50/60Hz, 4A	100- 240 V AC, 50/60Hz, 6A	
Мълниезащита	RJ45 порт	Общ режим: 6 kV		
	Захранване	Общ режим: 6 kV Диференциален режим: 4 kV		
Работна среда	Температура: 0°C - 45°C Влажност: (10% - 90%) RH, некондензиращи			
Среда за съхранение	Температура: -40°C - 70°C Влажност: (5% - 90%) RH, некондензиращи			
Скорост на предаване на данни	Ethernet: 10 Mbps (полуdupлекс)/20 Mbps (пълнен dupлекс) Бърз Ethernet: 100 Mbps (полуdupлекс)/200 Mbps (пълнен dupлекс) Гигабитен Ethernet: 2000 Mbps (пълнен dupлекс)			
Носител за предаване	Ethernet: CAT3 UTP/STP или по-добре Бърз Ethernet: CAT5 UTP/STP или по-добре Гигабит Ethernet: CAT5e или CAT6 UTP/STP 1000Base-SX, MMF 1000Base-LX, MMF или SMF			
Мрежови стандарти	IEEE 802.3, IEEE 802.3u, IEEE 802.3x, IEEE 802.3ab, IEEE 802.3af, IEEE 802.3at, IEEE 802.3z			

Especificaciones

Modelo	G3310P-8-150W	G3318P-16-250W	G3326P-24-410W	
Puerto	Puerto RJ45 de 10/100/1000 Mbps	8	16	24
	Puerto SFP de 1000 Mbps	2		
Rendimiento	Modo de comutación	Almacenar y retransmitir		
	Aprendizaje de direcciones MAC	Vencimiento automático, aprendizaje automático		
	Tabla de direcciones MAC	8 K		
	Estándar de PoE	IEEE 802.3af, IEEE 802.3at		
	Núcleo del cable de alimentación PoE	8 núcleos: el voltaje de los núcleos 1, 2, 4 y 5 es +, y el de los núcleos 3, 6, 7 y 8 es -		
Fuente de alimentación PoE	Puerto PoE	1- 8	1- 16	1- 24
	Salida máxima de un solo puerto	30 W		
	Salida máxima del conmutador	130 W	230 W	370 W
Dimensiones (L x An x Al)	294 mm x 179,6 mm x 44 mm	440 mm x 178,8 mm x 44 mm	440 mm x 284 mm x 44 mm	
Voltaje de entrada	100 - 240 V CA, 50/60Hz, 2A	100 - 240 V CA, 50/60Hz, 4A	100 - 240 V CA, 50/60Hz, 6A	
Protección contra rayos	Porto RJ45	Modo común: 6 kV		
	Fuente de alimentación	Modo común: 6 kV Modo diferencial: 4 kV		
Entorno de funcionamiento	Temperatura: 0°C - 45°C Humedad: 10 %–90 % HR, sin condensación			