



Questo manuale d'istruzione è fornito da trovaprezzi.it. Scopri tutte le offerte per [iRobot Roomba Combo 10 Max](#) o cerca il tuo prodotto tra le [migliori offerte di Aspirapolvere e Pulitrici](#)



Questo manuale d'istruzione è fornito da trovaprezzi.it. Scopri tutte le offerte per [iRobot Roomba Combo 10 Max](#) o cerca il tuo prodotto tra le [migliori offerte di Aspirapolvere e Pulitrici](#)

# Roomba Combo®

**10 Max** robot

+ AutoWash dock

Owner's Guide

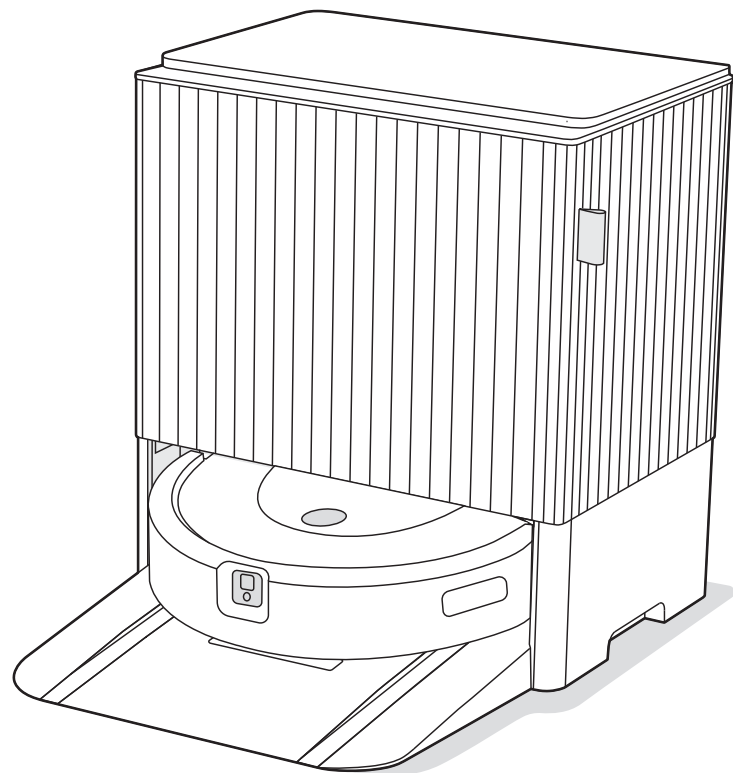

**iRobot**

# Safety information















## Important safety information

This owner's guide includes information for Regulatory Model(s): Robot: RCA-Y2 | Dock: ADL-N1 | Battery: ABL-F, ABL-D2Ax, ABL-D2Bx (x = 1 or 2) | Robot Radio Module: 6233E-UUB

**SAVE THESE INSTRUCTIONS**  
**WARNING:** When using an electrical appliance, basic precautions should always be followed, including the following:

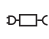
**READ ALL INSTRUCTIONS**  
**WARNING:** to reduce the risk of injury or damage, read and follow the safety precautions when setting up, using, and maintaining your robot.

This appliance is not intended for use by persons (including children) with reduced physical, sensory or mental capabilities, or lack of experience and knowledge, unless they have been given supervision or instruction concerning use of the appliance by a person responsible for their safety. Children should be supervised to ensure that they do not play with the appliance.

-  This is the safety alert symbol. It is used to alert you to potential physical injury hazards. Obey all safety messages that follow this symbol to avoid possible injury or death.
- |   |   |  |   |  |
|---|---|--|---|--|
|  Risk of electric shock |  For indoor use only |  Rated power output, d.c. |  Read operator's manual        |  General symbol for recycling |
|  Risk of fire           |  Class II equipment  |  Rated power input, d.c.  |  Keep out of reach of children |  Separate Supply Unit         |
|  Caution                |  Class III equipment |  Rated power input, a.c.  |   |  |

**WARNING:** Indicates a hazardous situation that, if not avoided, could result in death or serious injury.

**CAUTION:** Indicates a hazardous situation that, if not avoided, could result in minor or moderate injury.

**NOTICE:** Indicates a hazardous situation that, if not avoided, could result in property damage.

#### GENERAL



- This product comes with a region approved power supply cord and is designed to be plugged into a standard household AC power outlet only. Do not use any other power supply cord. For replacement cords, please contact Customer Care to ensure proper selection of country specific power supply cord.
- Do not disassemble or open this product other than instructed in the Owner's Guide. There are no user serviceable parts inside. Refer servicing to qualified service personnel.
- Risk of electric shock use indoors in dry location only.
- Do not handle this product with wet hands.
- Do not place anything hazardous or flammable on top of your robot or dock.
- This product is not a toy. Small children and pets should be supervised when your robot is operating. Do not sit or stand on your robot or dock.
- Do not sit or stand on this product.
- Store and operate this product in room temperature environments only.
- Do not use unauthorized chargers. Use of an unauthorized charger could cause the battery to generate heat, smoke, catch fire, or explode.
- If the room to be cleaned contains a balcony, a physical barrier should be used to prevent access to the balcony and ensure safe operation.
- If the room to be cleaned contains equipment, such as a stove, fan, portable heater, or humidifier, remove the equipment before operation. There is a risk of injury, accident or malfunction if the robot comes in contact with and pushes the equipment.
- Do not allow your robot or dock to become wet.
- Clean cliff sensors for buildup.

- Do not use the Mopping Pad Plate as a handle to lift or move the robot.
- Be aware that floors may be slippery after wet cleaning with your robot.



- Do not operate the robot in areas with exposed electrical outlets or gas shut-off valves in the floor.
- Do not use this device to pick up sharp objects, glass, or anything that is burning or smoking.
- Be aware that the robot moves on its own. Take care when walking in the area that the robot is operating in to avoid stepping on it.
- If the device passes over a power cord and drags it, there is a chance an object could be pulled off a table or shelf. Before using this device, pick up objects like clothing, loose papers, pull cords for blinds or curtains, power cords, and any fragile objects. Extinguish candles. Shut off portable heaters.
- Perform the required maintenance as per the Owner's Guide to ensure safe operation of the robot and dock.
- If the robot is operating on a floor with stairs, please remove any clutter from the top step.

## NOTICE

- Do not allow your robot or dock to become wet.
- The failure to maintain cleanliness of charger contacts could result in loss of ability for the robot to charge the battery and the contacts to become hot to the touch.
- Before running your robot on hard floors, please test your robot on a small section of the hard floor to ensure that it is compatible. Using your robot on a hard floor that is not compatible could result in damage to your floor. Contact your hard floor manufacturer with questions on compatibility.
- Before running your robot on carpets or rugs, ensure that the carpets or rugs are compatible with the dual multi-surface rubber brushes on your robot, otherwise known as beater bars. Using your robot on a carpet

or rug that is not compatible could result in damage to your carpet or rug. Contact your carpet or rug manufacturer with questions on compatibility.

## DOCK

### **WARNING**

- Do not use if the cord or plug is damaged. If appliance is not working as it should, has been dropped, damaged, left outdoors or dropped into water, return it to a service center.
- Always disconnect your robot from the dock before cleaning or maintaining it.
- Do not use the dock as a step.
- Do not put any object into openings. Do not use with any opening blocked; keep free of dust, lint, hair and anything that may reduce air flow.
- To properly maintain your dock, do not place foreign objects in your Debris Evacuation Port and ensure that it is clear of debris.
- In order to avoid a hazard due to inadvertent resetting of the thermal cut-out, this appliance must not be supplied through an external switching device, such as a timer, or connected to a circuit that is regularly switched on and off by the utility.
- Do not allow liquids to get on or into the dock.
- Do not pour any liquids into the device and do not immerse in water.
- Do not use outdoors or on wet surfaces.
- Do not allow to be used as a toy. Close attention is necessary when used by or near children.
- Use only as described in this manual.
- To reduce the risk of electric shock, unplug your dock before cleaning.
- Keep the dock and power cord away from heated surfaces.
- To avoid accidental contact with or ingestion of the cleaning solution, do not allow children to remove the tanks from the dock.
- Full tank is heavy. To avoid risk of injury, take additional care when inserting or removing the tanks. Do not allow children to insert or remove the tank.

- To prevent the risk of your robot falling down stairs, ensure that the dock is placed at least 1.2 metres (4 feet) away from stairs.

## NOTICE

- Product may not be used with any type of power converter. Use of power converters will immediately void the warranty.
- If you live in an area prone to electrical storms, it is recommended that you use additional surge protection. Your dock may be protected with a surge protector in the event of severe electrical storms.
- Do not use without a dust bag and/or filters in place.

## CLEANING SOLUTION

### **WARNING**

- Household cleaning products are safe when used and stored according to the instructions on the label. Always be sure to read and follow the directions carefully.
- Only use authorised cleaning solutions found on [answers.irobot.com/s/roomba-combo-cleanser](https://answers.irobot.com/s/roomba-combo-cleanser)
- For cleaning solution warnings, please refer to the outer box and solution bottle.



Keep away from children



Keep away from eyes. If product gets into eyes rinse thoroughly with water.



Rinse hands after use

## BATTERY

# WARNING

- Do not open, crush, heat above 80°C (176°F) or incinerate. Follow the Owner's Guide instructions for proper use, maintenance, handling and disposal.
- Do not short-circuit the Battery by allowing metal objects to contact the battery terminals or by immersing it in liquid. Do not subject batteries to mechanical shock.
- Lithium ion batteries and products that contain lithium ion batteries are subject to stringent transportation regulations. If you need to post this product (with the Battery included) for service, travel or any other reason, you must refer to the Troubleshooting section of your Owner's Guide or contact Customer Care for postage instructions.
- Periodically inspect the battery pack for any sign of damage or leakage. Do not charge damaged or leaking battery packs. Do not allow the liquid to come into contact with skin or eyes. If contact has been made, wash the affected area with large amounts of water and seek medical advice. Place the Battery in a sealed plastic bag and recycle or dispose of it safely according to local environmental regulations or return it to your local authorised iRobot Service Center for disposal.
- Keep the battery pack clean and dry. Wipe the cell/battery terminals with a clean dry cloth if they become dirty.

# CAUTION

- Battery usage by children should be supervised. Seek medical advice immediately if a cell or a battery has been swallowed.

## NOTICE

- The battery pack must be removed from the robot before recycling or disposal.
- For best results, only use the Lithium Ion Battery that comes with the robot.

- Do not use non-rechargeable batteries. Use only the rechargeable battery supplied with the product. For replacement, purchase identical iRobot battery or contact iRobot Customer Care for alternative battery options.
- Always charge and remove the battery from your robot and accessories before long-term storage.

### ADL-N1

NOMINAL ELECTRICAL CHARACTERISTICS	
Input voltage: 100-127 V	Input frequency: 50/60 Hz
Output voltage: 19.5 VDC	Current output: 1.25 A



This symbol on the battery indicates that the battery must not be disposed of with unsorted common municipal waste. As the end-user, it is your responsibility to dispose of the end-of-life battery in your appliance in an environmentally sensitive manner as follows:

- (1) returning it to the distributor/dealer from whom you purchased the product; or
- (2) depositing it in a designated collection point.

The separate collection and recycling of end-of-life batteries at the time of disposal will help to conserve natural resources and to ensure that it is recycled in a manner that protects human health and the environment. For more information, please contact your local recycling office or the dealer from whom you originally purchased the product. Failure to properly dispose of end-of-life batteries may result in the negative potential effects on the environment and human health due to the substances in the batteries and accumulators.

For battery recycling go to [call2recycle.org](http://call2recycle.org) or call 1-800-822-8837.

# Get started

## 1 Download the iRobot Home App

Scan the QR code with the camera on your mobile device or find the iRobot Home App in your app store.

- Follow step-by-step instructions to set up your robot.
- Complete setup in the app to allow your robot to identify and avoid obstacles in real time.
- Set an automatic cleaning schedule and customize cleaning preferences.
- Create smart maps to tell your robot where, when and how to clean.
- Access to tips, tricks, and answers to commonly asked questions. Follow step-by-step instructions to set up your robot.



**IMPORTANT:** Read enclosed safety information guide first before using your robot.

## 2 Position the dock

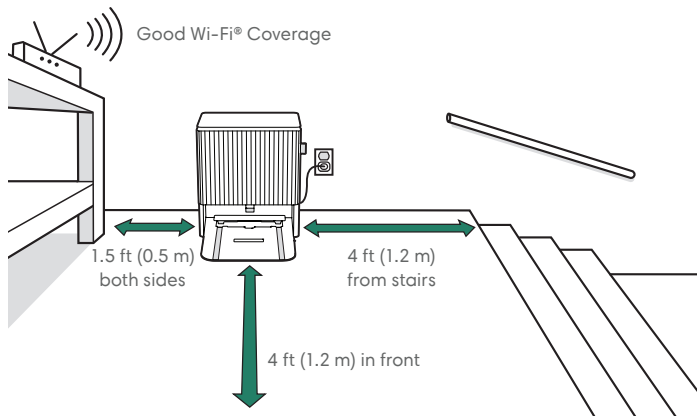

- Position your dock on hard surface flooring, near an outlet, in an area with good WiFi® coverage.
- Do not place it in direct sunlight.
- Ensure the area around the dock is free of clutter to improve docking performance.



**WARNING:** To prevent the risk of your robot falling down stairs, ensure that your dock is placed at least 4 feet (1.2 meters) away from stairs.

### 3 Install the dock ramp

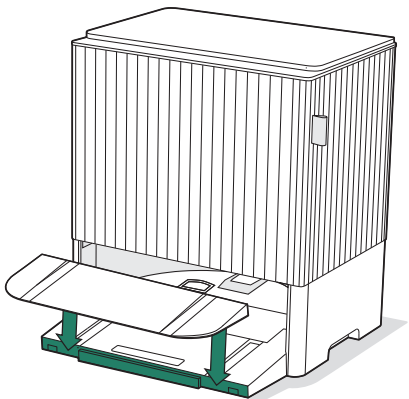

- Install the removable ramp by aligning with the dock.
- Press down to snap into place.

### 4 Install the Pad Washing Roller

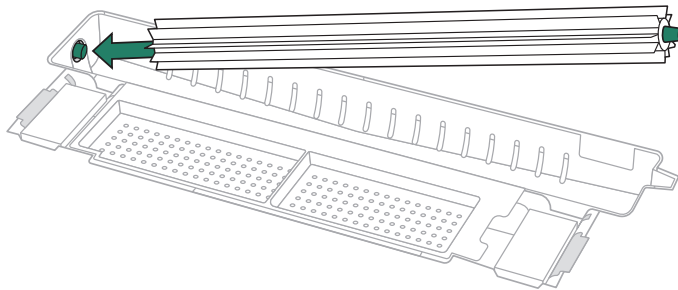

- Remove stickers from Pad Washing Filter.
- Install Pad Washing Roller from left to right by aligning the roller peg into place.

## 5 Prepare the Clean and Dirty tanks

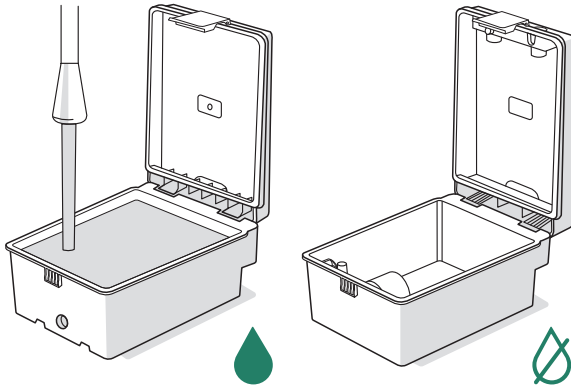

- Remove both tanks from the dock.
- Fill the Clean Tank (left) with water or compatible cleaning solution.

**\*** **IMPORTANT:** Only certain cleaning solutions can be safely used with your robot. A full list of compatible cleaning solutions can be found on <http://answers.irobot.com/s/roomba-combo-cleanser> or by visiting the app. Please do not use other cleaning solutions or bleach-based products.

- Both the Clean Tank and Dirty tank are shipped unlatched. You must latch both tanks before initial use.

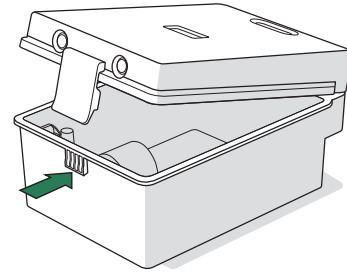

- Reinstall the tanks.

**\*** **IMPORTANT:** Ensure the latch is properly closed on the tank before reinstalling.

## 6 Plug in the dock

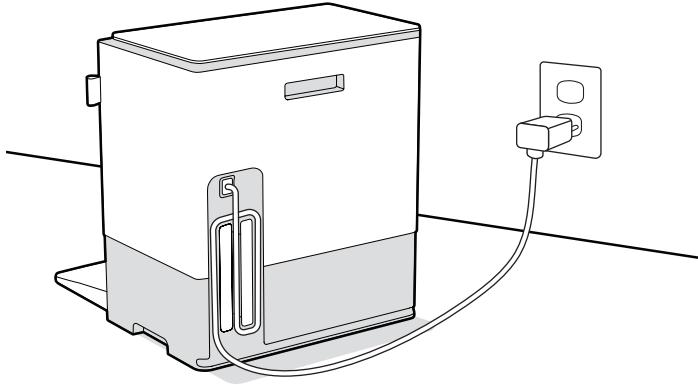

- Plug the power cord into the dock, then into the wall.
- Wrap the cord back so it won't get in the way of the robot as it comes and goes.

## 7 Wake up the robot

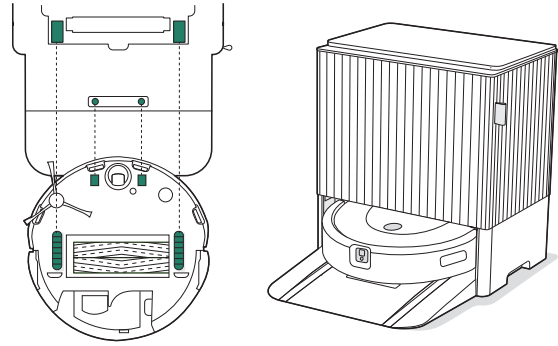

- Place your robot on the dock with the camera facing out.
- Make sure the metal charging contacts are lined up and the wheels are placed over the wheel switches.
- The charging LED indicator on the dock will briefly illuminate when the robot is docked correctly.
- After two full minutes your robot will chime when ready and display a solid or slowly filling white ring around its button.



**NOTE:** Your robot comes with a partial charge, but we recommend that you charge the robot for 3 hours prior to starting the first cleaning job.

If the light ring is swirling white, the robot is not ready and is still waking up.

# About your robot

## Top view

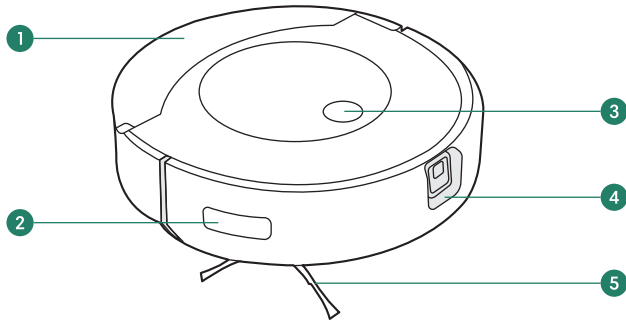

- 1 Mopping pad plate
- 2 Wall follow sensor
- 3 Clean button
- 4 Camera
- 5 Edge-sweeping brush

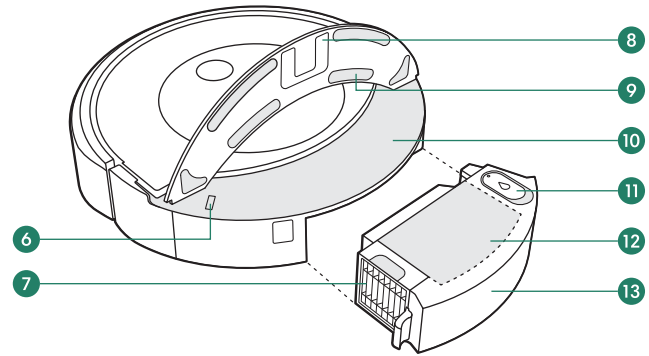

- 6 IR pad sensor
- 7 Filter
- 8 Pad track
- 9 Pad attachments
- 10 Pad shelf
- 11 Tank cap
- 12 Dust bin
- 13 Water tank

## Bottom view

EN

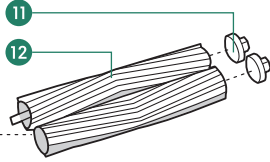
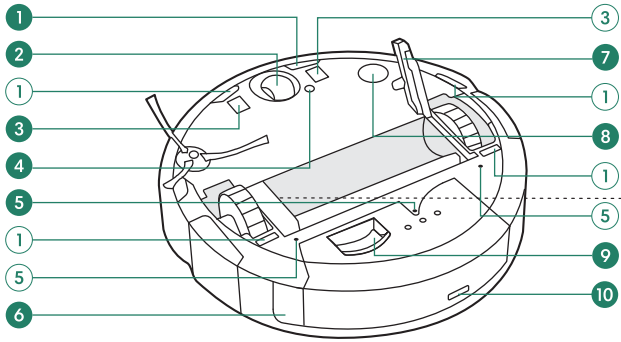

- 1 Cliff sensors
- 2 Front castor wheel
- 3 Charging contacts
- 4 Floor type sensor
- 5 Nozzle
- 6 Bin release button
- 7 Brush frame release tab
- 8 Floor tracking sensor
- 9 Debris evacuation port
- 10 Refill port

- 11 Brush caps
- 12 Multi-surface brushes

# About your dock

## Front view

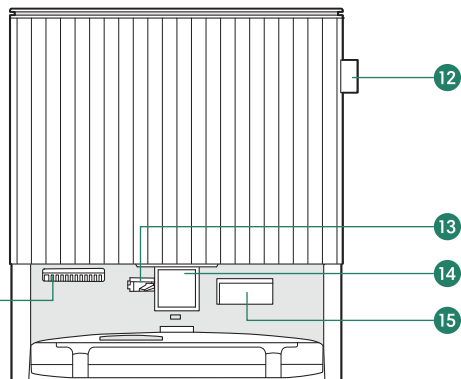
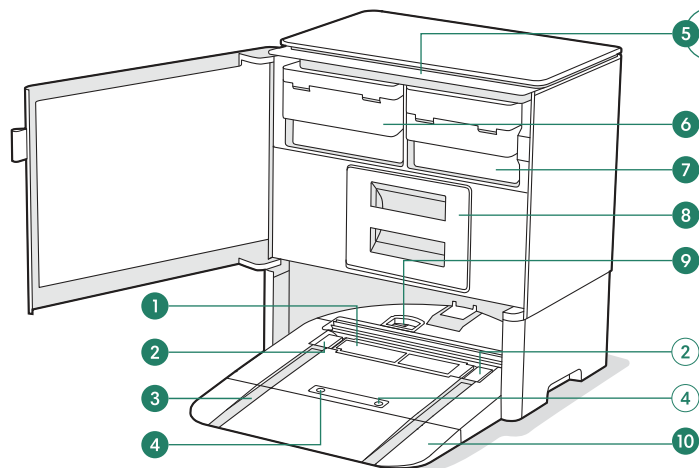

- 1 Pad washing system
- 2 Wheel switch
- 3 Wheel track
- 4 Charging contact
- 5 LED indicators
- 6 Clean tank

- 7 Dirty tank
- 8 Debris bag drawer
- 9 Debris evacuation port
- 10 Removable ramp

- 11 Forced air outlet
- 12 Pull tab
- 13 Refill nozzle
- 14 Visual docking target
- 15 IR window

EN

### Pad Washing System view

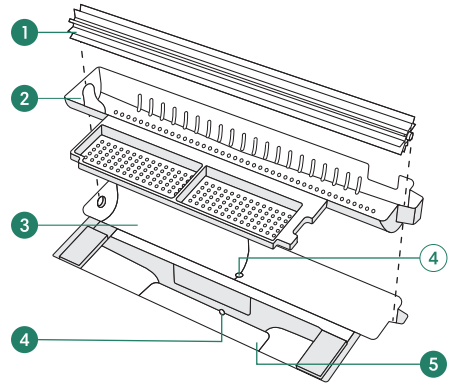

- 1 Pad washing roller
- 2 Pad washing filter
- 3 Pad washing basin
- 4 Drainage port
- 5 Liquid overflow basin

### Back view

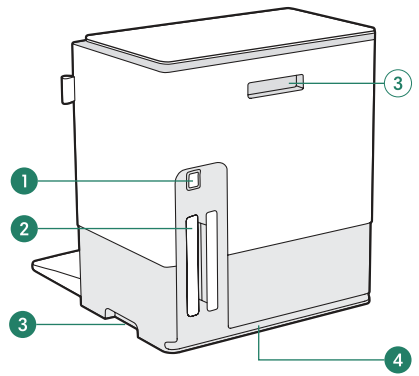

- 1 Cord attachment
- 2 Cord wrap
- 3 Carrying handle
- 4 Cord management channel

### Bottom view

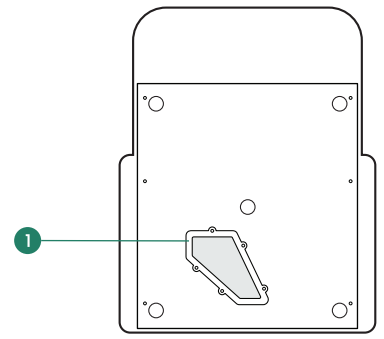

- 1 Debris tube access panel

# Charging

## Light Ring: Charging in progress



**Sweeping white:** charging

- Percentage charged is indicated by the size of the solid white
- For example, if half the light ring is solid, it's 50% charged

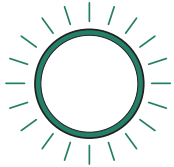

**Pulsing red:** charging, low battery

## Light Ring: Charging complete



**Solid white:** fully charged  
**Pulsing white at rear:** fully charged and asleep

## Dock Charging LED indicator



**On:** Robot on dock charging  
**Off:** robot not on dock, robot not charging, or dock is asleep



**NOTE:** After 60 seconds, the dock will sleep and the Charging LED indicator will turn off. To check the status, tap the Clean button on your robot or visit the iRobot Home app.

EN

## Charging during a cleaning job

You robot will return to the dock whenever it needs to recharge. Once the robot is sufficiently charged, it will then resume the cleaning job where it left off.

## Standby mode

The robot uses a small amount of power whenever it is on the dock. You can put the robot in a further-reduced power state when not in use. For instructions and more details on this Reduced Power Standby Mode, refer to the FAQ page on our website.

## Storing your robot

For long-term storage, turn off the robot by removing it from the dock and holding down the clean button for 3 seconds with one wheel off the ground. Store the robot in a cool, dry place.

# Cleaning

## Clean button controls

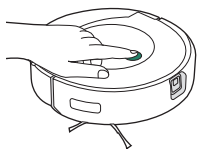

Tap to Start / Pause / Resume a job

Hold for 2-5 seconds to end a job and send the robot back to its dock

## Light Ring: Cleaning



**Sweeping red toward rear:** robot bin needs to be emptied



**Blue marching forward:** robot seeking dock

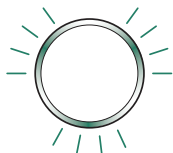

**Flashing blue:** Dirt Detect™ mode engaged

## Dock LED Indicators while cleaning



**Solid red:** bag full, missing, or improperly installed



**Solid red:** dirty tank full, missing, or improperly installed



**Solid red:** clean tank empty, missing, or improperly installed

## Cleaning pattern

Once your robot creates a map of your home, it will automatically explore and clean in neat rows, avoiding obstacles by using its front-facing camera.



**IMPORTANT:** The robot is unable to navigate in complete darkness. Turn on lights or open blinds to help the robot navigate.

Your robot will return to the dock. You robot will return to the dock at the end of a cleaning job and whenever it needs to empty the bin, fill the water tank, wash the pad, or recharge. Once complete, it will resume the cleaning job where it left off.



Your robot is able to recognize and avoid objects. However, it is still recommended to remove excess obstacles before cleaning.

After 90 minutes of inactivity off the dock, the robot will automatically end its cleaning job. If you are unsure if the robot is finished or paused, visit the iRobot Home App to check on its status.

## Dirt Detect™

When your robot detects an especially dirty area, it will engage Dirt Detect™ mode, moving in a forward/backward motion to clean the area more thoroughly. The light ring indicator will flash blue when Dirt Detect™ mode is engaged.

## Vacuuming

### Starting a vacuum only cleaning job from your robot

- 1 Detach the mopping pad before starting a vacuum job.
- 2 Return the robot to the dock and press the Clean button on your robot.



**NOTE:** When starting a vacuum only cleaning job from the iRobot Home app, you do not need to empty the tank or remove the mopping pad.

If you start a cleaning job from off the dock, the robot will still end its job on the dock. If it can't find its dock, it will end wherever it started in your home.

## Vacuuming and mopping

Your robot is able to both vacuum and mop at the same time.

When your robot detects carpet during its cleaning job, it will lift and tuck the mopping pad away.

Your dock will refill your robot's tank as needed and wash its mopping pad when the job is complete.



**WARNING:** To prevent damaging your robot, do not manually stow the mopping pad plate onto the pad shelf.

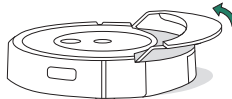

**IMPORTANT:** After completing your mopping and vacuum cleaning job, make sure to empty the robot bin water tank and replace the mopping pad.

### Starting a vacuum and mop cleaning job from your robot

- 1 Press bin release button to remove bin.

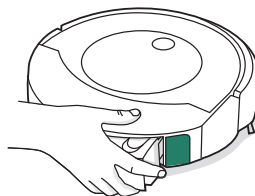

- 2 Fill tank with water or compatible cleaning solution.

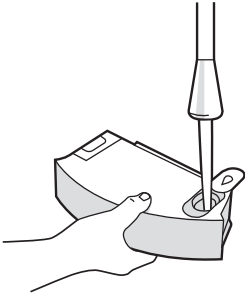

- 3 Attach mopping pad.

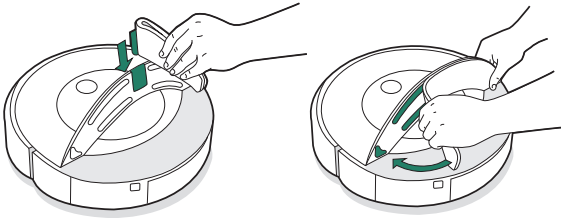

- 4 Place bin back in the robot.

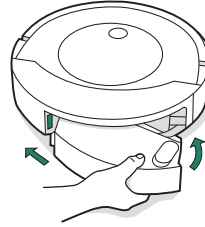

- 5 Place on the floor or return the robot to the dock and press the Clean button on your robot.



**NOTE:** If you start a cleaning job from off the dock, the robot will still end its job on the dock. If it can't find its dock, it will end wherever it started in your home.

## Starting a vacuum and mop cleaning job from your dock

If the Clean Tank or Dirty Tank LED Indicators are on:

- 1 Use pull tab to open door. Remove the tank that requires maintenance.

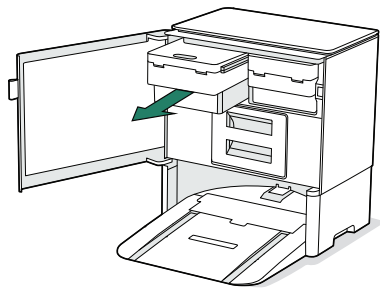

- 2 Lift the latch on the tank to open.

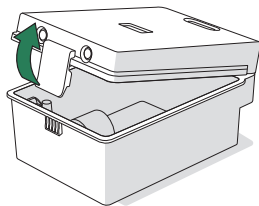

- 3 Fill the Clean Tank with water. Empty the Dirty Tank.

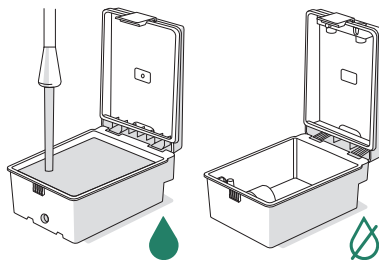

**IMPORTANT:** Ensure the latch is properly closed on the tank before reinstalling.

- 4 Place tanks back in the dock and close the door, making sure it is completely closed.
- 5 Attach mopping pad to robot.

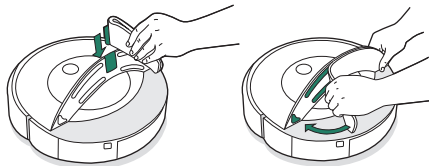

- 6 Return the robot to the AutoWash dock and press the Clean button on your robot.

If tanks are ready for cleaning and LED indicators are not on:

- 1 Attach mopping pad to robot.
- 2 Return the robot to the dock and press the Clean button on your robot.



**IMPORTANT:** Only certain cleaning solutions can be safely used with your robot. A full list of compatible cleaning solutions can be found on <http://answers.irobot.com/s/roomba-combo-cleanser> or by visiting the app. Please do not use other cleaning solutions or bleach-based products.

## Pad Washing

At the end of a cleaning job, the dock will wash and dry the mopping pad. The robot will lower the mopping pad and drive back and forth over the Pad Washing Roller. This process will take several minutes.



**IMPORTANT:** Do not interrupt the robot while Pad Washing is active. It is normal to hear noises throughout this process as the dock spins the Pad Washing Roller and fills/drains the Pad Washing Basin.

Once complete, the dock will proceed to dry the mopping pad by blowing air.



**NOTE:** The drying process will last for a few hours. You may hear a low hum coming from the dock while the dryer is active.

Visit the iRobot Home app to manually start or stop Pad Washing and Drying or to customize pad washing settings.

## Emptying the bin

### Emptying the bin from your robot

When your robot senses that its bin needs to be emptied, the light ring indicator will illuminate in a red sweeping motion toward the rear.

- 1 Press bin release button to remove bin.

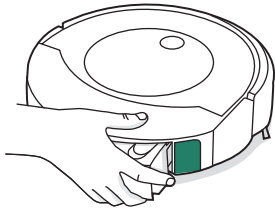

- 2 Open bin door to empty bin.

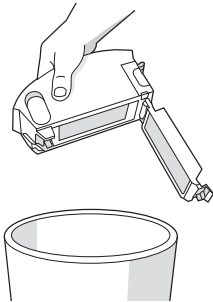

- 3 Place bin back in the robot.

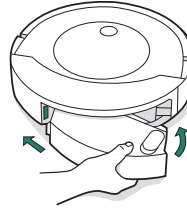

### Emptying the bin from your dock

While cleaning, your robot will automatically return to the dock to empty its bin. Once complete, it will resume the cleaning job where it left off.



**NOTE:** If you place your robot on the dock by hand, it will not empty automatically. In this case, use the iRobot Home App or hold the clean button down for 2-5 seconds.

# Care and maintenance for your robot

To keep your robot at optimal performance, make sure you periodically perform the following care & maintenance. There are additional instructional videos in the iRobot Home App. If you notice the robot picking up less debris from your floor, empty the bin, clean the filter, and clean the brushes.

Part	Care Frequency	Replacement Frequency*
Bin	Wash bin as needed	-
Charging contacts	Clean every 2 weeks	
Filter	Clean once a week (twice a week if you have a pet). Do not wash	Every 2 months
Edge-sweeping brush and Multi-surface Brushes	Clean once a month	Every 12 months
Front caster wheel	Clean every 2 weeks	Every 12 months
Full bin sensor	Clean every 2 weeks	-
Sensor, Camera window, and Pad shelf	Clean once a month	-
Mopping pad	Wash manually as needed	As needed Dispose in household waste when no longer usable

\* Replacement frequency may vary. Parts should be replaced if visible wear appears. If you think you need a replacement part, please contact iRobot Customer Care for more information.

## Cleaning the filter

- 1 Remove the bin. Remove the filter by grasping both ends and pulling out.

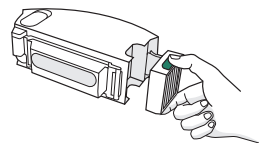

- 2 Remove debris by tapping the filter against your trash container.



- 3 Reinsert filter with ridged grips facing out. Place bin back in the robot.



**IMPORTANT:** The robot will not run if the filter is not installed correctly. Replace the filter every two months.

## Cleaning the full bin sensors

- 1 Remove and empty the bin.

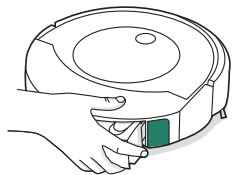

- 2 Wipe the inner sensors with a clean, dry cloth.

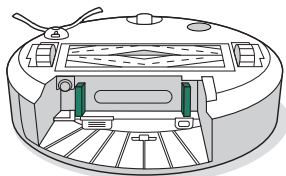

- 3 Wipe the bin door with a clean, dry cloth.

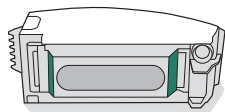

Closed door

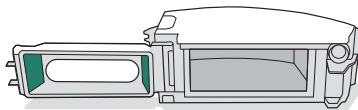

Open door

- 4 Clear any debris from the vacuum path.

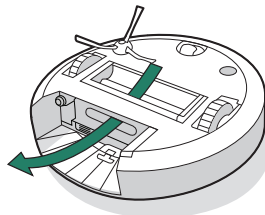

## Washing the bin

- 1 Release the bin, remove the filter, and open the bin door.
- 2 Rinse the dust bin and water tank using warm water.

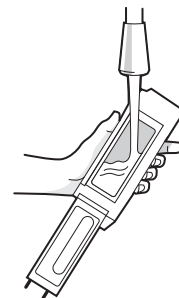

- 3 Make sure bin is completely dry. Reinsert filter and place bin back in the robot.



**IMPORTANT:** The bin is not dishwasher safe. Do not wash the filter. Remove the filter before washing the bin.

## Cleaning the charging contacts, sensors, camera window, and pad shelf

Wipe components with a clean, dry cloth.

### CHARGING CONTACTS

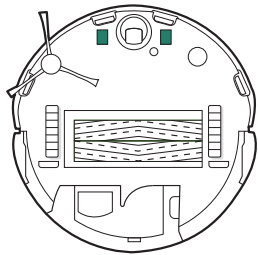

### SENSORS

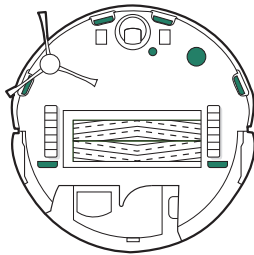

### CAMERA WINDOW

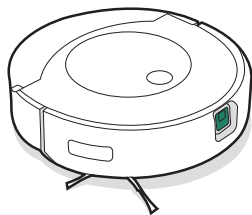

### PAD SHELF & IR PAD SENSOR

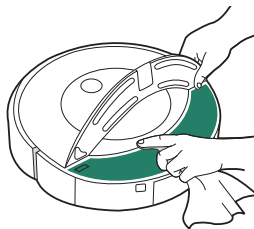

**IMPORTANT:** Do not spray cleaning solution or water onto the sensors or sensor openings.

## Cleaning the Edge-Sweeping Brush

- 1 Use a small screwdriver to remove the screw holding the edge-sweeping brush in place.
- 2 Pull to remove the edge-sweeping brush. Remove any hair or debris, then reinstall the brush.

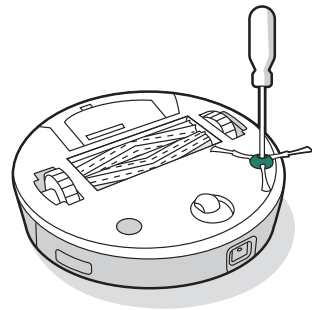

## Cleaning the dual Multi-Surface Brushes

- 1 Pinch the brush frame release tab, lift the tab, and remove any obstructions.

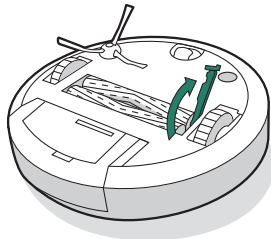

- 2 Remove the brushes from the robot. Remove the end caps from the ends of the brushes. Remove any hair or debris that has collected beneath the caps. Reinstall the brush caps.

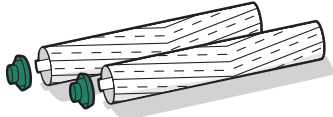

- 3 Remove any hair or debris from the square and hexagonal pegs on the opposite side of the brushes. Replace end caps.

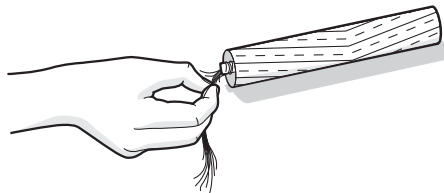

- 4 Reinstall the brushes in the robot. Match the shape of the brush pegs with the shape of the brush icons in the cleaning head module.

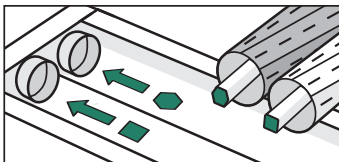

## Cleaning the front caster wheel

- 1 Pull firmly on the front wheel module to remove it from the robot.
- 2 Pull firmly on the wheel to remove it from its housing.
- 3 Remove any debris from inside the wheel cavity.
- 4 Reinstall all parts when finished. Make sure the wheel clicks back into place.

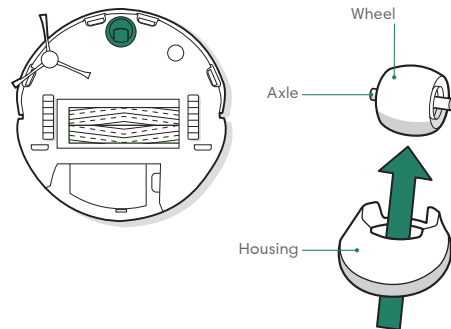

**IMPORTANT:** A front wheel clogged with hair and debris could result in damage to your floor. If the wheel is not spinning freely after you have cleaned it, please contact Customer Care.

## Cleaning the mopping pad

You can clean your mopping pads two ways: either by hand washing, or in a washing machine.

### HAND WASHING

Thoroughly wash the pad with warm water.

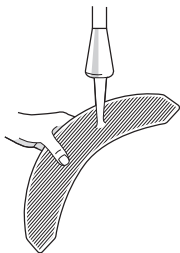

### MACHINE WASHING

Wash using the warm cycle, then air dry. Do not put in dryer. Do not wash with delicates.

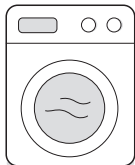

# Care and maintenance for your dock

To keep your dock running at peak performance, perform the procedures on the following pages.

Part	Care Frequency	Replacement Frequency*
Bags	-	Bags should be replaced when prompted by the LED indicator or the iRobot Home app
Charging contacts	Clean every 2 weeks	-
Sensors, IR window, Visual docking target	Clean once a month	-
Clean tank	Rinse and refresh water as needed	-
Dirty tank	Rinse and empty as needed	-
Pad washing basin, Liquid overflow basin	Clean if visibly dirty, once a month, or as indicated by iRobot Home app	-
Pad washing roller	Clean if visibly dirty, once a month, or as indicated by iRobot Home app	12 months or when prompted by the iRobot Home app
Ramp	Clean if visibly dirty	-

\* Replacement frequency may vary. Parts should be replaced if visible wear appears. If you think you need a replacement part, please contact iRobot Customer Care for more information.

## Replacing the bag

- 1 Use pull tab to open door and remove Debris Bag Drawer.

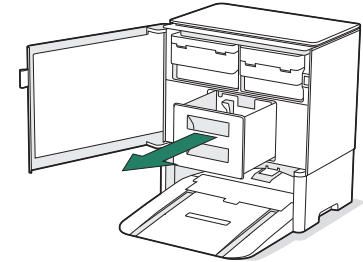

- 2 Pull up on the card to remove the bag from the canister. Discard the used bag.

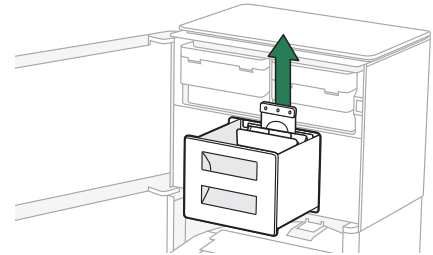

- 3** Install a new bag, sliding the plastic card into the guide rails. This will seal the bag so dust and debris cannot escape.

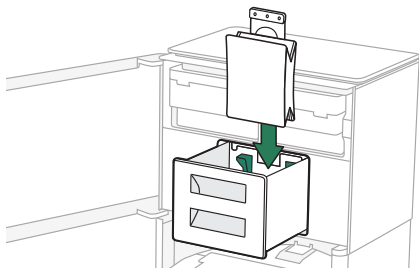

- 4** Reinstall the Debris Bag Drawer and close the door making sure it is completely closed.



**IMPORTANT:** To achieve optimal performance with your robot and dock, clean and/or replace your robot's filter as needed.

## Washing the tanks

- 1** Use pull tab to open door. Remove the Clean and Dirty tanks.

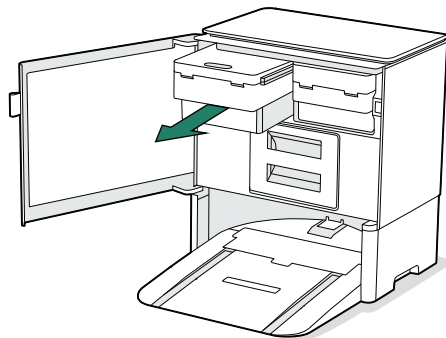

- 2** Lift the latch on the tanks to open.

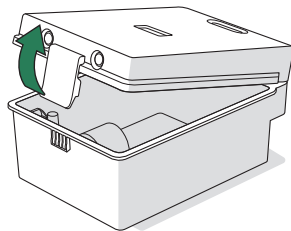

- 3** Rinse the tanks using warm water. Mild soap and a sponge may be used for stubborn debris.

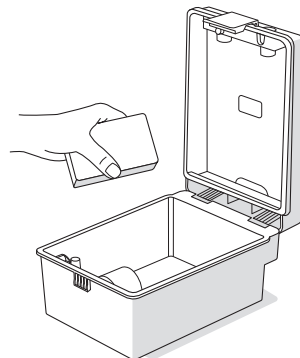

- 4** Refill the Clean Tank with water. Leave the Dirty Tank empty. Place both tanks back in the dock.

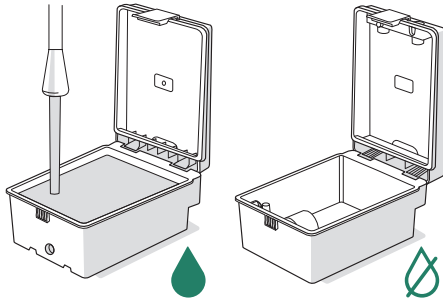

**IMPORTANT:** Ensure the latch is properly closed on the tank before reinstalling.

Tanks are not dishwasher safe.

## Cleaning the Pad Washing System

- 1** Remove the Pad Washing Roller.

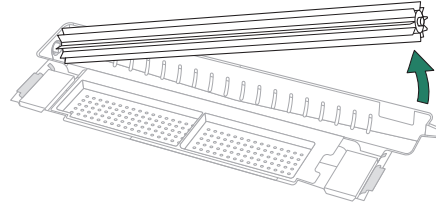

- 2** Remove the Pad Washing Filter.

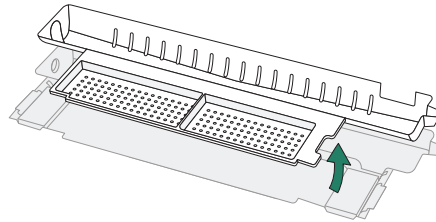

- 3** Wipe out the Pad Washing Basin with a clean dry cloth. Ensure there are no obstructions in the drainage port. Mild soap and a sponge may be used for stubborn debris.

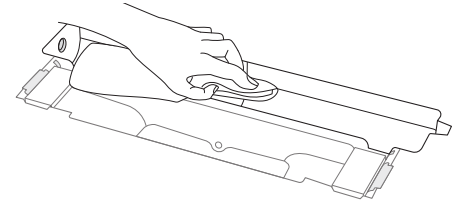

- 4** Repeat step 3 for the Liquid Overflow Basin.

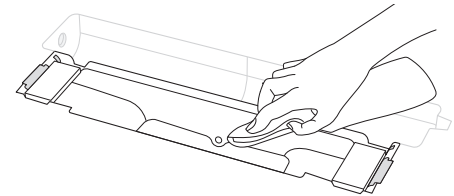

- 5** Wash the filter and roller under warm water. Mild soap and a sponge may be used for stubborn debris. Pat dry before reinstalling.

- 6** Reinstall the filter.

- 7 Reinstall the roller by aligning the Pad Washing Roller peg into place.

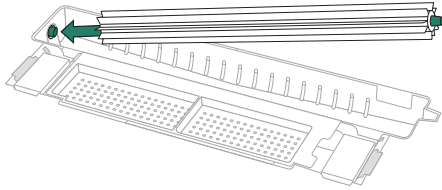

## Cleaning the charging contacts, IR window, and visual docking target

Inspect the components to make sure that they are clear of debris. Wipe with a clean, dry cloth.

### CHARGING CONTACTS

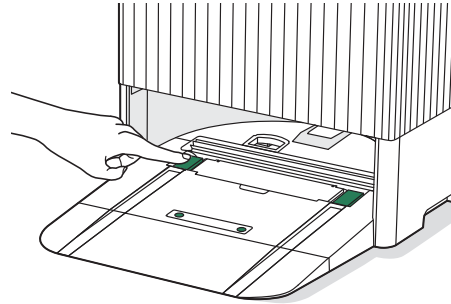

### VISUAL DOCKING TARGET

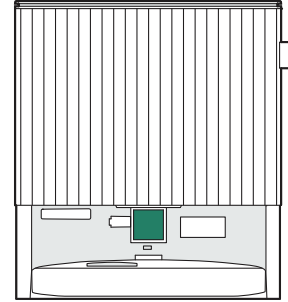

### IR WINDOW

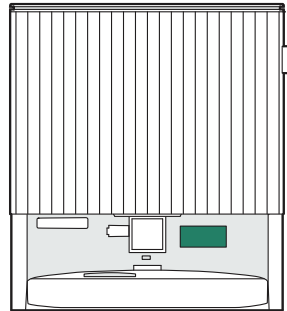

**NOTE:** To expose the charging contacts, press and hold the wheel switches.



**IMPORTANT:** Do not spray cleaning solution or water onto the sensors or sensor openings.

# Troubleshooting your robot

Your robot will tell you something is wrong by playing an audio alert and turning the light ring indicator red. Press the clean button for details. Check the iRobot Home App for further support.

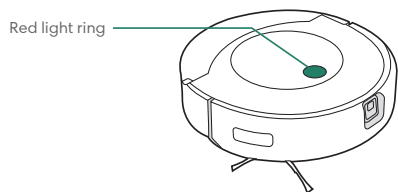

Red light ring

Low battery. Please charge.

## BATTERY SAFETY & SHIPPING

For best results, only use the iRobot Lithium Ion Battery that comes with your robot.



**WARNING:** Lithium ion batteries and products that contain lithium ion batteries are subject to stringent transportation regulations. If you need to ship this product for service, travel or any other reason, you **MUST** follow the below shipping instructions.

- Battery **MUST** be turned off before shipping.
- Turn off the battery by removing the robot from the charging station and holding down the clean button for 3 seconds with one wheel off the ground. All indicators will turn off.
- Package the robot securely for shipping.

If you need further assistance, contact our Customer Care team or visit <http://global.irobot.com>.

# Troubleshooting your dock

Your dock will tell you if something is wrong via the LED indicators on the top of the dock. If the dock is not performing as expected, check the iRobot Home app for errors.



## Clean Tank LED indicator

**Solid red:** clean tank empty, missing, or improperly installed

- 1 Fill the tank if it is empty with water or compatible cleaning solution.
- 2 Make sure the tank is installed properly.



## Dirty Tank LED indicator

**Solid red:** dirty tank full, missing, or improperly installed

- 1 Empty the tank if it is full.
- 2 Make sure the tank is installed properly.



## Dirt Disposal LED indicator

**Solid red:** bag full, missing, or improperly installed; debris drawer improperly installed

- 1 Replace bag if it is full or missing.
- 2 Make sure the bag is securely inserted and debris drawer is installed properly.

## Dirt Disposal LED indicator (continued)

**Flashing red:** clog in the dock evacuation path

- 1 With your robot on the dock, hold the Clean button down for 2-5 seconds or use the iRobot Home App to manually empty the bin  
Proceed to step 2 if the error is not resolved.
- 2 Remove the bin from your robot. Clear any debris from the bin and Debris Evacuation Port. Reinstall the bin.

Push down the Debris Evacuation Port on the dock, and ensure there are no obstructions in the path. Remove any visible debris.

Repeat step 1. Proceed to step 3 if the error is not resolved.

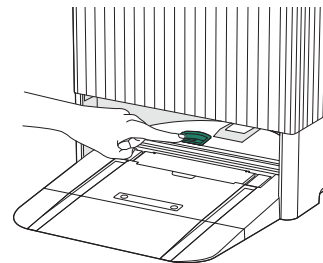
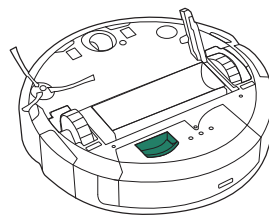

**3** Unplug the dock from the wall. Remove both tanks.

Place the dock on its side, remove the Debris Tube Access Panel, and inspect the tube for debris. If necessary, clear any debris from the tube

Replace the access panel, and repeat step 1. Contact Customer Care if the error is not resolved.

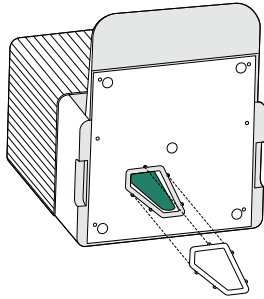

This product has been equipped with a thermal protector designed to protect against damage due to overheating. If the protector operates, the motor will stop running. If this happens, unplug the unit, allow to cool for 30 minutes, clear any obstructions from the evacuation port and evacuation tube, and plug the unit back in.

# Regulatory information

## FCC SUPPLIER'S DECLARATION OF CONFORMITY

iRobot Corporation

Roomba Combo® robot model: RCA-Y2  
AutoWash dock Model: ADL-N1

### Roomba Combo® robot

Contains FCC ID: 2AATL-6233E-UUB and contains IC: 12425A-6233EUUB  
This device complies with part 15 of the FCC Rules and ICES-003(B) / NMB-003(B).

Operation is subject to the following two conditions: (1) This device may not cause harmful interference, and (2) This device must accept any interference received, including interference that may cause undesired operation.

This device complies with Industry Canada license-exempt RSS standard(s).  
Operation is subject to the following two conditions: (1) This device may not cause interference, and (2) This device must accept any interference, including interference that may cause undesired operation of the device.

Changes or modifications not expressly approved by iRobot Corporation could void the user's authority to operate the equipment.

- This equipment has been tested and found to comply with the limits for a Class B digital device, pursuant to part 15 of the FCC Rules as well as CAN ICES-003(B) / NMB-003(B) Rules. These limits are designed to provide reasonable protection against harmful interference in a residential installation. This equipment generates, uses and can radiate radio frequency energy and, if not installed and used in accordance with the instructions, may cause harmful interference to radio communications. However, there is no guarantee that interference to radio communication will not occur in a particular installation. If this equipment does cause harmful interference to radio or television reception, which can be determined by turning the equipment off and on, the user is encouraged to try to correct the interference by one or more of the following measures:
  - Reorient or relocate the receiving antenna.
  - Increase the separation between the equipment and receiver.

- Connect the equipment into an outlet on a circuit different from that to which the receiver is connected.
- Consult the dealer or an experienced radio/TV technician for help.
- Under Industry Canada regulations, this radio transmitter may only operate using an antenna of a type and maximum (or lesser) gain approved for the transmitter by Industry Canada. To reduce potential radio interference to other users, the antenna type and its gain should be so chosen that the equivalent isotropically radiated power (e.i.r.p.) is not more than the necessary for successful communication.
- FCC Radiation Exposure Statement: This product complies with FCC §2.1091(b) for mobile device RF exposure limits, set forth for an uncontrolled environment and is safe for the intended operation as described in this manual. Per FCC requirements, maintain a distance of more than 8 inches (20 cm) between any person and the host device (Roomba robot).
- ISED Radiation Exposure Statement: This product complies with the Canadian Standard RSS-102 for mobile device RF exposure limits, set forth for an uncontrolled environment and is safe for the intended operation as described in this manual. Per ISED requirements, maintain a distance of more than 8 inches (20 cm) between any person and the robot.

### Brazil Radio

For more information, see the ANATEL website: [www.anatel.gov.br](http://www.anatel.gov.br). This equipment is not entitled to protection against harmful interference and must not cause interference in duly authorized systems.

**RCA-Y2:** This product contains the 6233E-UUB board Anatel approval code 19366-22-11470.

### Brazil Battery Recycling

Please be sure to dispose the battery properly when necessary. Please discard it at a recycling center or contact our Support Team for more information.

### Mexico Radio

For use in Mexico, the operation of this equipment is subject to the following two conditions: (1) this equipment or device may not cause harmful interference and (2) this equipment or device must accept any interference, including interference that may cause undesired operation.

RCA-Y2 IFT: NEIRRV23-27863

### Argentina Radio

RCA-Y2 CONTAINS

 C-28835

iRobot Corporation, 8 Crosby Drive, Bedford, MA 01730 USA

<https://global.irobot.com>

For battery recycling go to [call2recycle.org](http://call2recycle.org) or call  
1-800-822-8837.



## Para Mexico Solamente

### IMPORTADOR:

Nestek de México S.A. de C.V.

Calle Emiliano Zapata No. 42, Col. Ex Hacienda Doña Rosa, Lerma de Villada, Edo de Mex, C.P. 52000

Información a Clientes Tel: 01 800 716 7138

Correo: [irobot@nestek.com.mx](mailto:irobot@nestek.com.mx)

Horario de Atención: lunes a viernes de 9:00 am a 18:30 pm

### CENTRO AUTORIZADO DE SERVICIO:

TYSSA Tecnología y Servicio

Av. Guadalupe No. 150 Col. Guadalupe Proletaria Deleg. Gustavo A. Madero,

Ciudad de México, C.P. 07670

Tel: 01 800 5037 866

Correo: [servicio.irobot@gmail.com](mailto:servicio.irobot@gmail.com)

Horario de Atención: lunes a viernes de 9:00 am a 18:00 pm

**ONLY INCLUDE THIS PAGE IN ESXL DOCUMENTS**



©2024 iRobot Corporation, 8 Crosby Drive, Bedford, MA 01730 USA. All rights reserved.  
iRobot and Roomba Combo are registered trademarks of iRobot Corporation. Dirt Detect is a trademark of the iRobot Corporation. Wi-Fi and the Wi-Fi logo are registered trademarks of Wi-Fi Alliance. Apple and App Store are trademarks of Apple Inc., registered in the U.S. and other countries. Google Play is a trademark of Google LLC.



## Don't return to store. Let us help.

Download the iRobot Home app or visit [global.irobot.com](https://global.irobot.com) for product support or to contact your local support center. If you need further assistance in the US & Canada, call the US Customer Care team at (877) 855-8593.

### **iRobot USA Customer Care Hours**

Monday to Friday, 9AM — 9PM Eastern Time

Saturday and Sunday 9AM — 6PM Eastern Time



WC# 4842448 vB