



Questo manuale d'istruzione è fornito da trovaprezzi.it. Scopri tutte le offerte per [Logitech G735](#) o cerca il tuo prodotto tra le [migliori offerte di Cuffie e Microfoni](#)



Questo manuale d'istruzione è fornito da trovaprezzi.it. Scopri tutte le offerte per [Logitech G735](#) o cerca il tuo prodotto tra le [migliori offerte di Cuffie e Microfoni](#)

G735 HEADSET | G735 耳机麦克风

Wireless Gaming Headset
无线游戏鼠标

SETUP GUIDE | 设置指南



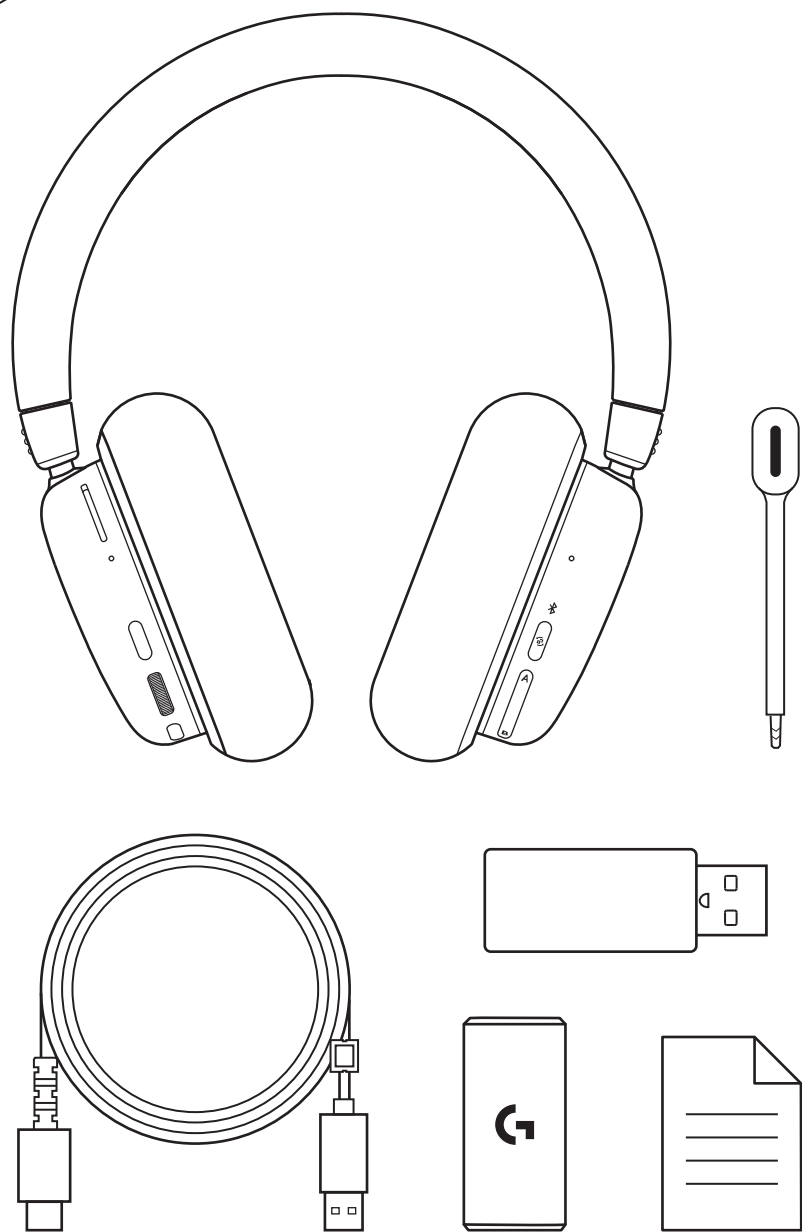

ENGLISH 3

简体中文 12

繁體中文 21

한국어 30

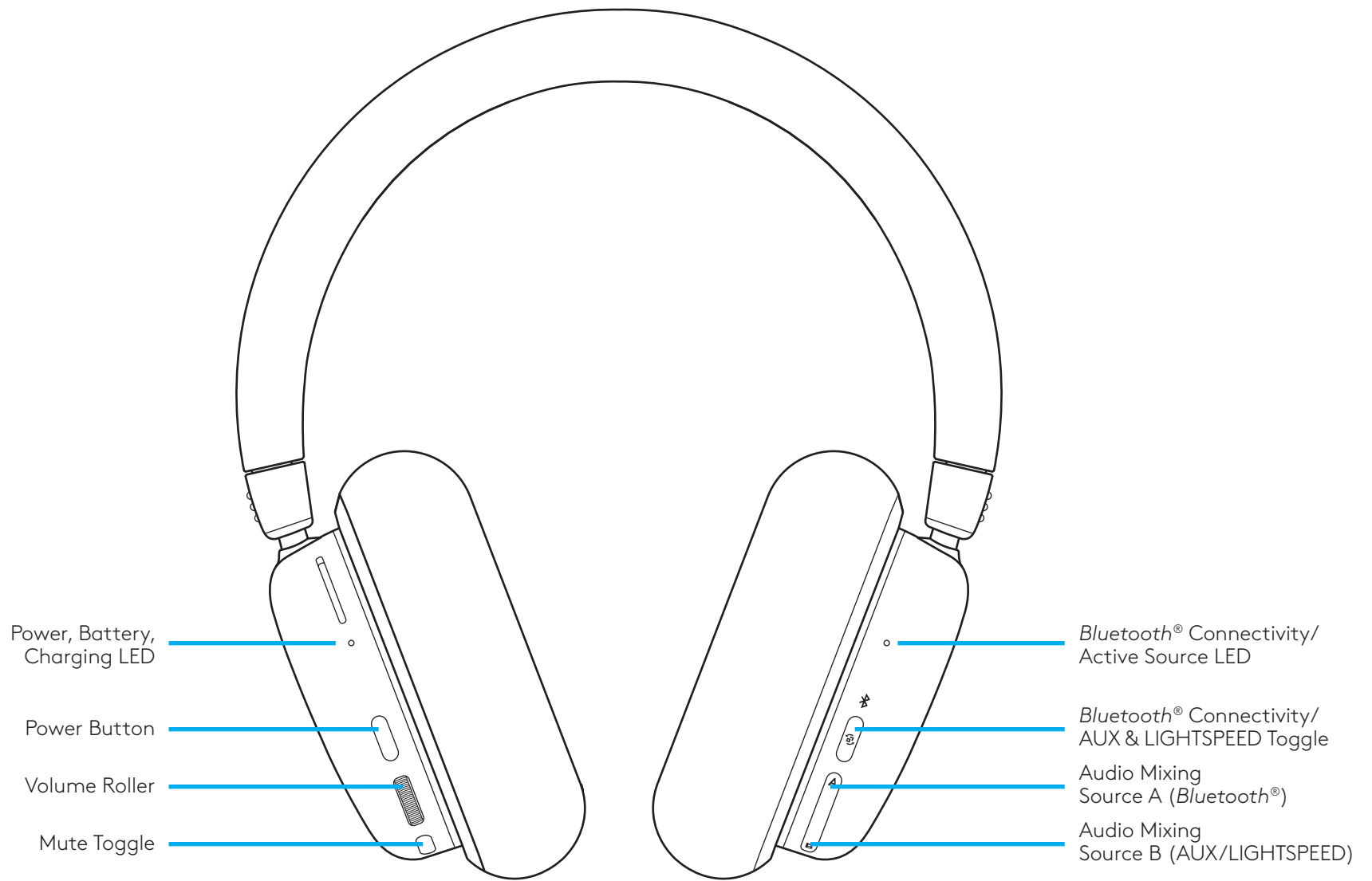

SETUP INSTRUCTIONS

- 1 Insert the microphone connector into the port on the left ear cup. It is designed to fit in one way.
- 2 Turn on the G735 headset by pressing and holding the power button located on the left ear cup for 3 seconds.

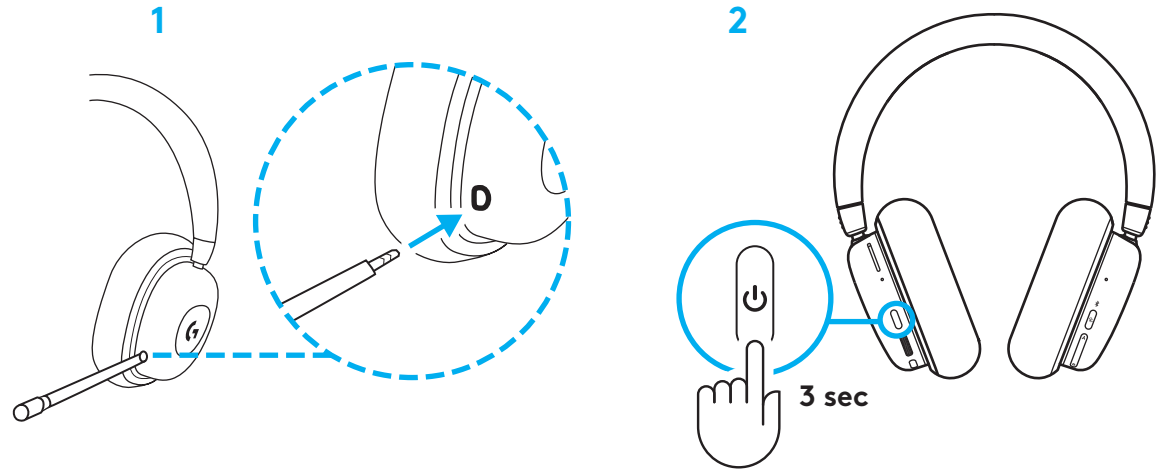

- 3 Insert the LIGHTSPEED receiver, with extender and cable into the PC USB port. Receiver can be used without the extender and cable by inserting it directly into a USB port if desired.

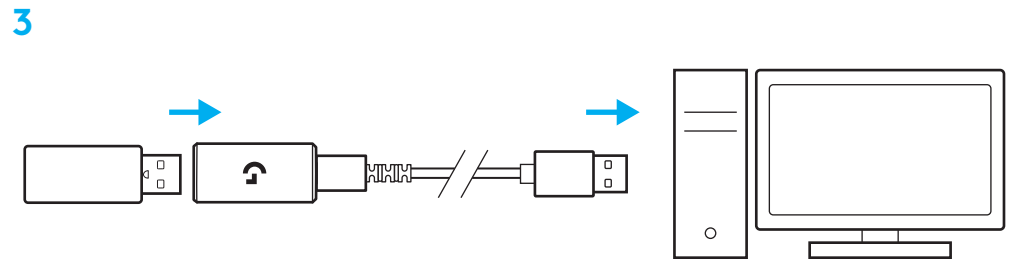

- 4 Download and install G HUB software to your PC/MAC for the best gaming experience (G HUB has onboarding story for features). Go to www.logitechG.com/ghub



BLUETOOTH® CONNECTIVITY

- 1 Turn on the G735 headset by pressing and holding the power button for 3 seconds.
- 2 Press Connectivity button to select *Bluetooth*® – the indicator light above will turn blue.

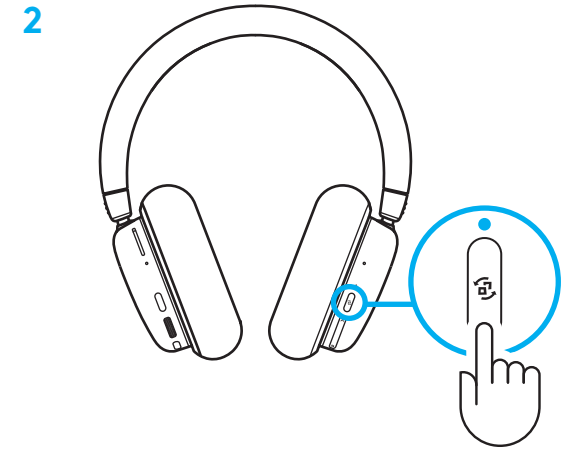
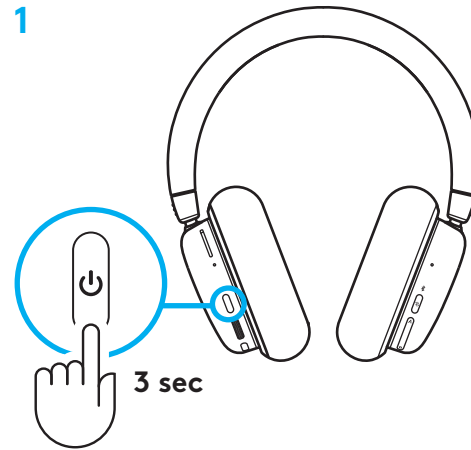

- 3 Press and hold Connectivity button for 3 seconds to initiate pairing mode. The blue light will flash quickly for up to 3 minutes.
- 4 Follow *Bluetooth*® connection for your device to pair with the headset.

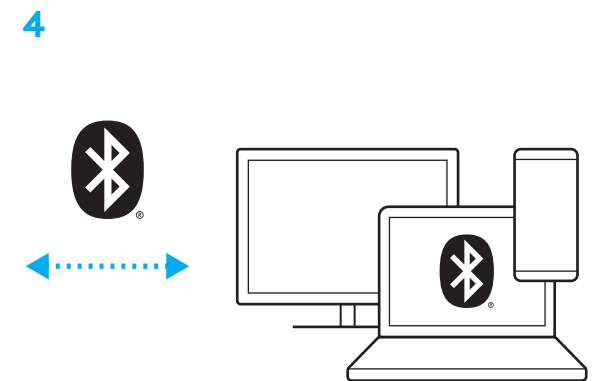
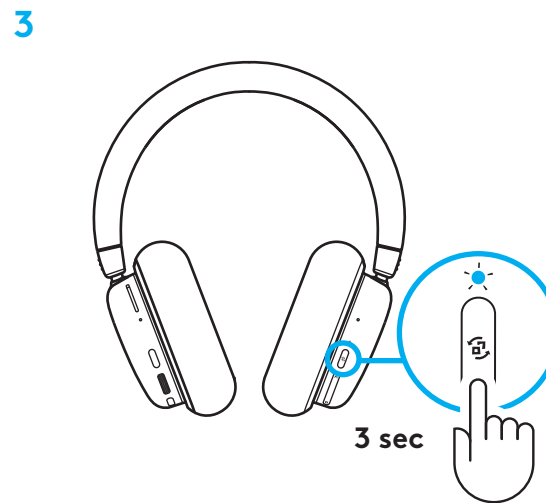

Volume

Adjust volume with the roller on the left ear cup.
This adjusts the headset's total volume,
not the volumes of your sources.

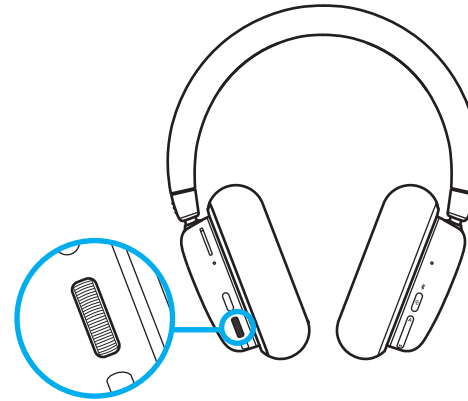

Mute/Unmute Microphone

Press the mute button located below the volume on
the left ear cup. This will mute the microphone.

When muted, the cosmetic RGB will temporarily
flash red.

There will be a mute sound notification.

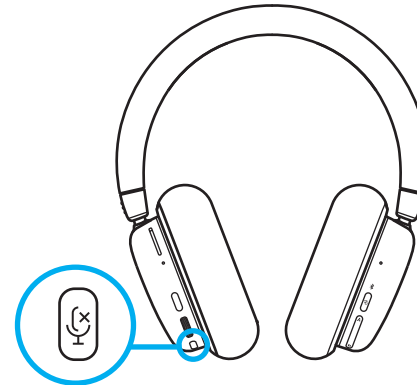

Audio Source Options

G735 can connect to and mix multiple audio sources at once:

- LIGHTSPEED audio
- *Bluetooth*[®] audio
- Auxiliary audio via 3.5 mm cable (not supplied)
- LIGHTSPEED + *Bluetooth*[®]
- Auxiliary + *Bluetooth*[®]

Toggling LIGHTSPEED/AUX & *Bluetooth*[®]

After connecting to both LIGHTSPEED and AUX, toggle between LIGHTSPEED and AUX options by pressing the connectivity button on the right ear cup.

When LIGHTSPEED is active, the LED light above the button will light up cyan for 5 seconds.

When AUX is active, the LED light will light up white for 5 seconds.

AUX only available when a cable is connected.

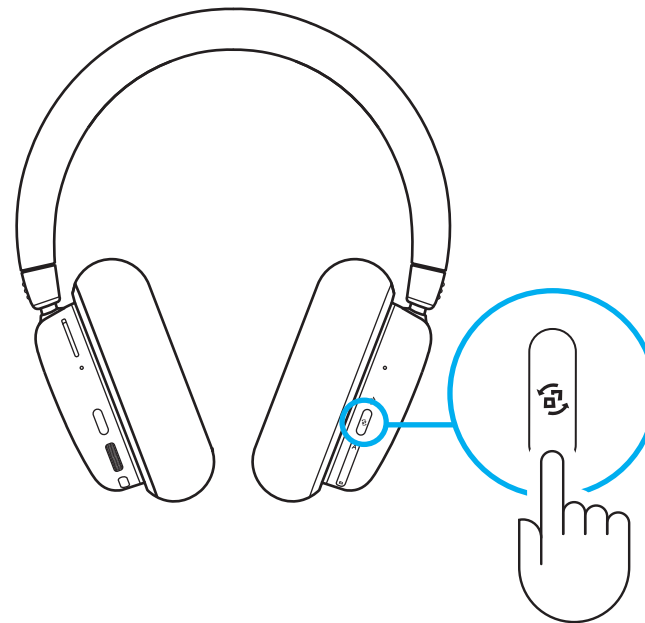

Mixing LIGHTSPEED/AUX & Bluetooth®

After connecting to 2 sources LIGHTSPEED or AUX, and Bluetooth®:

- To adjust source balance, press the up and down buttons on the right ear cup to paddle.
- Pressing up increases Bluetooth® source
- Pressing down increases the active source (LIGHTSPEED or AUX)
- To reset to equal levels, press and hold both buttons for 3 seconds.

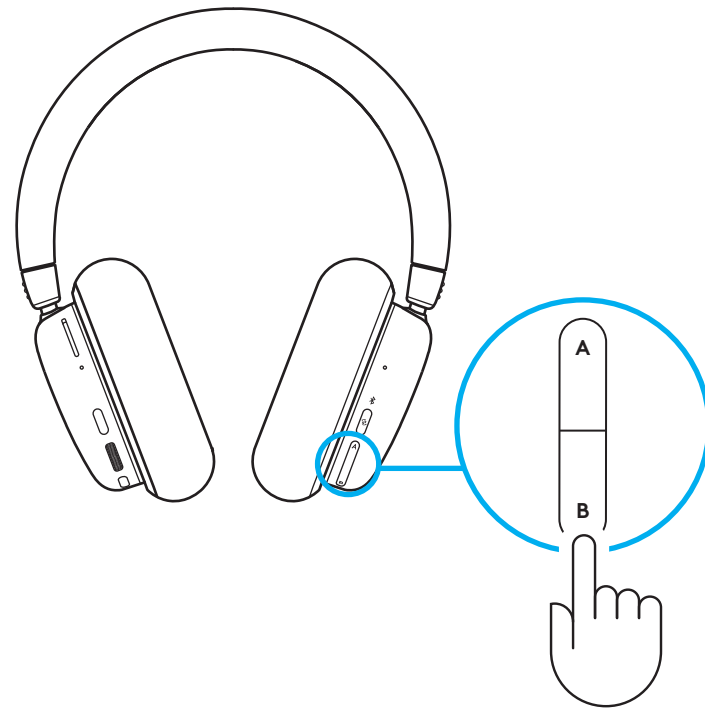

Powering Off

Turn off G735 headset by pressing the power button on the left ear cup for 3 seconds.

The headset lighting will turn off after a short lighting animation. There will be a sound notification indicating power off.

If the headset is inactive for 10 minutes, it will automatically shut off.

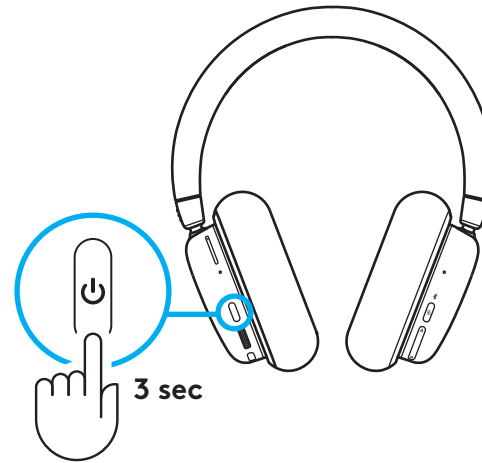

Checking Battery Status

To check the battery status, short press the power button on the left ear cup.

The LED will be:

- Green when it's over 30% battery
- Red when it's under 30% battery
- Blink red when it's under 15% battery



 = >30% battery

 = <30% battery

 = <15% battery

Lighting ON/OFF

To turn off the cosmetic lighting, double press the power button on the left ear cup.

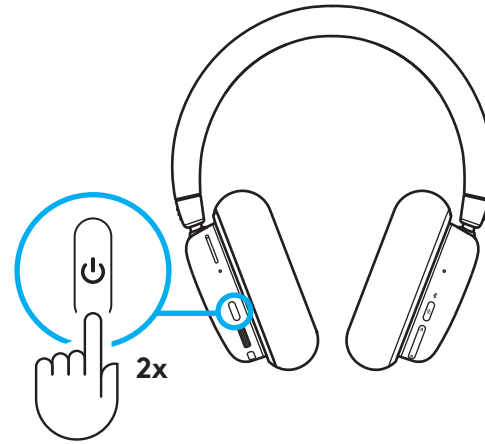

Charging the Battery

Plug the USB-C cable into the port at the bottom of the left ear cup, located between the microphone and AUX connector ports. Connect the USB-A end into a USB port on a PC or USB charging adapter (not included).

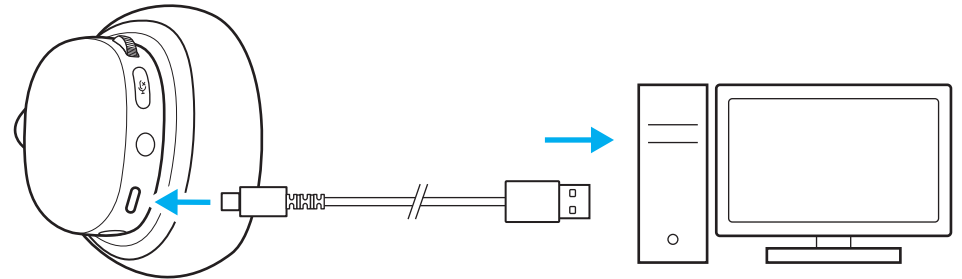

The power light will illuminate green and pulse while charging.

The power light glows red for low battery (<30%).

The G735 headset ships with about 60% charge. We recommend charging completely before use.

Changing Accessory Cups

Ear pads can be removed and replaced.



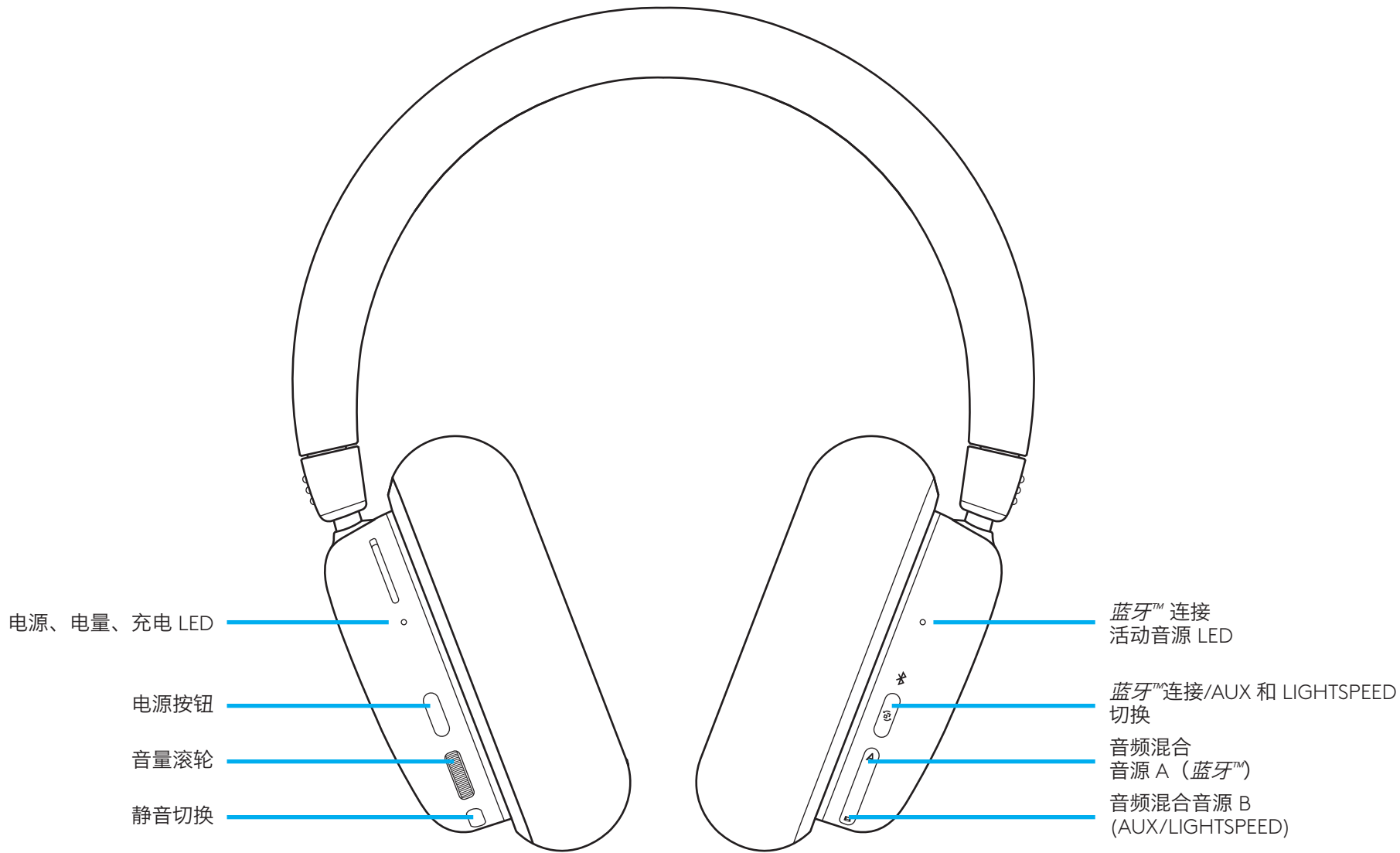

设置说明

- 1 将麦克风插头插入左耳罩的端口中。采用固定式设计。
- 2 按住左耳罩上的电源按钮 3 秒钟，启动 G735 耳机麦克风。

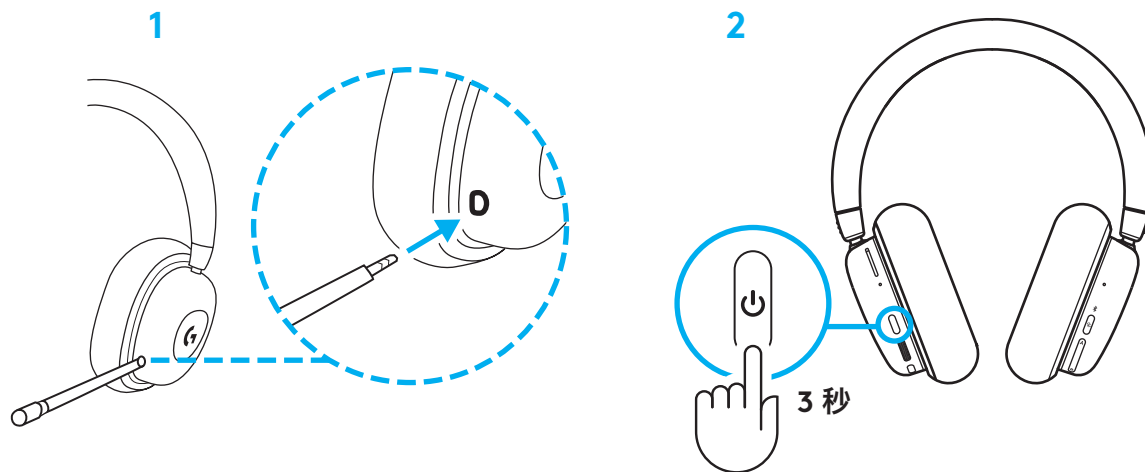

- 3 将 LIGHTSPEED 接收器插入扩展器和延长线，并插入 PC USB 端口。可以根据需要直接将接收器插入 USB 端口，无需扩展器和延长线即可使用。

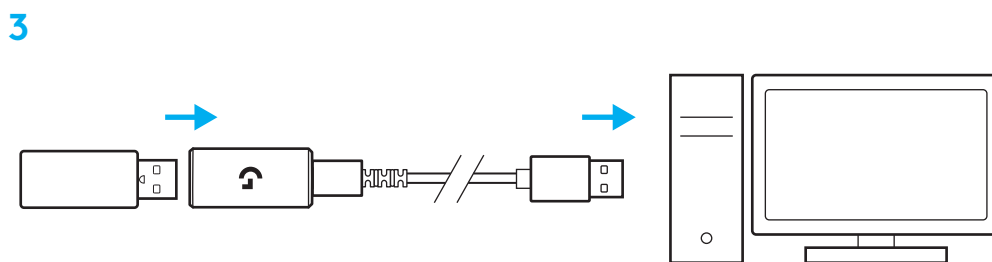

- 4 下载 G HUB 软件并安装到 PC/MAC，获得更出色的游戏体验（G HUB 包含有关各项功能的入门介绍）。访问 www.logitechG.com/ghub。



蓝牙™ 连接

1 按住电源按钮 3 秒钟，启动 G735 耳机麦克风。

2 按下连接按钮选择蓝牙™ - 上方的指示灯将变为蓝色。

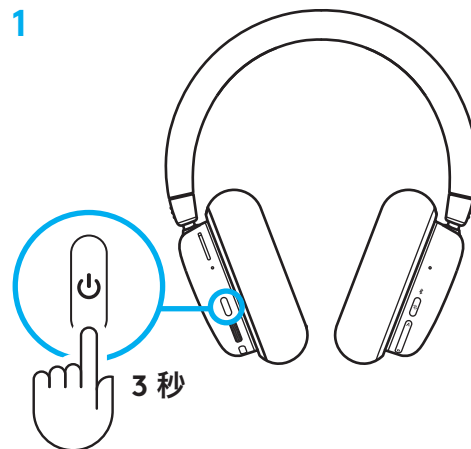

3 按住连接按钮 3 秒钟，启动配对模式。指示灯将快速闪烁蓝色最长 3 分钟。

4 通过蓝牙™ 连接将设备与耳机麦克风配对。

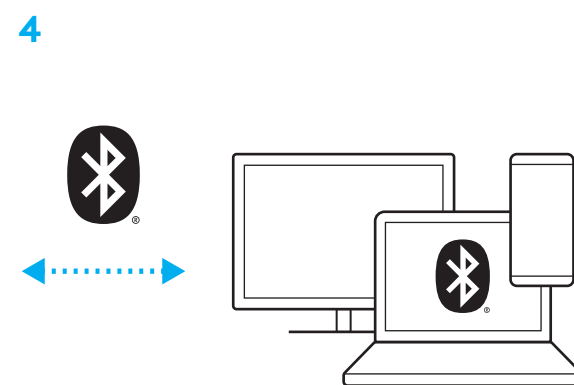
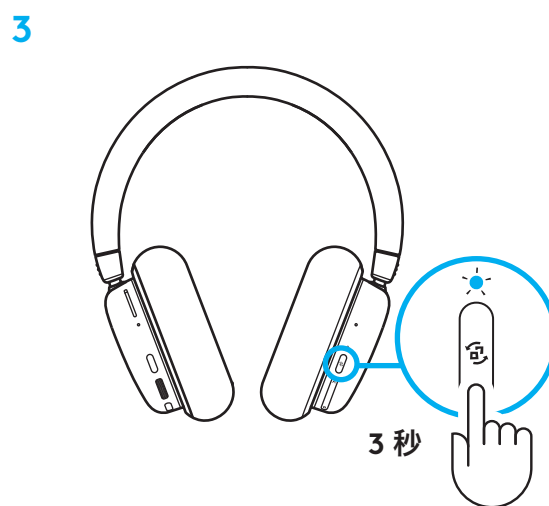

音量

使用左耳罩上的滚轮调节音量。这会调整耳机麦克风的总音量，而非音源的音量。

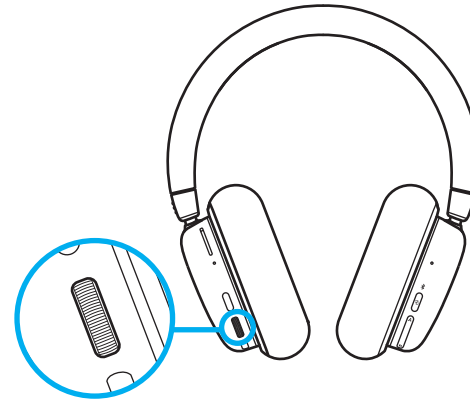

麦克风静音/取消静音

按下位于左耳罩音量下方的静音按钮。这将使麦克风静音。

静音时，RGB 炫光将暂时闪烁红色。

会有静音通知。

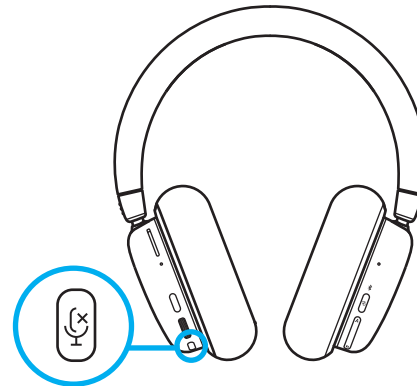

音频源选项

G735 可以同时连接和混合多个音频源:

- LIGHTSPEED 音频
- 蓝牙™ 音频
- 通过 3.5 毫米线缆 (需另购) 输入的辅助音频
- LIGHTSPEED + 蓝牙™
- 辅助输入 + 蓝牙™

切换 LIGHTSPEED/AUX 与 蓝牙™

连接到 LIGHTSPEED 和 AUX 后, 按下右耳罩的连接按钮, 在 LIGHTSPEED 和 AUX 之间切换。

当 LIGHTSPEED 激活时, 按钮上方的 LED 灯将亮起青色 5 秒钟。

当 AUX 激活时, LED 灯将亮起白色 5 秒钟。

AUX 仅在连接线缆时可用。

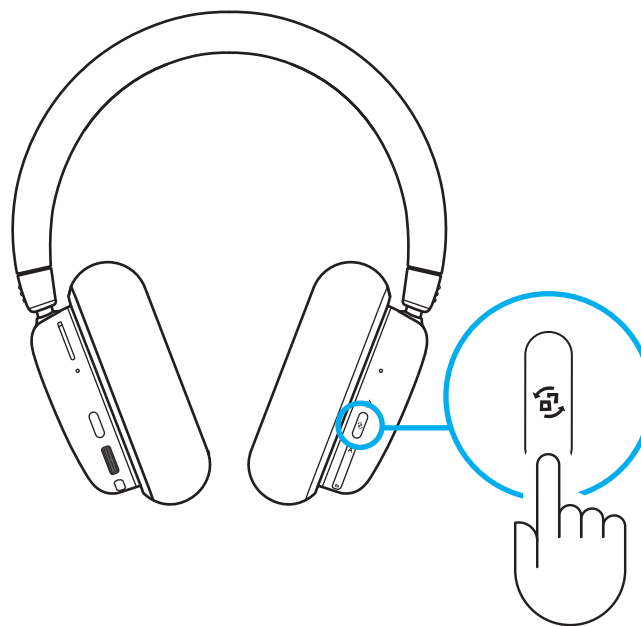

混合 LIGHTSPEED/AUX 与蓝牙™

连接到 2 个音源 LIGHTSPEED 或 AUX 与蓝牙™ 后：

- 要调节音源平衡，请按右耳罩的向上和向下按钮进行调节。
- 按向上按钮增加蓝牙™ 音源
- 按向下按钮增加活动音源（LIGHTSPEED 或 AUX）
- 要重置为平衡，请同时按住两个按钮 3 秒钟。

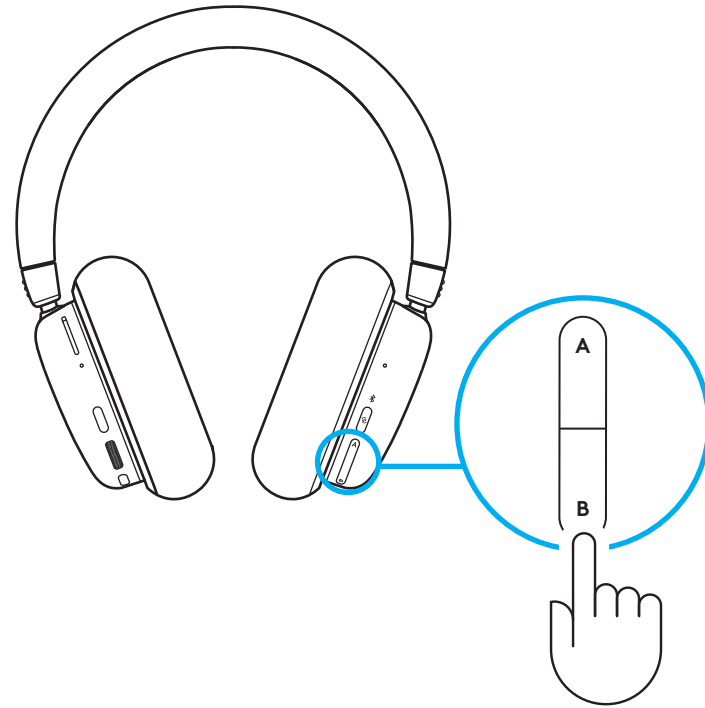

关机

按下左耳罩的电源按钮 3 秒钟，关闭 G735 耳机麦克风。

短暂的灯光动画后，耳机麦克风灯光将关闭。将有声音提示电源已关闭。

耳机麦克风闲置 10 分钟后将自动关闭。

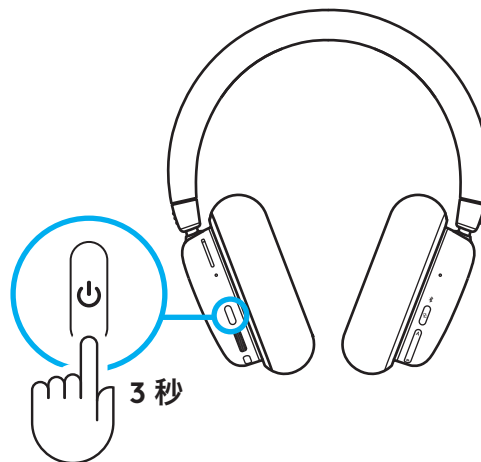

检查电池状态

要检查电池状态，请短按左耳罩上的电源按钮。

LED 状态：

- 绿色：电量超过 30%
- 红色：电量低于 30%
- 闪烁红色：电量低于 15%



 =>30% 电量

 =<30% 电量

 =<15% 电量

灯光开关

要关闭炫光，请按两次左耳罩上的电源按钮。

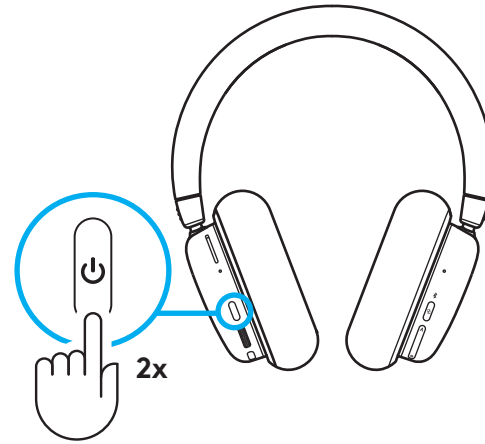

充电

将 USB-C 线缆插入左耳罩底部的端口，该端口位于麦克风和 AUX 端口之间。将 USB-A 端连接至 PC 的 USB 端口或 USB 充电适配器（需另购）。

电源指示灯为绿色，并在充电时闪烁。

电量不足 (<30%) 时，电源指示灯亮起红色。

G735 耳机麦克风预装载约 60% 的电量。我们建议在使用前为其完全充电。

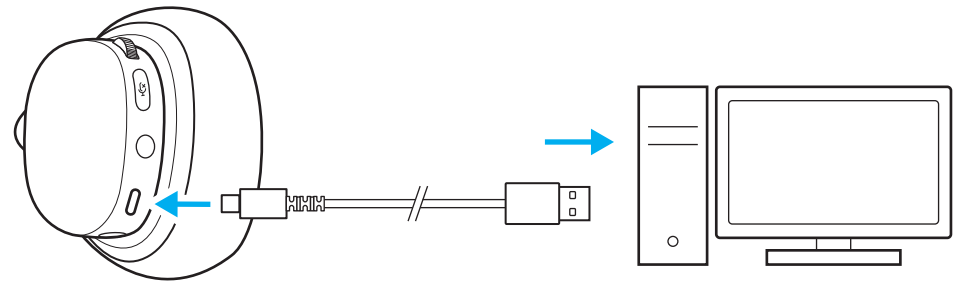

更换配件耳罩

耳垫可以拆卸和更换。



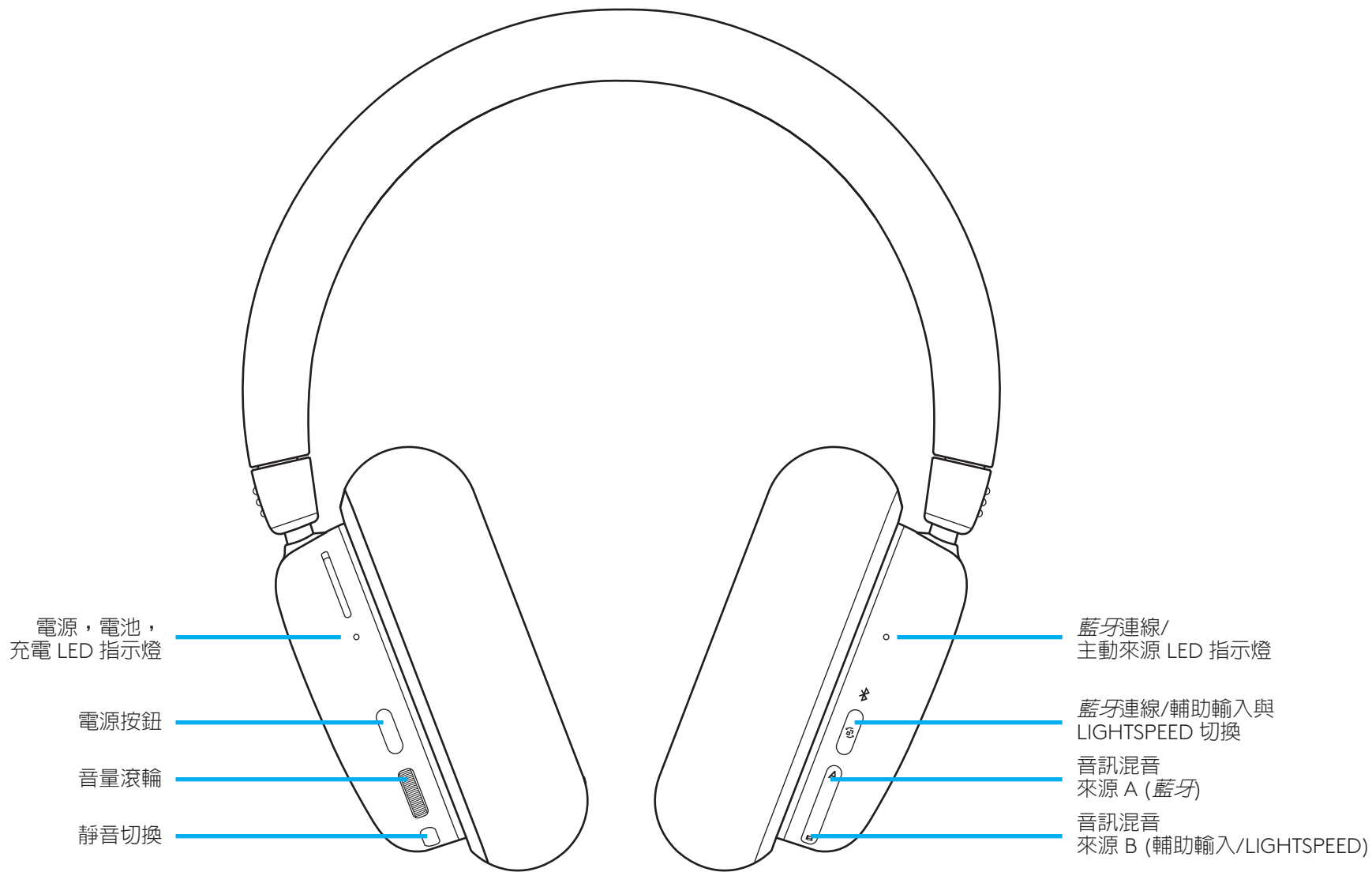

電源，電池，
充電 LED 指示燈

電源按鈕

音量滾輪

靜音切換

藍牙連線/
主動來源 LED 指示燈

藍牙連線/輔助輸入與
LIGHTSPEED 切換

音訊混音
來源 A (藍牙)

音訊混音
來源 B (輔助輸入/LIGHTSPEED)

設定說明

- 1 將麥克風接頭插入到左耳罩的連接埠。其設計為只能從一個方向插入。
- 2 按住位於左耳罩上的電源按鈕 3 秒，開啓 G735 耳機麥克風電源。

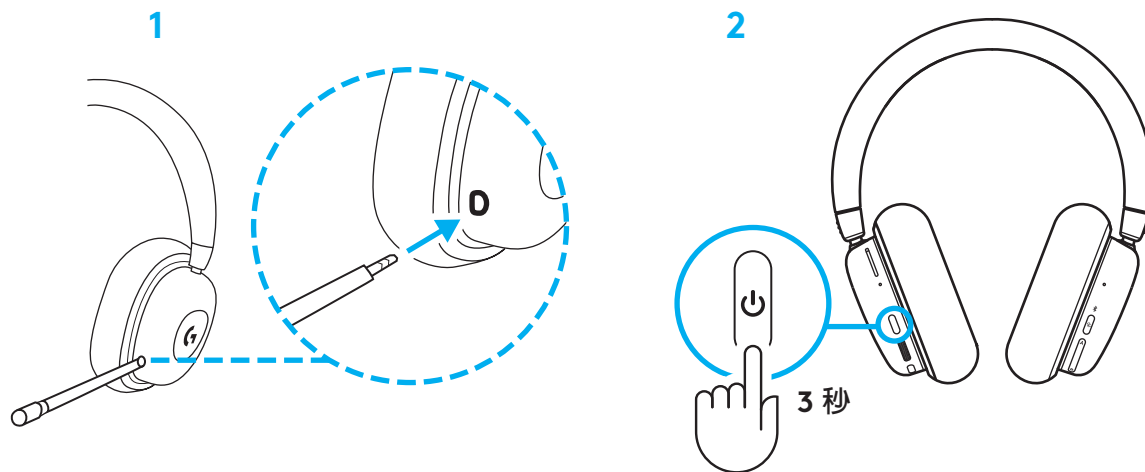

- 3 將附有延長器與連接線的 LIGHTSPEED 接收器插入 PC USB 連接埠。如果想要如此做的話，可以不附帶延長器和連接線，直接將接收器插入 USB 連接埠。

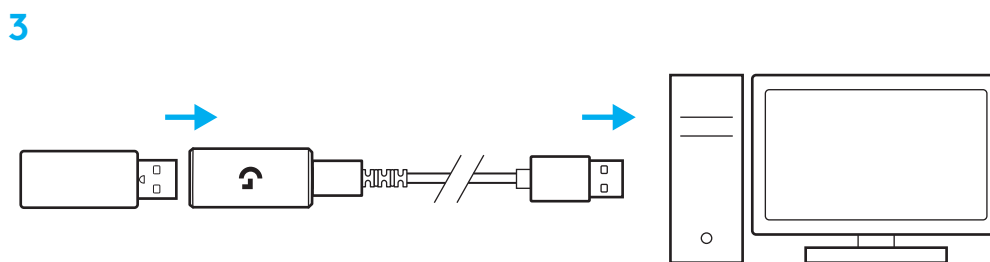

- 4 下載並安裝 G HUB 軟體到您的 PC/MAC，以獲得最佳遊戲體驗 (G HUB 提供有功能的介紹說明)。
前往 www.logitechG.com/ghub



藍牙連線

- 1 按住電源按鈕 3 秒，開啓 G735 耳機麥克風電源。
- 2 按下連線按鈕以選擇藍牙-上方的指示燈會亮起藍燈。

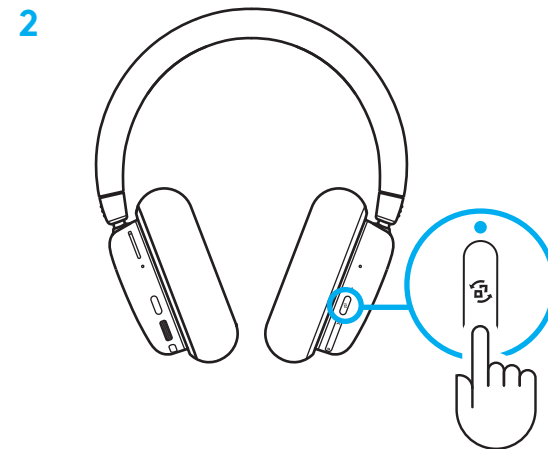
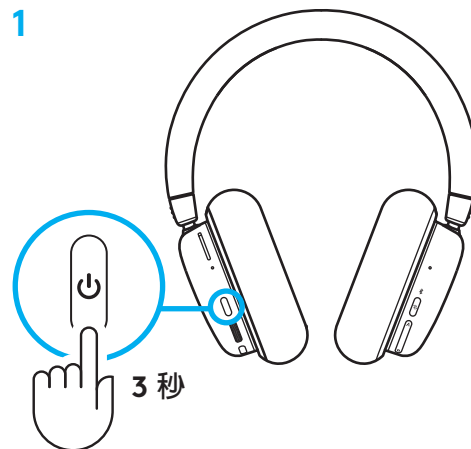

- 3 按住連線按鈕 3 秒，啓動配對程序。藍燈會快速閃爍 3 分鐘。
- 4 使用您裝置的藍牙連線功能與耳機麥克風配對。

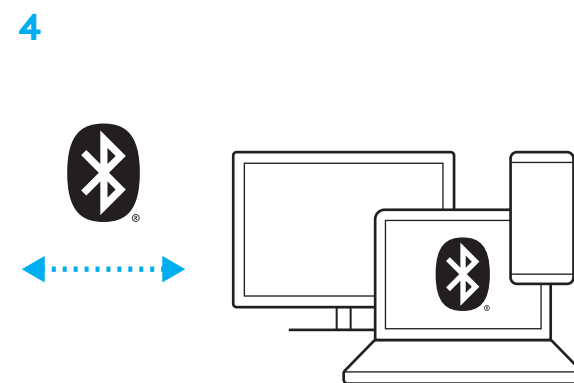
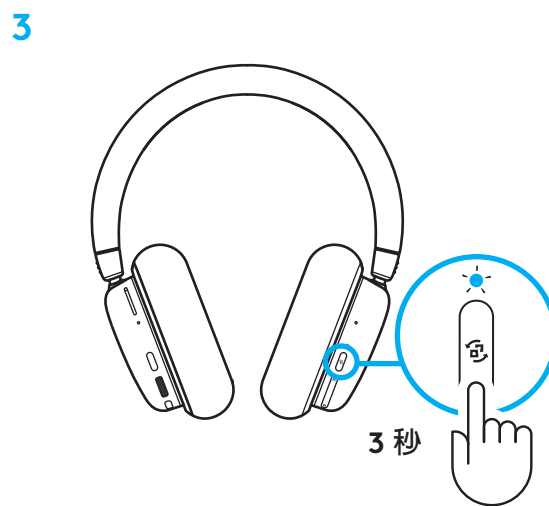

音量

使用左耳罩的滾輪調整音量。這會調整耳機麥克風的整體音量，而不是來源的音量。

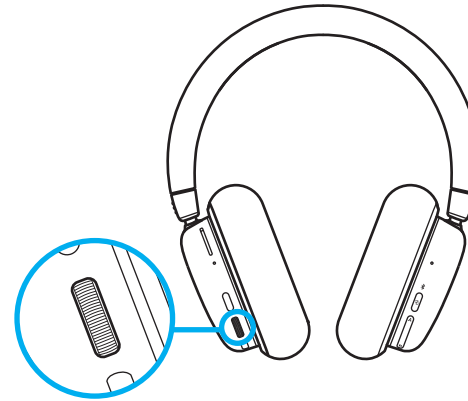

麥克風靜音/取消靜音

按住位於左耳罩音量滾輪下方的靜音按鈕。這會將麥克風靜音。

靜音後，裝置 RGB 燈光會暫時閃爍紅燈。

這是作為靜音通知之用。

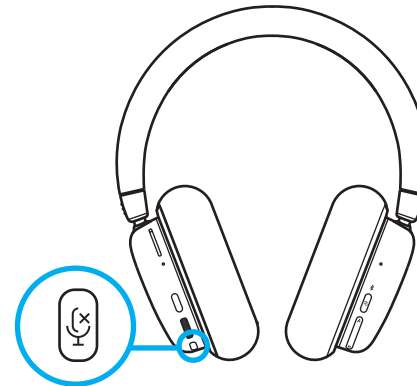

音訊來源選項。

G735 可以同時連線到多個來源並進行混音。

- LIGHTSPEED 音訊
- 藍牙音訊
- 透過 3.5 公釐連接線 (未隨附) 的輔助音訊
- LIGHTSPEED + 藍牙
- 輔助輸入 + 藍牙

切換 LIGHTSPEED/輔助輸入與藍牙

連線到 LIGHTSPEED 和 AUX 之後，按住右耳罩上的連線按鈕可在 LIGHTSPEED 和輔助輸入選項間切換。

啓用 LIGHTSPEED 時，按鈕上方的 LED 指示燈會亮起青燈 5 秒。

啓用輔助輸入時，LED 指示燈會亮起白燈 5 秒。

僅在連接上連接線時才能使用輔助輸入。

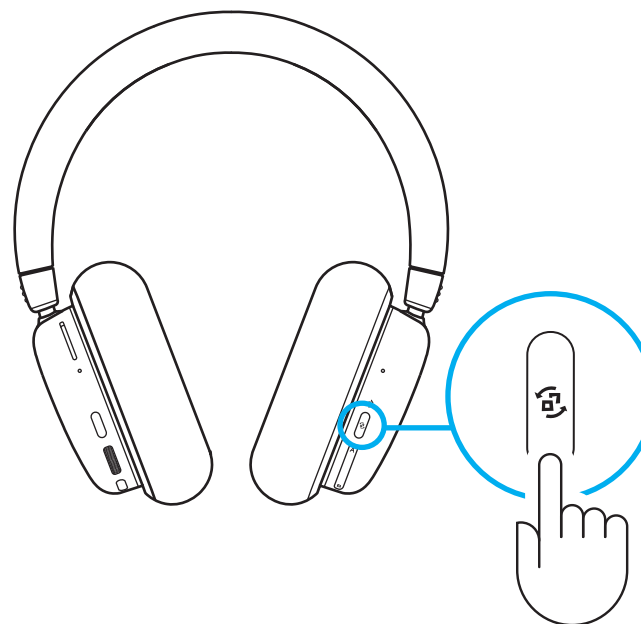

混音 LIGHTSPEED/輔助輸入與藍牙

連線到 2 種來源：LIGHTSPEED 或輔助輸入，以及藍牙之後：

- 若要調整來源平衡，可上下按右耳罩的上下按鈕進行調整。
- 按向上按鈕可增加藍牙來源
- 按向下按鈕可增加主動來源 (LIGHTSPEED 或 AUX)
- 若要重設平衡等級，按住兩個按鈕 3 秒。

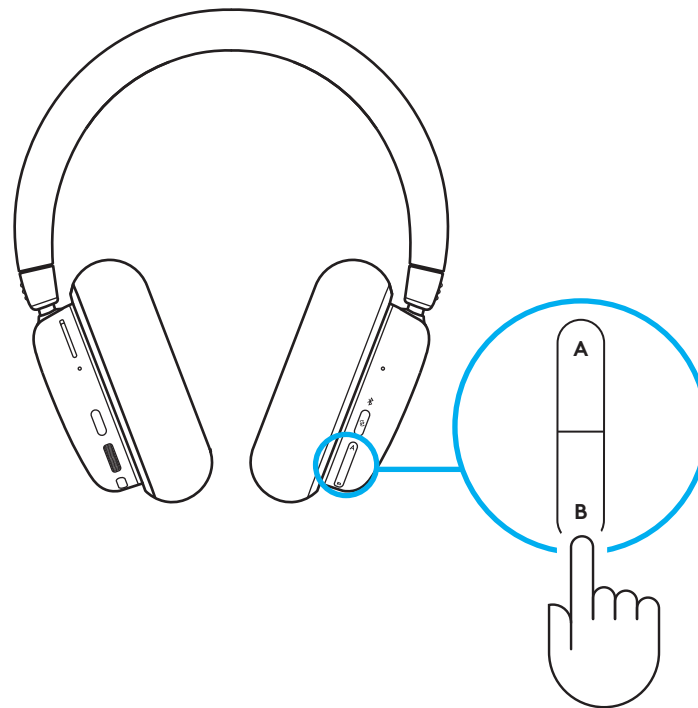

關閉電源

按住左耳罩上的電源按鈕 3 秒，關閉 G735 耳機麥克風電源。

耳機麥克風的指示燈會在短暫的動態指示燈動作後熄滅。會發出通知音效指明電源關閉。

如果耳機麥克風在 10 分鐘內沒有動作，則會自動關閉電源。

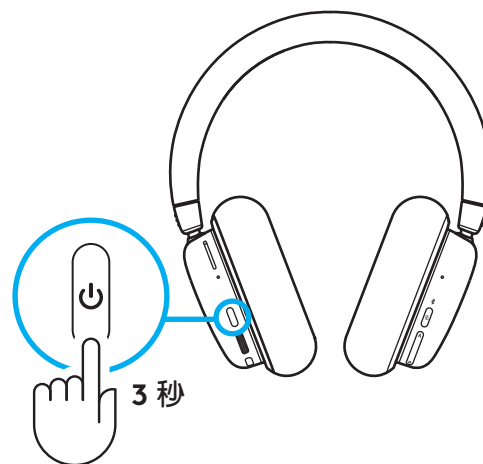

檢查電池狀態

若要檢查電池狀態，請短按左耳罩上的電源按鈕。

LED 指示燈會亮起下列燈號：

- 電池電量超過 30% 時亮起綠燈
- 電池電量低於 30% 時亮起紅燈
- 電池電量低於 15% 時閃爍紅燈



 => 30% 電池電量

 =< 30% 電池電量

 =< 15% 電池電量

燈光開啓/關閉

若要開啓/關閉裝飾燈光，請按兩下左耳罩上的電源按鈕。

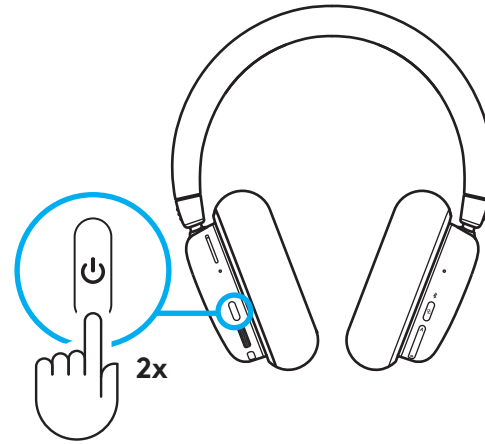

為電池充電

將 USB-C 連接線插入位於左耳罩底部，介於麥克風和輔助輸入接頭連接埠之間的連接埠。將 USB-A 端連接到 PC 或 USB 充電器 (未隨附) 的 USB 連接埠。

電源指示燈會亮起綠燈，並在充電期間閃爍。

電源指示燈亮起紅燈表示電池電量偏低 (<30%)。

G735 耳機麥克風出貨時具有約 60% 電量。建議在使用之前先完全充電。

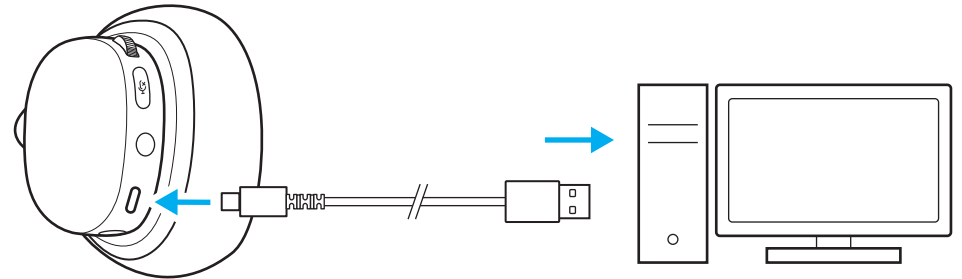

更換配件耳罩

耳墊可以取下與更換。



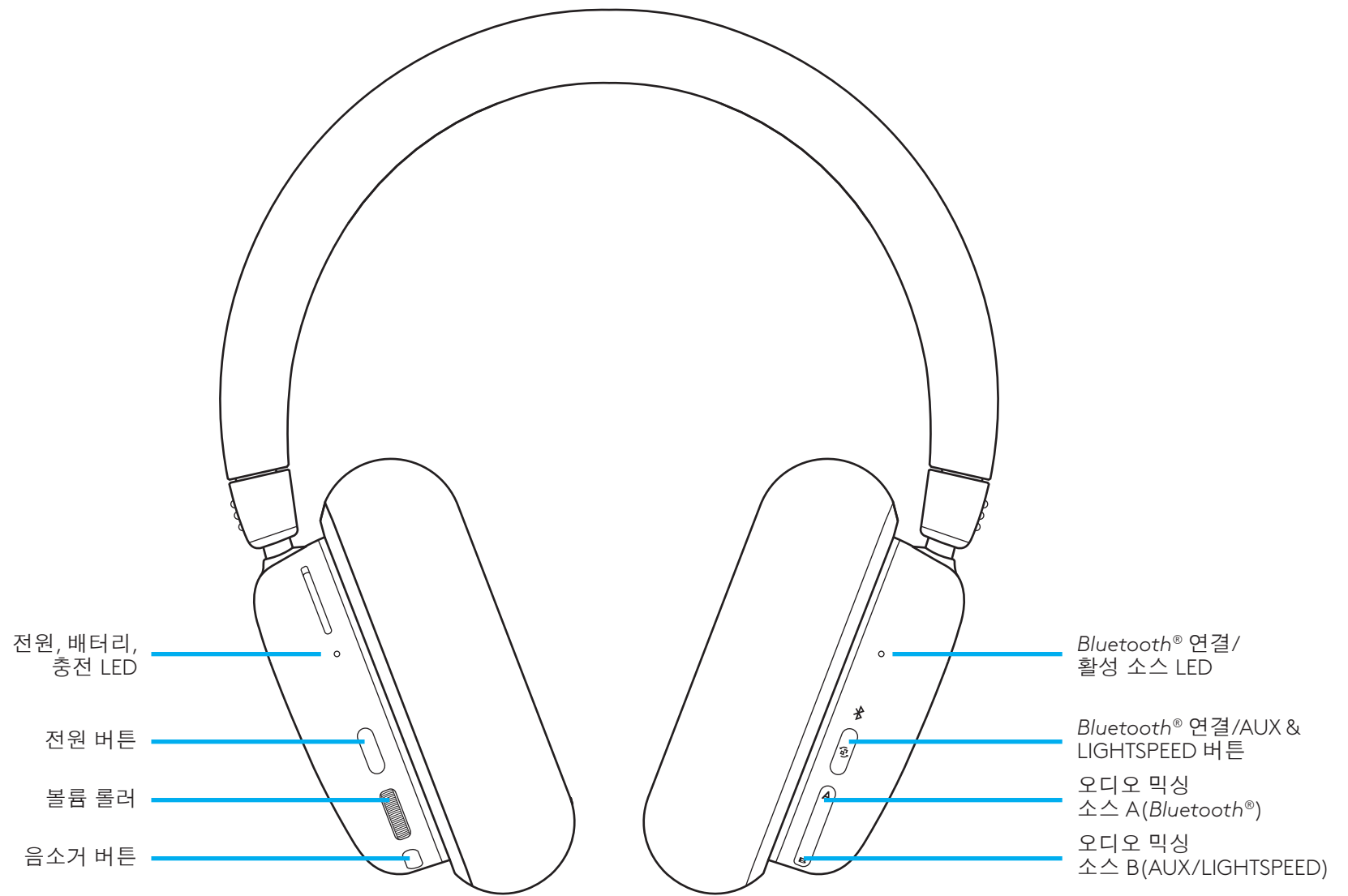

설치 지침

- 1 마이크 커넥터를 왼쪽 이어컵의 포트에 연결합니다. 한쪽 방향으로만 연결되도록 설계되었습니다.
- 2 왼쪽 이어컵에 있는 전원 버튼을 3초 동안 길게 눌러 G735 헤드셋을 켭니다.

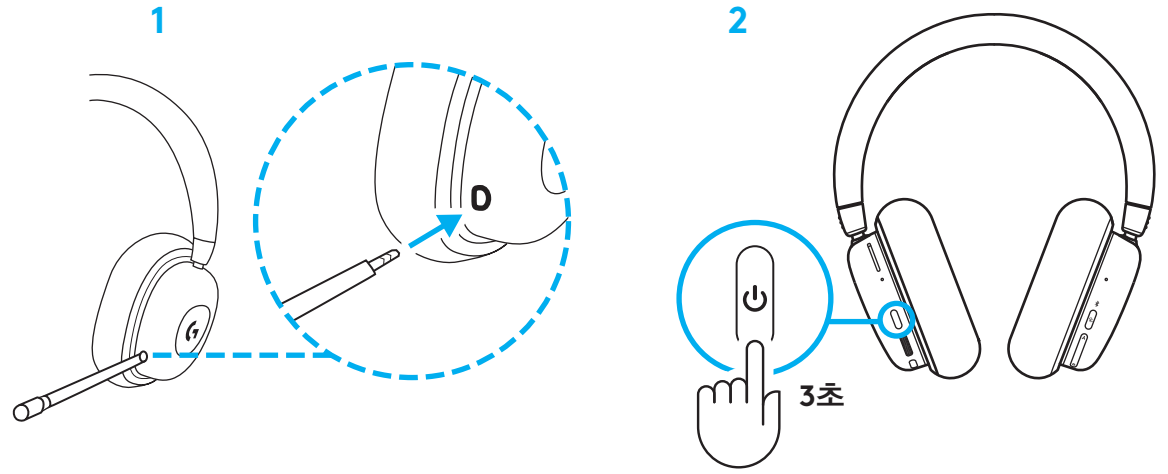

- 3 연장 케이블과 충전/데이터 케이블을 PC USB 포트에 연결하여 LIGHTSPEED 수신기를 연결합니다. 원하는 경우, USB 포트에 수신기를 직접 연결하여 연장 케이블과 충전/데이터 케이블 없이 사용할 수 있습니다.

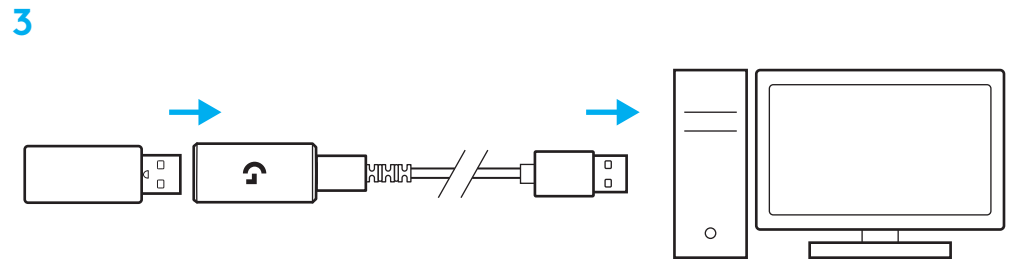

- 4 최고의 경험을 위해 PC/MAC에 G HUB 소프트웨어를 다운로드 및 설치합니다 (G HUB에서 기능 확인 가능).
www.logitechG.com/ghub로 이동



BLUETOOTH® 연결

- 1 전원 버튼을 3초 동안 길게 눌러 G735 헤드셋을 켭니다.
- 2 연결 버튼을 눌러 Bluetooth® 선택 - 위에 있는 표시등이 파란색으로 켜집니다.

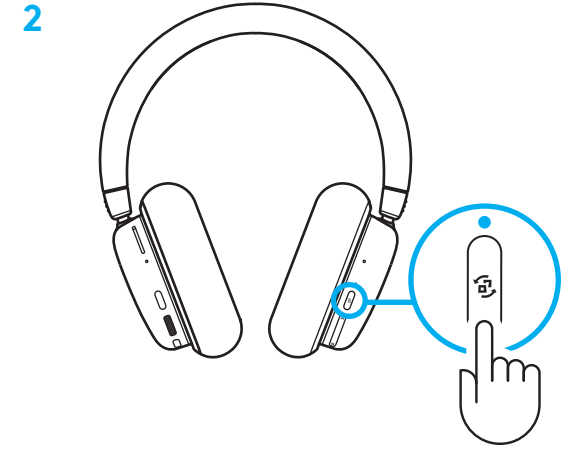
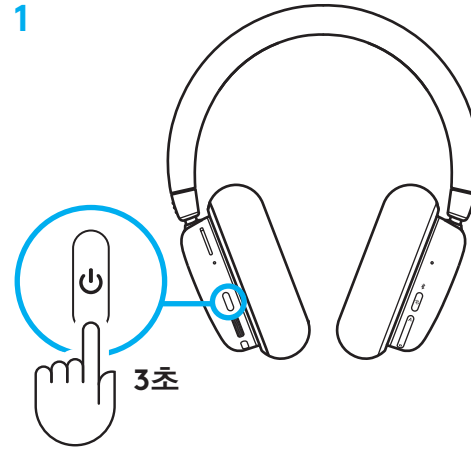

- 3 3초 동안 연결 버튼을 길게 눌러 페어링 모드를 시작합니다. 파란색 표시등이 최대 3분 동안 빠르게 깜박입니다.
- 4 장치의 Bluetooth® 연결을 따라 헤드셋과 페어링하십시오.

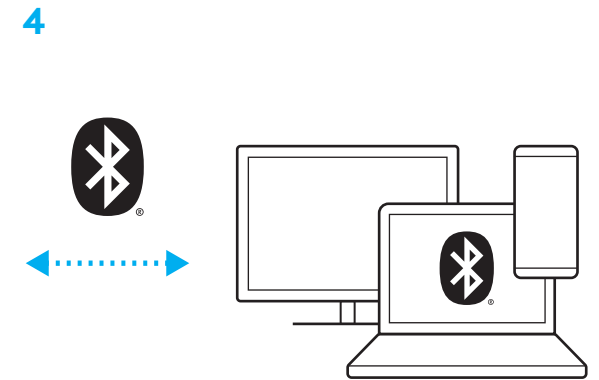
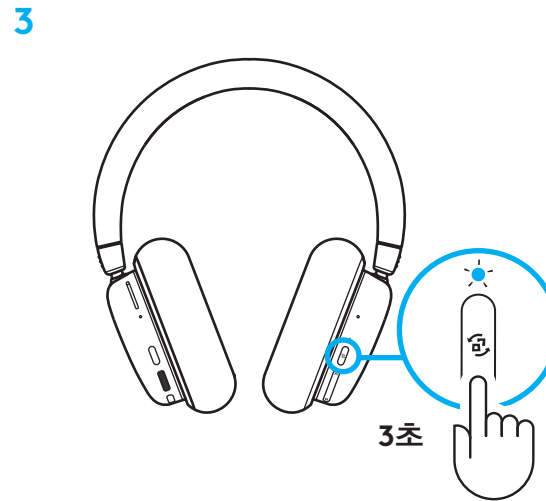

볼륨

왼쪽 이어컵의 롤러로 볼륨을 조절합니다. 이 경우 오디오 소스가 아닌 헤드셋의 음량이 조절됩니다.

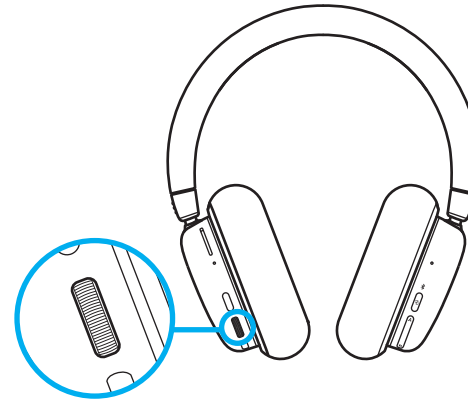

마이크 음소거/음소거 해제

왼쪽 이어컵 볼륨 아래의 음소거 버튼을 누릅니다. 이 경우 마이크가 음소거됩니다.

음소거되면 장식 RGB가 일시적으로 빨간색으로 깜박입니다.

음소거 사운드 알림이 있습니다.

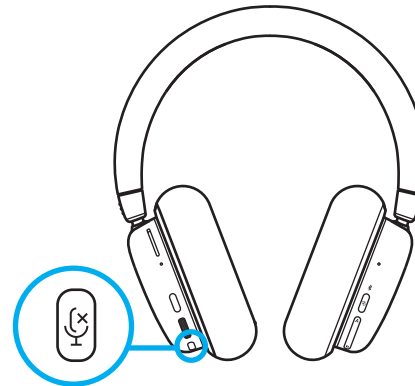

오디오 소스 옵션

G735는 한 번에 여러 오디오 소스에 연결 및 믹스가 가능합니다.

- LIGHTSPEED 오디오
- Bluetooth® 오디오
- 3.5mm 케이블(미제공) 이용 보조 오디오
- LIGHTSPEED + Bluetooth®
- 보조 + Bluetooth®

LIGHTSPEED/AUX 및 Bluetooth® 버튼

LIGHTSPEED 및 AUX에 둘 다 연결하면 오른쪽 이어컵의 연결 버튼을 눌러 LIGHTSPEED 및 AUX 옵션을 전환할 수 있습니다.

LIGHTSPEED가 활성화되면 버튼 위에 있는 LED 표시등이 5초 동안 청록색으로 켜집니다.

AUX가 활성화되면 LED 표시등이 5초 동안 흰색으로 켜집니다.

AUX는 케이블 연결 시에만 이용할 수 있습니다.

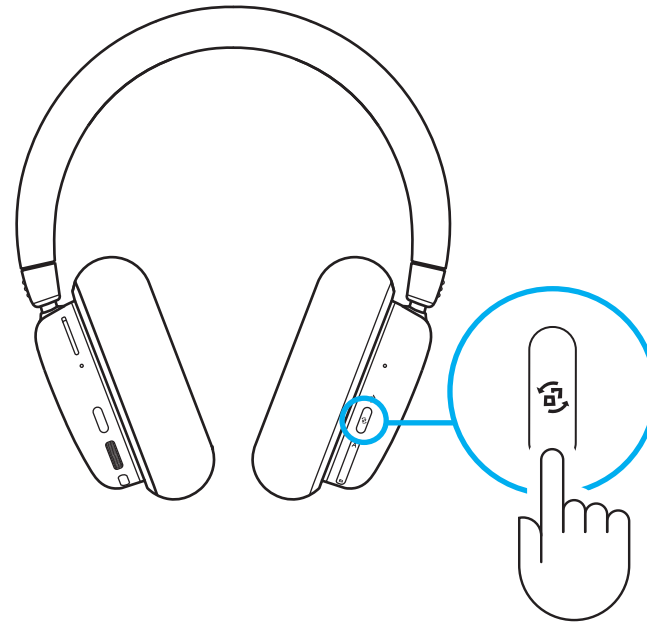

LIGHTSPEED/AUX 및 Bluetooth® 믹스

LIGHTSPEED, AUX, Bluetooth® 중 2개의 소스에 연결한 후:

- 소스 밸런스를 조절하려면 오른쪽 이어컵의 위/아래 버튼을 눌러 조절합니다.
- 위 버튼을 누르면 Bluetooth® 소스 음량이 커집니다.
- 아래 버튼을 누르면 활성 소스 (LIGHTSPEED 또는 AUX) 음량이 커집니다.
- 동등한 수준으로 초기화하려면 양 버튼을 3초 동안 길게 누릅니다.

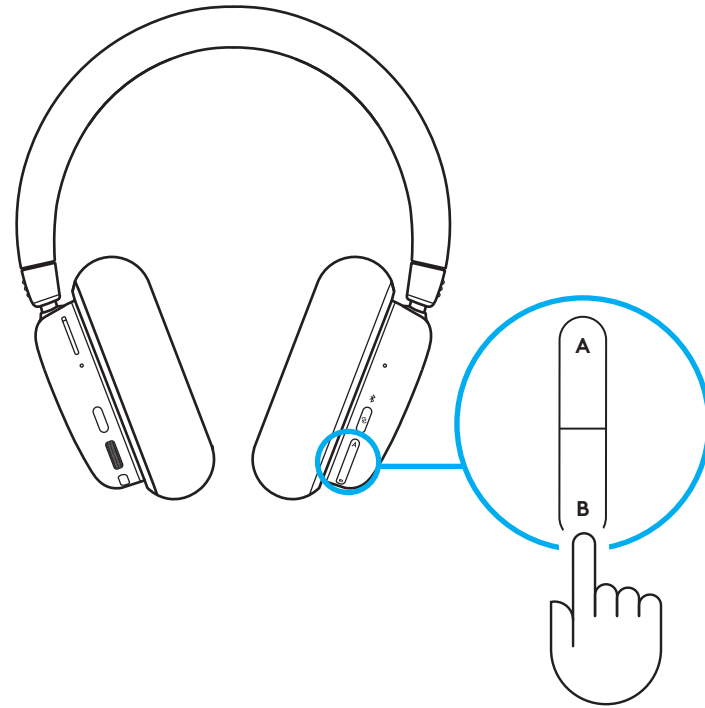

전원 끄기

왼쪽 이어컵에 있는 전원 버튼을 3초 동안 눌러 G735 헤드셋을 끕니다.

짧은 조명 애니메이션이 끝나면 헤드셋 조명이 꺼집니다. 전원이 꺼졌음을 알리는 사운드 알림이 있습니다.

10분 동안 헤드셋이 비활성화되면 헤드셋이 자동으로 꺼집니다.



배터리 상태 확인

배터리 상태를 확인하려면 왼쪽 이어컵의 전원 버튼을 짧게 누릅니다.

LED:

- 배터리 30% 이상인 경우 초록색
- 배터리 30% 미만인 경우 빨간색
- 배터리 15% 미만인 경우 빨간색 깜박임

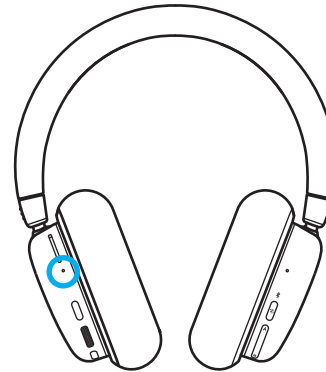

 = >30% 배터리

 = <30% 배터리

 = <15% 배터리

조명 켜기/끄기

장식 조명을 끄려면 왼쪽 이어컵의 전원 버튼을 두 번 누릅니다.

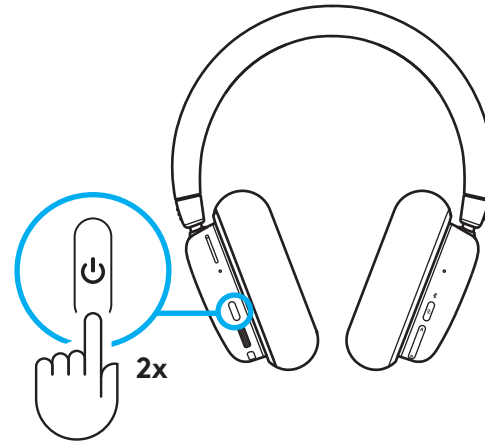

배터리 충전

왼쪽 이어컵의 하단에 있는 포트에 USB-C 케이블을 연결합니다. 마이크와 AUX 커넥터 포트 사이에 있습니다. PC의 USB 포트나 USB 충전 어댑터(미포함)에 USB-A를 연결합니다.

충전 중에는 전원 표시등이 초록색으로 켜진 뒤 깜박입니다.

배터리가 낮으면 전원 버튼이 빨간색으로 표시됩니다 (<30%).

G735 헤드셋은 60% 가량 충전되어 배송됩니다. 완전히 충전한 뒤 사용하는 것을 권장합니다.

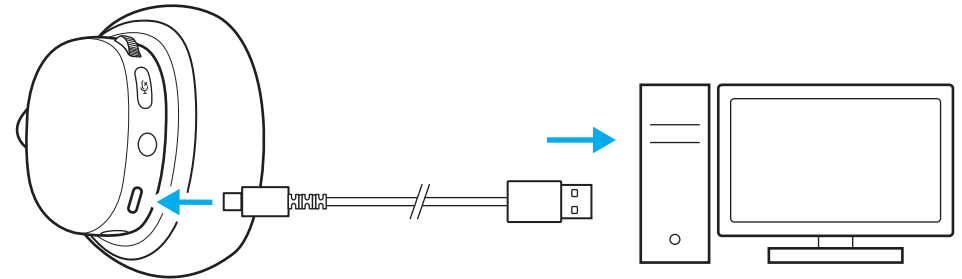

액세서리 컵 교체

이어패드를 제거하여 교체할 수 있습니다.





© 2022 Logitech. Logitech, Logitech G, Logi and their respective logos are trademarks or registered trademarks of Logitech Europe S.A. and/or its affiliates in the U.S. and other countries. All other trademarks are the property of their respective owners. Logitech assumes no responsibility for any errors that may appear in this manual. Information contained herein is subject to change without notice. The *Bluetooth*[®] word mark and logos are registered trademarks owned by Bluetooth SIG, Inc. and any use of such marks by Logitech is under license.

版权所有 © 2022 罗技。罗技、罗技 G、Logi、Logitech、Logitech G 及其各自标志为 Logitech Europe S.A. 和/或其在美国及其他国家/地区附属公司的商标， 并已注册。所有其它商标均是其各自所有者的财产。罗技对于本手册中可能出现的任何错误不承担任何责任。本手册中包含的信息如有更改， 恕不事先通知。蓝牙™文字商标和标志为 Bluetooth SIG, Inc. 所有的注册商标， 罗技对此类商标和标志的所有使用均已获得授权。