



Questo manuale d'istruzione è fornito da trovaprezzi.it. Scopri tutte le offerte per [Sony LSPX-S3](#) o cerca il tuo prodotto tra le [migliori offerte di Diffusori Audio](#)



Questo manuale d'istruzione è fornito da trovaprezzi.it. Scopri tutte le offerte per [Sony LSPX-S3](#) o cerca il tuo prodotto tra le [migliori offerte di Diffusori Audio](#)

SONY®

Operating Instructions

Glass Sound Speaker
LSPX-S3



5-029-387-11(1)
©2021 Sony Corporation
Printed in China /
Imprimé en Chine



Making preparations

Charging (When using the unit for the first time, be sure to charge it for at least 1 hour.)

Connect the supplied USB Type-C® cable and the commercially available USB AC adaptor to the unit.

Battery charging starts and the charge indicator lights up orange. Charging will complete in about 5 hours* and the indicator will turn off.

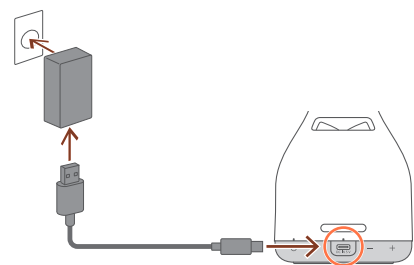

* Depending on the ambient temperature or the usage of the unit, the above time period may vary.

Turning the power on/off

Press the (power) button.

The (power) indicator lights up white. Pressing the (power) button again turns off the speaker.



Connecting with BLUETOOTH devices

To use BLUETOOTH® devices in combination with the unit via BLUETOOTH connections, you must pair the unit with each and every device.

Note

- Before pairing, stop playback on the BLUETOOTH device.
- When the connection is established, it is recommended that you turn down the volume before any playback. Otherwise, loud sound may output from the speaker for playback.

1 Turn on the unit and check the (BLUETOOTH) indicator on the bottom of the unit for activity.

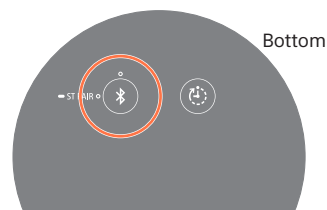
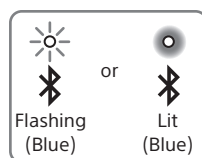

When the (BLUETOOTH) indicator is double flashing

The unit is in pairing mode.

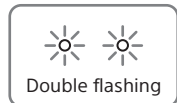

Register the unit on a BLUETOOTH device. See the section **A**.

When the (BLUETOOTH) indicator is flashing slowly

The unit is searching for paired BLUETOOTH devices.

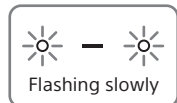

To pair the unit with a new BLUETOOTH device (a second or subsequent device). See the section **B**.

When the (BLUETOOTH) indicator stays lit

The unit is connected with a BLUETOOTH device.



To pair the unit with a new BLUETOOTH device (a second or subsequent device). See the section **B**.

2 Connect the unit with a BLUETOOTH device.

A

① Search for the unit on a BLUETOOTH device and select [LSPX-S3].

Android™ iPhone

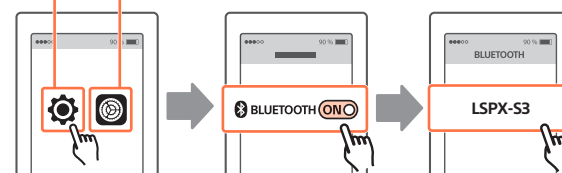

② Make sure that the (BLUETOOTH) indicator stops flashing and stays lit.

You hear a notification sound indicating that the unit is connected with the BLUETOOTH device. If a passkey is required on the display of the BLUETOOTH device, enter "0000."

- When the unit fails to connect with the BLUETOOTH device, perform the procedure described in the section **B**.

B

① Press the (BLUETOOTH) button.

You hear a notification sound and the (BLUETOOTH) indicator double flashes, which indicate that the unit is in pairing mode. Perform the procedure described in the section **A**.

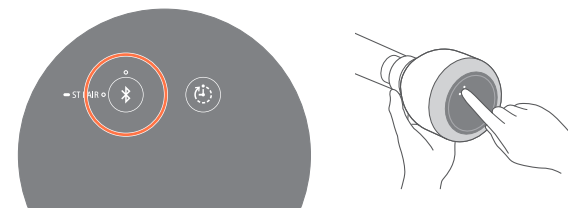

Hint

- The above instructions are provided as an example. Operations and screen displays vary depending on your BLUETOOTH device.
- For more information including how to connect with a BLUETOOTH device/computer, refer to the Help Guide.

Listening to music

1 Start playing music on the BLUETOOTH device and adjust the volume.

First, do the procedure in "Connecting with BLUETOOTH devices" to connect to the BLUETOOTH device.

2 Adjust the volume by pressing the (volume) button.

By pressing and holding the button, you can continuously adjust the volume.



On this unit, you can enjoy the following functions as well.

For details, refer to the Help Guide.

• Stereo Pair function

You can connect two LSPX-S3 units via a BLUETOOTH connection and enjoy music playback and linked illumination.

• Party Connect function

You can connect multiple speakers compatible with the Party Connect function*1 via BLUETOOTH connections*2 and enjoy music playback. When multiple LSPX-S3 units are connected, you can enjoy linked illumination as well.

*1 Up to 100 units can be connected.

*2 Products compatible with the Wireless Party Chain function are not applicable to the connection.

Using the illumination function

■ Adjusting brightness

On the touch sensor, flick your finger to the right or left.

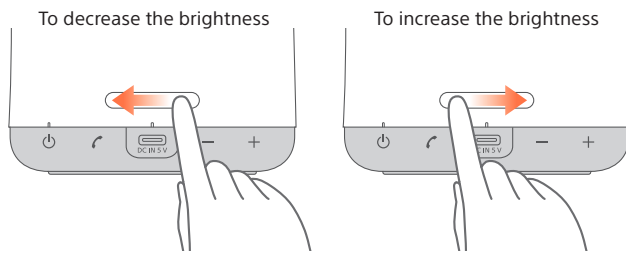

Hint

By sliding your finger to the right or left and keeping it touched on the touch sensor, you can continuously adjust the brightness. Take your finger off the touch sensor when the brightness reaches the optimal level.

■ Turning on/off

Tap the touch sensor to turn on/off the illumination.

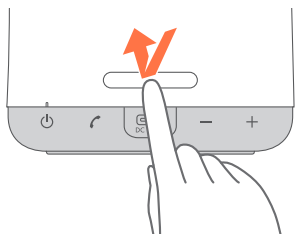

■ Enjoying the Candle Light Mode

Press the touch sensor for 2 seconds or longer.

You hear a notification sound indicating that the unit has shifted into Candle Light Mode from Lighting Mode (standard illumination).

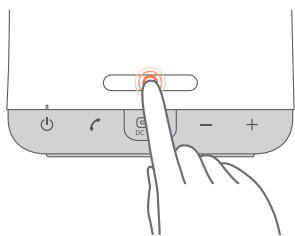

Hint

- When it is hard to tell if the unit is in Candle Light Mode, change the flickering setting.
- To bring the unit back into Lighting Mode, press and hold the touch sensor for 2 seconds or longer once again.

To change the flickering setting

On the touch sensor, flick your finger to the right. The setting shifts in the order from Delicate to Middle, Bright, and then to Linked with Music on each flick. Flicking your finger to the left shifts the setting in the reverse order.

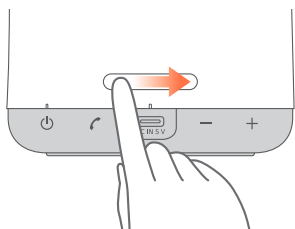

You hear a notification sound indicating that the flickering setting is changed.

Hint

With the "Illumination" function of "Sony | Music Center," you can select illumination mode, adjust brightness in Lighting Mode, specify the flickering setting in Candle Light Mode, and more. For details, refer to the Help Guide.

Other functions

■ Talking on the phone

For details about hands-free calling, refer to the Help Guide.

- 1 When you hear a ring tone, press the  (call) button.



- 2 Talk into the microphone of the unit.

The microphone (①) is located below the Sony logo inscription.

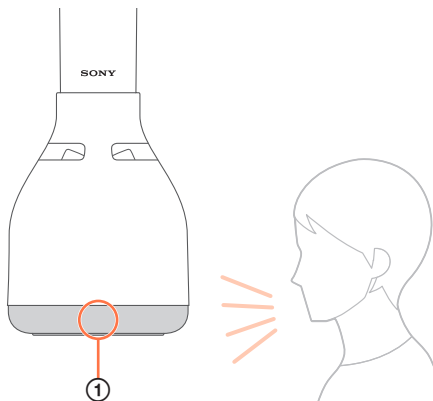

■ Using the Sleep Timer function

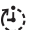
Press the  (timer) button.

The unit turns off in 60 minutes. To cancel the function, press the button once again.



■ Using "Sony | Music Center" for more convenience and fun

"Sony | Music Center" is an app that enables you to control Sony audio devices compatible with "Sony | Music Center" from your smartphone or iPhone.

How to download

Search for "Sony Music Center" in Google Play (Play Store) or the App Store, and download.

Sony Music Center 

What you can do with "Sony | Music Center"

- Setting up the Party Connect function
- Making sound settings (the Bass Boost function)
- Making Sleep Timer settings (changing the timer period, turning on/off the timer)
- Disabling the touch sensor (Disable Touch Sensor) and more

For details, refer to the Help Guide for "Sony | Music Center." <https://www.sony.net/smcqa/>



Be sure to use the latest version of "Sony | Music Center"

For the latest version and other information, visit the Google Play (Play Store) or the App Store.

Be aware that "Sony | Music Center" and "Music Center for PC" are different apps.

The specifications of "Sony | Music Center" are subject to change without prior notice.

Operations available on "Sony | Music Center" vary depending on the connected BLUETOOTH device.

■ Help Guide information

Refer to the Help Guide for more easy-to-understand troubleshooting tips. Use your computer or smartphone to view the tips.



https://rd1.sony.net/help/speaker/lsp-x-s3/h_zz/

■ Troubleshooting

For details, refer to "Troubleshooting" in the Help Guide. You may also be able to solve problems by charging the unit.

Restarting the unit

Restarting the unit may solve the issues, such as an operation failure of the unit while powered and a pairing failure.

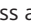
Press and hold the  (power) button for 8 seconds or longer.

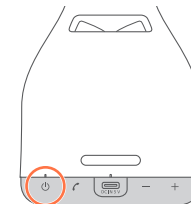

Note

Restarting the unit does not delete the pairing information.