



User Manual

Upright Freezer

H3F-280*SAAU1

H3F-320*SAAU1

H3F-320*TAAU1

* - Colour code

EN

Thank you for purchasing a Haier Product.

Please read these instructions carefully before using this appliance. The instructions contain important information which will help you get the best out of the appliance and ensure safe and proper installation, use and maintenance.

Keep this manual in a convenient place so you can always refer to it for the safe and proper use of the appliance.

If you sell the appliance, give it away, or leave it behind when you move house, make sure you also pass this manual so that the new owner can become familiar with the appliance and safety warnings.

Legend



General information and tips



Warning – Important Safety information



Environmental information

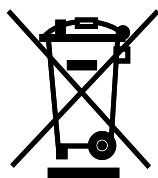

Disposal

Help protect the environment and human health. Put the packaging in applicable containers to recycle it. Help to recycle waste of electrical and electronic appliances. Do not dispose appliances marked with this symbol with the household waste. Return the product to your local recycling facility or contact your municipal office.



Warning!

Risk of injury or suffocation!

Refrigerants and gases must be disposed of professionally. Ensure that the tubing of the refrigerant circuit is not damaged before being properly disposed of. Disconnect the appliance from the mains supply. Cut off the mains cable and dispose of it. Remove the door, the door catch and seals, to prevent children and pets to get closed in the appliance.

1 - Safety	4
2 - Intended Use	8
3 - Product Description	9
4 - Control panel	10
5 - Use	11
6 - Energy saving	11
7 - Equipment	11
8 - Care and Cleaning	15
9 - Troubleshooting	17
10 - Installation	20
11 - Technical Data	24
12 - Customer Service	25

Before switching on the appliance for the first time, read the following safety hints!:



WARNING!

Before first use

- ▶ Make sure there is no transport damage.
- ▶ Remove all packaging and keep out of children's reach.
- ▶ Wait at least six hours before installing the appliance in order to ensure the refrigerant circuit is fully efficient.
- ▶ Handle the appliance always with at least two persons because it is heavy.

Installation

- ▶ The appliance should be placed in a well-ventilated place. Ensure a space of at least 10 cm above and around the appliance.
- ▶ Do not cover air vent openings.
- ▶ Never place the appliance in a damp area or location where it might be splashed with water. Clean and dry water splashes and stains with a soft clean cloth.
- ▶ Do not install the appliance in direct sunlight or in the near of heat sources (e.g. stoves, heaters).
- ▶ Install and level the appliance in an area suitable for its size and use.
- ▶ Keep ventilation openings in the appliance or in the in-built structure clear of obstruction.
- ▶ Make sure that the electrical information on the rating plate agrees with the power supply. If it does not, contact an electrician.
- ▶ The appliance is operated by a 220-240 VAC/50 Hz power supply. Abnormal voltage fluctuation may cause the appliance to fail to start, or damage to the temperature control or compressor, or there may be an abnormal noise when operating. In such case, an automatic regulator shall be mounted.
- ▶ Use a separate earthed socket for the power supply which is easily accessible during cleaning. The appliance must be earthed.
- ▶ **Only for UK:** The appliance's power cable is fitted with 3-cord (grounding) plug that fits a standard 3-cord (grounded) socket. Never cut off or dismount the third pin (grounding). After the appliance is installed, the plug should be accessible.
- ▶ Do not use multi-plug adapters and extension cables.
- ▶ Ensure that the power cable is not trapped by the freezer. Do not step on the power cable.
- ▶ Do not damage the refrigerant circuit.

**WARNING!****Daily use**

- ▶ This appliance can be used by children aged from 8 years and above and persons with reduced physical, sensory or mental capabilities or lack of experience and knowledge if they have been given supervision or instruction concerning use of the appliance in a safe way and understand the hazards involved.
- ▶ Keep away children under 3 years of age from the appliance unless they are constantly supervised.
- ▶ Children shall not play with the appliance.
- ▶ If cool gas or other inflammable gas is leaking in the vicinity of the appliance, turn off the valve of the leaking gas, open the doors and windows and do not unplug a plug in the power cable of the freezer or any other appliance.
- ▶ Notice that the appliance is set for operation at a specific ambient range between 10 and 43 °C. The appliance may not work properly if it is left for a long period at a temperature above or below the indicated range.
- ▶ Do not place unstable articles (heavy objects, containers filled with water) on top of the freezer, to avoid personal injury caused by falling or electric shock caused by contact with water.
- ▶ Open and close the doors only with the handles. The gap between the doors and between the doors and the cabinet is very narrow. Do not extend your hands in these areas to avoid pinching your fingers. Open or close the freezer doors only when there are no children standing within the range of door movement.
- ▶ Do not store or use inflammable, explosive or corrosive materials in the appliance or in the vicinity.
- ▶ Do not store medicines, bacteria or chemical agents in the appliance. This appliance is a household appliance. It is not recommended to store materials that require strict temperatures.
- ▶ Never store liquids in bottles or cans (besides high percentage spirits) especially carbonated beverages in the freezer, as these will burst during freezing.
- ▶ Check the condition of food if a warming in the freezer has taken place.
- ▶ Do not set unnecessarily low temperature in the freezer compartment. Attention: Bottles can burst.



WARNING!

Daily use

- ▶ Do not touch frozen goods with wet hands (wear gloves). Especially do not eat ice lollies immediately after removal from the freezer compartment. There is the risk to freeze or the formation of frost blisters. FIRST aid: keep immediately under running cold water. Do not pull away!
- ▶ Do not touch the inside surface of the freezer when in operation, especially with wet hands. Your hands may freeze onto the surface.
- ▶ Unplug the appliance in the event of a power interruption or before cleaning. Allow at least 5 minutes before restarting the appliance, as frequent starting may damage the compressor.
- ▶ Do not use electrical devices inside the food storage compartments of the appliance, unless they are of the type recommended by the manufacturer.

Maintenance/cleaning

- ▶ Make sure children are supervised if they carry out cleaning and maintenance.
- ▶ Disconnect the appliance from the electrical supply before undertaking any routine maintenance. Allow at least 5 minutes before restarting the appliance, as frequent starting may damage the compressor.
- ▶ Hold the plug, not the cable, when unplugging the appliance.
- ▶ Do not scrape off frost and ice with sharp objects. Do not use sprays, electric heaters like heater, hair dryer, steam cleaners or other sources of heat in order to avoid damage to the plastic parts.
- ▶ Do not use mechanical devices or other means to accelerate the defrosting process, other than those recommended by the manufacturer.
- ▶ Do not spray or flush the appliance during cleaning.
- ▶ Do not use water spray or steam to clean the appliance.
- ▶ If the supply cord is damaged, it must be replaced by the manufacturer, its service agent or similarly qualified persons in order to avoid a hazard.
- ▶ Do not try to repair, disassemble or modify the appliance by yourself. In case of repair please contact our customer service.

Refrigerant gas information



WARNING!

The appliance contains the flammable refrigerant ISOBUTHANE (R600a). Make sure the refrigerant circuit is not damaged during transportation or installation. Leaking refrigerant may cause eye injuries or ignite. If a damage has occurred, keep away open fire sources, thoroughly ventilate the room, do not plug or unplug the power cords of the appliance or any other appliance. Inform the customer service.

In case of eyes get into contact with the refrigerant, rinse immediately it under running water and call immediately the eye specialist.



WARNING!

- ▶ Taking care to avoid causing a fire by igniting flammable material.
- ▶ WARNING: When positioning the appliance, ensure the supply cord is not trapped or damaged.
- ▶ WARNING: Do not locate multiple portable socket-outlets or portable power supplies at the rear of the appliance.
- ▶ Do not store explosive substances such as aerosol cans with a flammable propellant in this appliance.
- ▶ For flammable refrigerants is used in the freezer, please be careful when installing, handling, serving and recycling the appliance.
- ▶ Please contact to the service agent to dispose the appliance because the flammable blowing gas was used.

2.1 Intended Use

"This appliance is intended to be used in household and similar applications such as

- staff kitchen areas in shops, offices and other working environments;
- farm houses and by clients in hotels, motels and other residential type environments;
- bed and breakfast type environments;
- catering and similar non-retail applications.

This appliance is intended for freezing food. It has been designed exclusively for use in dry-interior house-holds. It is not intended for commercial or industrial use. On demand this appliance can be used as fresh food compartment.

Changes or modifications to the device are not allowed. Unintended use may cause hazards and loss of warranty claims.

2.2 Accessories

Check the accessories and literature in accordance with this list:

2.2



Ice tray
(available for
H3F280/320*SAAU1)



Energy
label



Warranty card



Connectivity
Quick Guide



User manual

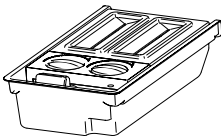

Twist Ice Maker
(available for
H3F-320*TAU1)

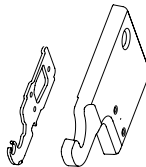

Upper left
hinge for door
reversibility

Upper left
hinge cover

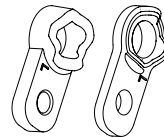

Axe covers



Notice: Differences

Due to technical changes and different models, some of the illustrations in this manual may differ from your model.

Picture of appliance (Fig. 3)

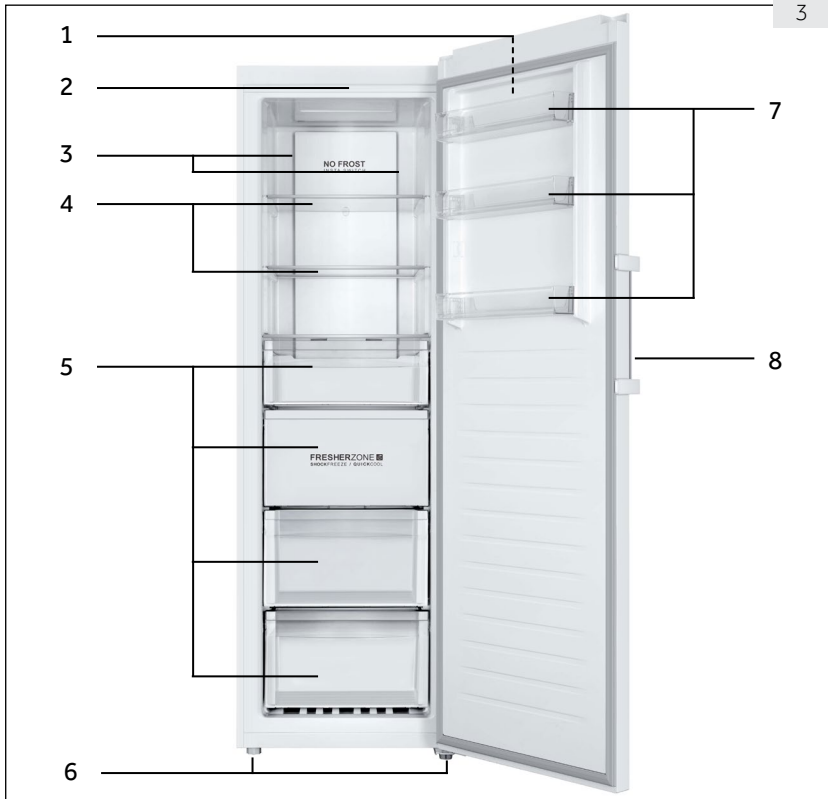

1 Control panel

2 LED light

3 Multi-air flow

4 Glass shelves

5 Drawers

6 Adjustable feet

7 Removable door racks

8 Door handle

Control panel (Fig. 4)

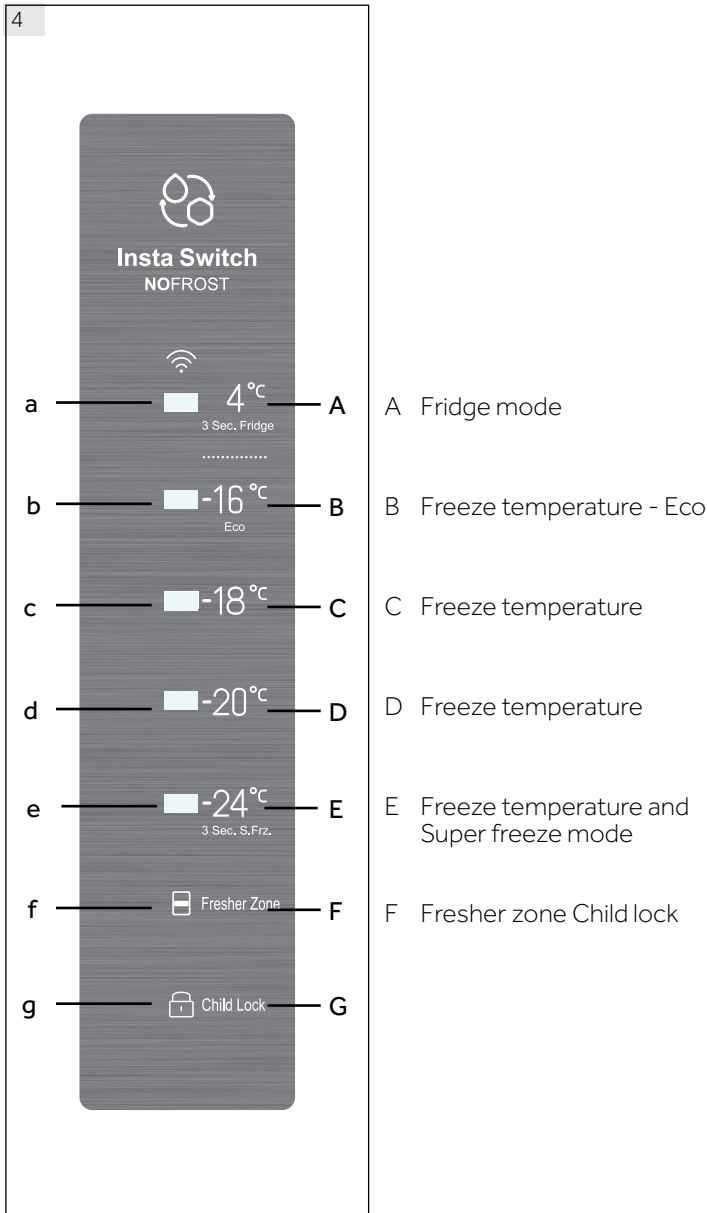

5.1 Before first Use

- ▶ Remove all packaging materials, keep them out of childrens reach and dispose them in an environmentally friendly manner.
- ▶ Clean the inside and outside of the appliance with water and a mild detergent before putting any food in it.
- ▶ After the appliance has been levelled and cleaned, wait for at least 6 hours before connecting it to the power supply. See Section INSTALLATION.
- ▶ Precool the compartment for 2 hours at high settings before loading with food. To do so, please set the temperature to -20°C or -24°C .

5.2 Switching the appliance on /off

The appliance is in operation as soon as it is connected to the power supply.

- ▶ The freezer temperature is automatically set to -18°C . This is the recommended setting and the ideal temperature for frozen goods. If desired, you can change the temperatures manually. Please see ADJUSTING THE TEMPERATURE.

Indicators (a-g) will flash once consecutively. If the door is closed, the display switches off after 30 seconds. The panel lock might be active.



Notice: Presettings

- ▶ The appliance is preset to the recommended temperature of -18°C . Under normal ambient condition you don't need to set a temperature.
- ▶ When the appliance is switched on after being disconnected from the main power supply, it may take up to 12 hours for the correct temperature to be reached.

Empty the appliance before switching off. To switch off the appliance, pull the power cord out off the power socket.

5.3 Standby-mode of display

When the door is closed the display screen turns off automatically 30 seconds after without operation. The display locks automatically. It lights up automatically when touching any button or opening the door.

5.4 Display lock and unlock

Automatic locking

Display is automatically locked after 30 seconds without operation.

Manual locking

When the display is unlocked, press "Child lock" (G) and hold for 3 seconds, after a beep, "Child lock"(g) indicator is light, display is locked. When the display is locked, press "Child lock" (G) and hold for 3 seconds, after a beep, "Child lock"(g) indicator is off, display is unlocked.

**Notice: Display lock**

When display is locked, functions such as temperature setting or super freeze are disabled. When above operation is attempted, Child lock indicator will blink for 3 times, to remind that the display is locked.

5.5 Temperature setting

When display is unlocked, by touching different temperature buttons, different temperature could be set, this process will be accompanied by beeps.

Freeze and Fridge (4°C)(A) mode has big difference in temperature, and is for different food storage. Prior to making any mode change, please make sure to change the food inside the freezer, so that food will not be damaged because of mode change.

5.6 Freeze mode (-16°C to -24°C) (B - E)

When display is unlocked, by touching different freeze temperature buttons, different temperature could be set, indicators on left of the touch button will be light and others will be off. Temperature could be set to "-16°C", "-18°C", "-20°C" and "-24°C".

5.7 Fridge mode(4°C) (A)

When display is unlocked, by touching (4°C) (A) and hold for 3 seconds, indicators "4°C" (a) will be light, the freezer works in fridge mode. After stabilization, temperature is around 4°C.

5.8 Super freeze mode (E)

Super freeze mode is optimal for preserving food nutrition, it could freeze food in less time. Before putting lots of food inside the freezer, activate super freeze function to have lower temperature, to make sure better freeze result.

When display is unlocked, touch and hold (-24°C) (E) for 3 seconds, indicators (b - e) will be light, the freezer works in super freeze mode. To deactivate manually super freeze function, repeat steps above. If not deactivated manually, the function will be deactivated automatically after 50 hours.

If you have a large amount of food to freeze at one time, it is recommended that the function is activated 24 hours before inserting food. Function will stop automatically after 50 hours or manually. Power consumption will increase when this function is on.

**Notice: Super freeze**

In super freeze mode, temperature could not be adjusted. If you do so, super freeze indicator will blink for 3 times to remind that the freezer is in super freeze mode.

5.9 Fresher Zone (F)

In the Freezer mode, FresherZone works as SHOCK FREEZE, the entire zone can be quickly cooled to the freezing temperature.

When temperature is set at -16°C or lower, touch FresherZone button(F), the FresherZone indicator(f) illuminates, then the blast function is activated. When activated, the functions will be automatically deactivated when temperature is reached or after 24 hours. Repeat the operation to deactivate manually.

In the Fridge mode, FresherZone works as QUICKCOOL, the entire zone can be quickly cooled to the freezing temperature.

When temperature is set at 4°C, touch FresherZone button (F), the FresherZone indicator(f) illuminates, then the FresherZone function is activated. When activated, the functions will be automatically deactivated when temperature is reached or after 3 hours. Repeat the operation to deactivate manually.

Deactivate FresherZone before switching from freezer to fridge temperature, or switching from fridge to freezer temperature.

5.10 Eco mode (-16°C) (B)

When display is unlocked, by touching (-16°C) (B) the appliance is set into Eco mode. In this mode the energy consumption is lower, while appropriate freezing performance is still guaranteed. To exit the Eco mode select other temperature.

5.11 Power-off memory

This freezer has power-off memory, settings before power-off will be memorized. When power is back on, freezer will return to settings before power-off and continue to function. Child lock is not memorized, after power back on, display is unlocked.

5.12 Door open alarm

When freezer is kept open for more than 1 minute, beeper will make 3 beeps with interval of 0.5 second. The beeps will be repeated every 30 seconds if door is kept open. The beeps will stop until door is closed or after 7 mins of door opening. The beeper stops beeping and freezer light goes off.

5.13 High temperature alarm

This freezer is equipped with high temperature alarm. In freeze mode or super freeze mode, if current temperature setting indicator blinks with beeps, touch any button, the beep will stop, but current temperature setting indicator keeps blinking, that means temperature in the freezer is too high. Please check if freezer door is tightly closed or if large amount of warm food is put inside the freezer. After a period, current temperature indicator will stop blinking. If it does not stop blinking for a long period, and beeps that are manually cancelled come back, please contact aftersales service.

5.14 Error indication

This freezer is equipped with error indication. When an error is encountered, display will blink every 1/4 second different codes for different errors. In this situation, the freezer could still freeze but user should contact aftersales service as soon as possible for optimal control of the freezer.

5.15 Wi-Fi

When the appliance is connected with Wi-Fi, it could be controlled from distant [temperature setting adjustment, activation and deactivation of super freeze and FresherZone function]. When the door is left open or when there is temperature deviation, real time information could be informed through the application.



Energy saving tips

- ▶ Make sure the appliance is properly ventilated (see INSTALLATION).
- ▶ Do not install the appliance in direct sunlight or in the near of heat sources (e.g. stoves, heaters).
- ▶ Avoid unnecessarily low temperature in the appliance. The energy consumption increases the lower the temperature in the appliance is set.
- ▶ Allow warm food to cool down before placing it in the appliance.
- ▶ Open the appliance door as little and as briefly as possible.
- ▶ Make sure the door always closes correctly and unimpaired by food position. Keep door seals clean.
- ▶ Defreeze frozen food in a fridge.
- ▶ Clean the rear of the appliance regularly. Dust increases energy consumption.

7 - Equipment

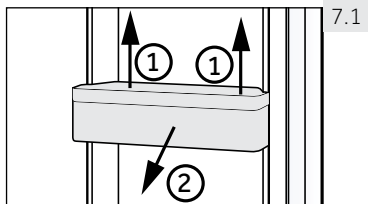

7.1

7.1 Removable door racks

The door rack can be removed for cleaning:

Place hands on each side of the rack, lift it upwards (1) and pull it out (2) (Fig. 7.3).

In order to insert the door rack, the above steps are carried out in reverse order.

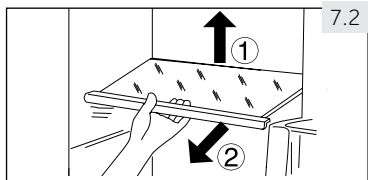

7.2

7.2 Glass shelves

1. To take out a shelf, remove it first by uplifting its hind edge (1) and pulling it out (2) (Fig. 7.2).

2. To reinstall it, put it on the lugs on both sides and push it to the most rearward position until the rear of the shelf is fixed inside the slots in the sides

**WARNING!**

Disconnect the appliance from the power supply before cleaning.

8.1 General

Clean the appliance when only little or no food is stored.

**WARNING!**

- ▶ Do not clean the appliance with hard brushes, wire brushes, detergent powder, petrol, amyl acetate, acetone and similar organic solutions, acid or alkaline solutions. Please clean with special freezer detergent to avoid damage.
- ▶ Do not spray or flush the appliance during cleaning.
- ▶ Do not scrape off frost and ice with sharp objects.
- ▶ Do not use sprays, electric heaters like heater, hair dryer, steam cleaners or other sources of heat in order to avoid damage to the plastic parts.
- ▶ Do not clean the cold glass shelves with hot water. Sudden temperature change may cause the glass to break.
- ▶ Do not touch the inside surface of the freezer storage compartment, especially with wet hands, as your hands may freeze onto the surface.
- ▶ In case of heating check the condition of frozen goods.
- ▶ Do not try to repair the appliance by yourself. In case of repair please contact our customer service.

- ▶ Always keep the door gasket clean.
- ▶ Clean the inside and housing of the appliance with a soft cloth or sponge dampened in warm water and neutral detergent (Fig. 8.1).
- ▶ Rinse and dry with soft cloth.
- ▶ Do not clean any of the parts of the appliance in a dishwasher.
- ▶ Clean the accessory only with warm water and mild neutral detergent.

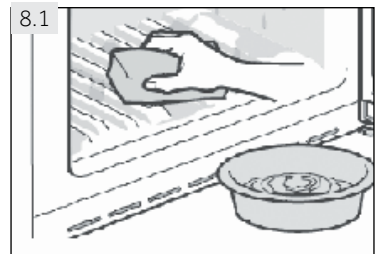

8.2 Non-use for a longer period

If the appliance is not used for an extended period of time:

- ▶ Take out the food.
 - ▶ Unplug the power cord.
 - ▶ Clean the appliance as described above.
 - ▶ Keep the door and freezer drawers open to prevent the creation of bad odours inside.
- Remove the door of the appliance (open the door and hold it before removing the screws) to avoid children entering into the appliance and getting locked in.



Notice: Switch off

To ensure the service life of the appliance, only turn it off only if strictly necessary.

8.3 Moving the appliance

1. Remove all food and unplug the appliance.
2. Secure shelves and other moveable parts in the freezer with adhesive tape.
3. Close the door and secure it with tape.
4. Do not tilt the freezer more than 45° to avoid damaging the refrigerating system.
5. Wrap the feet of the freezer to avoid scratching the floor. Never move the freezer forcefully.



WARNING!

- ▶ Do not lift the appliance by its handles.
- ▶ Never place the appliance horizontally on the ground.

Many occurring problems could be solved by yourself without specific expertise. In case of a problem please check all shown possibilities and follow below instructions before you contact an after sales service. See CUSTOMER SERVICE.



WARNING!

- ▶ Before maintenance, deactivate the appliance and disconnect the mains plug from the mains socket.
- ▶ Electrical equipment should be serviced only by qualified electrical experts, because improper repairs can cause considerable consequential damages.
- ▶ A damaged supply should only be replaced by the manufacturer, its service agent or similarly qualified persons in order to avoid a hazard.

The acoustic alarm can be switched off by pressing any button..

9.1 Troubleshooting

Problem	Possible Cause	Possible Solution
The compressor does not work.	<ul style="list-style-type: none"> • Mains plug is not connected in the mains socket. 	<ul style="list-style-type: none"> • Connect the mains plug.
The appliance runs frequently or for a too long period of time.	<ul style="list-style-type: none"> • The indoor or outdoor temperature is too high. • The appliance has been off power for a period of time. • The door of the appliance is not tightly closed. • The door has been opened too frequently or for too long. • The temperature setting is too low. • The door gasket is dirty, worn, cracked or mis-matched. • The required air circulation is not guaranteed. • The interior is covered in ice. 	<ul style="list-style-type: none"> • In this case, it is normal for the appliance to run longer. • Normally, it takes 8 to 12 hours for the appliance to cool down completely. • Close the door and ensure the appliance is located on a level ground and there is no food or container jarring the door. • Do not open the door too frequently. • Set the temperature higher until a satisfactory temperature is obtained. It takes 24 hours for the temperature to become stable. • Clean the door gasket or replace them by the customer service. • Ensure adequate ventilation. • Defrost the appliance.
The appliance makes abnormal sounds.	<ul style="list-style-type: none"> • The appliance is not located on level ground. • The appliance touches an object close to it. • The appliance stands on a wooden floor or near wooden walls. 	<ul style="list-style-type: none"> • Level the appliance. • Remove objects around the appliance. • Wood amplifies the sound. Set the appliance somewhere else.

Problem	Possible Cause	Possible Solution
The appliance makes a clicking sound	<ul style="list-style-type: none"> This is normal. It is caused by the refrigeration unit switching on or off. 	<ul style="list-style-type: none"> -
A slight sound is to be heard similar to that of flowing water.	<ul style="list-style-type: none"> This is normal. 	<ul style="list-style-type: none"> -
The appliance makes a motor sound	<ul style="list-style-type: none"> The refrigeration unit has just turned itself on. This is normal 	<ul style="list-style-type: none"> -
It is not cold enough inside the appliance.	<ul style="list-style-type: none"> The temperature is set too high. Goods that are too warm have been stored. Too much food has been stored at a time. The goods are too close to each other. The door is not tightly closed. The door has been opened too frequently or for too long. 	<ul style="list-style-type: none"> Reset the temperature. Always cool down goods before storing them. Always store small quantities of food. Leave a gap between several foods allowing air flowing. Close the door. Do not open the door too frequently.
It is too cold inside the appliance.	<ul style="list-style-type: none"> The temperature is set too low. The Fast-freezing function is activated or has been running too long. 	<ul style="list-style-type: none"> Reset the temperature. Switch off the Fast-freezing function.
Moisture accumulates on the surface of the appliance.	<ul style="list-style-type: none"> The climate is too warm and too damp. 	<ul style="list-style-type: none"> This is normal in damp climate and will change when the humidity decreases. Wipe dry with a cloth.
Strong ice and frost in the freezer compartment.	<ul style="list-style-type: none"> The goods were not adequately packaged. The door is not tightly closed. The door has been opened too frequently or for too long. The door gasket is dirty, worn, cracked or mis-matched. Something on the inside prevents the door from closing properly. 	<ul style="list-style-type: none"> Always pack the goods well. Close the door. Do not open the door too frequently. Clean the door gasket or replace them by the customer service. Reposition the shelves, door racks, or internal containers to allow the door to close.
The cooling system does not work.	<ul style="list-style-type: none"> Mains plug is not connected to the mains socket. The power supply is not intact. 	<ul style="list-style-type: none"> Connect the mains plug. Check the electrical supply to the room. Call the local electricity company!

Problem	Possible Cause	Possible Solution
The sides of the cabinet and door strip get warm.	<ul style="list-style-type: none"> This is normal. 	<ul style="list-style-type: none"> -
You hear an alarm signal.	<ul style="list-style-type: none"> The door is open The temperature inside product is too high 	<ul style="list-style-type: none"> Close the door or silence the alarm manually.
The door is difficult to open.	<ul style="list-style-type: none"> Once the appliance runs, it has an internal vacuum. 	<ul style="list-style-type: none"> Open the door seal gently to let air enter the appliance.
The door can't be closed properly. It always leaves a gap.	<ul style="list-style-type: none"> Because of the appliances's low temperature, the door seal can easily get hard and deformed. 	<ul style="list-style-type: none"> Use a hair dryer or put a hot towel on the spot where the gasket is deformed. When the gasket is soft once again, close the door and compress it tightly.

9.2 Power Interruption

In the event of a power cut, food should remain safely cold for about 18 hours. Follow these tips during a prolonged power interruption, especially in summer:

- ▶ Open the door as few times as possible.
- ▶ Do not put additional food into the freezer during a power interruption.
- ▶ If prior notice of a power interruption is given and the interruption duration is longer than 15 hours, make some ice and put it in a container in the top of the freezer compartment.
- ▶ As temperature in the freezer will rise during a power interruption or other failure, the storage period and edible quality of food will be reduced. Any food that defrosts should be either consumed, or cooked and refrozen (where suitable) soon afterwards in order to prevent health risks.



Notice: Memory function during power interruption

After restoration of power the appliance continues with the settings that were set before the power failure.

10.1 Unpacking



WARNING!

- ▶ The appliance is heavy. Always handle with at least two persons.
- ▶ Keep all packaging materials out of childrens reach and dispose them in an environmentally friendly manner.
- ▶ Take the appliance out of the packaging.
- ▶ Remove all packaging materials.

10.2 Environmental conditions

The room temperature should always be between 10 °C and 43 °C, since it can influence the temperature inside the appliance and its energy consumption. Do not install the appliance near other heat-emitting appliances (ovens, refrigerators) without isolation.

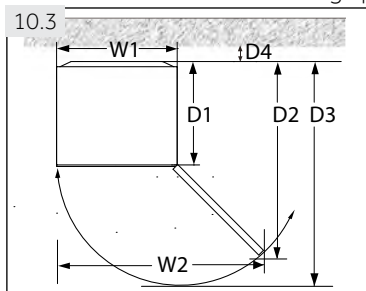

10.3 Space requirements

Required space to open the door (Fig. 10.3):

Width in mm		Depth in mm			Distance to wall in mm
W1	W2	D1	D2	D3	D4
595	955	592	1105	1215	100

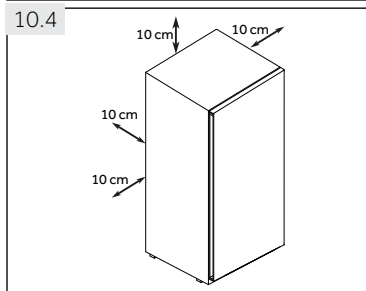

10.4 Ventilaton cross-section

To achieve sufficient ventilation of the appliance for safety reasons, the information of the required ventilation cross sections must be observed (Fig. 10.4).

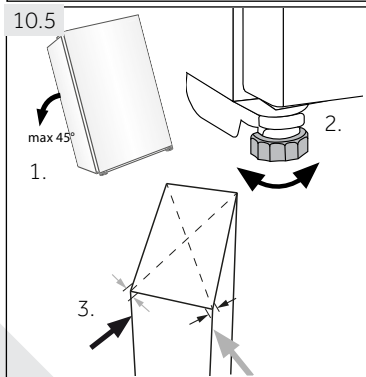

10.5 Aligning the appliance

The appliance should be placed on a flat and solid surface. If the appliance is placed on a pedestal, strong and fire-resistant materials must be used. Never use the foam packing material as a pedestal.

1. Tilt the appliance slightly backwards (Fig. 10.5).
2. Set the feet to the desired level.
3. The stability can be checked by alternately bumping on the diagonals. The slight swaying should be the same in both directions. Otherwise the frame can warp; possible leaking door seals are the result. A low tendency to the rear eases the closing of the door.

10.6 Using adjustable feet

If the freezer is unstable, the feet can be adjusted: Rotate the adjustable feet according to the direction of arrow (Fig. 10.6) to turn them up or down:

- ▶ Turning the feet clockwise raises the appliance.
- ▶ Turning the feet counterclockwise lowers it.

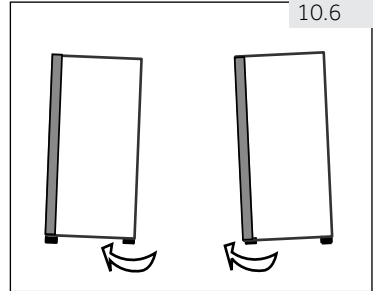

10.7 Waiting time

To the maintenance-free lubrication oil is located in the capsule of the compressor. This oil can get through the closed pipe system during slanting transport. Before connecting the appliance to the power supply you have to wait 6 hours (Fig. 10.7) so that the oil runs back into the capsule.

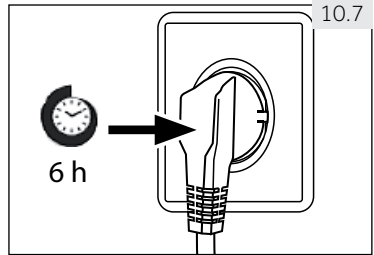

10.8 Electrical connection

Before each connection check if:

- ▶ power supply, socket and fusing are appropriate to the rating plate.
- ▶ the power socket is earthed and no multi-plug or extension.
- ▶ the power plug and socket are strictly according.

Connect the plug to a properly installed household socket.



WARNING!

To avoid risks a damaged power cord must be replaced by the customer service (see warranty card).

10.9 Door Reversibility

Before connecting the appliance to the power supply you should check, whether the door swing must be changed from right (as delivered) to left, if this is required by the installation location and the usability.



WARNING!

- ▶ The appliance is heavy. You need two persons to carry out the door reversibility.
- ▶ Before any operation, first unplug the appliance from the mains .
- ▶ Do not tilt the appliance more than 45 ° to prevent damage of the cooling system.

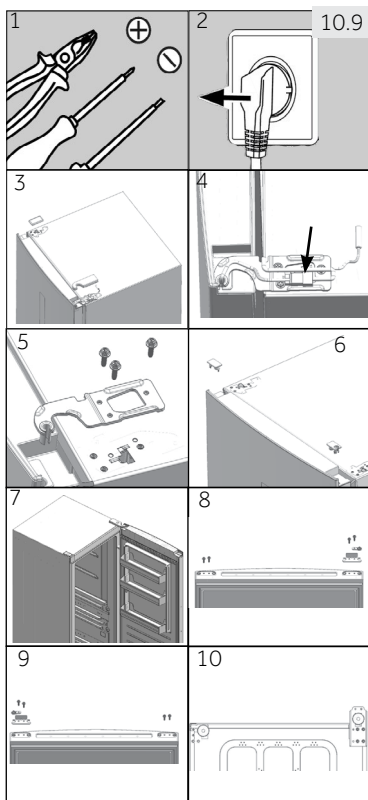

Assembly steps (Fig. 10.9):

1. Provide necessary tool.
2. Unplug the appliance.
3. Remove hinge hole cover and hinge cover.
4. Unplug the connection cable.
5. Removes screws and hinge
6. Remove cover on door. Remove axle cover on door
7. Open and remove the door.
8. Turn the door upside down, remove 2 screws on the bottom of the door. Remove 2 screws, door stopper and axle cover on the bottom of the door
9. Take door stopper from last step and the thinner axle cover from the accessory bag, fix them with 2 screws. Fix 2 screws also on the other side of the door.
10. Tilt slightly backwards the cabinet, remove 4 screws and then the lower hinge.

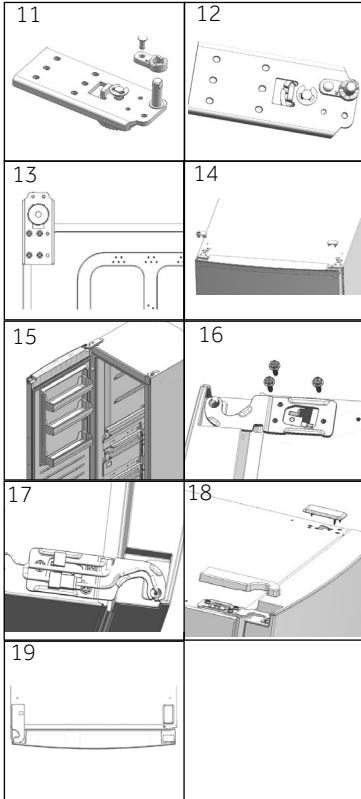

11. Remove screw and hinge cover. Remove hinge axle and fix it into the hole next to it.
12. Take the thicker hinge cover from the accessory bag. Fix it with screw from last step.
13. Fix the hinge to the opposite position of the cabinet with 4 screws.
14. On opposite side of the door, pull out left side connection cable and put it through the hinge cover from step 5, mount hinge cover. Mount the hole cover on the right side.
15. Mount the door.
16. Fix upper right upper hinge with 3 screws.
17. Connect the cable connectors:
18. Fix hinge hole cover and upper left hinge cover.
19. Finished.

11.1 Product fiche according to regulation EU No. 1060/2010

Trade mark	Haier		
Model identifier	H3F-280*SAAU1	H3F-320*SAAU1	H3F-320*TAAU1
Category of the model	Upright freezer		
Energy efficiency class	A++		A+++
Annual energy consumption (kWh/year) ¹⁾	260	285	189
Storage volume cooling (L)	not applicable		
Storage volume freezing (L) ****	285	330	
Star rating	****		
Temperature of other compartments > 14 °C	not applicable		
Frostfree system	yes		
Power cut safe (h)	16		
Freezing capacity (kg/24h)	19	21	
Climate class This appliance is intended to be used at an ambient temperature between 10 °C and 43 °C.	SN-T		
Airborne acoustical noise emissions (db(A) re 1pW)	38		
Construction type	freestanding		

¹⁾ based on standard test results for 24 hours. Actual energy consumption will depend on how the appliance is used and where it is located.

11.2 Additional Technical Data

Voltage / Frequency	220-240V ~/ 50Hz
Main fuse (A)	1.0
Coolant	R600a
Dimensions (H/W/D in mm) H3F-280*SAAU1	171/59,5/67,5
Dimensions (H/W/D in mm) H3F-320*(S/T)AAU1	191/59,5/67,5

11.3 Standards and directives



This product meets the requirements of all applicable EC directives with the corresponding harmonised standards, which provide for CE marking.

We recommend our Haier Customer Service and the use of original spare parts.
If you have a problem with your appliance, please first check section TROUBLESHOOTING.

If you cannot find a solution there, please contact

- ▶ your local dealer or
- ▶ the Service & Support area at www.haier.com where you can find telephone numbers and FAQs and where you can activate the service claim.

To contact our Service, ensure that you have the following data available.
The information can be found on the rating plate.

Model _____ Serial No. _____

Also check the Warranty Card supplied with the product in case of warranty.

For general business enquiries please find below our addresses in Europe:

European Haier addresses			
Country*	Postal address	Country*	Postal address
Italy	Haier Europe Trading SRL Via De Cristoforis, 12 21100 Varese ITALY	France	Haier France SAS 3-5 rue des Gravieres 92200 Neuilly sur Seine FRANCE
Spain Portugal	Haier Iberia SL Pg. Garcia Faria, 49-51 08019 Barcelona SPAIN	Belgium-FR Belgium-NL Netherlands Luxembourg	Haier Benelux SA Anderlecht Route de Lennik 451 BELGIUM
Germany Austria	Haier Deutschland GmbH Hewlett-Packard-Str. 4 D-61352 Bad Homburg GERMANY	Poland Czechia Hungary Greece Romania Russia	Haier Poland Sp. zo.o. Al. Jerozolimskie 181B 02-222 Warszawa POLAND
United Kingdom	Haier Appliances UK Co.Ltd. One Crown Square Church Street East Woking, Surrey, GU21 6HR UK		

*For more information please refer to www.haier.com

H3F-280/320_AAU1_V02_EN_190118

Haier