



## WHAT'S IN THE BOX



\*Power cord quantity and plug type vary by regions.

## BLUETOOTH PAIRING

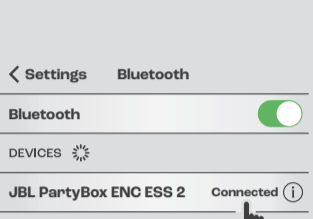

## PLAY

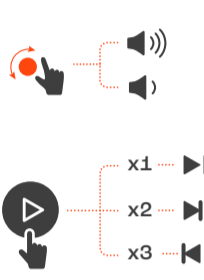

## LIGHTSHOW



Apply lightshow presets and more with the JBL PARTYBOX app.

## APP

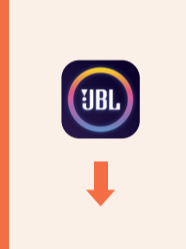

Download and install the JBL PARTYBOX app to get more from the product.



## MICROPHONE

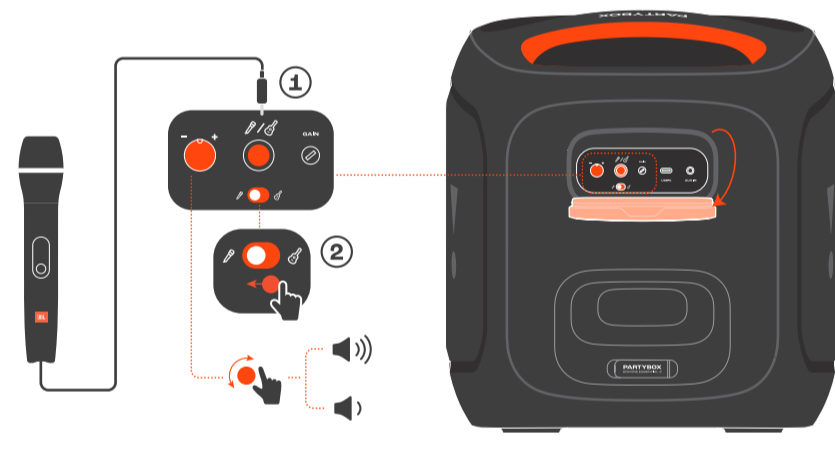

## GUITAR

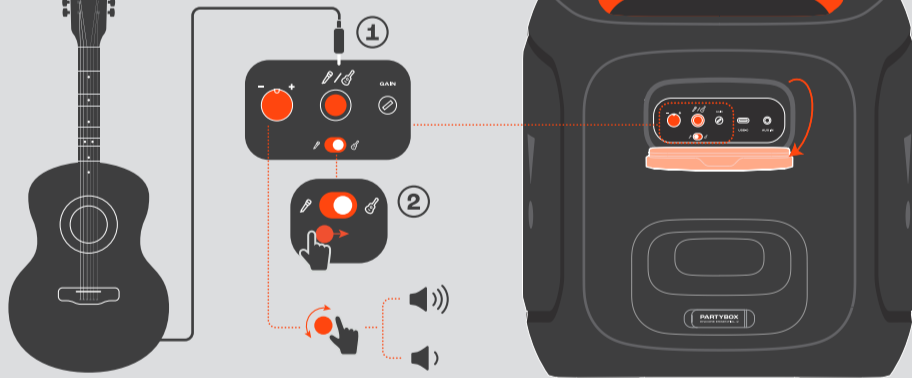

## MULTI-SPEAKER CONNECTION



## CHARGING

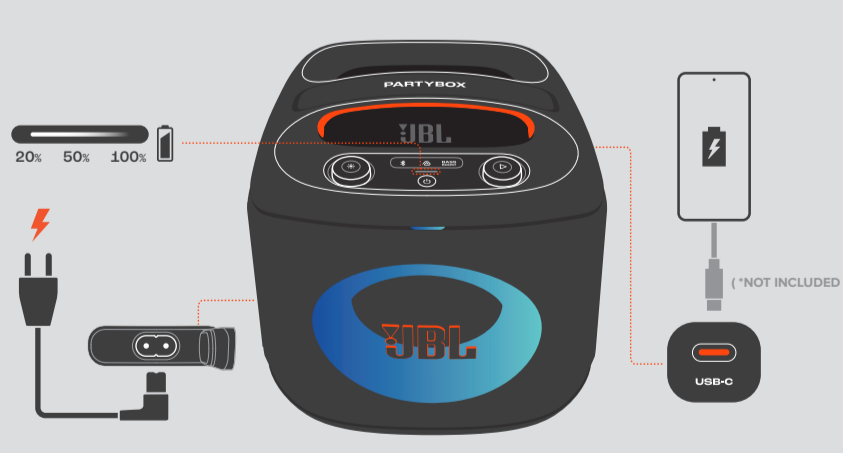

## BATTERY REPLACEMENT

### 1 Remove the Old Battery

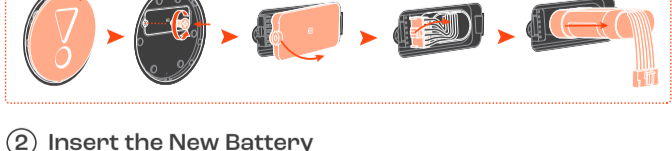

### 2 Insert the New Battery

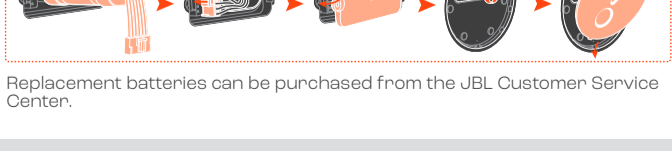

Replacement batteries can be purchased from the JBL Customer Service Center.

## SPLASH PROOF IPX4



Do not change your speaker until it is completely dry and clean.

