



LANCOOL II

MESH RGB PERFORMANCE

| Born to Push Limit |

Installation Guide / 安裝說明書
Guide d'installation / Montageanleitung
Guía de instalación / インストールガイド



LANCOOL II MESH

Born to Push Limit

* Case components

* 機殻部品紹介

* Composants du boîtier

* Gehäusekomponenten

* Guía de instalación

* ケース各部紹介

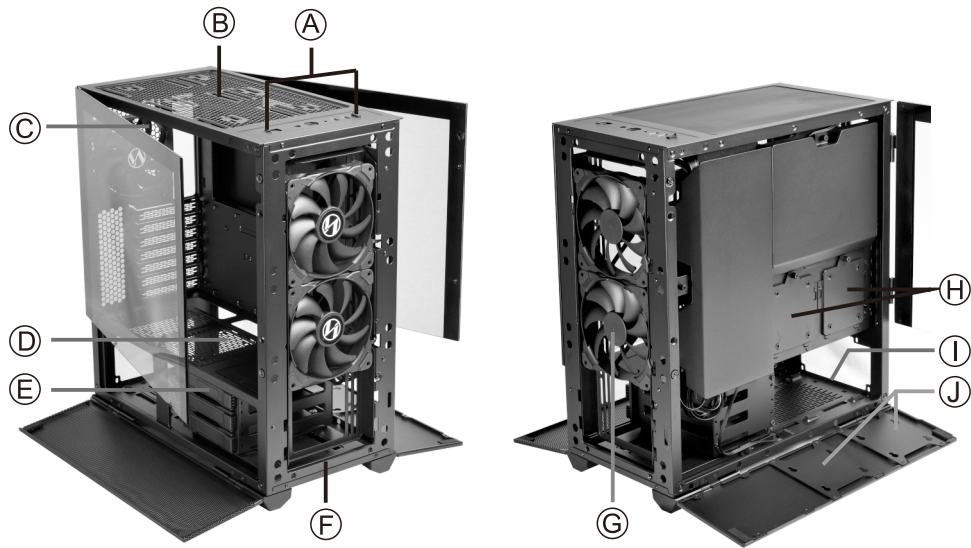

RGB: IO ports: 1 x AUDIO / Microphone Combo Jack, 2 x USB 3.0, 1 x USB 3.1 Type C (Optional)
Power Button, Reset Button, C button for color control, M button for lighting mode control

PERFORMANCE: IO ports: 1 x AUDIO / Microphone Combo Jack, 2 x USB 3.0, 1 x USB 3.1 Type C (Optional)
Power Button, Reset Button, 1 x Fan speed control button

B 120 mm fan x 1, Supporting 120 mm fan x 2 or 140 mm fan x 2 or 120 mm radiator x 1, or 240 mm radiator x 1, Removable dust filter

RGB: NON

C **PERFORMANCE:** 120 mm fan x 1

D Supporting 120 mm fan x 2 or 2.5" SSD x 2

E Removable HDD tray: Supporting 3.5" HDD x 3 or 2.5" SSD x 3

F Removable fan tray: Supporting 120 mm fan x 3 or 140 mm fan x 2 or 360 mm radiator x 1 or 280 mm radiator x 1

RGB: 120 mm fan x 3 (Removable dust filter in front panel)

G **PERFORMANCE:** 140 mm fan x 2 (Removable dust filter in front panel)

H Removable HDD tray: Supporting 2.5" SSD x 2

I PSU tray: Supporting ATX PSU x 1 (Removable dust filter in bottom)

J Removable HDD tray: Supporting 2.5" SSD x 2



LANCOOL II MESH

Born to Push Limit

- * Hardware list
- * 零件盒部品一覧表
- * Liste des pièces
- * Hardwareliste
- * Lista de materiales
- * 付属品一覧



Screws
for motherboard and
2.5" SSD mount

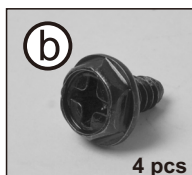

Screws
for PSU mounting



Screws
for 3.5" HDD mount

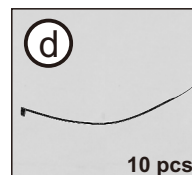

Cable ties
for cable management



Screws / Anti-vibration rings
for 2.5" SSD mount



Tool
for Stand off bolt



Screws
for 120 mm fan

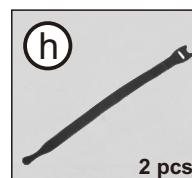

Velcro
for cable management

- ※ Exceeded quantity are spare parts.
- ※ 多餘的零件數量是備品。
- ※ Les pièces supplémentaires sont des pièces de rechange.
- ※ Zusätzliche Teile können als Ersatzteile verwendet werden.
- ※ Exceeded quantity are spare parts.
- ※ ネジには予備が含まれてています。

- * The fan is installed in the middle of the top cover
- * 風扇安裝在上蓋的中間
- * Le ventilateur est installé au milieu du capot supérieur
- * Der Lüfter befindet sich in der Mitte der oberen Abdeckung
- * El ventilador está instalado en el medio de la cubierta superior
- * ファンはトップカバーの中央に取り付けられています

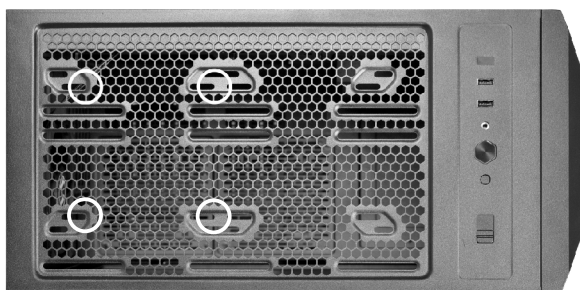



LANCOOL II MESH

| Born to Push Limit |

- * Remove front panel
- * 卸下前面板
- * Retirer le panneau avant
- * Frontplatte entfernen
- * Retire el panel delantero
- * 前面パネルを取り外す

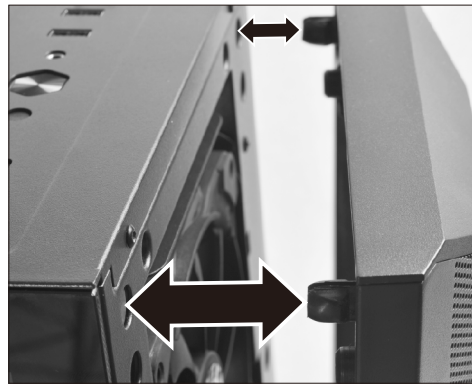
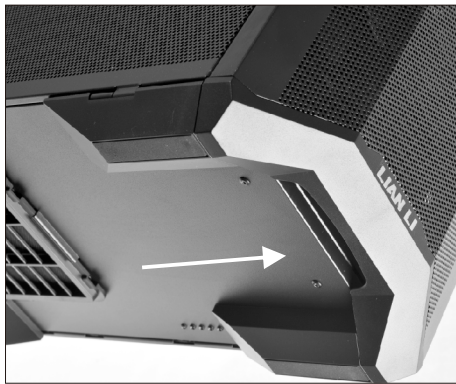

Handle, Pull to release





LANCOOL II MESH

Born to Push Limit

- * Remove the side panel
- * 側板拆卸
- * Retirez le panneau latéral
- * Seitenwand abnehmen
- * Extracción del panel lateral
- * サイドパネルの取り外し

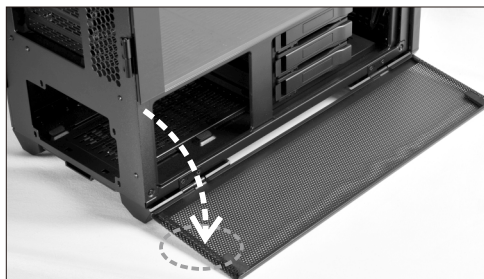

First remove the front panel and then open the side panels.



Handle, Pull to release



Without removing the front panel.

Move up to release the side panel

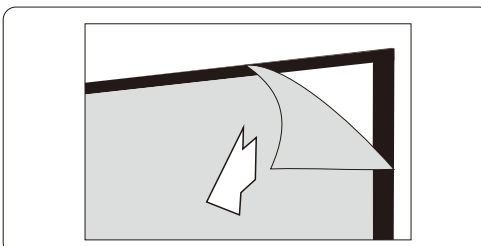
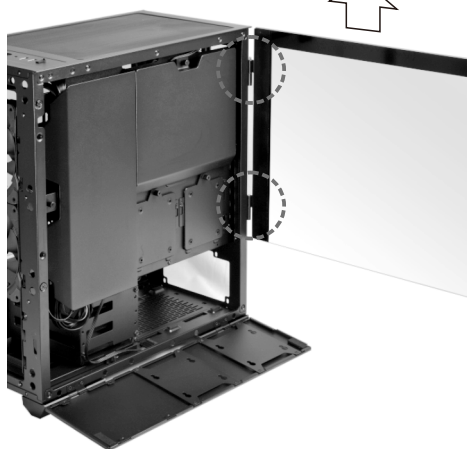

Attention:
Peel off the protective film



LANCOOL II MESH

Born to Push Limit

- * Motherboard installation
- * 主機板安裝
- * Installation de la carte mère
- * Motherboard installieren
- * Instalación de la placa base
- * マザーボードの取り付け

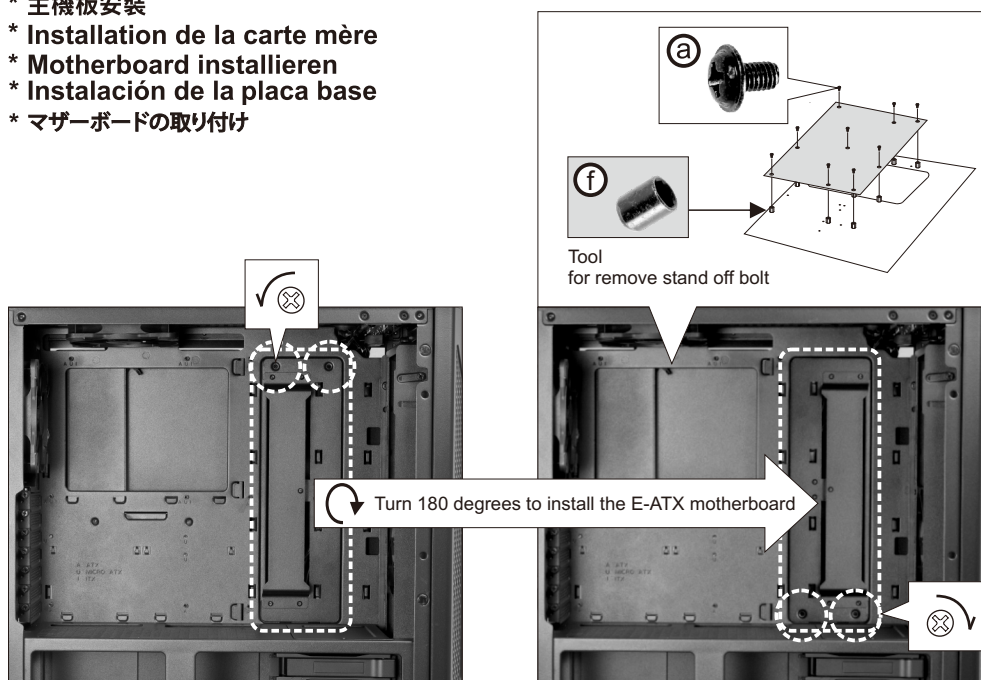

- * PSU installation
- * 電源供應器安裝
- * Installation du plateau du bloc d'alimentation

- * PSU-Einsatz installieren
- * Instalación de la fuente de alimentación
- * 電源ユニットの取り付け

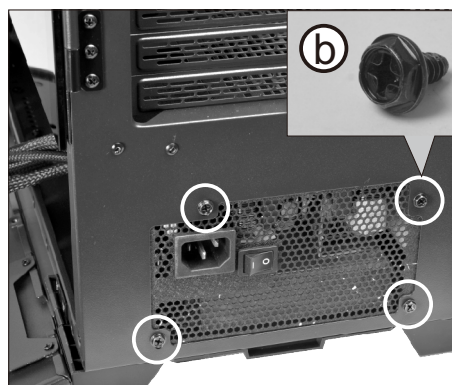
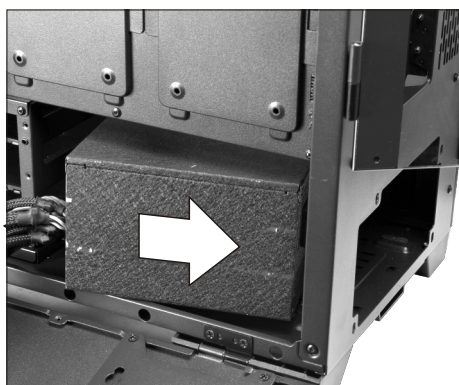



LANCOOL II MESH

Born to Push Limit

- * 2.5"SSD / 3.5"HDD installation
- * 2.5"SSD / 3.5"HDD 安裝
- * Installation de 2.5"SSD / 3.5"HDD

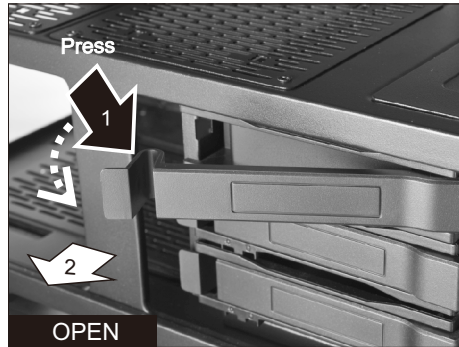

- * 2.5"SSD / 3.5"HDD - Installation
- * Instalación de 2.5"SSD / 3.5"HDD
- * 2.5"SSD / 3.5"HDD インストール

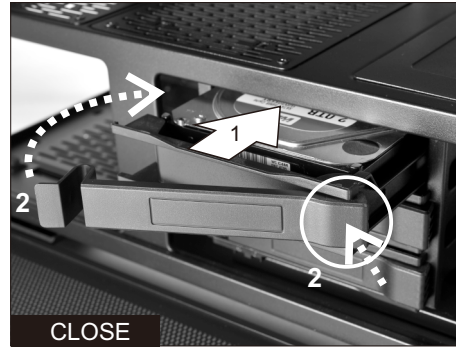

Warning: The HDD tray needs to be pushed in before closing the handle.

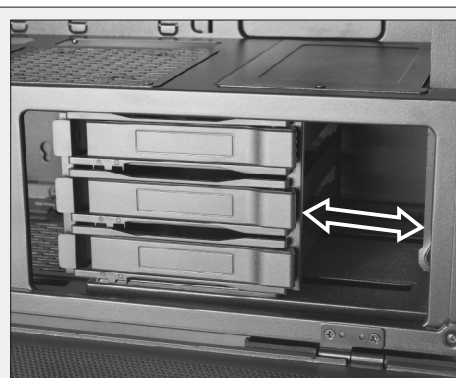
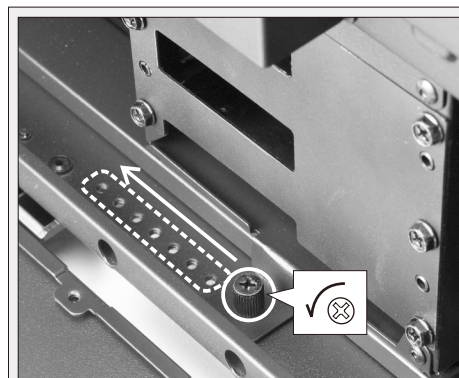
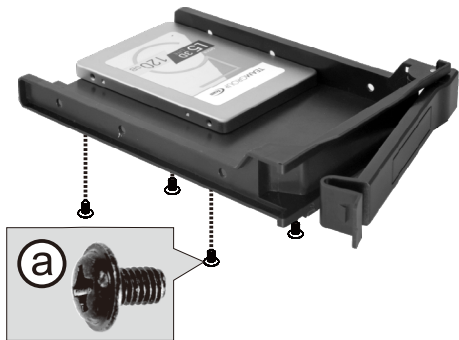

Note: HDD rack position can be adjusted



LANCOOL II MESH

| Born to Push Limit |

- * 2.5"SSD installation
- * 2.5"SSD安裝
- * Installation de 2.5"SSD

- * 2.5"SSD - Installation
- * Instalación de 2.5"SSD
- * 2.5"SSDインストール

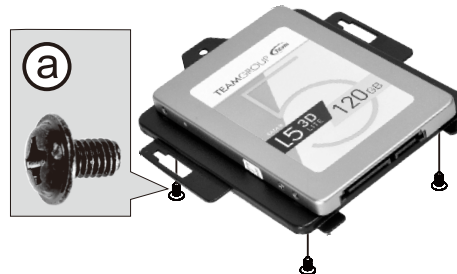
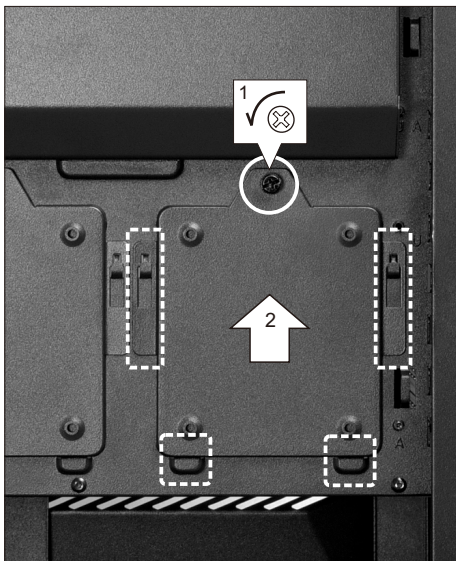
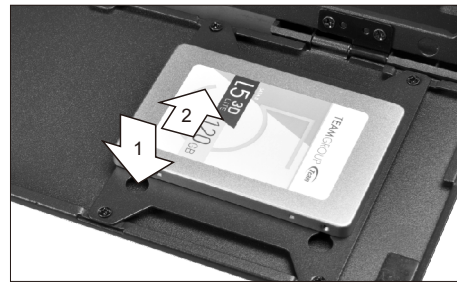
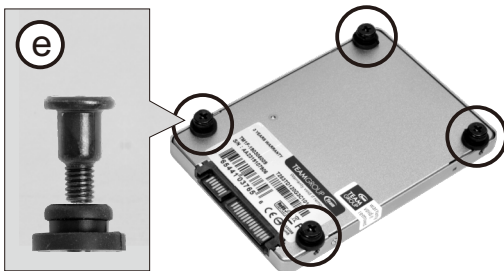
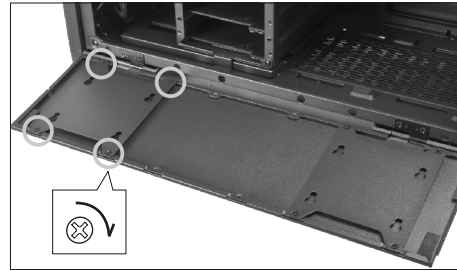
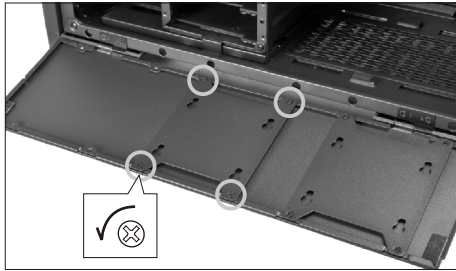



LANCOOL II MESH

Born to Push Limit

- * 120 mm fan / 2.5 "SSD installation
- * 2.5"SSD/120 mm 風扇安裝
- * Installation d'un ventilateur de 120 mm / SSD de 2,5 "

- * 120 mm Lüfter / 2,5 "SSD-Installation
- * Ventilador de 120 mm / instalación SSD de 2.5 "
- * 120 mmファン/ 2.5インチSSDの取り付け

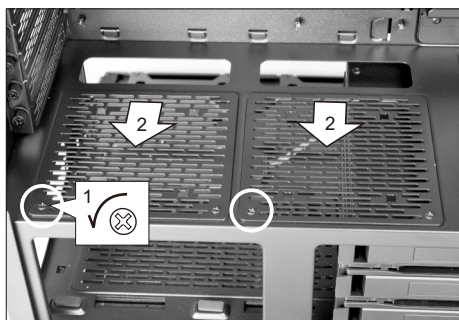

Remove bracket to installation.

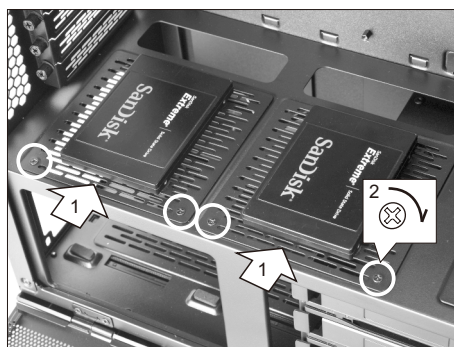
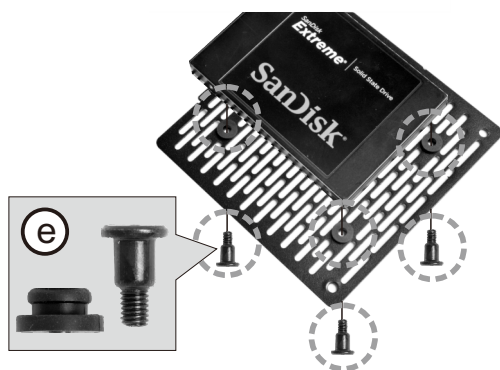
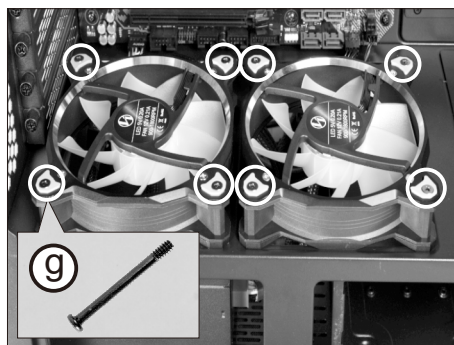

- * Cable management
- * 整線

- * Gestion des câbles
- * Kabelmanagement

- * Mantenimiento de cable
- * ケーブル管理

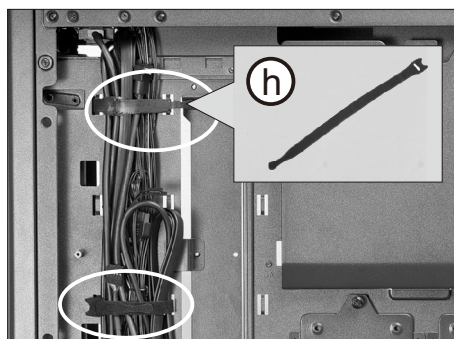
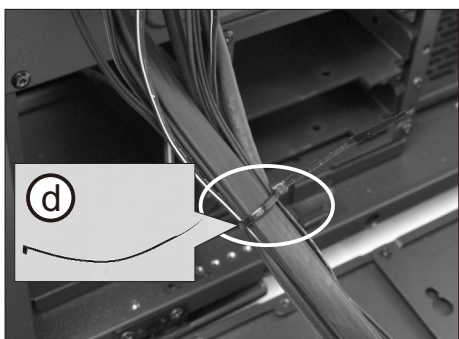



LANCOOL II MESH

Born to Push Limit

- * I/O ports function
- * Installation du port E/S
- * Instalación de los puertos de E/S
- * I/O port 功能説明
- * I/O-Port installieren
- * I/O ポートに関して

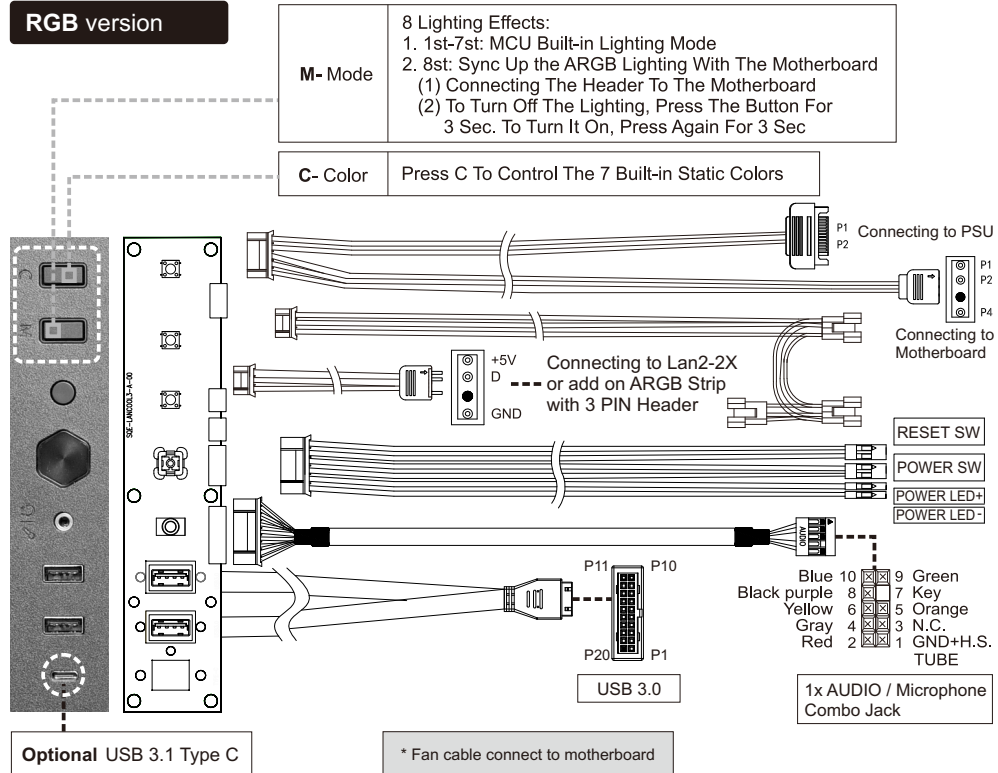

- * LED control installation
- * LED 控制安装
- * Installation de contrôle à LED
- * LED-Steuerung Installation
- * Instalación de control LED
- * LED制御のインストール

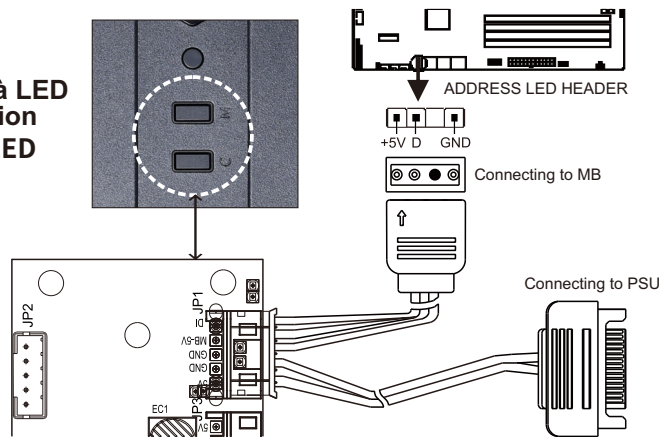



LANCOOL II MESH

Born to Push Limit

- * I/O ports function
- * Installation du port E/S
- * Instalación de los puertos de E/S
- * I/O port 功能說明
- * I/O-Port installieren
- * I/O ポートに関して

PERFORMANCE version

Fan speed control			
Mode	Funtion	120 mm fan	140 mm fan
L	Low RPM duty cycle 45%	675 RPM	540 RPM
M	Middle RPM duty cycle 75%	1125 RPM	900 RPM
H	High RPM duty cycle 100%	1500 RPM	1200 RPM
MB	Sync motherboard PWM signal	Sync motherboard PWM signal	

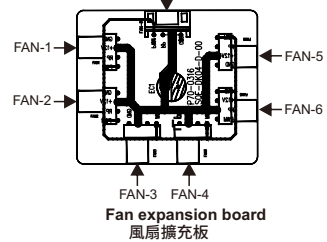
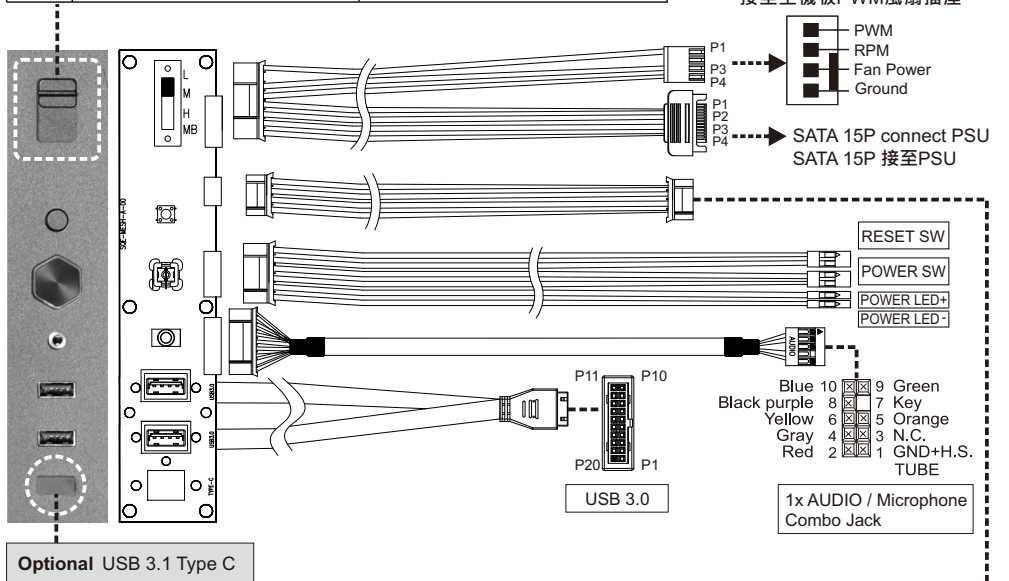



LANCOOL II MESH

Born to Push Limit

- * Remove the fan tray
- * 卸下風扇架
- * Retirez le plateau du ventilateur
- * Entfernen Sie die Lüfterablage
- * Retire la bandeja del ventilador
- * ファントレイを取り外す

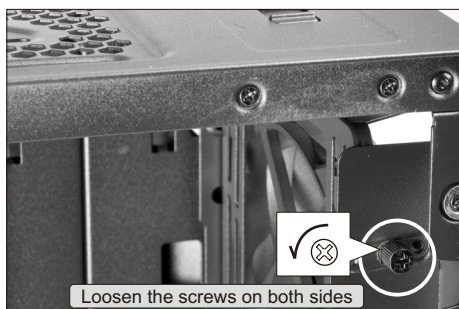
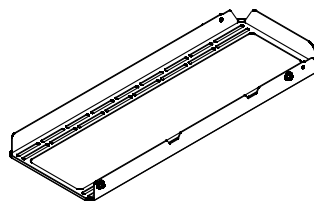

Loosen the screws on both sides

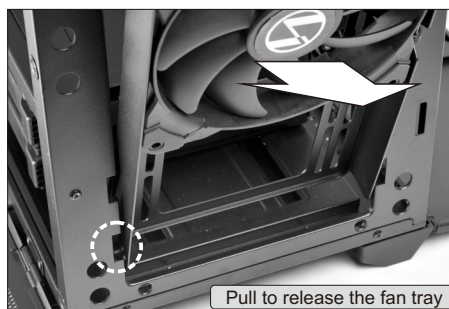

Pull to release the fan tray



Attention: The fan tray can be reversed and has four styles

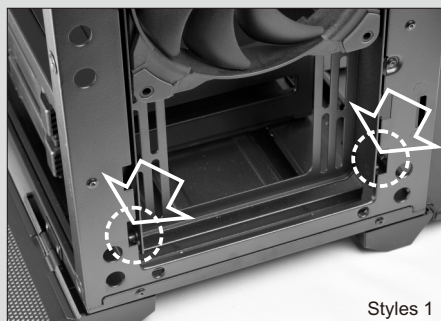

Styles 1

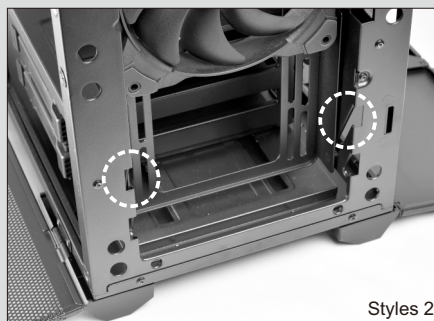

Styles 2



Styles 3 (Reversed)



Styles 4 (Reversed)



LANCOOL II MESH

Born to Push Limit

- * Radiator & cooling support
- * 散熱器 & 水冷排支援
- * Assistance radiateur et refroidissement
- * Kühler- und Kühlungsunterstützung
- * Radiador y soporte de refrigeración.
- * ラジエーター&冷却サポート

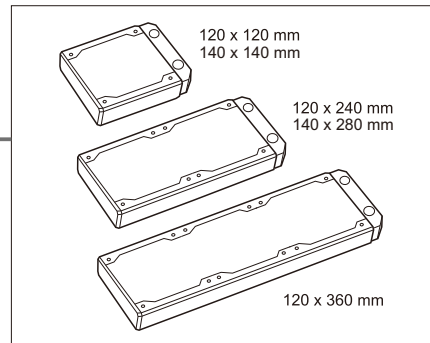
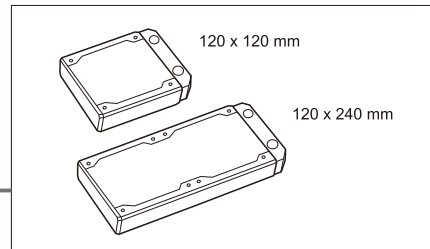

120 x 120 mm
120 x 240 mm
120 x 360 mm

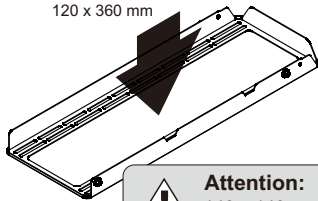

Attention:
140 x 140 mm / 140 x 280 mm
does not apply to this position.

120 x 120 mm
140 x 140 mm
120 x 240 mm
140 x 280 mm
120 x 360 mm

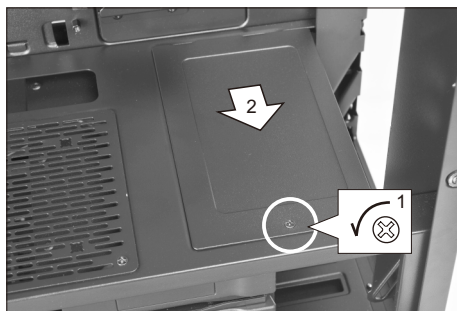
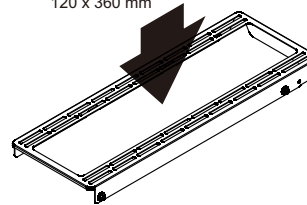

Remove the cover to install the 360 mm radiator



LANCOOL II MESH

Born to Push Limit

- * Remove the magnetic dust filters
- * Entfernen Sie Luftfilter
- * 灰塵濾網拆卸
- * Retire los filtros de aire
- * Retirez les filtres à air
- * エアフィルターの取り外し

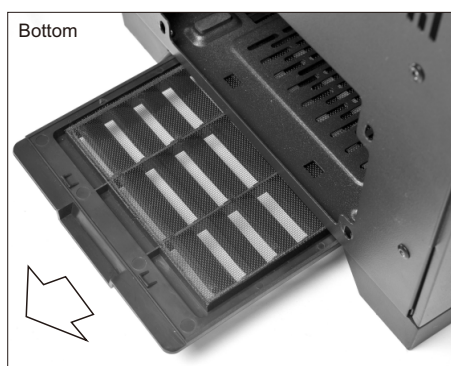

- * Remove cover
- * Retirer le couvercle
- * 卸下蓋子
- * Abdeckung abnehmen
- * Retire la tapa
- * カバーを外す

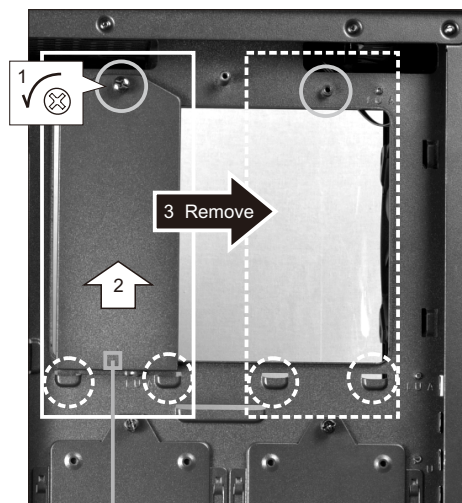
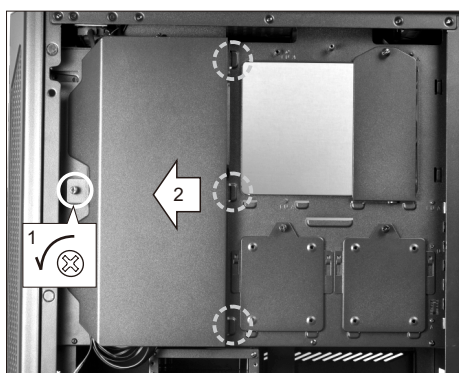
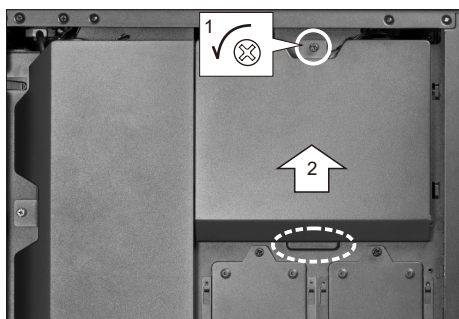

For RGB Controller or fan hub



LANCOOL II MESH

Born to Push Limit

*** Hardware clearance**

*** 硬體擴充支援**

- CPU air cooler
- GPU
- PSU
- Radiator clearance

*** Passage de matériel**

*** Hardware-Freigabe**

*** Limpieza de hardware**

*** ハードウェア拡張のサポート**

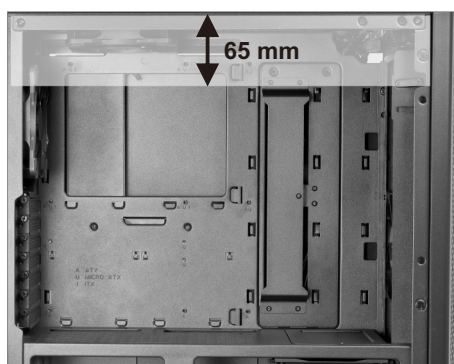
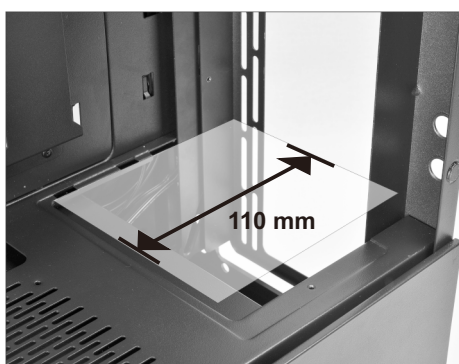
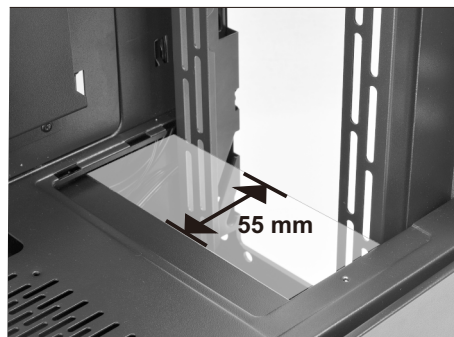
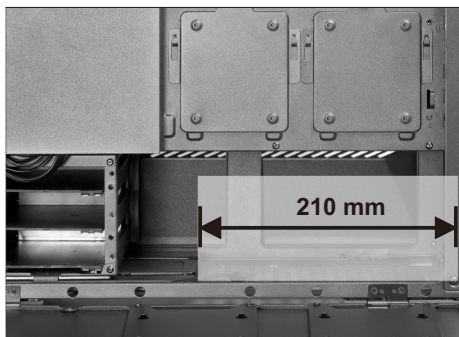
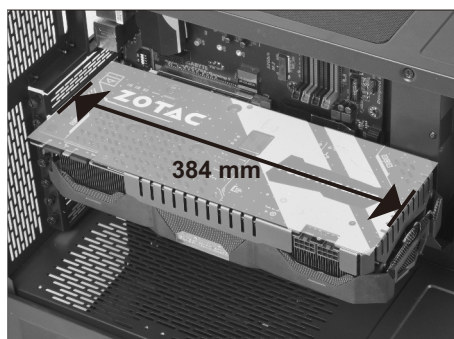
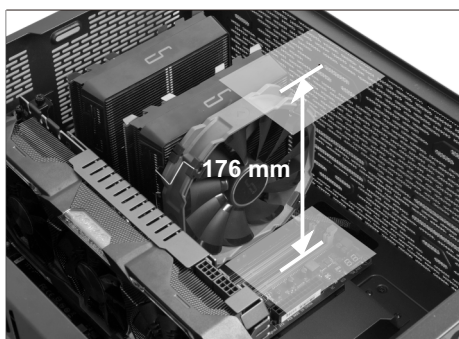



LANCOOL II MESH

Born to Push Limit

- * Optional kits
- * 選配套件
- * Kits optionnels
- * Optionale Sets
- * Kits opcionales
- * オプションパーツ

Model:	Product name:
LANCOOL II - 1X	Vertical GPU kit
LANCOOL II - 2X	Side Diffused LEDs strip
LANCOOL II - 3X	Hot swappable back plate
LANCOOL II - 4X	3.1 type C cable
GB-001X	Graphic card anti-sag bracket

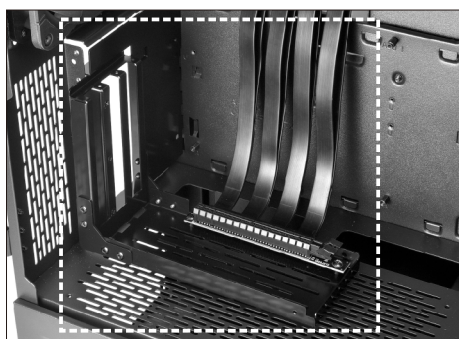

LANCOOL II - 1X Vertical GPU kit

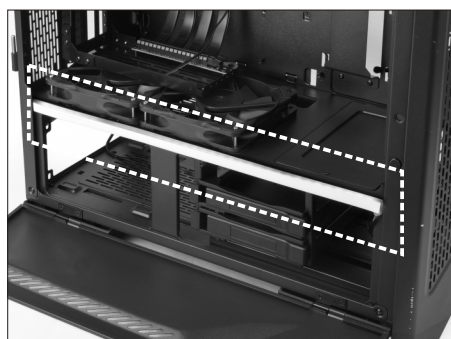

LANCOOL II - 2X Side Diffused LEDs strip

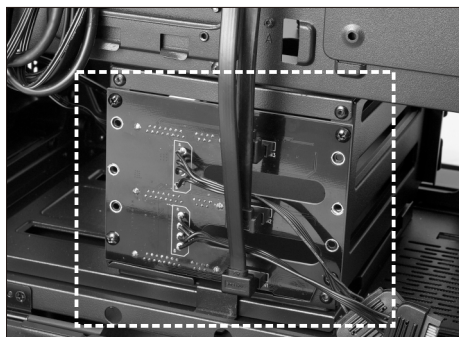

LANCOOL II - 3X Hot swappable back plate

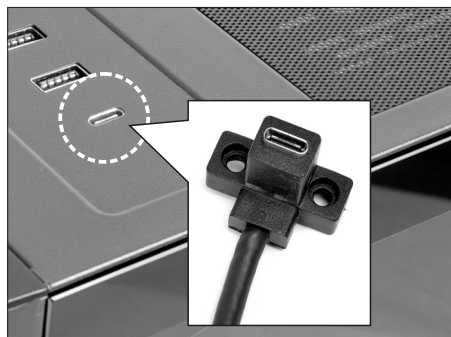

LANCOOL II - 4X 3.1 type C cable

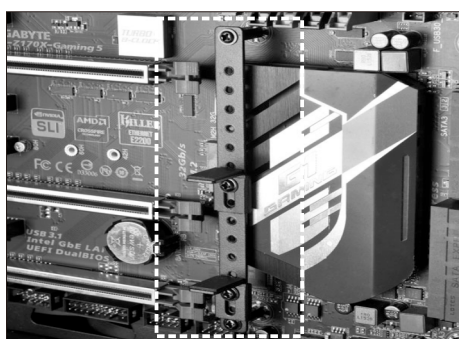

GB-001X Graphic card anti-sag bracket