

USB-C™ Single Monitor Docking Station - DisplayPort or VGA - 3x USB-A / 1x USB-C - GbE - 65W PD

Product Diagram (DKM30CHDPD/ DKM30CHDPDUE)

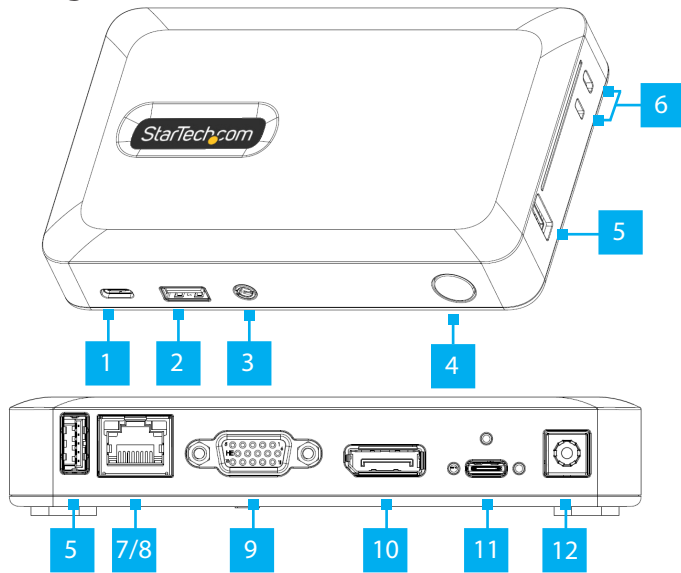

Component	Function
1 USB-C Port	<ul style="list-style-type: none"> SuperSpeed USB 5Gbps (USB 3.2 Gen 1) Connect a USB-C Peripheral Device to the USB-C Docking Station
2 USB-A Battery Charging Port	<ul style="list-style-type: none"> SuperSpeed USB 5Gbps (USB 3.2 Gen 1) Supports up to 5V at 1.5A, 7.5W charging Connect a USB-A Peripheral Device to the USB-C Docking Station Fast-charge USB Peripheral Devices that comply with USB Battery Charging specification Revision 1.2
3 3.5mm Audio Port	<ul style="list-style-type: none"> 4 Position Audio Jack for Headset use Connect an Audio Device
4 Power Button	<ul style="list-style-type: none"> Power the USB-C Docking Station on and off Integrated LED Indicator is illuminated white when the USB-C Docking Station is powered on

5	USB-A Port x 2	<ul style="list-style-type: none"> SuperSpeed USB 5Gbps (USB 3.2 Gen 1) Connect USB-A Peripheral Devices to the USB-C Docking Station
6	Lock/Nano Lock Slots	<ul style="list-style-type: none"> Connect a K-Slot or Nano K-Slot Style Locking Device Deter theft of the USB-C Docking Station
7	RJ45 Port	<ul style="list-style-type: none"> Connect a Network Device
8	RJ45 LEDs (above the RJ45 Port)	<ul style="list-style-type: none"> Left (Link Speed) LED: <ul style="list-style-type: none"> Amber = 1Gb Green = 100Mb None = 10Mb Right (Link State) LED: <ul style="list-style-type: none"> Solid Green = Link Detected Flashing Green = Network Activity
9	VGA Port	<ul style="list-style-type: none"> Connect a VGA Enabled Display Device
10	DisplayPort Port	<ul style="list-style-type: none"> Connect a DisplayPort Enabled Display Device
11	USB-C Host Port	<ul style="list-style-type: none"> SuperSpeed USB 5Gbps (USB 3.2 Gen 1) Power Delivery 3.0 Specification Connect a Host Laptop, using the Locking USB-C Host Cable
12	DC Power Input Port	<ul style="list-style-type: none"> Connect the Universal Power Adapter to supply power to the USB-C Docking Station Type-N barrel connector 19.5V 6.15A

Product Information

For the latest product information, technical specifications, manuals, and Declarations of Conformance please visit: www.startech.com/DKM30CHDPD or www.startech.com/DKM30CHDPDUE

Package Contents

- USB-C Dock x 1
- Locking USB-C Host Cable x 1
- (DKM30CHDPD) Universal Power Adapter (NA/JP, ANZ) x 1
- (DKM30CHDPDUE) Universal Power Adapter (UK, EU x 1)
- Quick-Start Guide x 1

Installation

Install Drivers

- Drivers will automatically install with an internet connection on Windows 10, macOS, ChromeOS, and Ubuntu. If drivers do not auto-install, please visit www.StarTech.com/DKM30CHDPD or www.StarTech.com/DKM30CHDPDUE to download the latest drivers.

Connect a Host

- Connect the **Locking USB-C Cable** (included) to the **Locking USB-C Host Port** on the rear of the **USB-C Docking Station** and to a **USB Port-C** on the **Host Laptop**.

Connect the Display Devices

- Connect a **DisplayPort Enabled Display Device** to the **DisplayPort Port** on the rear of the **USB-C Docking Station** using a **DisplayPort Cable**.

--OR--

- Connect a **VGA Enabled Display Device** to the **VGA Port** on the rear of the **USB-C Docking Station** using a **VGA Cable**.
 - *NOTE - VGA Port will be disabled when a DisplayPort Enabled Display Device is connected to the USB-C Docking Station.*

FCC Compliance Statement

This equipment has been tested and found to comply with the limits for a Class B digital device, pursuant to part 15 of the FCC Rules. These limits are designed to provide reasonable protection against harmful interference in a residential installation. This equipment generates, uses and can radiate radio frequency energy and, if not installed and used in accordance with the instructions, may cause harmful interference to radio communications. However, there is no guarantee that interference will not occur in a particular installation. If this equipment does cause harmful interference to radio or television reception, which can be determined by turning the equipment off and on, the user is encouraged to try to correct the interference by one or more of the following measures:

- Reorient or relocate the receiving antenna.
- Increase the separation between the equipment and receiver.
- Connect the equipment into an outlet on a circuit different from that to which the receiver is connected.
- Consult the dealer or an experienced radio/TV technician for help

This device complies with part 15 of the FCC Rules. Operation is subject to the following two conditions:

(1) This device may not cause harmful interference, and (2) this device must accept any interference received, including interference that may cause undesired operation. Changes or modifications not expressly approved by StarTech.com could void the user's authority to operate the equipment.

Industry Canada Statement

This Class B digital apparatus complies with Canadian ICES-003. Cet appareil numérique de la classe [B] est conforme à la norme NMB-003 du Canada. CAN ICES-3 (B)/NMB-3(B)

This device complies with Industry Canada licence-exempt RSS standard(s). Operation is subject to the following two conditions: (1) This device may not cause interference, and (2) This device must accept any interference, including interference that may cause undesired operation of the device.

Le présent appareil est conforme aux CNR d'Industrie Canada applicables aux appareils radio exempts de licence. L'exploitation est autorisée aux deux conditions suivantes:

(1) l'appareil ne doit pas produire de brouillage, et (2) l'utilisateur de l'appareil doit accepter tout brouillage radioélectrique subi, même si le brouillage est susceptible d'en compromettre le fonctionnement.

Use of Trademarks, Registered Trademarks, and other Protected Names and Symbols

This manual may make reference to trademarks, registered trademarks, and other protected names and/or symbols of third-party companies not related in any way to StarTech.com. Where they occur these references are for illustrative purposes only and do not represent an endorsement of a product or service by StarTech.com, or an endorsement of the product(s) to which this manual applies by the third-party company in question. StarTech.com hereby acknowledges that all trademarks, registered trademarks, service marks, and other protected names and/or symbols contained in this manual and related documents are the property of their respective holders.

Connect Peripherals

1. Connect an **Audio Device** to the **3.5 mm Audio Port** on the **USB-C Docking Station**.
2. (Optional) Connect a **USB-A Storage Device** or other **USB-A Peripheral** to the **USB-A Ports** on the front, side and/or rear of the **USB-C Docking Station**. Connect up to 3 total **USB-A Devices**.
3. Connect a **Network Device** to the **USB-C Docking Station**, using a **Cat5e/6 Network Cable**.

Power the Docking Station

1. Select the appropriate regional **Power Cord** and connect it to the **Universal Power Adapter**.
2. Connect the **Universal Power Adapter** to the **DC 19.5V Port** on the rear of the **USB-C Docking Station** and to an **AC Electrical Outlet**.
3. (Optional) Press and release the **Power Button** to power the **USB-C Docking Station** off and on. The **USB-C Docking Station** will be powered on by default when the **Universal Power Adapter** is first connected.

(Optional) Mounting

- To install a **Mounting Bracket** (sold separately), fasten the **Mounting Bracket** to the **USB-C Docking Station**, using the appropriate **Screws**. The **Screw** length should equal the thickness of the **Mounting Bracket** plus 2-4 mm.

Warranty Information

This product is backed by a three-year warranty.

For further information on product warranty terms and conditions, please refer to www.startech.com/warranty.

Limitation of Liability

In no event shall the liability of StarTech.com Ltd. and StarTech.com USA LLP (or their officers, directors, employees or agents) for any damages (whether direct or indirect, special, punitive, incidental, consequential, or otherwise), loss of profits, loss of business, or any pecuniary loss, arising out of or related to the use of the product exceed the actual price paid for the product. Some states do not allow the exclusion or limitation of incidental or consequential damages. If such laws apply, the limitations or exclusions contained in this statement may not apply to you.

Safety Measures

- Cables (including power and charging cables) should be placed and routed to avoid creating electric, tripping or safety hazards.

Mesures de sécurité

- Les câbles (y compris les câbles d'alimentation et de chargement) doivent être placés et acheminés de façon à éviter tout risque électrique, de chute ou de sécurité

安全対策

- ケーブル（電源ケーブルと充電ケーブルを含む）は、適切な配置と引き回しを行い、電気障害やつまづきの危険性など、安全上のリスクを回避するようにしてください。

Misure di sicurezza

- I cavi (inclusi i cavi di alimentazione e di ricarica) devono essere posizionati e stesi in modo da evitare pericoli di inciampo, rischi di scosse elettriche o pericoli per la sicurezza.

Säkerhetsåtgärder

- Kablar (inklusive elkablar och laddningskablar) ska dras och placeras på så sätt att risk för snubblingsolyckor och andra olyckor kan undvikas.

StarTech.com Ltd.

45 Artisans Crescent
London, Ontario
N5V 5E9
Canada

StarTech.com LLP

4490 South Hamilton
Road
Groveport, Ohio
43125
U.S.A.

StarTech.com Ltd.

Unit B, Pinnacle 15
Gowerton Road
Brackmills,
Northampton
NN4 7BW
United Kingdom

StarTech.com Ltd.

Siriusdreef 17-27
2132 WT Hoofddorp
The Netherlands

FR: startech.com/fr
DE: startech.com/de
ES: startech.com/es
NL: startech.com/nl
IT: startech.com/it
JP: startech.com/jp