

TCL

3.1.2 Channel Dolby Atmos Sound Bar with Wireless Subwoofer

TS8132

User Manual



Contents

1	Before you begin	3
<hr/>		
2	Welcome	8
	What's in the box	8
	Overview of the Sound Bar	10
	Overview of the wireless subwoofer	12
	Set up your Sound Bar system	13
	Position Your Sound Bar and Subwoofer	13
	Mount your Sound Bar on the wall	14
	Install/replace the remote control batteries.....	18
	Overview of the Remote Control	19
<hr/>		
3	Connect your Sound Bar system	21
	Connect with the HDMI cable	21
	Optional: Connect your Blu-ray player	23
	Connect with the optical cable	24
	Direction for setting up your Sound Bar using an optical cable	25
	Connect your Sound Bar to power supply	26
	Connect the Sound Bar with your Bluetooth device	27
	Add in Google home	28
	Add in AirPlay 2	29

Setting up Works With Alexa	30
Connect your wireless subwoofer to the Sound Bar.....	32
Online Firmware Update	33

4 Use your Sound Bar system.....	34
Use your Sound Bar with the top panel or remote control	34
Listen to music from your Bluetooth device	37
Use the USB cable or device for music playback	38

5 Specifications	38
-------------------------------	-----------

6 Trademarks	40
---------------------------	-----------

7 FAQ	42
--------------------	-----------

1 Before you begin

- Carefully read and observe all safety instructions in the safety leaflet.
- This soundbar is intended for indoor use only. In case it accidentally gets in contact with small amounts of water, unplug immediately and use a dry cloth to remove the water.
- Unplug the soundbar if it is not used for long periods of time or during lightning storms.
- Make sure the soundbar is installed on a solid surface or solidly wall-mounted below your TV for the best experience.
- Only use AAA 1.5V non-rechargeable batteries for the remote control.
- In case any of the cables are visibly damaged or pinched, unplug the soundbar and replace the cable.
- Be careful not to sharply bend the HDMI and optical cable as they may affect the performance.
- Protect your hearing by adjusting to a proper volume. Predefined and customizable sound settings are available for your listening comfort.

Important safety instructions

Make sure you read all the safety information before you use this product.

TCL Entertainment Solutions Limited bears no responsibility for accidents or damages caused by unauthorized changes, modifications or improper use of the product.



CAUTION

RISK OF ELECTRIC SHOCK
DO NOT OPEN



CAUTION: TO REDUCE THE RISK OF ELECTRIC SHOCK, DO NOT REMOVE COVER (OR BACK). NO USER-SERVICEABLE PARTS INSIDE. REFER SERVICING TO QUALIFIED SERVICE PERSONNEL.



The lightning flash with arrowhead symbol, within an equilateral triangle is intended to alert the user to the presence of uninsulated dangerous voltage within the product's enclosure that may be of sufficient magnitude to constitute a risk of electric shock.



The exclamation point within an equilateral triangle is intended to alert the user to the presence of important operating and maintenance (servicing) instructions in the literature accompanying the product.



This symbol indicates that this product incorporates double insulation between hazardous main voltage and user accessible parts. When servicing, use only identical replacement parts.

Warnings

- To reduce the risk of fire or electric shock, do not expose this product to rain or moisture. This product should not be exposed to dripping or splashing. No objects filled with liquids, such as vases, should be placed on or near the product.
- The product is unstable if it is not properly placed or mounted to the wall. Be sure to follow the wall mounting instructions provided in the user manual to ensure your safety.
- Do not expose batteries to excessive heat such as sunshine, fire, and so forth.

Safety

- **Read these instructions** - Read all the safety and operating instructions before operating the product.
- **Retain these instructions** - Retain the safety and operating instructions for future reference.
- **Heed all warnings** - Adhere to all warnings on the product and in the operating instructions.
- **Follow all instructions** - Follow all operating and use instructions.
- **Do not use this apparatus near water** - The appliance should not be used near water or moisture – for example, in a wet basement or near a swimming pool and the like
- **Clean only with a dry cloth.**
- **Do not block any ventilation openings.** Install in accordance with the manufacturer's instructions.
- **Do not install near any heat sources** such as radiators, heat registers, stoves, or other apparatus (including amplifiers) that produce heat.
- **Do not defeat the safety purpose** of the polarized or grounding-type plug. A polarized plug has two blades with one wider than the other. A grounding type plug has two blades and a third grounding prong. The wide blade or the third prong are provided for your safety. If the provided plug does not fit into your outlet, consult an electrician for replacement of the obsolete outlet.
- **Protect the power cord** from being walked on or pinched particularly at plugs, convenience receptacles, and the point where it exits from the product.
- **Use only attachments/accessories** specified by the manufacturer.



- **Use only with the cart**, stand, tripod, bracket, or table specified by the manufacturer, or sold with the apparatus. When a cart is used, use caution when moving the cart/apparatus combination to avoid injury from tip-over.
- **Unplug this apparatus** during lightning storms or when unused for long periods of time.
- **Refer all servicing** to qualified service personnel. Servicing is required when the apparatus has been damaged in any way, such as power-supply cord or plug damaged, liquid has been spilled or objects have fallen into the apparatus, the apparatus has been exposed to rain or moisture, does not operate normally, or has been dropped.
- **This appliance is** not intended for use by young children or infirm persons without supervision. Young children should be supervised to ensure that they do not play with the appliance.

Cautions

- Do not place any sources of danger on the product (for example: liquid filled objects, lighted candles).
- Disconnect the power cord to shut off when find trouble or not in use. The power cord shall be readily operable.
- Use of controls or adjustments or performance of procedures other than those described herein, may result in hazardous radiation exposure or other unsafe operation.
- The power cord/appliance coupler is used as the disconnect device, the disconnect device must remain readily operable.
- The rating label is located at the bottom or back of the product.
- The use of apparatus in tropical and moderate climates.

Battery precautions

- Do not mix batteries (old and new or carbon and alkaline).
- Do not dispose of batteries in fire or water.
- Recycle or dispose of batteries as per state and local guidelines.
- Danger of explosion if battery is incorrectly replaced. Replace only with the same or equivalent type.
- When the remote control is not to be used for a long time (more than a month), remove the battery from the remote control to prevent it from leaking.

- If the batteries leak, wipe away the leakage inside the battery compartment and replace the batteries with new ones.
- Keep away the batteries from heat or moisture.
- Do not carry or store batteries with other metallic objects. Doing so could cause batteries to short circuit, leak or explode.
- Never recharge a battery unless it is confirmed to be a rechargeable type.

For 5G WIFI Device

The device for operation in the band 5150–5350 MHz is only for indoor use to reduce the potential for harmful interference to co-channel mobile satellite systems.

Disposal of your old product and battery

Your product is designed and manufactured with high quality materials and components, which can be recycled and reused.

This product may contain lead and mercury. Disposal of these materials may be regulated due to environmental considerations. For disposal or recycling information, please contact your local authorities.

This product contains batteries:

- Do not incinerate. Batteries may explode if overheated.
- For disposal or recycling information, please contact your local authorities.

CAUTION: Risk of explosion if the battery is replaced by an incorrect type.

CAUTION: replacement of a battery with an incorrect type that can defeat a safeguard.

CAUTION: disposal of a battery into fire or a hot oven, or mechanically crushing or cutting of a battery, that can result in an explosion;

CAUTION: leaving a battery in an extremely high temperature surrounding environment that can result in an explosion or the leakage of flammable liquid or gas.

CAUTION: a battery subjected to extremely low air pressure that may result in an explosion or the leakage of flammable liquid or gas.

2 Welcome

Congratulations on the purchase of your new TCL Sound Bar! After it is set up and connected, you can experience a superb sound quality and state-of-the-art design to best fit your home entertainment system. You are recommended to read through this user manual which helps you set up, connect and operate the product easily and properly.

Let's get started.

What's in the box

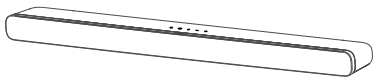

Sound Bar

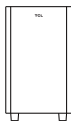

Wireless Subwoofer



Remote control



AAA battery x 2

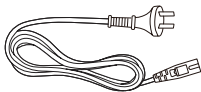

AC power cord x 2

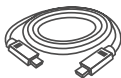

HDMI cable

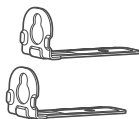

Wall mount bracket x 2



Wall anchor x 2

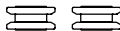

Sleeve x 2



Wall mounting screw x 2



Warranty card x 2

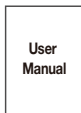

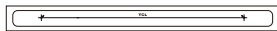

User Manual



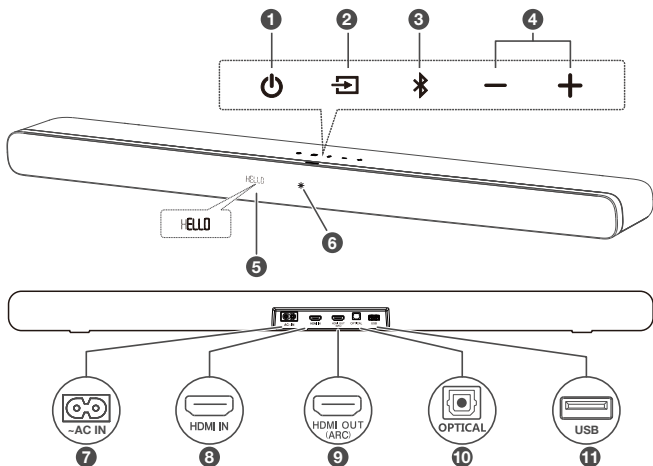

Wall mount template

Overview of the Sound Bar



- 1 

Short press to enter Sleep or Standby mode.
Long press to enter Standby mode.
- 2 

Press to switch the audio source among
HDMI ARC/HDMI IN/OPT/BT/USB modes.
- 3 

Press to select the Bluetooth function. Press and hold
to enter the pairing mode.

4 **+ / -**

Press to increase or decrease the volume level.

5 **LED indicator**

It indicates the Sound Bar status (e.g. volume level, sound bar status).

6 **White LED:**

It indicates standby/sleep mode.

7 **AC input power connector**

8 **HDMI IN connector**

9 **HDMI OUT (ARC) connector**

10 **Optical input connector**

11 **USB Type A connector (only for music playback)**

Overview of the wireless subwoofer

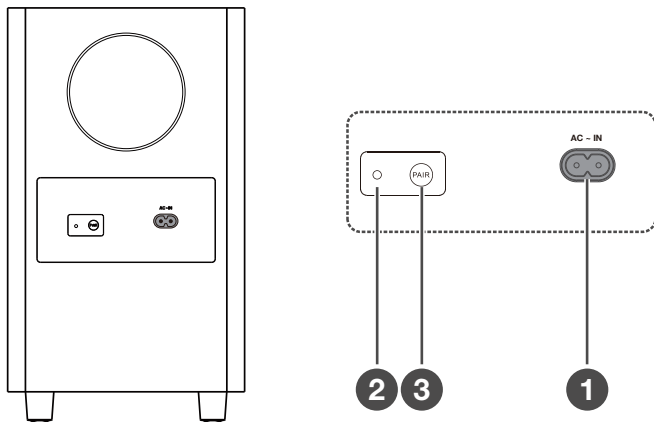

1 AC input power connector

2 Amber LED indicator

- flashes slowly when the subwoofer is in standby mode.
- flashes quickly when pairing is in progress.
- remains on solidly when pairing is successful.

3 PAIR

Press and hold  button on the Sound Bar main unit for 5 seconds. Press and hold **PAIR** button on the subwoofer until pairing is complete. And then the amber LED light will be solid up on the subwoofer.

Note

- Manual pairing is needed only in case of troubleshooting.

Set up your Sound Bar system

Notes

- Make sure you read all the safety information before you mount the Sound Bar main unit on the wall.
- Make sure you use screws provided or specified by the authorized manufacturer.
- TCL Overseas Marketing Limited bears no responsibility for accidents or damage caused by improper wall mounting and screws installation or insufficient wall strength, etc.
- Additional tools (not supplied) are required for installation.
- You can choose to place your Sound Bar below the center of your TV or mount it on the wall.

Position Your Sound Bar and Subwoofer

The ideal place to position the Sound Bar main unit is centered underneath your TV.

You are recommended to place the Sound Bar main unit on the top of the cabinet and right below the center of your TV. The distance between the subwoofer and the Sound Bar main unit should be less than 3m.

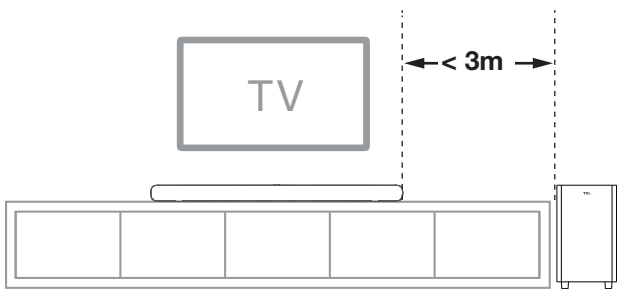

Mount your Sound Bar on the wall

- 1 Place the supplied wall mount template on the wall. Make sure the wall mount template is at least 5cm below the center of the TV.
- 2 Use a level to make sure the wall mount template is positioned accurately.
- 3 Use tape to stick the wall mount template firmly on the wall.

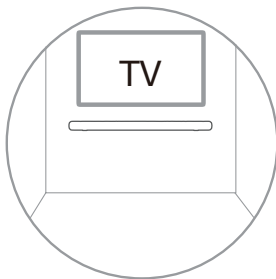

- 4 Mark on the wall using each marking on the template through the mounting holes.
- 5 Take away the wall mount template.
- 6 Drill a screw hole at each marking on the wall.

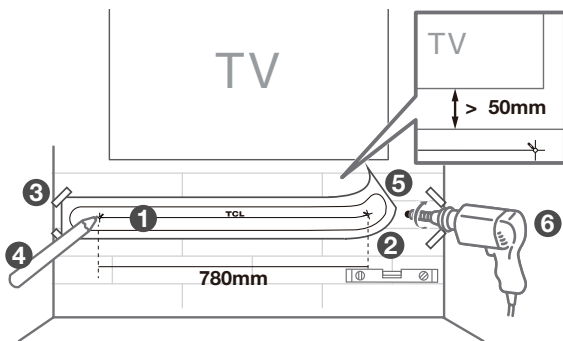

- 7 Screw off the rubber cushions from the soundbar.
(Reserve the rubber cushions for future use)
- * The rubber cushions can be used as soundbar mats when you put the soundbar on the table
- 8 Screw on the wall mount brackets to the soundbar.
- 9 Insert the supplied screws with the sleeves into the hole of the wall anchors.

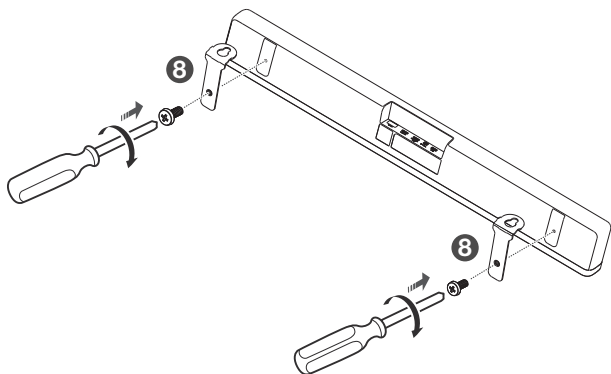
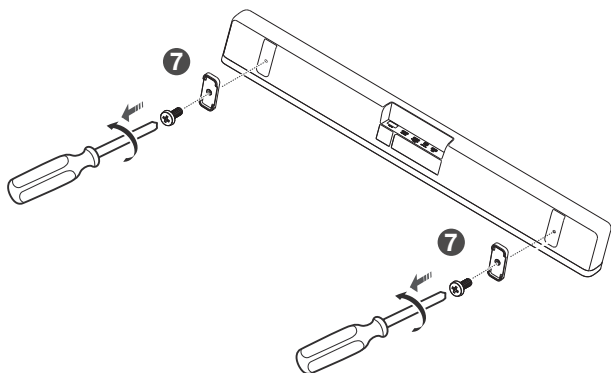

- 10 Fix and tighten the wall bracket screws on the wall.
- 11 Hang the Sound Bar on the screws.

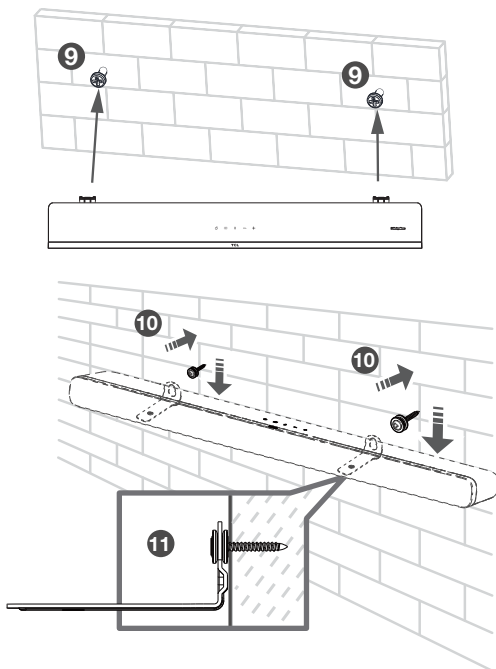

Notes

- Check the installation location before you mount the Sound Bar on the wall (see 'Mount your Sound Bar on the wall' on page 14).
- You may consider to connect the cables first before mounting the Sound Bar on the wall.

Install/replace the remote control batteries

Warnings

- *Danger of explosion if battery is incorrectly replaced. Replace only with the same or equivalent type.*

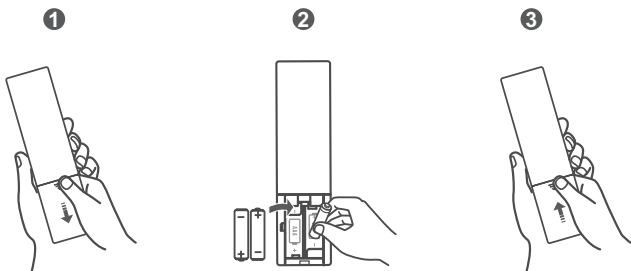

- 1 Open the battery compartment, remove the old batteries if necessary.
- 2 Place two new AAA batteries into the battery compartment with the correct polarity (+/-).
- 3 Close the battery compartment.





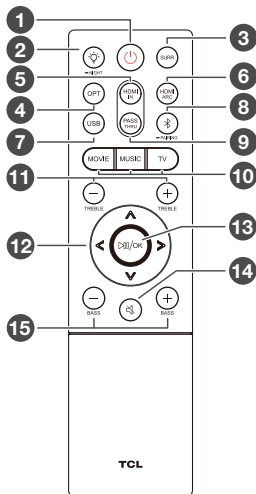





Setup is complete. Your Sound Bar is ready to use. For more information about how to access different connection options on your Sound Bar, see the following chapter.

Overview of the Remote Control

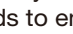

- 1  Short press to enter Sleep or Standby mode.
Long press to enter Standby mode.
- 2  Press to adjust the lightness of the display.
Press and hold for 3 seconds to enter Night mode or close Night mode.
- 3 **SURR**
Press to turn on/off Dolby vertical surround.
- 4 **OPT**
Press to switch the audio source to Optical mode.
- 5 **HDMI IN**
Press to switch the audio source to HDMI IN source.

- 6 **HDMI ARC**
Press to switch the audio source to HDMI OUT (ARC) source.
- 7 **USB**
Press to switch the audio source to USB source.
- 8 
Press to switch the audio source to Bluetooth mode.
Press and hold to enter pairing mode.
- 9 **PASS THRU**
Press to switch on/off Pass Through function.
- 10 **MOVIE / MUSIC / TV**
Press to select the equalizer (EQ) effect when you are watching **TV**, **movie** or listening to **music**.
- 11 **TREBLE** 
Increase or decrease the treble sound effect.
- 12 
Switch to previous or next music. (Under Bluetooth or USB mode)

Decrease or increase the volume level.
- 13 /OK
Press to play/pause the music. (Under Bluetooth or USB mode)
In Standby or Sleep mode, press and hold for 5 seconds to enter Menu, and then press / to view options. And press OK to confirm.
- 14 
Press to mute or unmute the sound.
- 15 **BASS** 
Increase or decrease the bass sound effect.

3 Connect your Sound Bar system

After you have fixed the position of the Sound Bar, you can start connecting it to your TV or other devices and listen to the audio through your Sound Bar. Make sure you have muted the audio of your TV or device. For information, check the user manual of your TV or device.

Connect with the HDMI cable

Note

- Make sure your TV or device supports the HDMI ARC feature. For information, check the user manual of your TV or device.

Connect one end of the HDMI cable to the HDMI ARC input connector on your Sound Bar and another end to the HDMI ARC output connector of your TV or device.

To get the best possible audio experience using the HDMI cable, follow below given steps:

For TCL TV:

- ➊ Connect HDMI cable from the HDMI (ARC) interface on the sound bar to the HDMI (ARC/eARC) interface on the TV. Connect power cord.
- ➋ Enable the CEC function in the settings of the TCL TV.

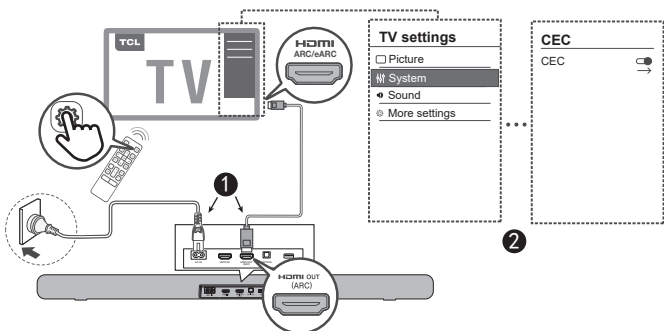

For other TV brands:

- ① Connect HDMI cable from the HDMI (ARC) interface on the sound bar to the HDMI (ARC/eARC) interface on the TV. Connect power cord.
- ② Enable the CEC function in the settings of the TV.

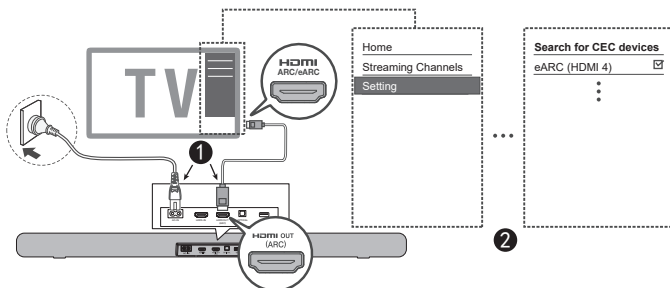

★ CEC (Consumer Electronic Control) function naming may differ by TV manufacturer. This feature may be called CEC, Anynet+, SimpLink, BRAVIA Link, EasyLink or VIERA Link. Please see your TV's user manual for more information.

Optional: Connect your Blu-ray player

For ease of use, you are advised to connect a Blu-ray player to the TV and enjoy the Sound Bar through HDMI-ARC. However, in order to enjoy **Dolby TrueHD** based **Atmos** content that not all TVs may support through HDMI-ARC, you can optionally connect your Blu-ray player directly to the Sound Bar using the HDMI-in port.

Notes

- The Sound Bar will pass on the video signal to the TV. If it is not successful, turn on the Sound Bar and try again.
- The HDMI input supports UHD (4K) and that it can also be used for game console to enjoy Dolby Atmos audio.

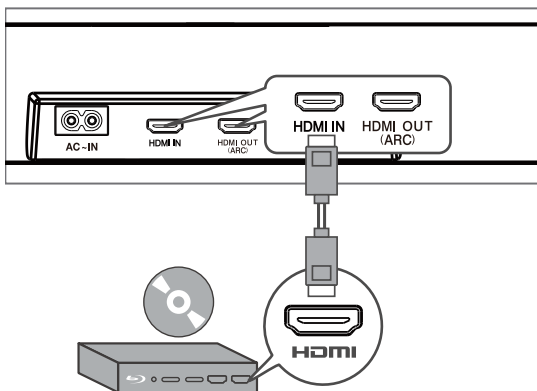

Connect with the optical cable

- 1 Remove the protective caps from the optical cable when necessary.
- 2 Connect one end of the optical cable to the optical input connector on your Sound Bar and another end to the optical output connector of your TV or device.

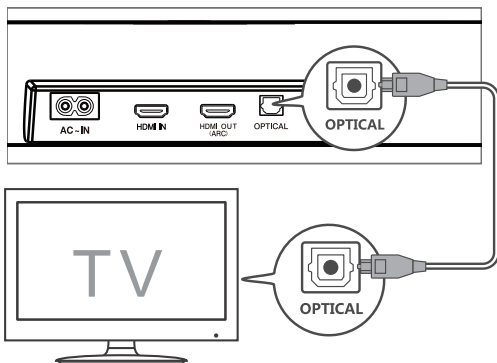

Note

- If there is no sound output from the Sound Bar, try to activate the PCM signal output on your TV or device. PCM is used to convert analog audio signals into digital audio signals in most devices. For more information of how to activate the PCM signal output, check the user manual of your TV or device.

Direction for setting up your Sound Bar using an optical cable



Do not bend or kink the optical cable (SPDIF) as it is fragile and can easily get damaged and broken.

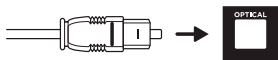

To get the best possible audio experience using the optical cable:

- 1 Press the Home button on your TCL TV Remote.
- 2 Navigate to **Audio option** under **Settings**.
- 3 Uncheck the “**TV speaker enabled**” option.
- 4 Under **S/PDIF** and **ARC**, select **PCM-Stereo**.

Notes

- *Different devices may have different menu options.*
- *Devices such as Blu-ray players, set-top boxes, etc. are also applicable.*

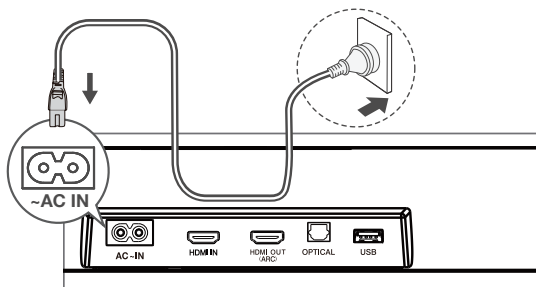

Connect your Sound Bar to power supply

- 1 Make sure that you have completed all other connections before connecting the Sound Bar to power supply.
- 2 Make sure the power supply voltage complies with your country's safety standards (see 'Specifications' on page 38)
- 3 Connect one end of a supplied AC power cord to the AC input connector on your Sound Bar and another end to the power socket on the wall.



Connect the Sound Bar with your Bluetooth device

Notes



- Make sure your wireless device supports the Bluetooth function.
 - The operational range between the Sound Bar and your Bluetooth device is approximately 10m (without any obstacle between the Bluetooth device and the Sound Bar).
- 1 Press  on the top panel of your Sound Bar or remote control to power on the Sound Bar.
 - 2 Press and hold  on the top panel of your Sound Bar or remote control.
→ **PAIR** is flashes on the LED display. The Sound Bar is ready to pair.
 - 3 Power on your Bluetooth device and activate its Bluetooth function.
 - 4 Select **TCL 8132 Sound Bar** on the pairing list of your Bluetooth device.
→ You hear distinct double beep sound.

Tip

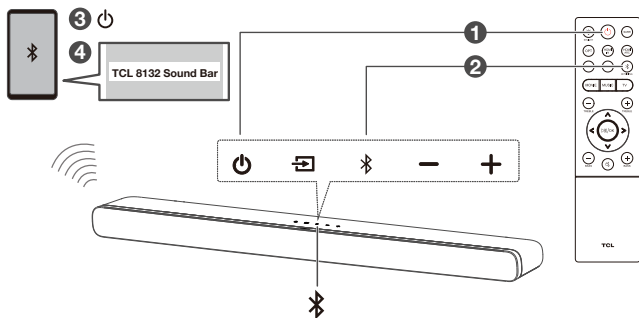
- If you cannot find the model name **TCL 8132 Sound Bar** on your Bluetooth device, press and hold  on the remote control. You will see **PAIR** . Now the Sound Bar is coming into the pairing mode.



Your Sound Bar system is now set up and ready to be used.

- 5** To disconnect the Bluetooth function, you can:
- press  on the Sound Bar or remote control to switch to another source; or
 - disable the Bluetooth function on your device; or
 - press and hold  on the remote control for 3 seconds.

Add in Google home

1. Power on the sound bar.
2. On an Android phone, open the Google Home app and continue with step 3.
3. In the Google Home app, make sure you are signed in and follow the on-screen instructions to complete the setup process.
4. Once setup is complete via step 3, you are now connected to your network and Wi-Fi. Now you can enjoy Chromecast built-in from any device on the same network.

5. After this setup you may see a message on the sound bar display that there is new software available (NEW SW OK/NOT"). Please press "Play-Pause/OK" button on your remote control to download software and upgrade your sound bar or any other key to skip for now.

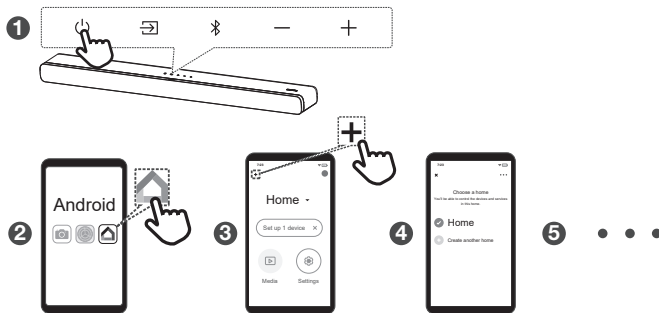

Add in AirPlay 2

1. Power on the sound bar.
2. On an iOS device, go to Settings > Wi-Fi and continue with step 3.
3. For the Airplay 2, in Settings > Wi-Fi, look for "TCL 8132 Sound Bar" under "SETUP AS NEW AIRPLAY SPEAKER" and complete the setup process.
4. Once setup is complete via step 3, you are now connected to your network and Wi-Fi. Now you can enjoy AirPlay from any device on the same network.
5. After this setup you may see a message on the sound bar display that there is new software available (NEW SW OK/NOT"). Please press "Play-Pause/OK" button on your remote control to download software and upgrade your sound bar or any other key to skip for now.

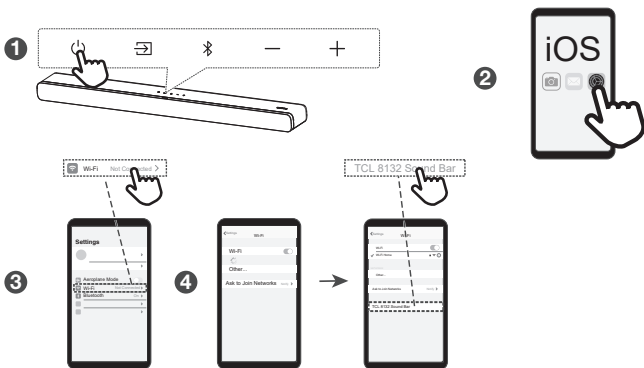

Setting up Works With Alexa

1. Press and hold the ➤ (next) button on the sound bar remote for 5s until the display on the sound bar shows ALEXA SETUP
2. Now open the Alexa app on your device.
3. If the Alexa app indicates that your Bluetooth function is not turned on, go to the Settings and activate Bluetooth
4. In the Alexa app, select the Devices tab and use the "+" button to add a new device.
5. Select "Speaker" for the kind of device and "TCL" as the brand.
6. You will now be asked to select the Wi-Fi network you want the sound bar to connect to. This is typically the same Wi-Fi network as your phone is using. You may need to enter the Wi-Fi network's password.
7. After a short while, you will be asked to try out some examples on how to use the soundbar and after this, the display on the sound bar shows ALEXA READY. Your setup is now complete.

Note: This setup requires you to install the Alexa app from the App Store or Google Play. If you open the Alexa app you may automatically be invited to set up your sound bar, in this case just follow the steps. Otherwise proceed with the steps below.

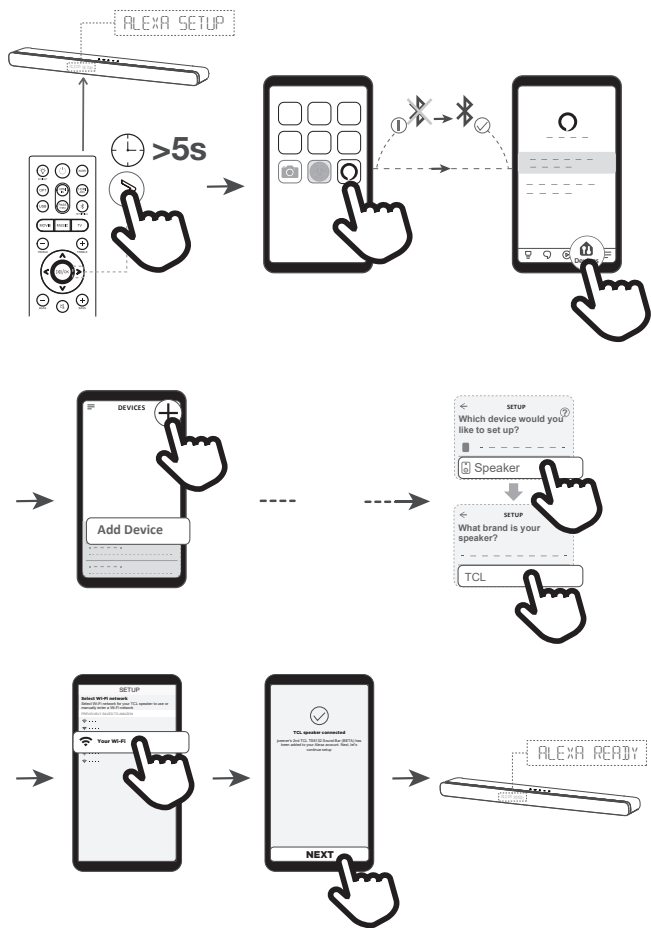

Connect your wireless subwoofer to the Sound Bar

When the wireless subwoofer is connected, you can enjoy powerful deep bass sounds and a truly immersive audio experience.

Auto pairing

Make sure both the Sound Bar and wireless subwoofer are connected to the power supply and are turned on.

- The Sound Bar will pair with the subwoofer automatically.
- The amber LED will flash when pairing is in progress.
- The amber LED will remain on solidly when pairing is successful.

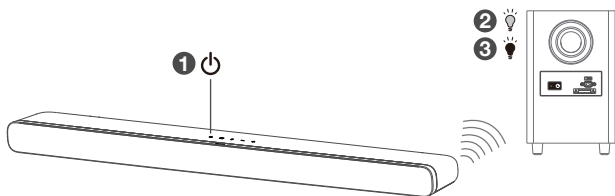

If you have more than one device to be connected, please connect the next one after connecting the previous one successfully.

Online Firmware Update

Automatic detection and upgrade of Sound Bar software:

1. Ensure your Sound Bar and Subwoofer are both powered up.
2. Ensure your Sound Bar and Subwoofer pair successfully.
3. Ensure your Sound Bar is connected to Wi-Fi successfully (Refer to 8a and 8b.)
4. You will see the following LED indications:
UPDATE FOUND > DOWNLOADING > UPGRADING > UPGOK

Note: Do not interrupt the Sound Bar and subwoofer during the upgrading.

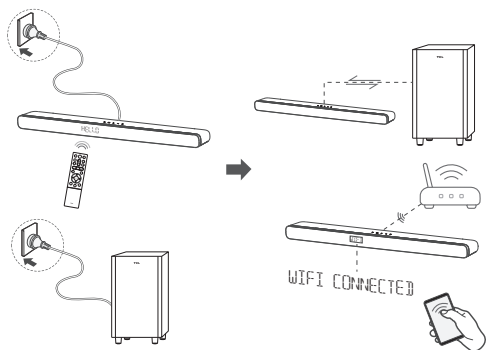

4 Use your Sound Bar system

Use your Sound Bar with the top panel or remote control

- 1 Make sure the Sound Bar is properly connected to the power supply and sources.
- 2 Press  at the top panel of your Sound Bar main unit or remote control to switch to the correct source.

The LED display on the Sound Bar gives you information about the status of the Sound Bar.

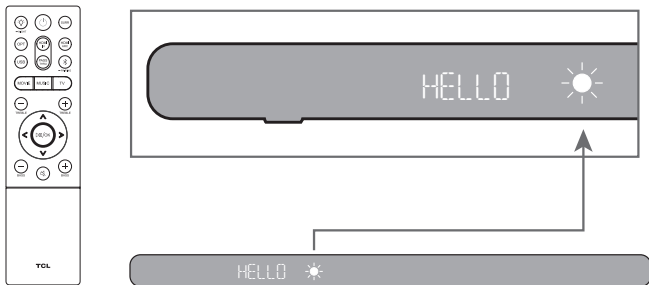

Remote Control	LED Indications	Remarks
	HELLO START READY SLEEP SLEEPY	*Power on/off
OPT HDMI IN HDMI ARC USB PASS THRU BT CONNECTED	OPT HDMI 1 IN HDMI 2 ARC USB BT PAIR CONNECTED PASS THROUGH	*Input source *Connect your Blu-ray player via HDMI IN to use PASS THRU
MOVIE MUSIC TV	MOVIE MUSIC TV	Set preferred sound
2s	NIGHT	Reduced dynamics
	SURR ON/OFF	Enhanced surround effect
TREBLE -3 TREBLE +3 BASS -3 BASS +3		Increase or decrease treble or bass level
^ v 	V 20 V MAX V MIN MUTE	Volume Mute/unmute
< >	PAUSE	Previous, next music or pause on USB mode
	DIM 1 DIM 2	Set display brightness
	--X--	Not support
	AIRPLAY READY	Ready to work with AirPlay
	CAST READY	Ready to work with Chromecast
	ALEXA READY	Ready to work with Alexa
	UPDATE FOUND DOWNLOADING UPG UPG OK	Upgrade via OTA
	SUB PAIR SUB CONNECTED	Pair your subwoofer manually
	DOLBY ATMOS DOLBY SURROUND PCM AUDIO	Audio format detected



Note: After powering on your Sound Bar, if there is no operation performed on either the Sound Bar or remote control within 10 seconds, all LED indicators on the Sound Bar will turn off and light up again when the operation is resumed.

Tip: You can use more advanced functions on the remote control (see 'Overview of the remote control' on page19).

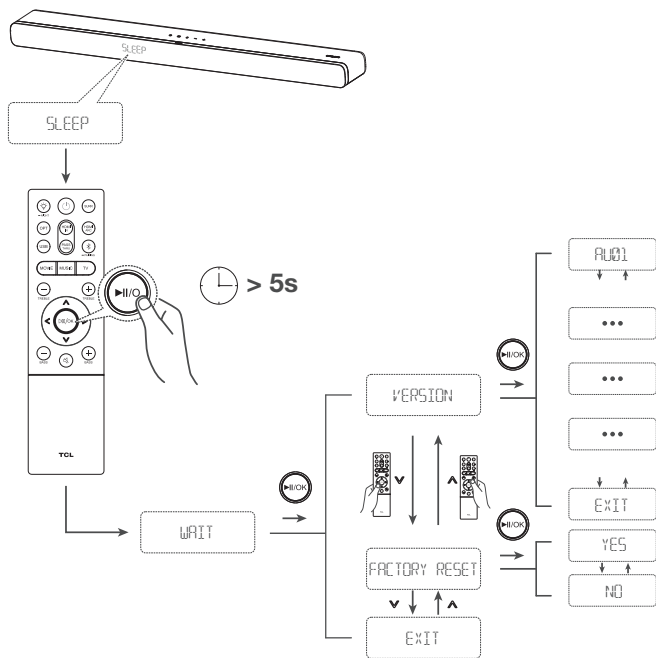
Sound Bar Settings







Listen to music from your Bluetooth device

- 1 Make sure that your device supports A2DP and/or AVRCP. For information, check the specification of your device.
- 2 Pair your Bluetooth device with the Sound Bar (see 'Connect the Sound Bar with your Bluetooth device' on page 27).
- 3 Start listening to music stored in your Bluetooth device through the Sound Bar.
 - If your Bluetooth device supports A2DP, you can listen to music, but you cannot control the playback.
 - If your Bluetooth device supports AVRCP, you can listen to music and control music playback with the remote control. Press  to pause or resume music playback. Press  /  to skip to the previous/next track.

Note

- The operational range between the Sound Bar and your Bluetooth device is approximately 10 meters (without any obstacle between the Bluetooth device and Sound Bar).

Use the USB cable or device for music playback

- Press /OK on the remote control to listen to/pause/resume the music.
- Press  or  on the remote control to skip to the previous or next track.
- Press  or  to increase or decrease the volume level.

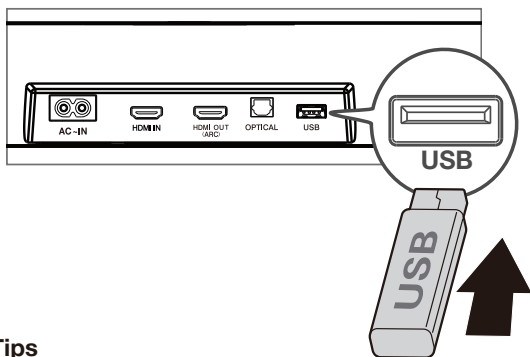

Tips

- This Sound Bar can support USB devices of up to 64GB memory and the supported file format is MP3.
- Music in folders of the USB device should be within 5 (including 5) directory levels. Otherwise, the sound bar can not detect the music.

5 Specifications

Product Name

3.1.2 Channel Dolby Atmos Sound Bar with Wireless Subwoofer Sound Bar

- Power Supply: AC 100-240V ~ 50/60Hz
- Power consumption: 30W
- Power consumption at standby mode: $\leq 0.5W$
- Impedance: $6\ \Omega$
- Frequency response: 160Hz-20KHz
- Dimensions (WxHxD): 1000x65x122(mm)
- Weight: 7.3 lbs (3.3 kg)
- Operating temperature: $0^{\circ}C - 45^{\circ}C$

Wireless subwoofer

- Power Supply: AC 100-240V ~ 50/60Hz
- Power consumption: 30W
- Power consumption at standby mode: $\leq 0.5W$
- Frequency response: 40 Hz-120 Hz
- Frequency range: 5727MHz-5848MHz
- Max transmitting power: 13dBm
- Dimensions (WxHxD): 200x350x200(mm)
- Weight: 7.7 lbs (3.5 kg)

Bluetooth

- Bluetooth version: 5.0, Bluetooth profile - Bluetooth stereo supported (Advanced Audio Distribution Profile - A2DP; Audio Video Remote Control Profile - AVRCP)
- Frequency range: 2402 Mhz – 2480 Mhz
- Max transmitting power: 15dBm

Remote control

- Distance/Angle: 6m/ 30°
- Battery type: 1.5V AAA battery x 2, user replaceable.

Wi-Fi

WLAN Standard	IEEE802.11a/b/g/n/ac
Security	WPA2 TM /WPA TM
Frequency range	<u>2.4 GHz band (1-13 ch)</u> 2412 MHz to 2472 MHz <u>5 GHz band</u> 5150 MHz to 5350 MHz 5470 MHz to 5600 MHz 5650 MHz to 5725 MHz 5725 MHz to 5850 MHz

Maximum power(EIRP) 20 dBm

Restrictions in the 5 GHz band:

The 5150 to 5350 MHz frequency range is restricted to indoor use only.

6 Trademarks



The Bluetooth® word mark and logos are registered trademarks owned by Bluetooth SIG, Inc. and any use of such marks by TTE Corporation is under license. Other trademarks and trade names are those of their respective owners.



Dolby, Dolby Atmos, and the double-D symbol are registered trademarks of Dolby Laboratories Licensing Corporation. Manufactured under license from Dolby Laboratories. Confidential unpublished works. Copyright © 2012-2021 Dolby Laboratories. All rights reserved.

Works with Apple AirPlay



To control this AirPlay 2-enabled speaker, iOS 11.4 or later is required. Apple, AirPlay, iPhone are trademarks of Apple Inc., registered in the U.S. and other countries.

Chromecast built-in



Google and Chromecast built-in are trademarks of Google LLC.



The Adopted Trademarks HDMI, HDMI High-Definition Multimedia Interface, and the HDMI Logo are trademarks or registered trademarks of HDMI Licensing Administrator, Inc. in the United States and other countries.

works with Hey Google



Google and Chromecast built-in are trademarks of Google LLC.

COMPATIBLE WITH



Dolby, Dolby Vision, Dolby Atmos, and the double-D symbol are registered trademarks of Dolby Laboratories Licensing Corporation. Manufactured under license from Dolby Laboratories. Confidential unpublished works. Copyright © 2012–2021 Dolby Laboratories. All rights reserved.

works with Alexa



Amazon, Alexa and all related logos are trademarks of Amazon.com, Inc. or its affiliates.

7 FAQ

No power

- Make sure the AC power cord and AC input connector are connected properly.
- Make sure there is power supply.
- Make sure the Sound Bar has turned on.

No sound

- Make sure the audio cable is connected to the Sound Bar and your device.
- Make sure you have selected the correct source.
- Press **▲** to increase the volume level.
- Make sure the Sound Bar is not muted.

Low voice

- Use the remote control to adjust the volume.
- May open Night mode, please press  for 3 seconds to exit the Night mode.

* Other EQs cannot be selected in Night Mode.

The remote control does not work.

- Make sure you have selected the correct source.
- Make sure the distance of remote control and the Sound Bar is within operational range.
- Make sure the battery is correctly inserted and is working.
- Make sure the remote control is close to the remote control sensor of the Sound Bar.

I hear distorted sound.

- Make sure all cables are properly connected.
- Make sure you have selected the correct source.
- Make sure the TV is muted if you play audio from the TV.

I cannot find the Bluetooth name of this Sound Bar on my Bluetooth device.

- Make sure the Bluetooth function is activated on your Bluetooth device.
- Make sure the Sound Bar has paired with your Bluetooth device.

WE ARE READY TO HELP

contact us first
with any questions



TCL Electronics Australia Pty Ltd.

ABN 83 111 032 896

Telephone: 1300 738 149

service.au@tcl.com

www.tcl.com/au

TCL Electronics New Zealand Pty Ltd.

NZBN 9429043411917

Telephone: 0800 449 750

service.nz@tcl.com

www.tclelectronics.co.nz

