



# DELTA MAX RGB SSD

USER MANUAL

VERSION 01

TEAMGROUP 



TEAMGROUP Inc.

[www.teamgroupinc.com](http://www.teamgroupinc.com)

3F, No.166, Jian 1st Rd., Zhonghe Dist., New Taipei City 23511, Taiwan (R.O.C.)

TEL: +886-2-8226-5000 | FAX: +886-2-8226-5808

The DELTA MAX RGB SSD product package contains



DELTA MAX RGB SSD

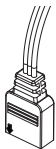

5V ARGB 3 pin  
to Micro B Cable

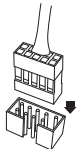

5V USB 10 pin  
to Micro B Cable



Cleaning cloth

## DELTA MAX RGB SSD

There are two ways to control DELTA MAX RGB SSD light effect. According to the corresponding light control source, only one kind of cable can be used for each mode.

- Sync mode uses 5V ARGB 3 pin to Micro B Cable.
- Initial Rainbow light effect uses USB 10 Pin to Micro B cable.
- When using the synchronous light effect (use 5V ARGB 3 pin to Micro B Cable connection), if there is already 5V power supply before the synchronization software control is started, that showed initial built-in lighting effect. (Rainbow style)
- If you use USB 10 Pin to Micro B cable connect DELTA MAX , only have initial Rainbow light effect, cannot sync and control by mother board signal.

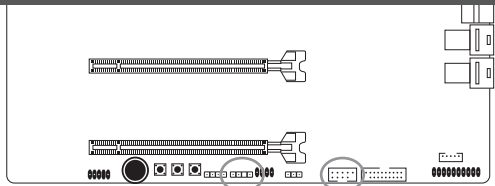

9pin USB Header

5V ADD Header

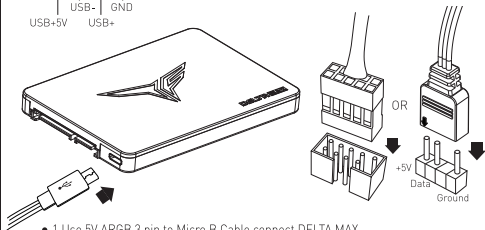
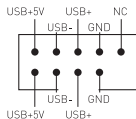

1. Use 5V ARGB 3 pin to Micro B Cable connect DELTA MAX
2. Use 3 pin Connect the 5V ADD \_Header on the motherboard and the other Micro B to the RGB SSD
1. Use USB 10 pin to Micro B Cable connect DELTA MAX
2. Connect the USB \_Header on the motherboard and the other Micro B to the RGB SSD

\* Note that it is not possible to connect to the 12V RGB Header, which will cause damage to the product and will lose warranty.