

THRUSTMASTER®



USER MANUAL

MANUEL DE L'UTILISATEUR

MANUAL DEL USUARIO

MANUAL DO USUÁRIO



USER MANUAL

PACKAGE CONTENTS

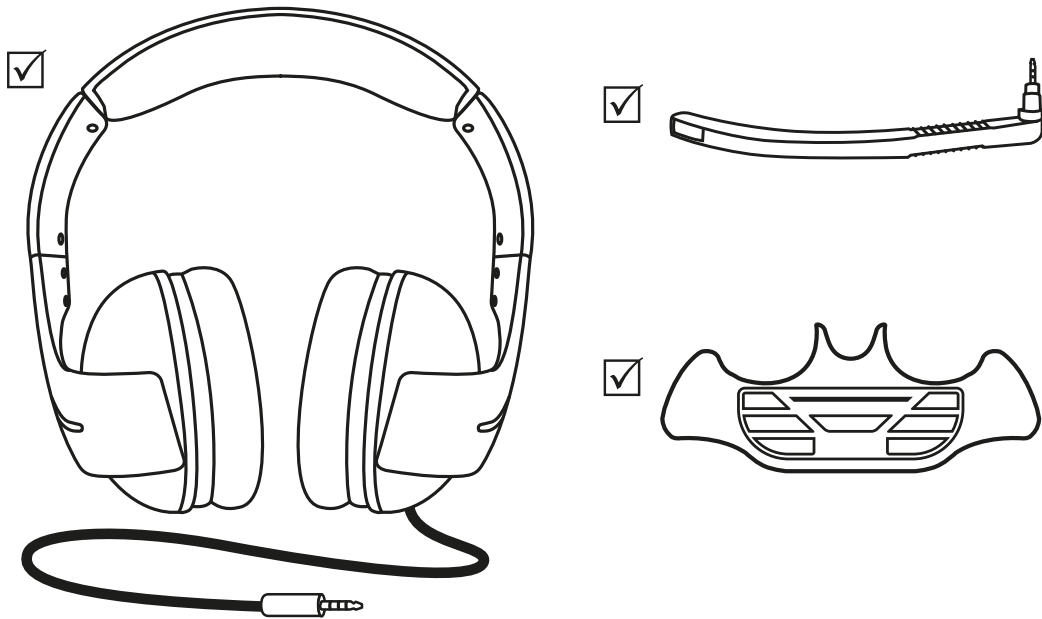

THRUSTMASTER®

1

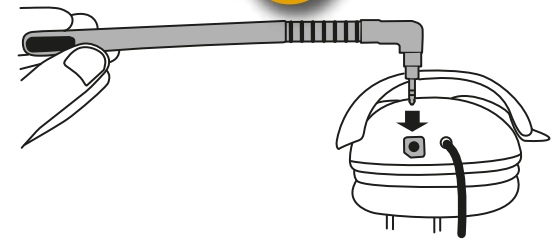

2

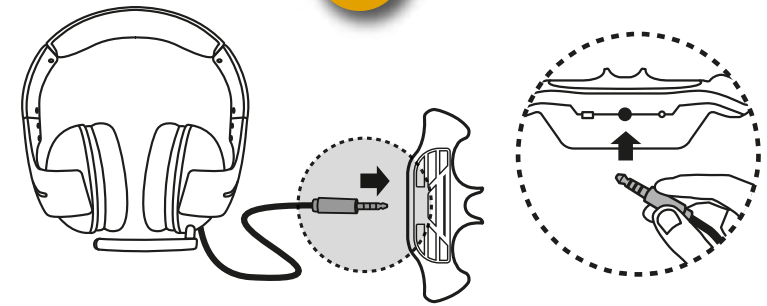

3

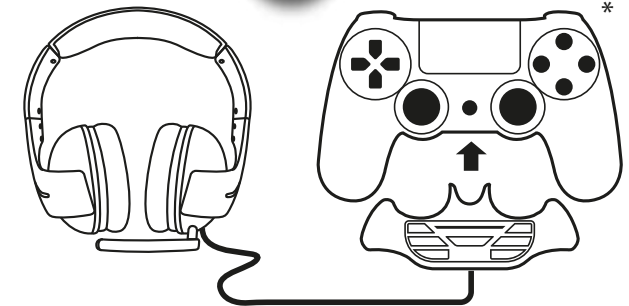

4

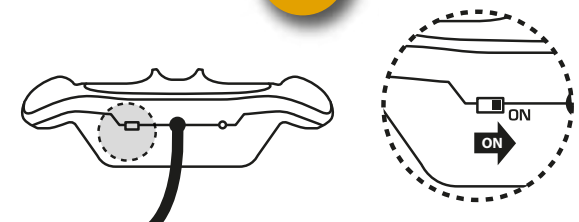

* Sold separately

CHARGING



Before using the Y Sound Commander, be sure to charge it completely.

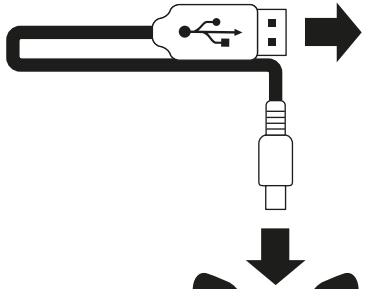

You can charge the headset via any device equipped with a USB port. The average charging time is 3 hours. The charge indicator switches off when the battery is 100% charged.



Charge indicator

- Blue: charging
- Red: low battery
- Off: battery 100% charged, or not charging



DO NOT CHARGE THE DUALSHOCK®4 WIRELESS CONTROLLER AND THE Y SOUND COMMANDER AUDIO CONTROLLER SIMULTANEOUSLY WHILE YOU ARE GAMING.

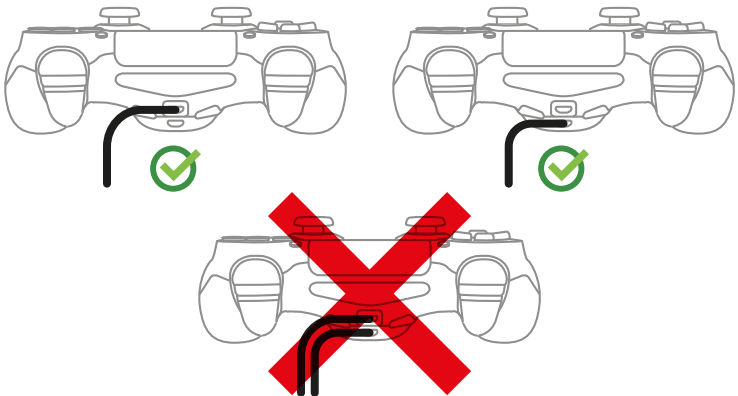

Y Sound
Commander

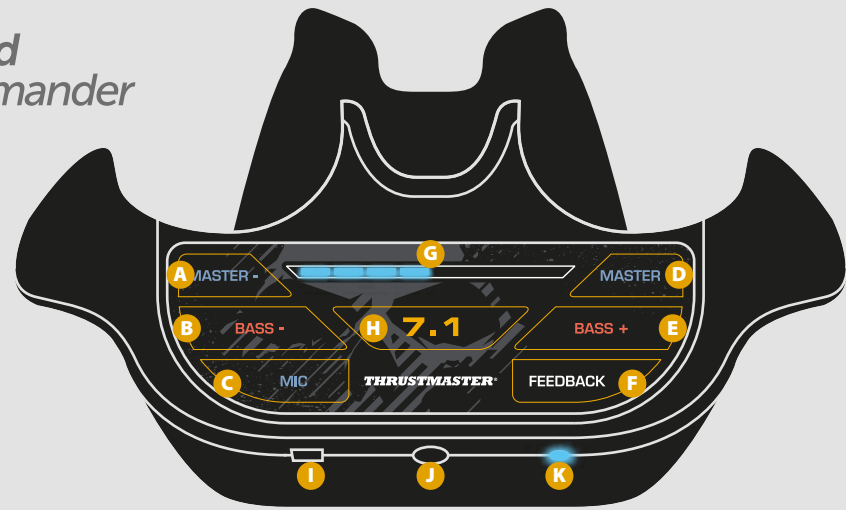

- A** - Master Volume - button
- B** - Bass Volume - button
- C** - Enable/disable microphone (blue = microphone enabled)
- D** - Master Volume + button
- E** - Bass Volume + button

- F** - Enable/disable feedback of gamer's voice
- G** - Master volume indicator
- H** - Enable/disable Ghost Recon Wildlands 7.1 mode (blue = 7.1 mode enabled / orange = 7.1 mode disabled)

- I** - ON/OFF switch
- J** - Headset connector
- K** - Charge indicator



BASS

Bass volume: 100%
Bass volume: 50%



GHOST RECON WILDLANDS 7.1 MODE

Enabled
Disabled



MASTER VOLUME

By default, the control panel displays the game's master volume in blue. Press Master - or Master + to adjust the master volume.

Master volume at 100%
Master volume at 50%

ADJUSTMENT

Adjustment of the different volume levels is carried out by steps. There are 50 steps and 9 LEDs.





MANUEL DE L'UTILISATEUR

CONTENU DE LA BOÎTE

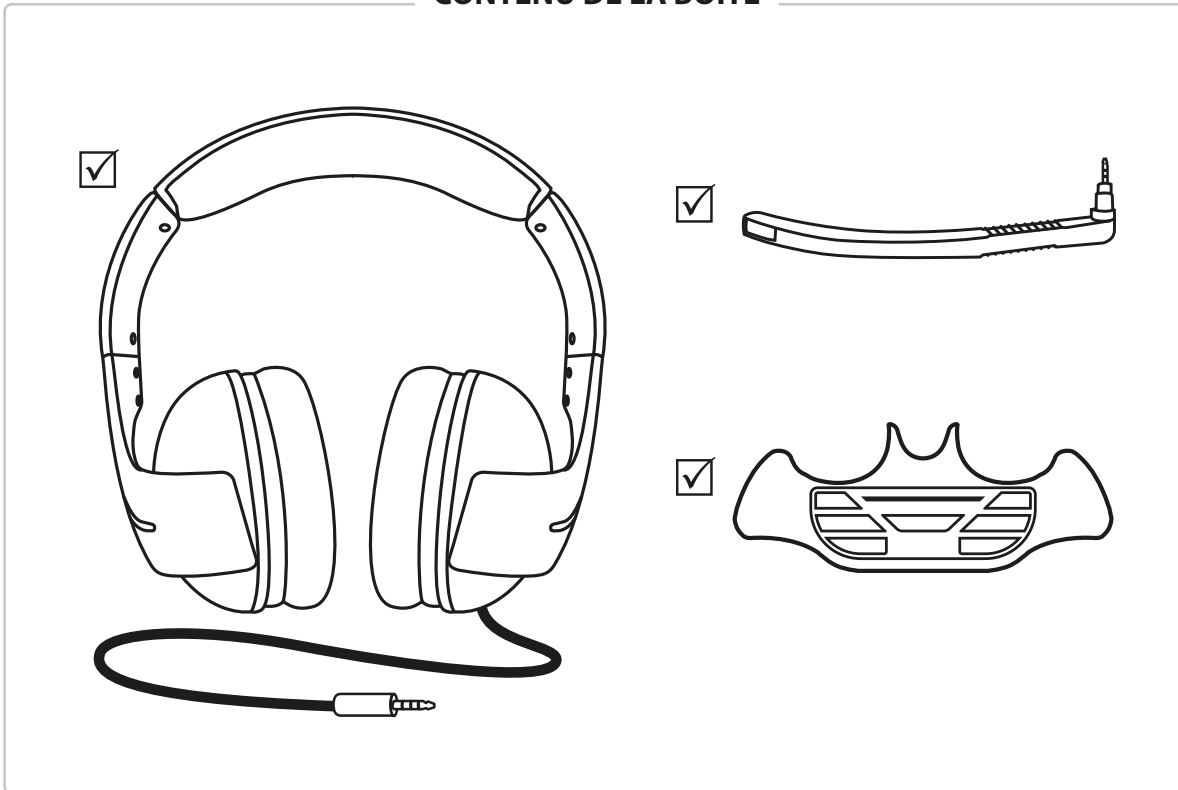

THRUSTMASTER®

1

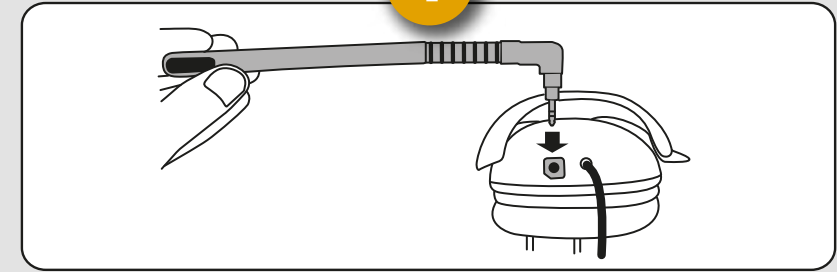

2

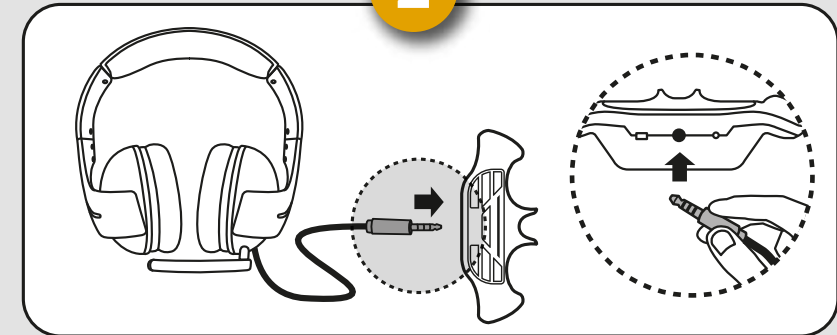

3



4

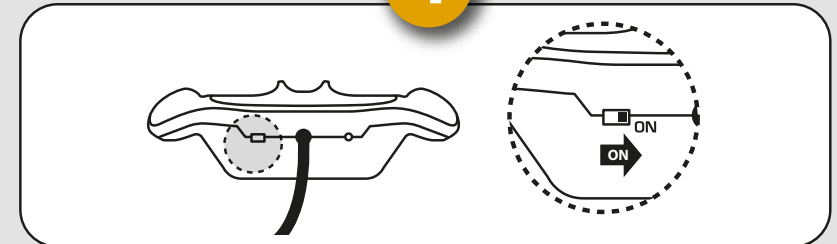

* Vendu séparément

CHARGE



Avant d'utiliser le Y Sound Commander, effectuez une charge complète.

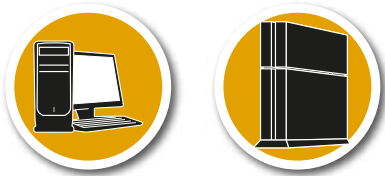

Il est possible de recharger ce casque à partir de tout périphérique équipé d'un port USB. Le temps de charge moyen est de 3 heures. L'indicateur de charge s'éteint lorsque la batterie est chargée à 100%.

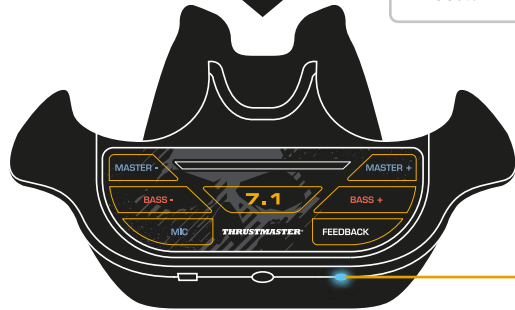
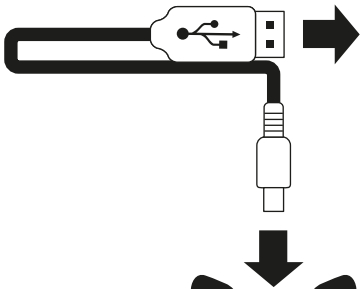

Indicateur de charge

- Bleu : en charge
- Rouge : batterie faible
- Éteint : batterie à 100% ou pas en charge



NE CHARGEZ PAS SIMULTANÉMENT LA MANETTE SANS FIL DUALSHOCK®4 ET LE CONTRÔLEUR AUDIO Y SOUND COMMANDER LORSQUE VOUS JOUEZ.

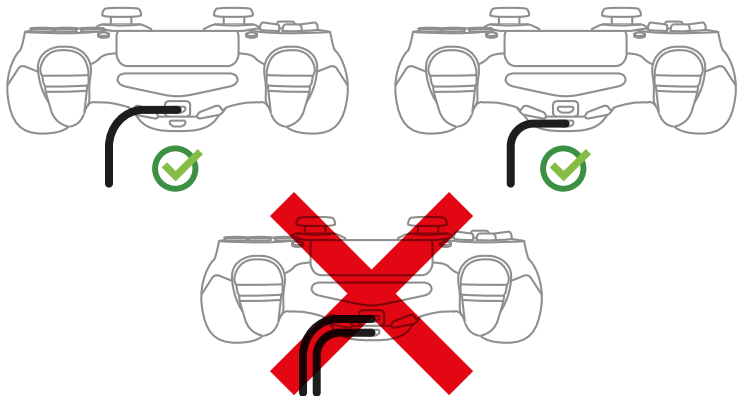

Y Sound
Commander

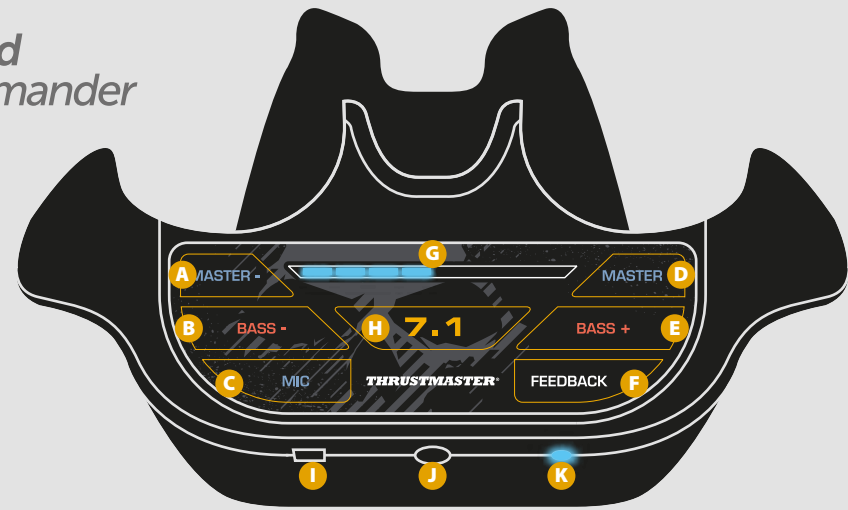

- A** - Bouton Master Volume -
- B** - Bouton Bass Volume -
- C** - Activation/désactivation du microphone (bleu = micro activé)
- D** - Bouton Master Volume +
- E** - Bouton Bass Volume +
- F** - Activation/désactivation du retour de la voix du joueur
- G** - Indicateur de volume
- H** - Activation/désactivation du mode 7.1 Ghost Recon Wildlands (bleu = 7.1 activé / orange = 7.1 désactivé)
- I** - Interrupteur ON/OFF
- J** - Entrée casque
- K** - Indicateur de charge



BASS

Volume des basses : 100%
Volume des basses : 50%



MODE 7.1 GHOST RECON WILDLANDS

Activé
Désactivé



VOLUME GÉNÉRAL

Par défaut, le panneau de contrôle affiche le volume général du jeu en bleu.
Appuyez sur Master - ou Master + pour le régler.
Volume général à 100%
Volume général à 50%

RÉGLAGE

Le réglage des différents volumes s'effectue par paliers. Il existe 50 paliers et 9 LEDs.

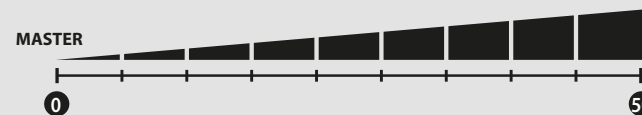



MANUAL DEL USUARIO

CONTENIDO DEL PAQUETE

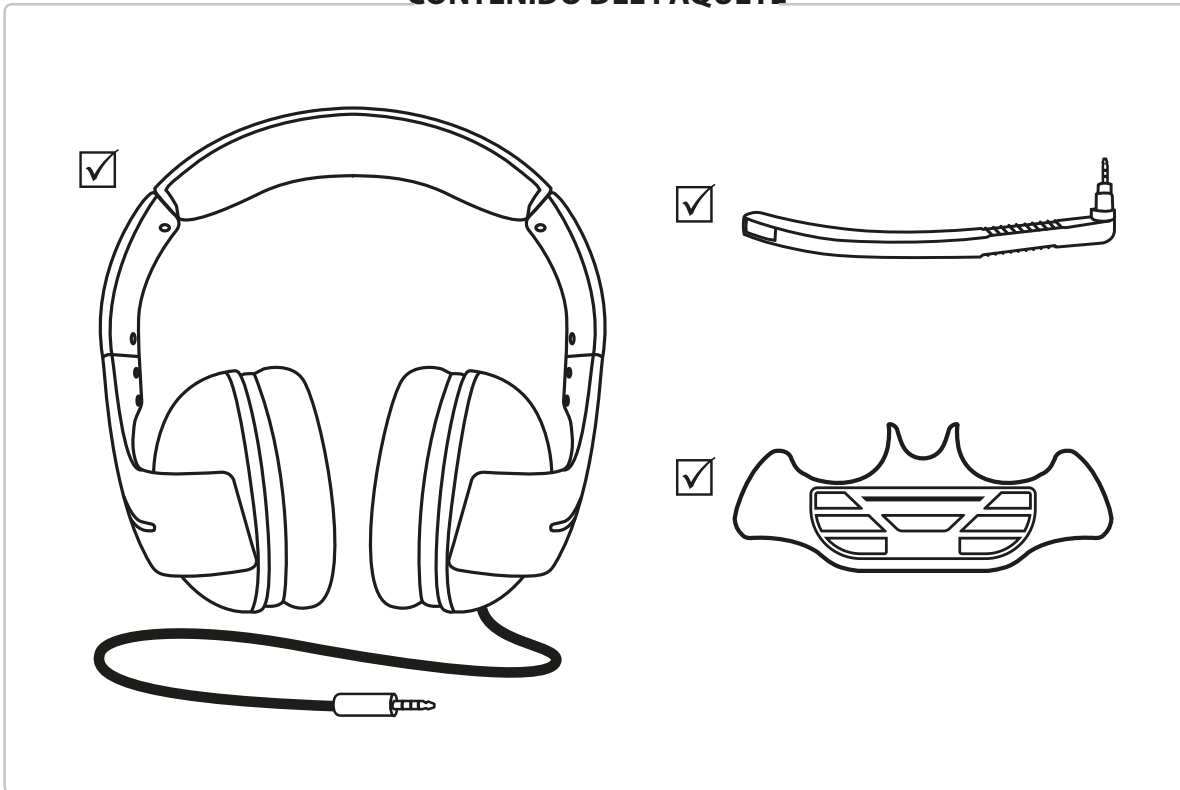

THRUSTMASTER®

1

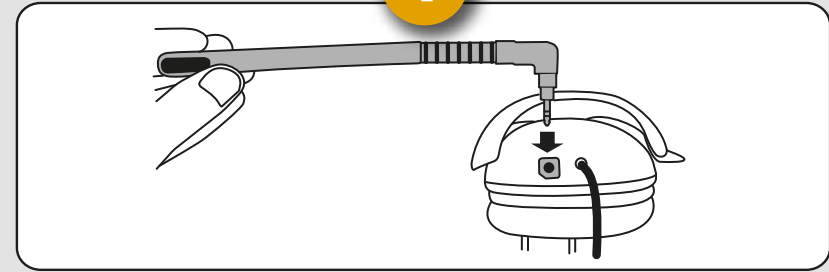

2

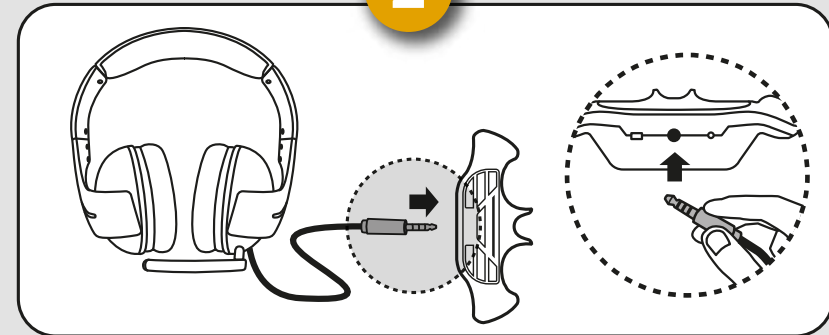

3

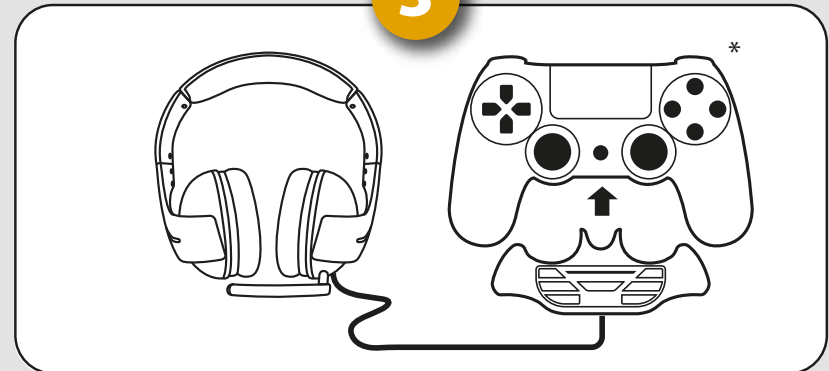

4

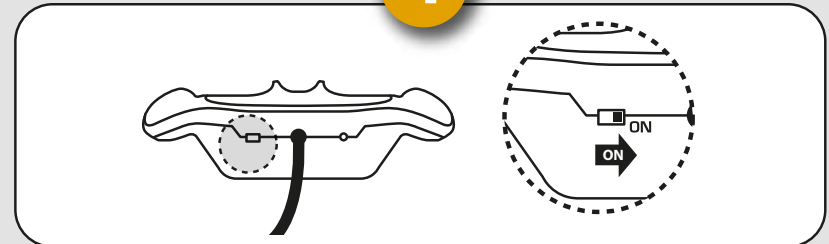

* Vendido por separado

CARGA



Antes de usar el Y Sound Commander, asegúrate de cargarlo por completo.



Puedes cargar los auriculares mediante cualquier dispositivo equipado con un puerto USB. El tiempo de carga promedio es de 3 horas. El indicador de carga se apaga cuando la batería está cargada al 100%.

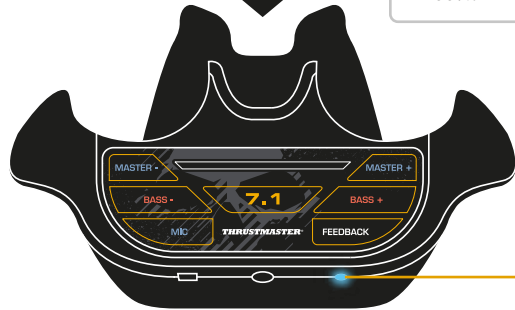
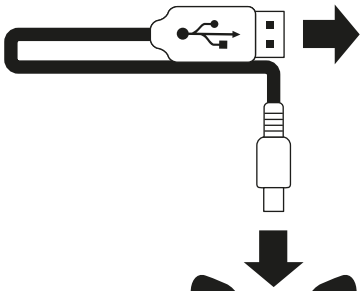

Indicador de carga

- Azul: cargando
- Rojo: batería baja
- Apagado: batería cargada al 100% o sin cargar



NO CARGUES EL MANDO INALÁMBRICO DUALSHOCK®4 Y EL CONTROLADOR DE AUDIO Y SOUND COMMANDER SIMULTÁNEAMENTE MIENTRAS ESTÁS JUGANDO.

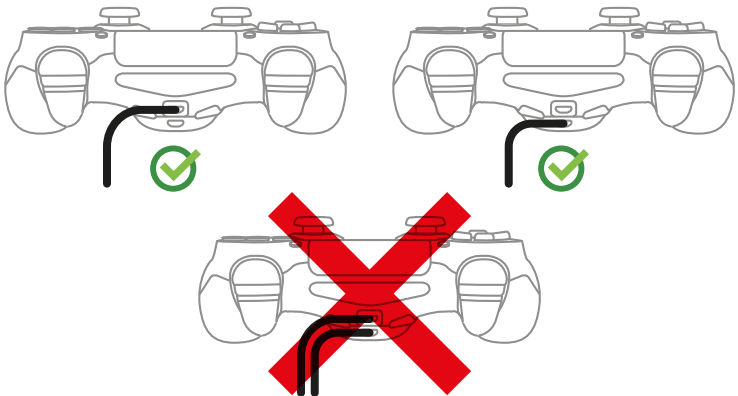

Y Sound Commander

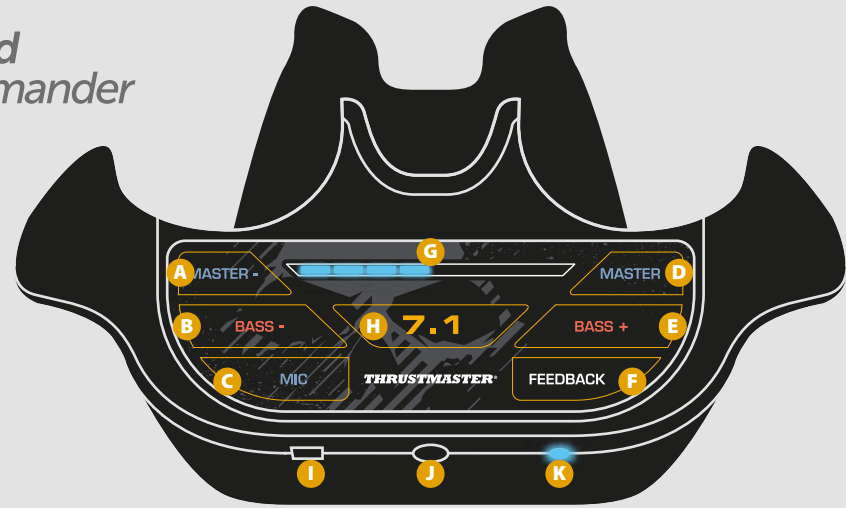

- A** - Botón Master Volume -
- B** - Botón Bass Volume -
- C** - Activar/desactivar micrófono (azul = micrófono activado)
- D** - Botón Master Volume +
- E** - Botón Bass Volume +

- F** - Activar/desactivar retroalimentación de la voz del jugador

- I** - Interruptor ON/OFF
- J** - Conector de auriculares
- K** - Indicador de carga

- G** - Indicador de volumen maestro
- H** - Activar/desactivar modo 7.1 de Ghost Recon Wildlands (azul = modo 7.1 activado / naranja = modo 7.1 desactivado)

BASS



Volumen de bajos: 100%
Volumen de bajos: 50%

MODO 7.1 DE GHOST RECON WILDLANDS



Activado
Desactivado

VOLUMEN MAESTRO

De forma predeterminada, el panel de control muestra el volumen maestro del juego en azul. Pulsa Master - o Master + para ajustar el volumen maestro.



Volumen maestro al 100%
Volumen maestro al 50%

AJUSTE

El ajuste de los distintos niveles de volumen se realiza en pasos. Hay 50 pasos y 9 LED.

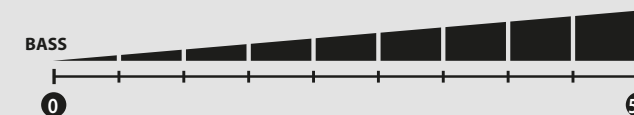
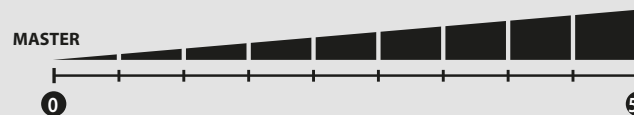



MANUAL DO USUÁRIO

CONTEÚDO DO PACOTE

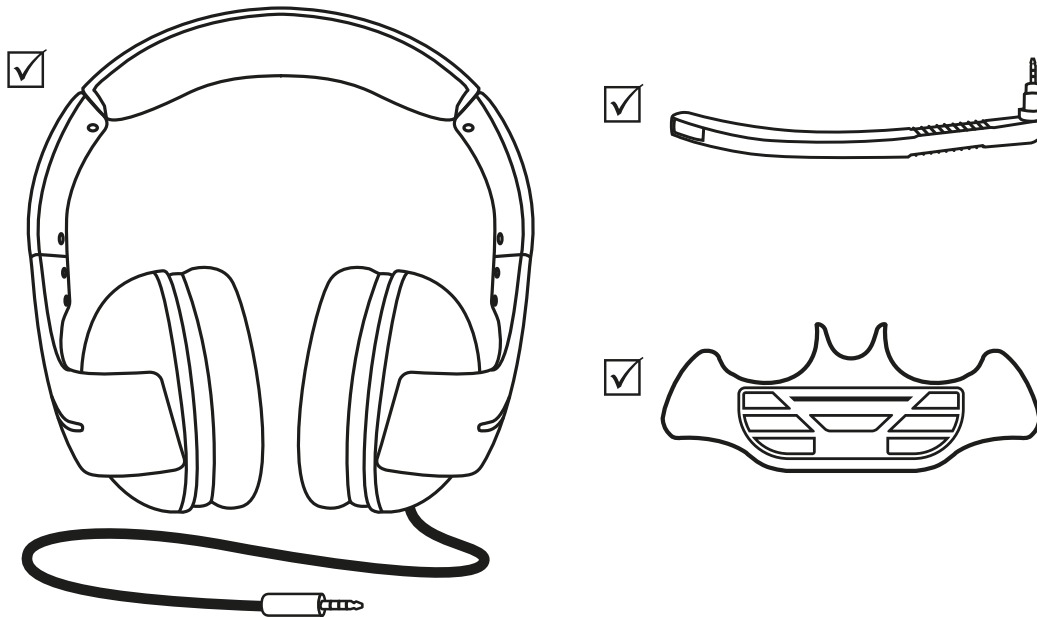

THRUSTMASTER®

1

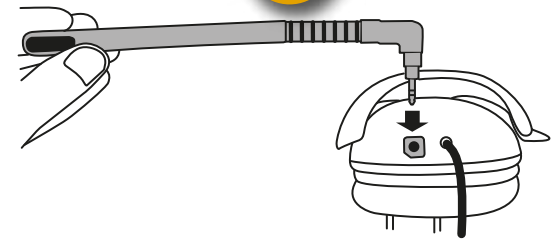

2

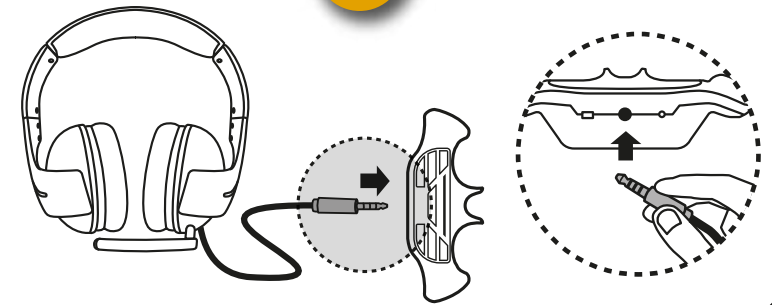

3

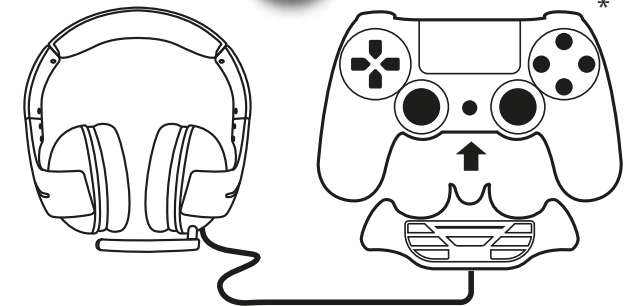

4

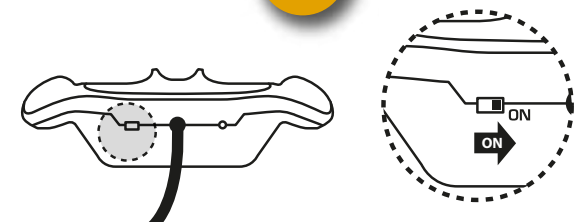

*Vendido separadamente

CARREGAR



Antes de usar o Y Sound Commander, certifique-se de carregá-lo completamente.



Você pode carregar o headset usando qualquer dispositivo equipado com uma porta USB. O tempo médio de carregamento é de 3 horas. O indicador de carga é desativado quando a bateria estiver 100% carregada.

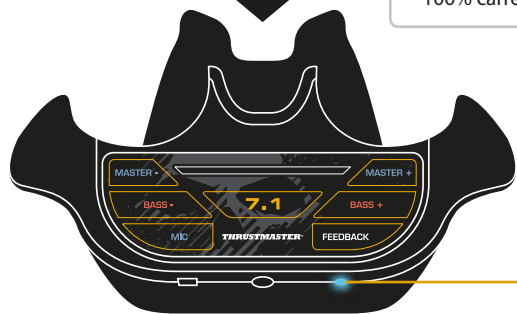
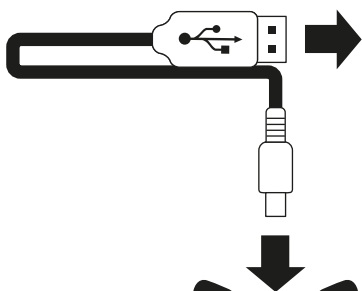

Indicador de carga

- Azul: carregando
- Vermelho: pouca bateria
- Desativado: bateria 100% carregada, ou não carregando



NÃO CARREGUE O CONTROLE SEM FIO DUALSHOCK®4 E O CONTROLADOR DE ÁUDIO Y SOUND COMMANDER SIMULTANEAMENTE ENQUANTO ESTIVER JOGANDO.

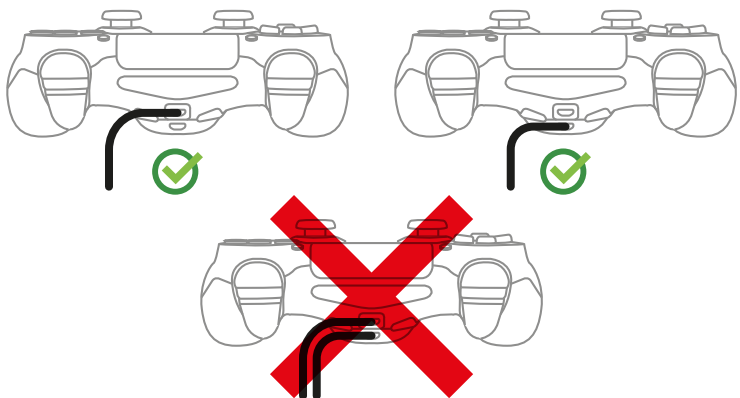

Y Sound
Commander

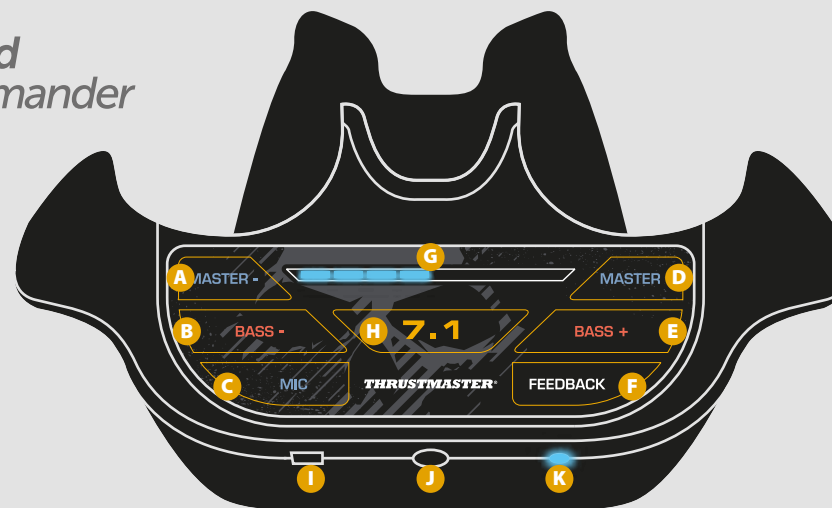

- A** - Master Volume – botão
- B** - Bass Volume – botão
- C** - Ativar/desativar microfone (azul = microfone ativado)
- D** - Master Volume + botão
- E** - Bass Volume + botão

- F** - Ativar/desativar retorno da voz do jogador
- G** - Indicador de volume mestre
- H** - Ativar/desativar modo Ghost Recon Wildlands 7.1 (azul = modo 7.1 ativado / laranja = modo 7.1 desativado)

- I** - Botão liga/desliga
- J** - Conector para headset
- K** - Indicador de caldicator de carga



BASS

Volume dos graves: 100%
Volume dos graves: 50%



MODO GHOST RECON WILDLANDS 7.1

Ativado
Desativado



VOLUME MESTRE

Por padrão, o painel de controle exibe o volume mestre do jogo em azul. Pressione Master – ou Master + para ajustar o volume mestre.
Volume mestre em 100%
Volume mestre em 50%

AJUSTE

O ajuste dos diferentes níveis de volume é realizado em incrementos. Há 50 incrementos e 9 LEDs.

