

# Questo manuale d'istruzione è fornito da trovaprezzi.it. Scopri tutte le offerte per Turtle Beach Stealth 600 Gen 2 MAX Rosso o cerca il tuo prodotto tra le migliori offerte di Cuffie e Microfoni

## QUICK START GUIDE GUÍA DE INICIO RÁPIDO



STEALTH  
600  
GEN 2

**IMPORTANT  
READ BEFORE USING  
IMPORTANTE  
LEA ANTES DE USAR**

Any questions? ¡Preguntas?  
[turtlebeach.com/support](https://turtlebeach.com/support)  
Model: Stealth™ 600 Gen 2 para auriculares de juego para Xbox

**IMPORTANT  
PLEASE MAKE SURE YOUR HEADSET  
IS UPDATED WITH THE LATEST FIRMWARE.**

**IMPORTANTE  
ASEGÚRATE DE QUE TUS AURICULARES ESTÁN  
ACTUALIZADOS CON EL ÚLTIMO FIRMWARE.**

Connect to the Turtle Beach Audio Hub for Windows or Mac® to update firmware.

Conéctate a la aplicación Turtle Beach Audio Hub para Windows o Mac® para actualizar el firmware.

[turtlebeach.com/audiohub](https://turtlebeach.com/audiohub)



### CONTENTS CONTENIDO

A Stealth™ 600 Gen 2 Headset  
Auriculares Stealth™ 600 Gen 2

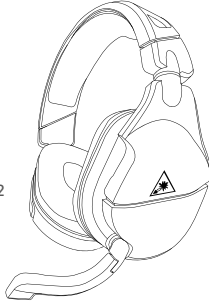

B USB-C Charging Cable  
Cable de carga USB-C

### HEADSET CONTROLS CONTROLES DE AURICULARES

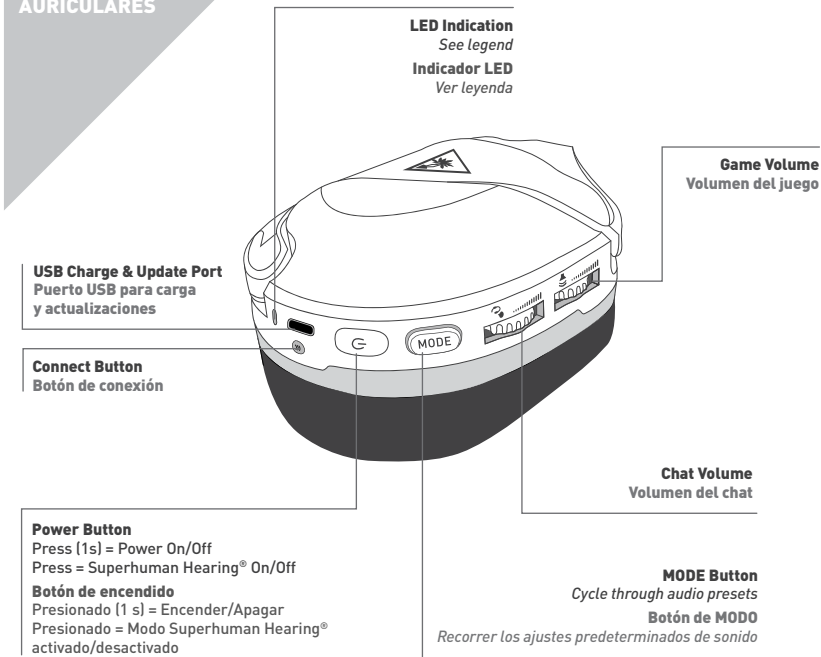

### SUPERHUMAN HEARING™

Use Superhuman Hearing™ Made to pinpoint quiet audio cues like enemy footsteps and weapon reloads. During gameplay, you can activate and deactivate Superhuman Hearing™ by pressing the POWER button once, quickly.

Utiliza el modo Superhuman Hearing™ para detectar los sonidos más leves, como las pisadas y las recargas de las armas de los enemigos. Durante el juego, puedes activar y desactivar el modo Superhuman Hearing™ al presionar rápidamente el botón de encendido (POWER) una sola vez.

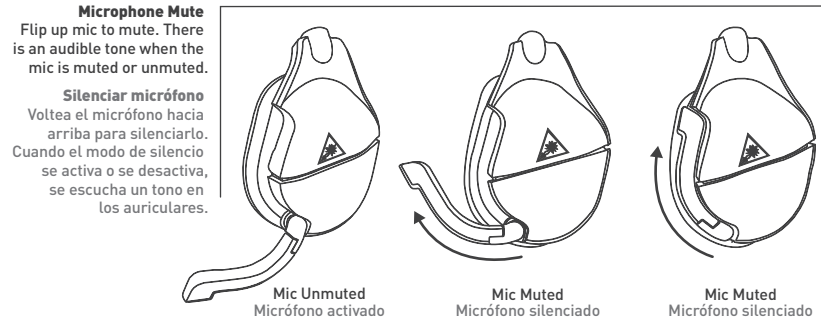

### EQ PRESETS | PREAJUSTES DE AUDIO DEL ECUALIZADOR

- Signature Sound | Sonido personalizado
- Bass Boost | Potenciador de graves
- Bass + Treble Boost | Potenciador de graves y agudos
- Vocal Boost | Potenciador de voz

### SETUP FOR XBOX CONFIGURACIÓN PARA XBOX

For new Xbox console setup instructions, go to:  
Instrucciones sobre la configuración en una Xbox nueva en:  
[turtlebeach.com/Xboxsetup](https://turtlebeach.com/Xboxsetup)

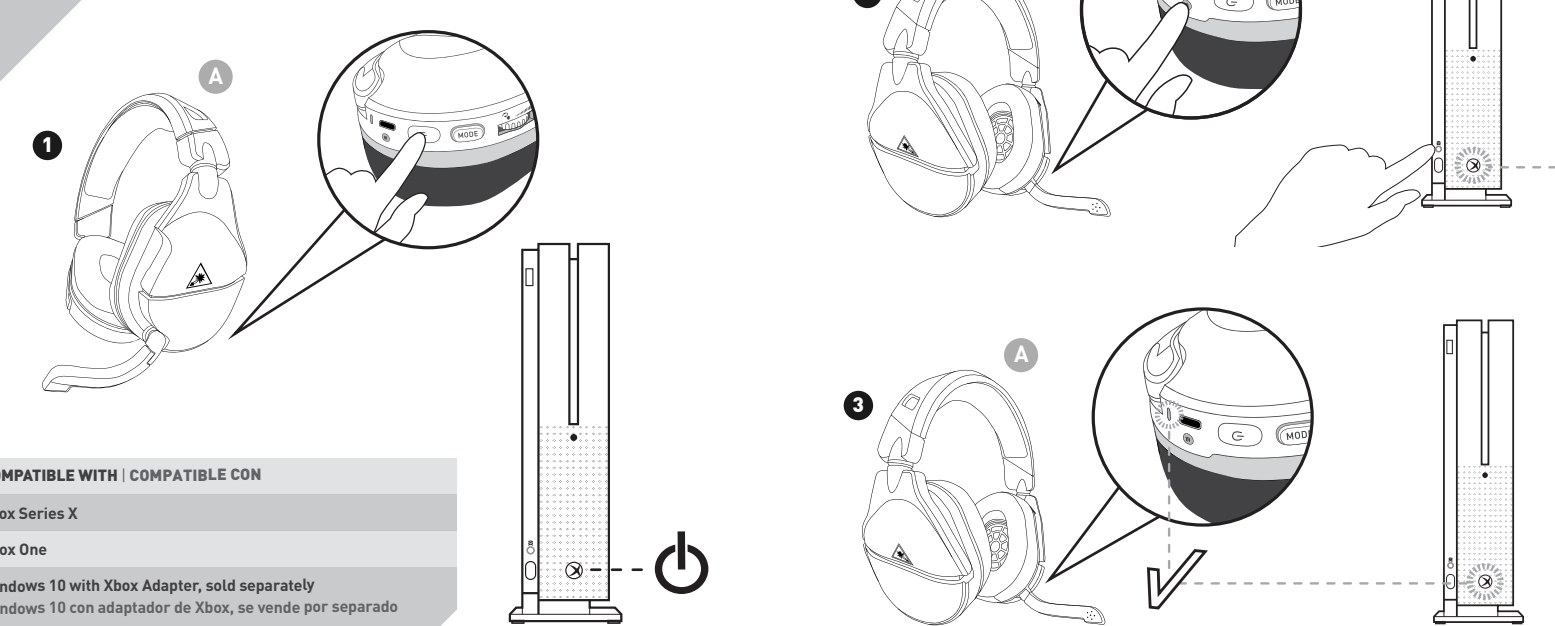

COMPATIBLE WITH | COMPATIBLE CON  
Xbox Series X  
Xbox One  
Windows 10 with Xbox Adapter, sold separately  
Windows 10 con adaptador de Xbox, se vende por separado

### SURROUND SOUND FOR XBOX (ONLY AVAILABLE ON XBOX) SONIDO ENVOLVENTE PARA XBOX (SÓLO DISPONIBLE EN XBOX)

- EN 1. Go to **Settings** - **General** - **Volume & Audio Output**.  
2. Set **Headset Audio** to **Windows Sonic for Headphones**.
- ES 1. Ir a **Configuración** - **General** - **Salida de volumen y sonido**.  
2. Selecciona **Windows Sonic para auriculares** en **Sonido de los auriculares**.
- IT 1. Vai a **Impostazioni** - **Generale** - **Volume e uscita audio**.  
2. Imposta audio cuffie su **Windows Sonic per cuffie**.
- SE 1. Gå till **Inställningar** > **Allmänt** > **Volym och ljudutdata**.  
2. Ställ in **Windows Sonic for Headphones** under **Headsetljud**.
- NL 1. Ga naar **Instellingen** - **Algemeen** - **Volume- en audio-uitvoer**.  
2. Stel **Audio voor hoofdtelefoon** in op **Windows Sonic voor hoofdtelefoon**.
- FR 1. Allez dans **Paramètres** - **Général** - **Volume et sortie audio**.  
2. Réglez **Son du casque sur Windows Sonic pour casque**.
- DE 1. Gehe zu **Einstellungen** - **Allgemein** - **Lautstärke & Audioausgabe**.  
2. Aktiviere **Windows Sonic für Headphones für Headset-Audio**.
- PT 1. Vai a **Definições** - **Gerál** - **Saída de Áudio e Volume**.  
2. Configura o **Áudio dos Auscultadores** para **Windows Sonic nos Auscultadores**.
- DK 1. Gå til **Indstillinger** - **Generelt** - **Lydstyrke og lydoutput**.  
2. Indstil **headsettets lyd til Windows Sonic for Headphones**.

For updated setup instructions visit:  
Instrucciones de la configuración actualizadas en:  
[turtlebeach.com/sonic](https://turtlebeach.com/sonic)

### CHARGING CARGANDO

The Stealth™ 600 Gen 2 gives you **15 hours** of rechargeable battery life. Make sure to charge it regularly before storing. Los auriculares Stealth™ 600 Gen 2 te ofrecen **15 horas** de juego por cada carga de la batería. Asegúrate de cargarlos con frecuencia antes de guardarlos.

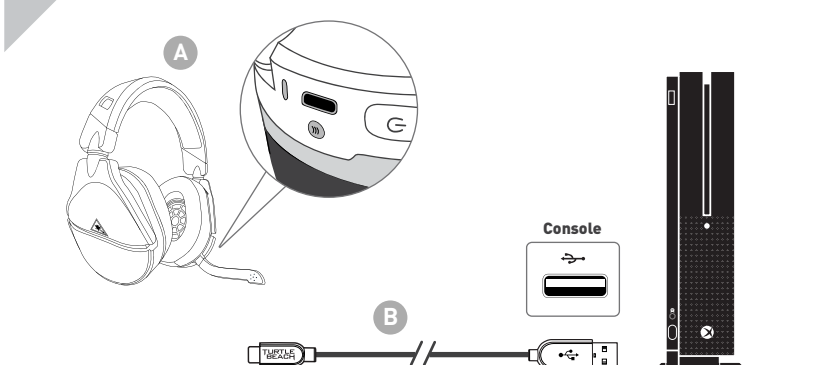

### Headset Storage

Always charge your headset before storing it for any extended period of time (greater than 3 months). Never store the unit in temperatures above 113°F/43°C.

Almacenamiento de los auriculares: Antes de un almacenamiento prolongado (más de 3 meses) carga los auriculares. No almacenar el equipo a temperaturas superiores a los 45 °C (113 °F).

### HEADSET LED INDICADOR LED DE LOS AURICULARES

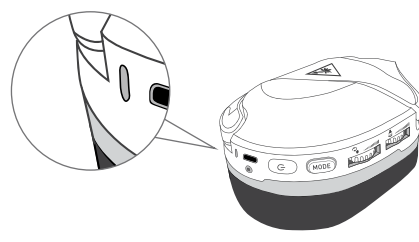

HEADSET LED	MEANING
Solid Green	Headset and Console Paired
Breathing Green	[White Charging] Battery Full
Double-Blink Green	Not Paired
Solid Red	[White Charging] Battery Charging
Breathing Red	Battery Low
ES VOYANT DU CASQUE	SIGNIFICADO
Verde constante	Auriculares y consola emparejados
Verde variable	[Durante la carga] Batería llena
Verde con doble parpadeo	No emparejados
Rojo constante	[Durante la carga] Cargando la batería
Rojo variable	Batería baja

### SETUP FOR PC USE CONFIGURACIÓN PARA PC

SYNCING YOUR HEADSET  
(XBOX WIRELESS ADAPTER)\*  
EMPAJEAR TUS AURICULARES  
(ADAPTADOR INALÁMBRICO PARA XBOX)\*



\*Xbox Wireless Adapter not included  
\*No incluye adaptador inalámbrico para Xbox

### SYNCING YOUR HEADSET (BUILT-IN XBOX WIRELESS) EMPAJEAR TUS AURICULARES (CONEXIÓN INALÁMBRICA A XBOX INCORPORADA)

- EN 1. On your PC, go to **Settings** > **Devices** > **Connected Devices**.  
a. Choose **Add a device**. Windows searches for the headset.  
2. Press the **connect** button on your headset. Windows finds and adds the headset.  
3. When your **Stealth™ 600** headset appears in the list under **Other devices**, it is ready to use.  
4. Configuring your settings > On the **Windows Taskbar**, right-click the **Speaker Icon**, **Select Playback Devices**.  
a. Set **TURTLE BEACH Stealth 600™** as your default device.  
b. Select **Recording Devices**, Set **TURTLE BEACH Stealth 600™** as your default device.
- ES 1. En tu PC, ve a **Configuración** - **Dispositivos** - **Dispositivos conectados**.  
a. Elige **Añadir un dispositivo**. Windows buscará los auriculares.  
2. Pulsa el botón de conectar en los auriculares. Windows buscará y añadirá los auriculares.  
3. Cuando los auriculares **Stealth™ 600** aparezcan en la lista de **Otros dispositivos**, estarán listos para usarse.  
4. Para configurar > En la barra de tareas de Windows, haz clic derecho en el icono del altavoz, selecciona **Dispositivos de reproducción**  
a. Configura **Stealth 600™** de **TURTLE BEACH** como dispositivo predeterminado.  
b. Selecciona **Dispositivos de grabación**, configura **Stealth 600™** de **TURTLE BEACH** como dispositivo predeterminado.
- DE 1. Wählen Sie auf Ihrem PC **Einstellungen** - **Geräte** - **Angeschlossene Geräte**.  
a. Wählen Sie „Gerät hinzufügen“. Windows sucht jetzt nach dem Headset.  
2. Drücken Sie den Knopf „Connect“ (Anschließen) auf Ihrem Headset. Windows findet das Headset und fügt es hinzu.  
3. Sobald Ihr **Stealth™ 600** Headset in der Liste unter „Andere Geräte“ angezeigt wird, kann es benutzt werden.  
4. Einstellungen konfigurieren > Rechtsklicken Sie das Lautsprechersymbol in der Windows Taskleiste und wählen Sie „Wiedergabegeräte“.  
a. Wählen Sie **TURTLE BEACH Stealth 600™** als Ihr Standardgerät.  
b. Wählen Sie „Audiowiedergabe“ und legen Sie **TURTLE BEACH Stealth 600™** als Ihr Standardgerät fest.

### Regulatory Compliance Statements for the Stealth™ 600X Gen 2

**Local Restrictions on 802.11a, 802.11b, 802.11g and 802.11n Radio Usage**  
**Caution:** Due to the fact that the frequencies used by 802.11a, 802.11b, 802.11g and 802.11n wireless LAN devices may not yet be harmonized in all countries, 802.11a, 802.11b, 802.11g and 802.11n products are designed for use only in specific countries, and are not allowed to be operated in countries other than those of designated use. As a user of these products, you are responsible for ensuring that the products are used only in the countries for which they were intended and for verifying that they are configured with the correct selection of frequency and channel for the country of use. Any deviation from the permissible power and frequency settings for the country of use is an infringement of national law and may be punished as such.

To determine whether you are allowed to use your wireless network device in a specific country, please check to see if the radio type number that is printed on the identification label of your device is listed in the manufacturer's OEM Regulatory Guidance document at the following URL: <http://www.turtlebeach.com/homologation> or contact Turtle Beach directly.

**Federal Communications Commission (FCC) Compliance Notices**  
This section includes the following FCC statements for the Stealth™ 600X Gen 2:  
• FCC ID: X036-182315  
• Class B Interference Statement  
• Radio Frequency Exposure & Hazard Warning  
• Non-Modification Statement  
• Unlicensed National Information Infrastructure Bands Operation Statement

**Class B Interference Statement**  
This equipment has been tested and found to comply with the limits for a Class B digital device, pursuant to Part 15 of the FCC Rules. These limits are designed to provide reasonable protection against harmful interference in a residential installation. This equipment operates, uses, and can radiate radio frequency energy and, if not installed and used in accordance with the instructions, may cause harmful interference to radio communications. However, there is no guarantee that interference will not occur in a particular installation. If this equipment does cause harmful interference to radio or television reception, which can be determined by turning the equipment off and on, the user is encouraged to try to correct the interference by one or more of the following measures:  
• Reorient or relocate the receiving antenna.  
• Increase the separation between the equipment and receiver.  
• Connect the equipment into an outlet on a circuit different from that to which the receiver is connected.  
• Consult the dealer or an experienced radio/TV technician for help.

**FCC Caution:**  
This device complies with Part 15 of the FCC Rules. Operation is subject to the following two conditions: [1] This device may not cause harmful interference, and [2] this device must accept any interference received, including interference that may cause undesired operation.

**RF Radiation Exposure & Hazard Statement**  
To ensure compliance with FCC RF exposure requirements, this device must be installed in a location such that the antenna of the device will be greater than 2 cm (0.8 in.) from all persons. Using higher gain antennas and types of antennas not covered under the FCC certification of this product is not allowed. Installers of the radio and end users of the product must adhere to the installation instructions provided in this manual. This transmitter must not be co-located or operated in conjunction with any other antenna or transmitter.

**Unlicensed National Information Infrastructure (U-NII) Bands Operation Statement**  
Within the 5.25-5.35 GHz band, U-NII devices will be restricted to indoor operations to reduce any potential for harmful interference to co-channel MDS operations.  
The U-NII devices shall accept any interference from legal communications and shall not interfere with the legal communications. If interference is caused, the user must stop operating the device immediately and cannot resume operation until the harmful interference is clear.  
Manufacturers of U-NII devices are responsible for ensuring frequency stability such that an emission is maintained within the band of operation under all conditions of normal operation as specified in this user manual.

**Dynamic Frequency Selection (DFS)**  
U-NII devices operating in the 5.25-5.35 GHz and 5.47-5.725 GHz bands shall employ a DFS radar detection mechanism to detect the presence of radar systems and to avoid co-channel operation with radar systems in order to reduce the likelihood of interference to radar. The modification of wireless broadband or other transmitter to operate on unauthorized frequencies or the disabling of DFS capabilities is a violation of FCC rules and may result in unlawful interference to radio communications services critical to public safety. This product is compliant with the Consumer Product Safety Improvement Act of 2008, Public Law 110-314 (CPSIA).

**Canadian ICES Statements (IC: 3879A-215) (Stealth™ 600X Gen 2)**  
This device complies with ICES-003 and ICES-007 of Industry Canada. Operation is subject to the following two conditions:  
1. This device may not cause interference, and  
2. This device must accept any interference, including interference that may cause undesired operation of the device.

**Ce dispositif est conforme aux normes NRB002 et CNR-247 de l'industrie Canadienne.**  
L'utilisation de ce dispositif est autorisée seulement aux conditions suivantes:  
1. Il ne doit pas produire de brouillage et l'utilisateur du dispositif doit être prêt à accepter tout brouillage radioélectrique reçu, même si ce brouillage est susceptible de compromettre le fonctionnement du dispositif.  
2. Le produit doit accepter toute interférence radioélectrique légitime qu'il pourrait subir.  
To prevent radio interference to the licensed service (i.e., co-channel Mobile Satellite Systems) this device is intended to be operated indoors and away from windows to provide maximum shielding. Equipment for its transmit antenna is installed outdoors is subject to licensing and not supported by Stealth™ 600X Gen 2 Models.

**Pour éviter les interférences radio au service agréé (i.e., à-d. Les systèmes par satellite mobile co-canal), cet appareil est destiné à fonctionner à l'intérieur et à l'extérieur des fenêtres pour assurer un blindage maximal. L'équipement pour son antenne d'émission installée à l'extérieur est soumise à l'octroi de licences et n'est pas pris en charge par les modèles Stealth™ 600X Gen 2.**

**RF Radiation Exposure & Hazard Statement**  
To ensure compliance with FCC RF exposure requirements, this device must be installed in a location such that the antenna of the device will be greater than 2 cm (0.8 in.) away from all persons. Using higher gain antennas and types of antennas not covered under the IC certification of this product is not allowed. Installers of the radio and end users of the product must adhere to the installation instructions provided in this manual. This transmitter must not be co-located or operated in conjunction with any other antenna or transmitter.

**Exposition aux radiations RF et Mention de danger**  
Pour assurer la conformité avec les exigences RF-02 d'exposition aux RF (Radio Fréquences), cet appareil doit être installé dans un endroit où l'antenne de l'appareil sera située à une distance de plus de 2 cm (0,8 po) de toutes personnes. L'utilisation d'antennes à gain plus élevé et les types d'antennes qui ne sont pas couverts par le de certification IC de ce produit n'est pas autorisés. Les installateurs de la radio et les utilisateurs du produit final doivent se conformer aux instructions d'installation fournies dans ce manuel. Cet émetteur ne doit pas être co-implanté ou exploité en conjonction avec toute autre antenne ou transmetteur.

**Déclaration de déploiement**  
Ce produit est certifié pour le déploiement à l'intérieur tout en rencontrant les limites de cette bande de fréquences: 5150-5250 MHz. Ne pas installer ou utiliser ce produit à l'extérieur du Canada, si ce bande de fréquences ne peut être rencontré.

**Operation in the Frequency Bands 5170-5225 MHz and 5250-5850 MHz**  
This device complies with the Canadian ICES-003 and ICES-007 of Industry Canada. Operation is subject to the following two conditions:  
1. This device may not cause interference, and  
2. This device must accept any interference, including interference that may cause undesired operation of the device.

**Fonctionnement dans les bandes de fréquence 5170-5225 MHz et 5250-5850 MHz**  
Jusqu'à nouvel avis, les appareils soumis à cette section ne doivent pas être transmis dans la bande de 5150-5250 MHz. Cette restriction concerne la protection des radars météorologiques d'Environnement Canada opérant dans cette bande. Les utilisateurs des avisés que les utilisateurs de radars de haute puissance sont désignés utilisateurs principaux (i.e., à-d., qu'ils ont la priorité) pour les bandes 5250-5350 MHz et 5450-5850 MHz et que ces radars pourraient causer du brouillage à d'autres utilisateurs des dispositifs LAN-E.

**European Union and European Free Trade Association Regulatory Compliance**  
This product is compliant with the countries that comprise the member countries of the European Union and the European Free Trade Association. These countries, listed below, are referred to as The European Community throughout this document:  
AUSTRIA, BELGIUM, BULGARIA, CYPRUS, CZECH REPUBLIC, DENMARK, ESTONIA, FINLAND, FRANCE, GERMANY, GREECE, HUNGARY, IRELAND, ITALY, LATVIA, LITHUANIA, LUXEMBOURG, MALTA, NETHERLANDS, POLAND, PORTUGAL, ROMANIA, SLOVAKIA, SLOVENIA, SLOVENE, SWAIN, SWEDEN, UNITED KINGDOM, UNITED KINGDOM, LICHTENSTEIN, NORWAY, SWITZERLAND.

**CE Declaration of Conformity**  
Marking by this symbol:  
Indicates compliance with the Essential Requirements of the Radio Equipment Directive (RED) of the European Union (2014/53/EU). This equipment meets the following conformity standards:  
**Safety:** EN 60950-1:2006 + A11:2009 + A1:2010 + A12:2011 A2:2013 (Mark Licenced), IEC 60950-1:2005 (2nd Ed.) + Am 1:2009 + Am 2:2013 (IEC Scheme Certificate), EN 62368-1:2014 + A11:2014 (Mark Licenced), IEC 62368-1:2014 (CB Scheme Certificate), EN 60335-1:2013, EN 50352-2:2013, EN 71-3:2013.  
Additional licenses issued for specific countries available on request  
**EMC:** EN 55032:2015, CISPR 32:2015, EN 301 489-1 V2.1.1 (2017)-02, EN 301 489-1 V2.1.1 (2017)-02, EN 61000-4-2:2009, EN 61000-4-3:2008 + A1:2008, A2:2010, EN 61000-4-8:2010.  
The products are licensed, as required, for additional country specific standards for the International Marketplace. Additional licenses issued upon request.  
**Radio:** EN 300 220 V2.1.2 (2017)-01, EN 301 893 V2.1.1 (2017)-03  
SAR: EN 1251:2009  
**Environmental:** RoHS 2015/863 amending Annex II to 2011/65/EU, WEEE 2012/19/EU, REACH 2006/1807/EC, Packaging 94/42/EC, Battery 2006/46/EC, Toys Safety Directive 2009/90/EC.  
**Warning!** This is a Class B product. In a domestic environment, this product may cause radio interference, in which case, the user may be required to take appropriate measures.

**Non-Modification Statement**  
This product is certified for indoor deployment only in the 5150-5250 MHz band. Do not install or use this product outdoors in that attention is drawn to the user to take the appropriate measures.

**Attention!** Dieses ist ein Gerät der Funkfrequenzklasse B. In Wohnbereich können bei Betrieb dieses Gerätes Funkstörungen auftreten, in welchen Fällen der Benutzer für entsprechende Gegenmaßnahmen verantwortlich ist.

**Warning!** This is a Class B product. In a domestic environment, this product may cause radio interference, in which case, the user may be required to take appropriate measures.

**Attention!** Dieses ist ein Gerät der Funkfrequenzklasse B. In Wohnbereich können bei Betrieb dieses Gerätes Funkstörungen auftreten, in welchen Fällen der Benutzer für entsprechende Gegenmaßnahmen verantwortlich ist.

### To access the rating label: Para acceder a la etiqueta de evaluación:

- Remove the left ear pad by pulling the ear pad straight up using your thumb.
- Once you've released the cloth from the lip on top, pull the ear pad straight back and it should slip right off.
- Quando Hayes separada a tela de a orelha em la parte superior, jala la almohadilla directamente hacia abajo, y entonces se debe salir fácilmente de su lugar.

To replace the ear pad, follow the same process in reverse. Para reemplazar la almohadilla, sigue el mismo proceso en orden inverso.

Not seeing what you're looking for here? Visit [turtlebeach.com/support](https://turtlebeach.com/support) for the latest Tech Support information.

¿Tienes alguna duda? Visita [es.turtlebeach.com/pages/servicio-asistencia](https://turtlebeach.com/pages/servicio-asistencia) para obtener la información más reciente de soporte técnico.