

QUICK START GUIDE
GUIDE DE DÉMARRAGE RAPIDE



STEALTH™
600
GEN 2

IMPORTANT
READ BEFORE USING
À LIRE
LIRE AVANT UTILISATION

Any questions? Des questions ?
turtlebeach.com/support
Model: Stealth™ 600 Gen 2 for PlayStation®

IMPORTANT
PLEASE MAKE SURE YOUR HEADSET IS UPDATED WITH THE LATEST FIRMWARE.

IMPORTANT
VEUILLEZ VOUS ASSURER QUE VOTRE CASQUE DISPOSE DE LA DERNIÈRE VERSION DU MICROLOGICIEL.

Connect to the Turtle Beach Audio Hub for Windows or Mac® to update firmware.

Connectez-vous au Turtle Beach Audio Hub pour Windows ou Mac® afin de mettre à jour le micrologiciel.

turtlebeach.com/audiohub



CONTENTS
CONTENU DE LA BOÎTE

A Stealth™ 600 Gen 2 Headset
Casque Stealth™ 600 Gen 2

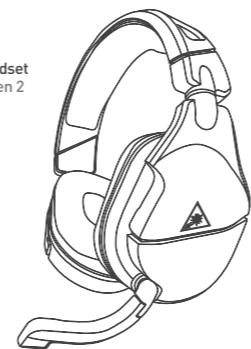

B Stealth™ 600 Gen 2 Mini Wireless Transmitter
Émetteur sans fil mini Stealth™ 600 Gen 2



C USB-C Charging Cable
Câble de chargement USB-C



HEADSET CONTROLS
COMMANDES SUR CASQUE

LED Indication
See legend
Indications du voyant
Voir la légende

USB Charge & Update Port
Port USB pour le chargement et la mise à jour

Power Button
Press [I] = Power On/Off
Press = Superhuman Hearing™ On/Off
Bouton d'alimentation
Appuyer [I] pour allumer/éteindre
Press = Superhuman Hearing™ On/Off

Master Volume Dial
Molette de volume principal

Variable Mic Monitoring
Adjust Mic Monitoring levels
Réglage du retour micro
Ajuster les niveaux de retour micro

MODE Button
Cycle through EQ audio presets
Bouton de MODE
Appuyer pour parcourir les presets audio de Turtle Beach



Use Superhuman Hearing™ Mode to pinpoint quiet audio cues like enemy footsteps and weapon reloads. During gameplay, you can activate and deactivate Superhuman Hearing™ by pressing the **POWER** button once, quickly.

Utilisez le mode Superhuman Hearing™ pour localiser des sons presque imperceptibles, comme les pas d'un ennemi ou le rechargement d'une arme. Pendant le jeu, vous pouvez activer ou désactiver Superhuman Hearing™ en appuyant une fois sur le bouton **D'ALIMENTATION** rapidement.

Microphone Mute
Flip up mic to mute. There is an audible tone when the mic is muted or unmuted.

Mode Mute
Relève le microphone pour le désactiver. Vous entendrez un son lorsque le microphone est désactivé ou activé.

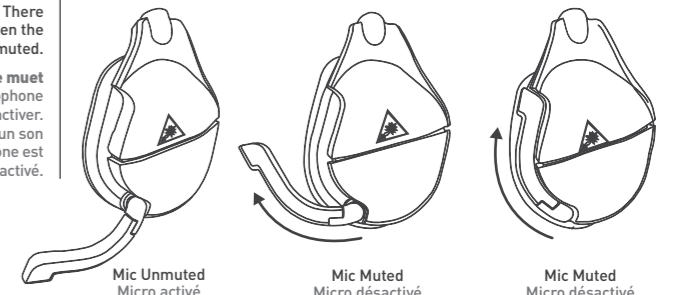

EQ PRESETS | PRÉSETS D'ÉGALISATION
Signature Sound | Son emblématique
Bass Boost | Amplification des basses
Bass + Treble Boost | Amplification des basses et des aigus
Vocal Boost | Amplification vocale

SETUP FOR PLAYSTATION® CONFIGURATION POUR PLAYSTATION®

1 Connect Mini Transmitter to USB Port
Connecter l'émetteur mini au port USB

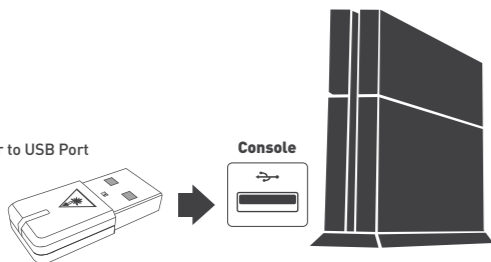

2 Power on Headset
Allumez le casque

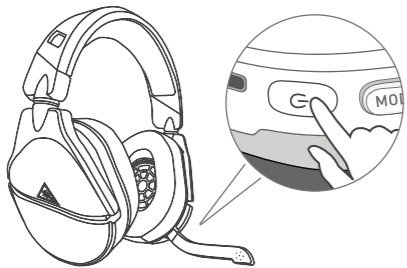

1 Go to Settings > Devices > Audio Devices

- Select Stealth™ 600 Gen 2 for Input & Output Device
- Set Output to Headphones to All Audio
- Set Volume Control (headphones) level to maximum
- Select Adjust Microphone Level and follow the on-screen instructions to calibrate your microphone

FR Allez dans Paramètres > Périphériques > Périphériques Audio

- Sélectionnez Stealth™ 600 Gen 2 comme périphérique d'entrée et de sortie
- Réglez Sortie vers le casque sur Tout audio
- Mettez le réglage du volume (casque) au maximum
- Sélectionnez Régler le niveau du microphone et suivez les instructions à l'écran pour calibrer votre microphone

ES Dirígete a Configuración > Dispositivos > Dispositivos de audio

- Selecciona Stealth™ 600 Gen 2 en la sección de Dispositivo de entrada y salida
- Selecciona Todo el sonido para la salida a los audífonos
- Ajusta el control de volumen de los audífonos en el nivel máximo
- Selecciona Ajustar el nivel del micrófono y sigue las instrucciones en pantalla para calibrar tu micrófono

IT Vai a Impostazioni > Dispositivi > Dispositivi audio

- Seleziona Stealth™ 600 di seconda generazione per dispositivi di input e output
- Imposta Output alle cuffie su Tutto l'audio
- Imposta Regolazione volume (cuffie) al livello massimo
- Seleziona Regola livello microfono e segui le istruzioni sullo schermo per calibrare il tuo microfono

SE Gå till Inställningar > Enheter > Ljudenheterparaten

- Välj Stealth™ 600 Gen 2 som enhet för indata och utdata
- Ställ in hörlurar som utdata för allt ljud
- Ställ in volymkontroll (hörlurar) till max
- Välj justering av mikrofonnivån och följ instruktionerna på skärmen för att kalibrera mikrofonen

NL Ga naar Instellingen > Apparaten > Audioapparaten

- Selecteer Stealth™ 600 Gen 2 als invoer- en uitvoerapparaat
- Stel Uitvoer naar hoofdtelefoon in op Alle audio
- Stel Volumebediening (hoofdtelefoon) in op het maximum
- Selecteer Microfoonniveau aanpassen en volg de instructies op het scherm om je microfoon te kalibreren

PT Acede a Definições > Dispositivos > Dispositivos de áudio

- Define os auscultadores Stealth™ 600 Gen 2 como dispositivo de entrada e saída
- Em Saída para auscultadores, escolhe Todo o áudio
- Define o nível de controlo do volume (auscultadores) para o máximo
- Seleciona Ajustar o nível do microfone e segue as instruções no ecrã para calibrares o teu microfone

DE Gehe zu Einstellungen > Geräte > Audio-Geräte.

- Wähle bei Ein- und Ausgabegeräte: Stealth™ 600 Gen 2 Headset.
- Stelle ein, dass alle Sounds über die Kopfhörer ausgegeben werden.
- Stelle die Lautstärkenregelung (Kopfhörer) auf die höchste Stufe.
- Wähle Mikrofonpegel anpassen und folge den Anweisungen auf dem Bildschirm, um dein Mikrofon einzustellen.

DK Gå til Indstillinger > Enheder > Lydenheder

- Vælg Stealth™ 600 Gen 2 som Inputenhed og Outputenhed
- Angiv Output til hovedtelefoner til Al lyd
- Indstil Lydstyrkekontrol (hovedtelefoner) til maksimalt niveau
- Vælg Juster mikrofonniveau, og følg instruktionerne på skærmen for at kalibrere din mikrofon.

CHARGING
CHARGEMENT

The Stealth™ 600 Gen 2 gives you **15 hours** of rechargeable battery life. Make sure to charge it regularly before storing.

Le Stealth™ 600 Gen 2 vous offre **15 heures** d'autonomie de batterie rechargeable. N'oubliez pas de le recharger régulièrement avant de le ranger.

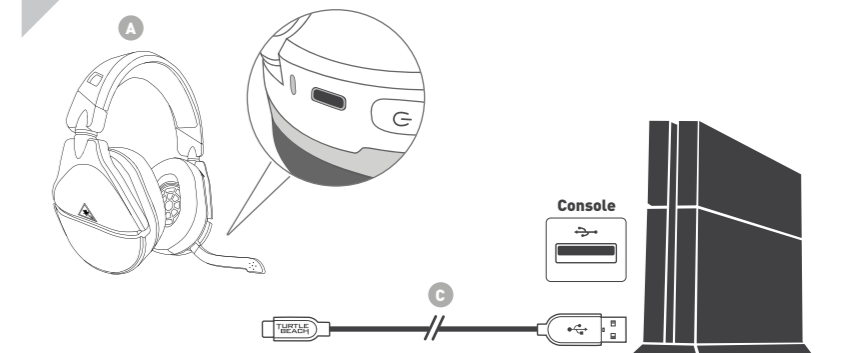

Headset Storage
Always charge your headset before storing it for any extended period of time (greater than 3 months). Never store the unit in temperatures above 113°F/45°C.

Rangement du casque:
Chargez toujours votre casque avant de le ranger pour une longue durée (plus de 3 mois). Ne stockez jamais le casque à des températures supérieures à 45°C.

LED BEHAVIORS
ÉTATS DES VOYANTS

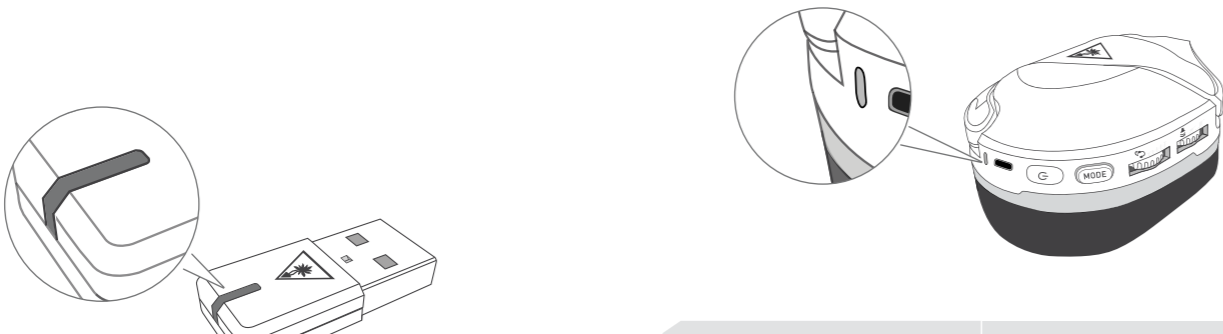

HEADSET LED VOYANT DU CASQUE	MEANING SIGNIFICATION
Solid Blue Bleu et Fixe	Headset and Mini Transmitter Paired Casque et Émetteur Mini Appariés
Breathing Blue Clignote en Bleu	[White Charging] Battery Full [En Charge] Batterie Pleinée
Double-Blink Blue Clignote Deux Fois en Bleu	Not Paired Non Apparié
Solid Red Rouge et Fixe	[White Charging] Battery Charging [En Charge] Batterie en Charge
Breathing Red Clignote en Rouge	Battery Low Batterie Faible

PAIRING
JUMLAGE

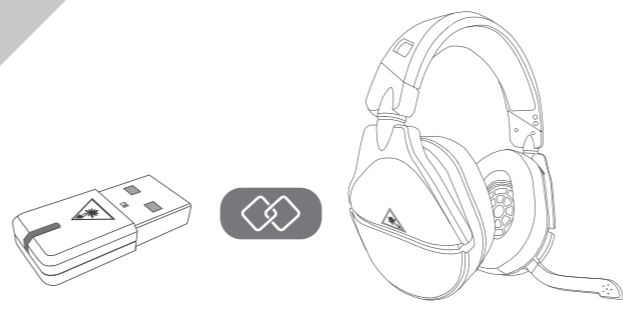

The headset and transmitter are paired out of the box, indicated by a solid LED on the transmitter. If your transmitter's LED is double-blinking, follow the steps to pair your headset and transmitter.

Le casque et l'émetteur mini devraient déjà être appariés, ce qui indique un voyant fixe sur l'émetteur. Si le voyant de votre émetteur clignote deux fois, suivez les étapes pour appairer votre casque et votre émetteur.

1 Connect your Stealth™ 600 Gen 2 for PlayStation™ Transmitter into an available USB port on your PlayStation™ 4 console. Your Transmitter will begin to double blink blue as it searches for your Headset.

2 Power on your Stealth™ 600 Gen 2 for PlayStation™ Headset and the LED will begin to double blink blue as it searches for your Transmitter.

Allumez votre casque Stealth™ 600 Gen 2 pour PlayStation® et le voyant LED commencera à clignoter deux fois en bleu, indiquant qu'il cherche votre émetteur.

3 Within 10 seconds, the Transmitter's and Headset's LED's remain solid, indicating a successful pairing.

Dans les 10 secondes qui suivent, les voyants LED de l'émetteur et du casque resteront fixes, ce qui indique qu'ils ont bien été appariés.

After 30 seconds, your transmitter will search for both the previously paired headset or any available Stealth™ 600 Gen 2 headset to pair to. Bring the two units closer together to ensure faster pairing.

Au bout de 30 secondes, votre émetteur cherchera le casque apparié précédemment ou n'importe quel casque Stealth™ 600 Gen 2 disponible avec lequel s'appairer. Approchez les deux unités pour un appariage plus rapide.

Regulatory Compliance Statements for Stealth™ 600P Gen 2 RX & TX

Local Restrictions on Radio Usage
Caution: Due to the fact that the frequencies used by wireless devices may not yet be harmonized in all countries, these radio products are designed for use only in specific countries, and are not allowed to be operated in countries other than those of designated use. As a user of these products, you are responsible for ensuring that the products are used only in the countries for which they were intended and for verifying that they are configured with the correct selection of frequency and channel for the country of use. Any deviation from the permissible power and frequency settings for the country of use is an infringement of national law and may be punished as such.

To determine whether you are allowed to use your wireless network device in a specific country, please check to see if the radio type number that is printed on the identification label of your device is listed in the manufacturer's OEM Regulatory Guidance document at the following URL: <http://www.turtlebeach.com/homologation> or contact Turtle Beach directly.

Federal Communications Commission (FCC) Compliance Notices
This section includes the following FCC statements for the Stealth™ 600P Gen 2 RX & TX:
• FCC ID: X305-TB31419RX & X305-TB31417TX • Non-Modification Statement
• Class B Interference Statement • RF Radiation Exposure & Hazard Warning

Class B Interference Statement
This equipment has been tested and found to comply with the limits for a Class B digital device, pursuant to Part 15 of the FCC Rules. The limits are designed to provide reasonable protection against harmful interference in a residential installation. This equipment generates, uses, and can radiate radio frequency energy and, if not installed and used in accordance with the instructions, may cause harmful interference to radio communications. However, there is no guarantee that interference will not occur in a particular installation. If this equipment doesn't cause harmful interference to radio/television reception, which can be diagnosed by turning the equipment off and on, the user is encouraged to try to correct the interference by one or more of the following measures:
• Reorient or relocate the receiving antenna.
• Increase the separation between the equipment and receiver.
• Connect the equipment into an outlet on a circuit different from that to which the receiver is connected.
• Consult the dealer or an experienced radio/TV technician for help.

FCC Caution
This device complies with Part 15 of the FCC Rules. Operation is subject to the following two conditions: (1) This device may not cause harmful interference, and (2) this device must accept any interference received, including interference that may cause undesired operation.

RF Radiation Exposure & Hazard Statements
To ensure compliance with FCC RF exposure requirements, this device must be installed in a location such that the antenna of the device will be greater than 2 cm (0.8 in.) from all persons. Using higher gain antennas and types of antennas not covered under the FCC certification of this product is not allowed. Installers or the radio and end users of the product must adhere to the installation instructions provided in this manual. This transmitter must not be co-located or operated in conjunction with any other antenna or transmitter.

Non-Modification Statement
Use only the supplied internal antenna. Unauthorized antennas, modifications, or attachments could damage the Stealth™ 600P Gen 2 RX & TX Models and violate FCC regulations. Any changes or modifications not expressly approved by the party responsible for compliance could void the user's authority to operate this equipment. Please contact Turtle Beach for a list of approved 2.4 GHz antennas.

This product is compliant with the Consumer Product Safety Improvement Act of 2008, Public Law 110-314 (CPSIA)

Canadian ICES Statements (IC)

3879-A-310/000 and IC: 3879-A-311/170
This device complies with ICES-003 and RSS-247 of Industry Canada. Operation is subject to the following two conditions:
1. This device may not cause interference, and
2. This device must accept any interference, including interference that may cause undesired operations of the device.

Ce dispositif est conforme aux normes NMB003 et CNB-247 d'Industrie Canada
Ce dispositif est conforme aux normes NMB003 et CNB-247 d'Industrie Canada
Ce dispositif est conforme aux normes NMB003 et CNB-247 d'Industrie Canada
1. Ce dispositif ne doit pas causer d'interférences nuisables et,
2. Il doit pouvoir accepter les interférences, incluant celles pouvant nuire à son fonctionnement normal.
To prevent radio interference to the licensed service (i.e. co-channel Mobile Satellite system) this device is intended to be operated indoors and away from windows to provide maximum shielding. Equipment for its transmit antenna that is installed outdoors is subject to licensing and not supported by Stealth™ 600P Gen 2 RX & TX Models.
Pour éviter les interférences radio au service autorisé (i.e. 3-G), les systèmes par satellite mobile co-canal, cet appareil est destiné à fonctionner à l'intérieur et à l'éloignement des fenêtres pour assurer un blindage maximal. L'équipement (ou son antenne d'émission) installé à l'extérieur est soumis à l'octroi de licences et n'est pas en charge par les modèles Stealth™ 600P Gen 2 RX & TX.

RF Radiation Exposure & Hazard Statement
To ensure compliance with FCC RF exposure requirements, this device must be installed in a location such that the antenna of the device will be greater than 2 cm (0.8 in.) away from all persons. Using higher gain antennas and types of antennas not covered under the FCC certification of this product is not allowed. Installers of the radio and end users of the product must adhere to the installation instructions provided in this manual. This transmitter must not be co-located or operated in conjunction with any other antenna or transmitter.
Exposition aux radiations RF & Mention de danger
Pour assurer la conformité avec les exigences RSS-102 d'exposition aux RF (Radio Fréquences), cet appareil doit être installé dans un endroit où l'antenne de l'appareil sera à une distance de plus de 2 cm (0,8 pou) de toutes personnes. L'utilisation d'antennes de gain plus élevée et les types d'antennes qui ne sont pas couverts en vertu de la certification IC/IC de ce produit n'est pas autorisée. Les installateurs de la radio et les utilisateurs du produit final doivent se conformer aux instructions d'installation fournies dans ce manuel. Cet émetteur ne doit pas être co-implanté ou exploité en conjonction avec toute autre antenne ou transmetteur.

European Union and European Free Trade Association Regulatory Compliance
This equipment may be operated in the countries that comprise the member countries of the European Union and the European Free Trade Association. These countries, listed below, are referred to as The European Community throughout this document: ALGERIA, BELGIUM, BULGARIA, CYPRUS, CZECH REPUBLIC, DENMARK, ESTONIA, FINLAND, FRANCE, GERMANY, GREECE, HUNGARY, IRELAND, ITALY, LATVIA, LITHUANIA, LUXEMBOURG, MALTA, NETHERLANDS, POLAND, PORTUGAL, ROMANIA, SLOVAKIA, SLOVENIA, SPAIN, SWEDEN, UNITED KINGDOM, ICELAND, LICHTENSTEIN, NORWAY, SWITZERLAND.

Declaration of Conformity
Marking this symbol indicates compliance with the Essential Requirements of the Radio Equipment Directive (RED) of the European Union (2014/53/EU).
This equipment meets the following conformance standards:
Safety:
EN 60950-1: 2006 + A11: 2009 + A1: 2010 + A12: 2011 + A2: 2013 (ET-Mark License),
IEC 60950-1: 2005 (UL 6101 + A1: 2009 + A2: 2013 IEC Scheme Certificate),
EN 62368-1: 2014 + A11 (ET-Mark License),
IEC 62368-1: 2014 IEC Scheme Certificate,
EN 60332-1: 2013, EN 60332-2: 2013, EN 71-3: 2013
Additional licenses issued for specific countries available on request.

EMC:

EN 55032: 2015, CISPR 32: 2015,
EN 55014: 2011 + A2: 1 (2017:2012), EN 55014: 2011 + A2: 1 (2014:11),
EN 61000-3-2: 2006, EN 61000-3-3: 2006 + A1: 2008 + A2: 2010,
EN 61000-4-8: 2010

The products are licensed, as required, for additional country specific standards for the International MarketPlace. Additional issued licenses available upon request.
Radio: EN 300 328 V2, 1.2 (2019-07)
SAR: EN 62311: 2008

Environmental: RoHS 2015/863 amending Annex II to 2011/65/EU, WEEE 2012/19/EU, REACH 2006/1907/EC, Packaging 94/62/EC, Battery 2006/66/EC.
WARNING: This is a Class B product. In a domestic environment, this product may cause radio interference, in which case, the user is required to take appropriate measures.

ACHTUNG: Dieses ist ein Gerät der Funkstrahlungs-Kategorie B. In Wohnbereichen können bei Betrieb dieses Gerätes Rundfunkstörungen auftreten, in welchen Fällen der Benutzer für entsprechende Gegenmaßnahmen verantwortlich ist.

ATTENTION! Ceci est un produit de Classe B. Dans un environnement domestique, ce produit risque de créer des interférences radioélectriques, il appartient alors à l'utilisateur de prendre les mesures spécifiques appropriées.

Recycling symbol: This symbol on the product or its packaging indicates that this product must not be disposed of with your other household waste. Instead, it is your responsibility to dispose of your waste equipment by handing it over to a designated collection point for the recycling of waste electrical and electronic equipment. The separate collection and recycling of your waste equipment at the time of disposal will help conserve natural resources and ensure that it is recycled in a manner that protects human health and the environment. For more information about where you can drop off your waste for recycling, please contact your local authority, or where you purchased your product.

Turtle Beach Europe Ltd is obligated as a producer with a main activity of selling under The Producer Responsibility Obligations (Packaging Waste) Regulations 2007. To fulfil our obligation we are registered with Comply Direct and their Recycling Room. Here you will find advice and information on packaging waste management, recycling symbols and the waste hierarchy principles of reduce, reuse and recycle. <https://www.complydirect.com/the-recycling-room/>

Please visit the following URL, for a complete copy of the Declaration of Conformity: <http://www.turtlebeach.com/homologation>
Mexican IPT-008 Compliance Statement
La operación de este equipo está sujeta a las siguientes condiciones: (1) es posible que este equipo o dispositivo no cause interferencia perjudicial y (2) este equipo o dispositivo debe aceptar cualquier interferencia, incluyendo la que pueda causar su operación no deseada.

To access the rating label:
Pour accéder à l'étiquette :

1. Remove the left ear pad by pulling the ear pad straight up using your thumb.

1. Retirez le coussinet gauche en le tirant vers le haut à l'aide de votre pouce.

2. Once you've released the cloth from the lip on top, pull the ear pad straight back and it should slip right off.

2. Une fois le haut du tissu délogé, tirez le coussinet vers vous pour le retirer facilement.

To replace the ear pad, follow the same process in reverse. Pour remettre le coussinet en place, veuillez suivre la procédure inverse.

Not seeing what you're looking for here?

Visit turtlebeach.com/support for the latest Tech Support information.

Vous n'avez pas trouvé ce que vous cherchiez ?

Rendez-vous sur turtlebeach.com/support pour consulter les dernières informations de l'assistance technique.