

QUICK START GUIDE
GUIDE DE DÉMARRAGE RAPIDE



STEALTH™
600
GEN 2

IMPORTANT
READ BEFORE USING
À LIRE
LIRE AVANT UTILISATION

Any questions? Des questions ?
turtlebeach.com/support
Model: Stealth™ 600 Gen 2 for Xbox

IMPORTANT
PLEASE MAKE SURE YOUR HEADSET IS UPDATED WITH THE LATEST FIRMWARE.

IMPORTANT
VEUILLEZ VOUS ASSURER QUE VOTRE CASQUE DISPOSE DE LA DERNIÈRE VERSION DU MICROLOGICIEL.

Connect to the Turtle Beach Audio Hub for Windows or Mac® to update firmware.

Connectez-vous au Turtle Beach Audio Hub pour Windows ou Mac® afin de mettre à jour le micrologiciel.

turtlebeach.com/audiohub



CONTENTS
CONTENU DE LA BOÎTE

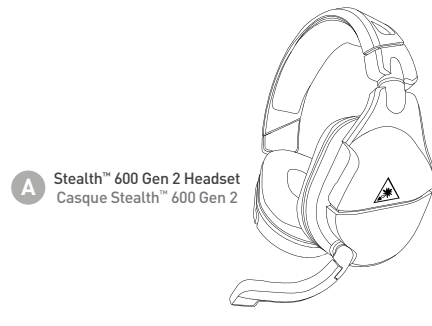

A Stealth™ 600 Gen 2 Headset
Casque Stealth™ 600 Gen 2

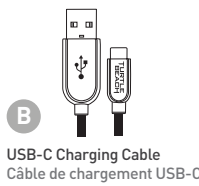

B USB-C Charging Cable
Câble de chargement USB-C

HEADSET CONTROLS
COMMANDES SUR CASQUE

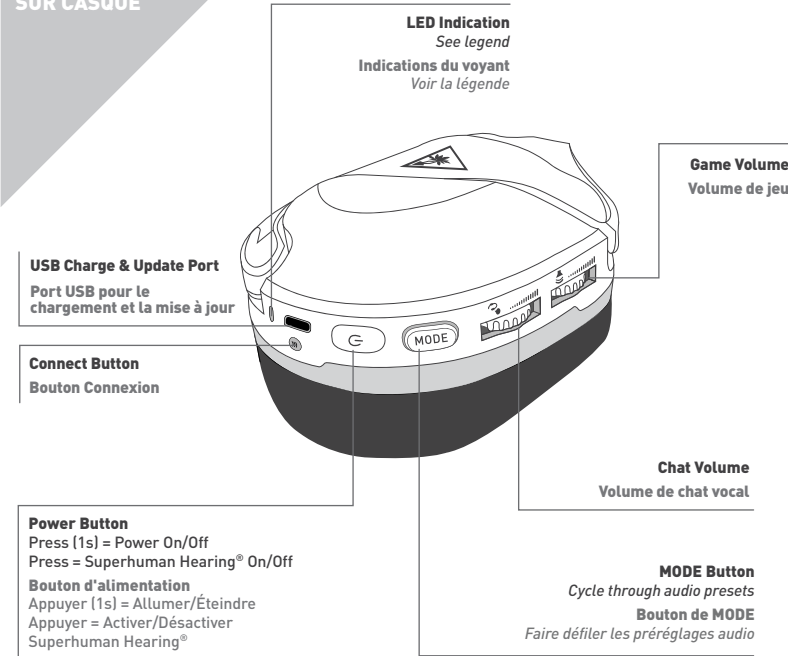

LED Indication
See legend
Indications du voyant
Voir la légende

Game Volume
Volume de jeu

Chat Volume
Volume de chat vocal

MODE Button
Cycle through audio presets
Bouton de MODE
Faire défiler les présélections audio

Power Button
Press (1s) = Power On/Off
Press = Superhuman Hearing™ On/Off
Bouton d'alimentation
Appuyer (1s) = Allumer/Éteindre
Appuyer = Activer/Désactiver Superhuman Hearing™

SUPERHUMAN HEARING™

Use Superhuman Hearing™ Mode to pinpoint quiet audio cues like enemy footsteps and weapon reloads. During gameplay, you can activate and deactivate Superhuman Hearing™ by pressing the **POWER** button once, quickly.

Le mode Superhuman Hearing™ permet d'entendre le moindre son, comme les pas d'un adversaire ou le rechargement d'une arme. Pendant le jeu, vous pouvez activer ou désactiver Superhuman Hearing™ en appuyant une fois sur le bouton d'alimentation rapidement.

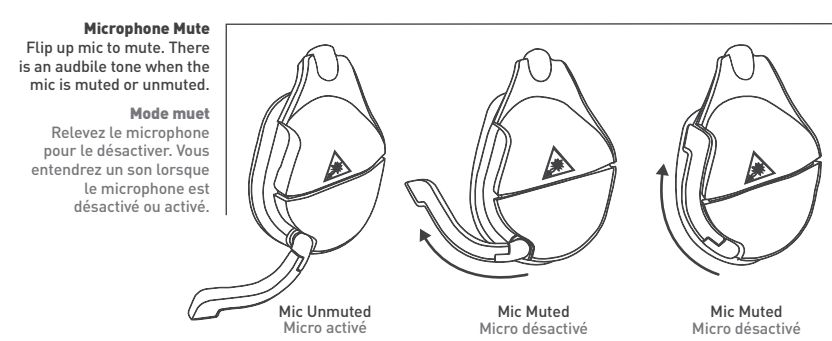

Microphone Mute
Flip up mic to mute. There is an audible tone when the mic is muted or unmuted.
Releviez le microphone pour le désactiver. Vous entendrez un son lorsque le microphone est désactivé ou activé.

Mic Muted
Micro désactivé

EQ PRESETS | PRÉSETTS D'ÉGALISATION

Signature Sound | Son emblématique

Bass Boost | Amplification des basses

Bass + Treble Boost | Amplification des basses et des aigus

Vocal Boost | Amplification vocal

SETUP FOR XBOX CONFIGURATION XBOX

For new Xbox console setup instructions, go to: turtlebeach.com/Xboxsetup

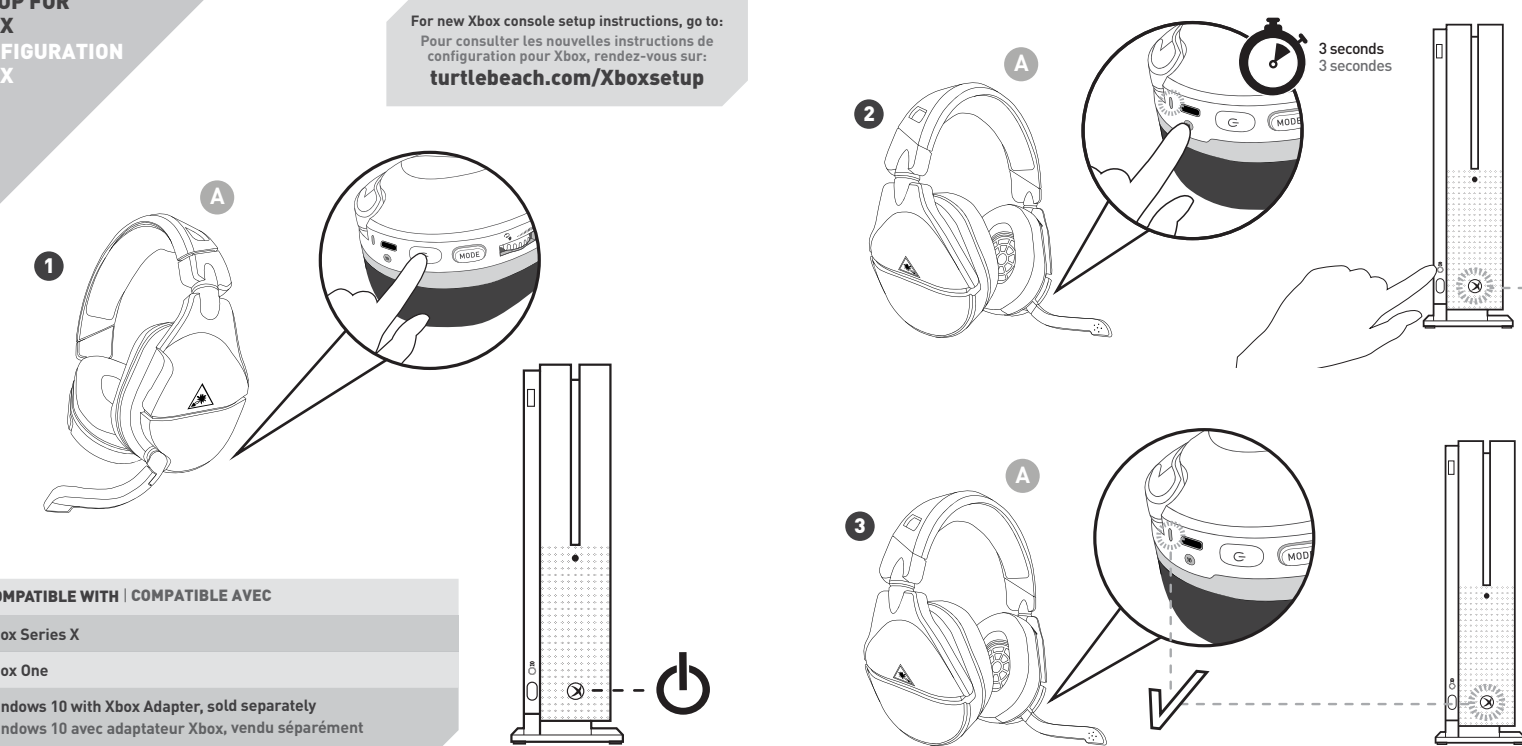

SURROUND SOUND FOR XBOX (ONLY AVAILABLE ON XBOX)
SON SURROUND POUR XBOX (DISPONIBLE UNIQUEMENT SUR XBOX ONE)

- EN 1. Go to **Settings - General - Volume & Audio Output**
- FR 1. Allez dans Paramètres - Général - Volume et sortie audio
- ES 1. Ir a Configuración - General - Salida de Volumen y sonido
- DE 1. Gehe zu Einstellungen - Allgemein - Lautstärke & Audioausgabe
- IT 1. Vai a Impostazioni - Generale - Volume e uscita audio
- PT 1. Vai a Definições - Geral - Saída de Áudio e Volume
- SE 1. Gå till Inställningar - Allmänhet - Volym och Utsändning under Headsetinställning
- DK 1. Gå til Indstillinger - Generelt - Lydstyrke og lydudgang
- NL 1. Ga naar Instellingen - Algemeen - Volume- en audio-uitvoer

For updated setup instructions visit: turtlebeach.com/sonic

CHARGING
CHARGEMENT

The Stealth™ 600 Gen 2 gives you **15 hours** of rechargeable battery life. Make sure to charge it regularly before storing.

Le Stealth™ 600 Gen 2 vous offre **15 heures** d'autonomie de batterie rechargeable. N'oubliez pas de le recharger régulièrement avant de le ranger.

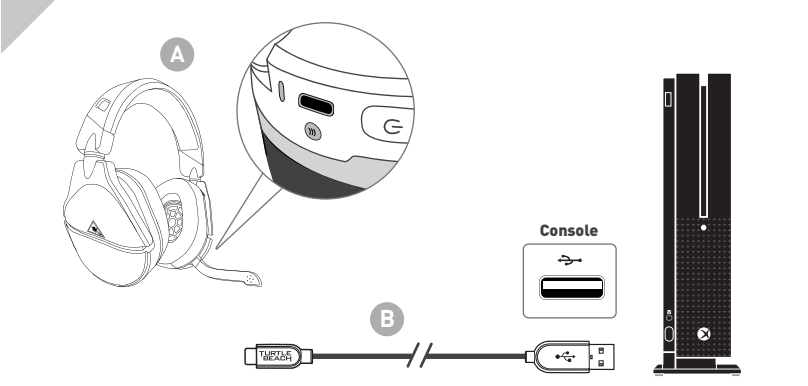

Headset Storage
Always charge your headset before storing it for any extended period of time (greater than 3 months). Never store the unit in temperatures above 113°F/45°C.

Rangement du casque:
Chargez toujours votre casque avant de le ranger pour une longue durée (plus de 3 mois). Ne stockez jamais le casque à des températures supérieures à 45°C.

HEADSET LED VOYANT DU CASQUE

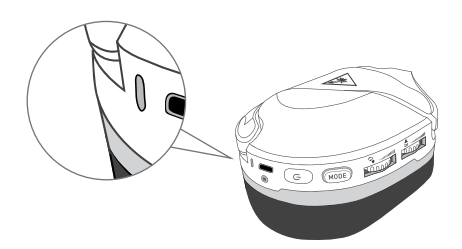

HEADSET LED	MEANING
Solid Green	Headset and Console Paired
Breathing Green	(While Charging) Battery Full
Double-Blink Green	Not Paired
Solid Red	(While Charging) Battery Charging
Breathing Red	Battery Low

FR VOYANT DU CASQUE SIGNIFICATION

Vert et Fixe	Casque et Console Appariés
Clitonne en Vert	(En Charge) Batterie Pleine
Clitonne Deux Fois en Vert	Non Apparié
Rouge et Fixe	(En Charge) Batterie en Charge
Clitonne en Rouge	Batterie Faible

SETUP FOR PC USE CONFIGURATION POUR PC

SYNCING YOUR HEADSET (XBOX WIRELESS ADAPTER)*
SYNCHRONISER LE CASQUE (ADAPTEUR SANS FIL XBOX)†

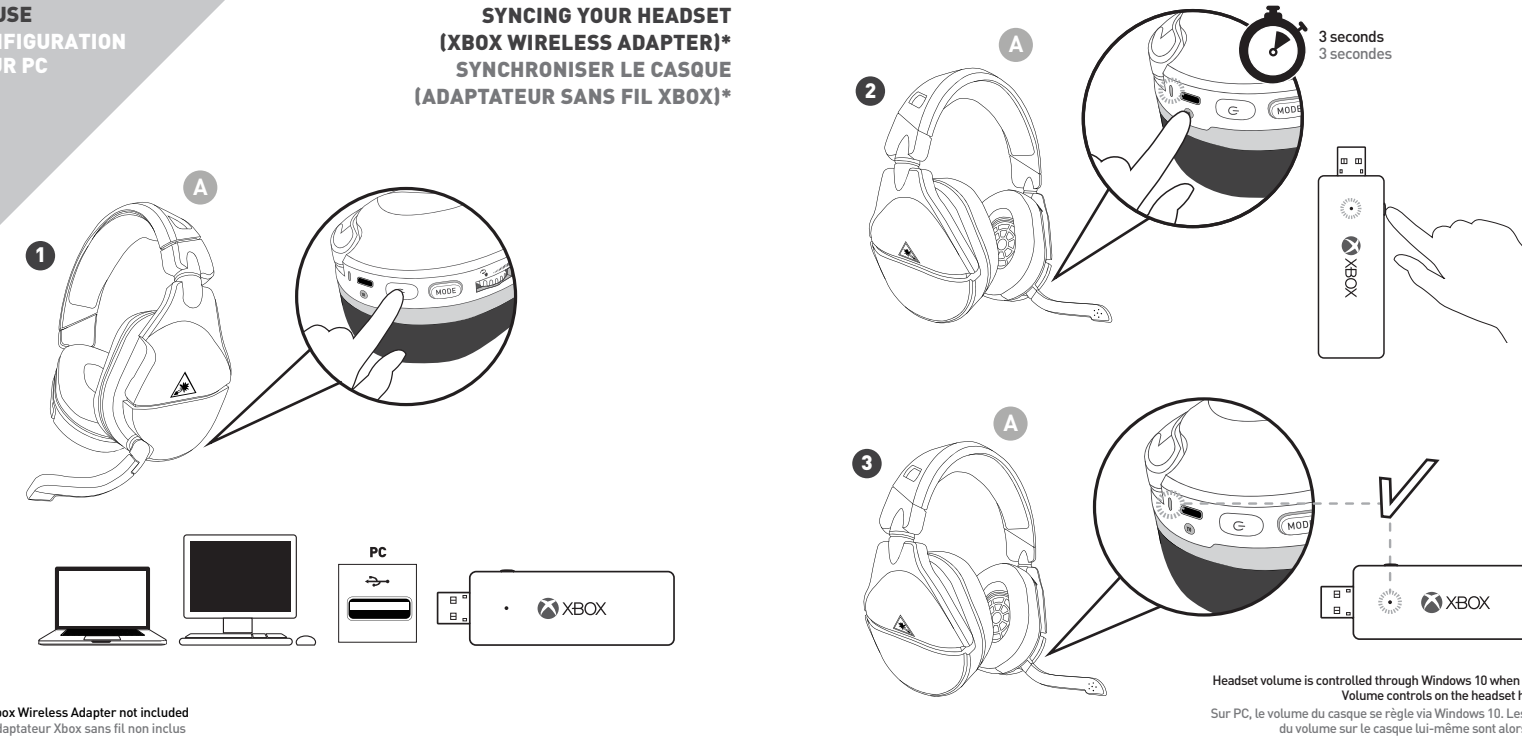

SYNCING YOUR HEADSET (BUILT-IN XBOX WIRELESS)
SYNCHRONISER LE CASQUE (TECHNOLOGIE XBOX SANS FIL INTÉGRÉE)

- EN 1. On your PC, go to **Settings - Devices - Connected Devices**.
- FR 1. Allez dans Paramètres - Périphériques - Appareils connectés.
- ES 1. En tu PC, ve a Configuración - Dispositivos - Dispositivos conectados.
- DE 1. Wählen Sie auf Ihrem PC **Einstellungen - Geräte - Angeschlossene Geräte**.
- IT 1. Sul PC, selezionare **Impostazioni - Dispositivi - Dispositivi connessi**.
- PT 1. No PC, dirija-se a **Definições - Dispositivos - Dispositivos ligados**.
- SE 1. Gå till **Inställningar - Enheter - Ljudenheter på din dator**.
- DK 1. Gå til **Indstillinger - Enheder - Tilsluttede enheder på din pc**.
- NL 1. Ga op je pc naar **Instellingen - Apparaten - Verbonden apparaten**.

Regulatory Compliance Statements for the Stealth™ 600X Gen 2

Local Restrictions on 802.11a, 802.11b, 802.11g and 802.11n Radio Usage
Caution: Due to the fact that the frequencies used by 802.11a, 802.11b, 802.11g and 802.11n wireless LAN devices may not yet be harmonized in all countries, 802.11a, 802.11b, 802.11g and 802.11n products are designed for use only in specific countries, and are not allowed to be operated in countries other than those of designated use. As a user of these products, you are responsible for ensuring that the products are used only in the countries for which they were intended and for verifying that they are configured with the correct selection of frequency and channel for the country of use. Any deviation from the permissible power and frequency settings for the country of use is an infringement of national law and may be punished as such.

To determine whether you are allowed to use your wireless network device in a specific country, please check to see if the radio type number that is printed on the identification label of your device is listed in the manufacturer's FCC Regulatory Guidance document at the following URL: <http://www.turtlebeach.com/homologation> or contact Turtle Beach directly.

Federal Communications Commission (FCC) Compliance Notices
This section includes the following FCC statements for the Stealth™ 600X Gen 2:

- FCC ID: XBR-1723215
- RF Radiation Exposure & Hazard Warning
- Class B Interference Statement
- Non-Modification Statement
- Unintended National Infrastructure Bands Operation Statement

Class B Interference Statement
This equipment has been tested and found to comply with the limits for a Class B digital device, pursuant to Part 15 of the FCC Rules. These limits are designed to provide reasonable protection against harmful interference in a residential installation. This equipment generates, uses, and can radiate radio frequency energy and, if not installed and used in accordance with the instructions, may cause harmful interference to radio communications. However, there is no guarantee that interference will not occur in a particular installation. If this equipment does cause harmful interference to radio or television reception, which can be determined by turning the equipment off and on, the user is encouraged to try to correct the interference by one or more of the following measures:

- Reorient or relocate the receiving antenna.
- Increase the separation between the equipment and receiver.
- Connect the equipment into an outlet on a circuit different from that to which the receiver is connected.
- Consult the dealer or an experienced radio/TV technician for help.

FCC Caution:
This device complies with Part 15 of the FCC Rules. Operation is subject to the following two conditions: (1) This device may not cause harmful interference, and (2) this device must accept any interference received, including interference that may cause undesired operation.

RF Radiation Exposure & Hazard Statement
To ensure compliance with FCC RF exposure requirements, this device must be installed in a location such that the antenna of the device will be greater than 2 cm (0.8 in.) away from all persons. Using higher gain antennas and types of antennas not covered under the FCC certification of this product is not allowed. Installation of the radio and end users of the product must adhere to the installation instructions provided in this manual. This transmitter must not be co-located or operated in conjunction with any other antenna or transmitter.

Non-Modification Statement
Use only the supplied internal antenna. Unauthorized antennas, modifications, or attachments could damage the Stealth™ 600X Gen 2 and violate FCC regulations. Any changes or modifications not approved by the party responsible for compliance could void the user's authority to operate this equipment. Please contact Turtle Beach for a list of approved 2.4 GHz and 5.0 GHz antennas.

Unintended National Infrastructure (U-NI) Bands Operation Statement

Within the 5.25-5.35 GHz band, U-NI devices may be restricted to indoor operations to reduce any potential for harmful interference to co-channel MS operations. The U-NI device shall accept any interference from legal communications and shall not interfere with the legal communications. If interference is caused, the user must stop operating the device immediately and cannot return operation until the harmful interference is clear. Dynamic Frequency Selection (DFS) U-NI devices operating in the 5.25-5.35 GHz and 5.47-5.725 GHz bands shall employ a DFS radar detection mechanism to detect the presence of radar systems and to avoid co-channel operation with radar systems in order to reduce the likelihood of interference to radar. The modification of wireless broadband and other transmitter devices to operate on unauthorised frequencies or the disabling of DFS capabilities is a violation of FCC rules and may result in unlawful interference to radio communications services critical to public safety. This product is compliant with the Consumer Product Safety Improvement Act of 2008, Public Law 110-314 (CPISIA).

Canadian ICES Statements (IC-3079, 2315) Stealth™ 600X Gen 2
This device complies with ICES-003 and ICES-247 of Industry Canada. Operation is subject to the following two conditions: 1. This device may not cause interference, and 2. This device must accept any interference, including interference that may cause undesired operation of the device.

Coexistence with other devices
Ce dispositif est conforme aux normes **IMB003** et **CNR-247** d'Industrie Canada.

1. L'utilisation de ce dispositif est autorisée seulement aux conditions suivantes:
2. Il ne doit pas produire de brouillage et l'utilisateur du dispositif doit être prêt à accepter tout brouillage radioélectrique reçu, même si ce brouillage est susceptible de compromettre le fonctionnement du dispositif.

To prevent radio interference to the licensed service (i.e. co-channel Mobile Satellite system) this device is intended to be operated indoors and away from windows to provide maximum shielding. Equipment for its external use is intended to be operated outdoors and not near windows to provide maximum shielding. Equipment for its external use is intended to be operated outdoors and not near windows to provide maximum shielding. Equipment for its external use is intended to be operated outdoors and not near windows to provide maximum shielding.

RF Radiation Exposure & Hazard Statement
To ensure compliance with RF exposure requirements, this device must be installed in a location such that the antenna of the device will be greater than 2 cm (0.8 in.) away from all persons. Using higher gain antennas and types of antennas not covered under the IC certification of this product is not allowed. Installers of the radio and end users of the product must adhere to the installation instructions provided in this manual. This transmitter must not be co-located or operated in conjunction with any other antenna or transmitter.

European Union and European Free Trade Association Regulatory Compliance
This equipment may be operated in the following countries: AUSTRIA, BELGIUM, BULGARIA, CYPRUS, CZECH REPUBLIC, DENMARK, ESTONIA, FINLAND, FRANCE, GERMANY, GREECE, HUNGARY, IRELAND, ITALY, LITHUANIA, LUXEMBOURG, MALTA, NETHERLAND, POLAND, PORTUGAL, ROMANIA, SLOVAKIA, SLOVENIA, SPAIN, SWEDEN, UNITED KINGDOM, ICELAND, LIECHTENSTEIN, NORWAY, SWITZERLAND.

Declaration of Conformity
This equipment complies with the Essential Requirements of the Radio Equipment Directive (RED) of the European Union (2014/53/EU). This equipment meets the following conformity assessment procedures:
Safety: EN 60950-1:2005 + A11:2009 + A1:2010 + A12:2011 + A2:2013 IT-Mark (Lloyd's), IEC 60950-1:2005 (2nd Ed.) + Am. 1:2009 + Am. 2:2013 (CB Scheme Certificate), EN 62368-1:2014 + A11 IT-Mark (Lloyd's), IEC 62368-1:2014 (CB Scheme Certificate), EN 60335-1:2013, EN 60335-2:2013, EN 3, 2013
Additional licenses issued for specific countries available upon request
EMC: EN 55022:2010, CISPR 32:2010, EN 14989:1:2011, EN 15017:2010, EN 301 489-17 v1.1.1, EN 15014-1-1, EN 41000-4-2:2009, EN 41000-4-3:2006 + A1:2008 + A2:2010, EN 41000-4-6:2010
The products are licensed, as required, for additional country specific standards for the International Marketplace. Additional issued licenses available upon request.
RoHS: EN 300 320 v2.1, EN 12015:01, EN 61010 v2.1, EN 12017:01
SAR: EN 62311:2009
Environment: EN 50528:2013, EN 50528:2013 amendment Annex 1 to 2011/626/EU, WEEE 2012/19/EC, REACH 2006/1819/EC, Packaging 1442/EC, Battery 2006/46/EC, RoHS 2002/95/EC, Toy Safety Directive 2009/48/EC
Warning! This is a Class B product. In a domestic environment, this product may cause radio interference, in which case, the user may be required to take appropriate measures.
Achtung! Dieses ist ein Gerät der Funkstörgruppenklasse B. In Wohnbereichen können bei Betrieb dieses Gerätes Rundfunkstörungen auftreten. In diesem Fall sind Benutzer für entsprechende Gegenmaßnahmen verantwortlich.
Attention! Ceci est un produit de Classe B. Dans un environnement domestique, ce produit risque de créer des interférences radioélectriques. Il appartient alors à l'utilisateur de prendre les mesures préventives appropriées.

National Restrictions

Indoor Operation
The Stealth™ 600X Gen 2 operates in the 5150 to 5350 MHz frequency band and is restricted to indoor use only!
Antenna
The Stealth™ 600X Gen 2 has integrated antennas which cannot be replaced.
Power Level Control
The Stealth™ 600X Gen 2 does not allow for customized power level control.
Operating Frequency
The operating frequency of the Stealth™ 600X Gen 2 is determined by the host console system. As such, it is important that the host console system is correctly configured to meet the local regulations.

This symbol on the product or its packaging indicates that this product must not be disposed of with your other household waste. It must be sent to a designated collection point for the recycling of waste electrical and electronic equipment. The separate collection and recycling of this product will help conserve natural resources and ensure that it is recycled in a manner that protects human health and the environment. For more information about where you can drop-off your waste for recycling, please contact your local authorities, or where you purchased your product.
<https://www.cyclepoint.com/the-recycling-queen/>

Please visit the following URL for a complete copy of the Declaration of Conformity: <http://www.turtlebeach.com/homologation>

Mexican IFT-006 Compliance Statement
"La operación de este equipo está sujeta a las siguientes dos condiciones: (1) Es posible que este equipo o dispositivo no cause interferencia perjudicial y (2) este equipo o dispositivo debe aceptar cualquier interferencia, incluyendo la que provenga de equipos no deseados."

To access the rating label: Pour accéder à l'étiquette :



To replace the ear pad, follow the same process in reverse. Pour remettre le coussinet en place, suivre la procédure inverse.

Not seeing what you're looking for here? Visit turtlebeach.com/support for the latest Tech Support information.

Vous n'avez pas trouvé ce que vous cherchiez ? Rendez-vous sur turtlebeach.com/support pour consulter les dernières informations de l'assistance technique.