

## Xiaomi Smart Camera C200 User Manual





Read this manual carefully before use, and retain it for future reference.

## Product Overview

---

The nameplate is marked on the bottom of the camera.

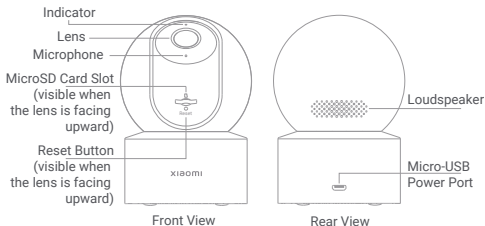

Note: Illustrations of product, accessories, and user interface in the user manual are for reference purposes only. Actual product and functions may vary due to product enhancements.

Package Contents: Xiaomi Smart Camera C200, charging cable, wall mounting kit (base, wall plug × 2, screw × 2), user manual, warranty notice



## How to Install

---

The camera can be placed on flat surfaces, such as desks, dining tables, and coffee tables. It can also be mounted on a wall.

### Mounting the Camera on a Wall :

1. First use a pencil to mark the positions for the base mounting holes on the wall, then drill two holes at the marked positions. The diameter of each hole is approximately 6 mm, and the depth is approximately 30 mm.
2. Insert the plastic wall plugs into the drilled holes.
3. Place the side of the base with arrows facing forward, and then align the holes. Insert the screws and then tighten them into the wall plugs with a Phillips head screwdriver.
4. Align the grooves on the bottom of the camera with the raised part on the base, and then turn it clockwise until it locks into place.

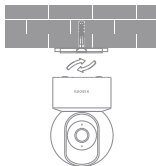
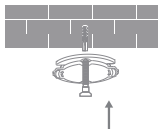



### Precaution for Mounting the Camera on a Wall

The wall must be able to support at least three times the total weight of the camera.

### WARNING

To prevent possible injury, the camera must be securely fixed to the ceiling or wall according to the installation instructions.

## How to Use

---

### • Installing a MicroSD Card

Make sure the camera is unplugged. Adjust the lens upward until the microSD slot is revealed, then insert the microSD card into the slot (the side with contact points must be facing down).

**Note:** Unplug the camera when installing or removing the microSD card. Please use a genuine microSD card manufactured by a qualified supplier (The microSD card needs to be purchased separately and the maximum supported capacity is 256 GB). It is recommended that the microSD card has a read/write speed of no less than U1/Class 10.



- **Turning On**

Plug the charging cable into the Micro-USB port on the back of the camera, the camera automatically turns on, and the indicator quickly blinks orange.

**Note:** When the camera is working, do not turn the lens of the camera nor force it to rotate. If the positioning of the lens is inaccurate, please calibrate it in the Mi Home/Xiaomi Home app.

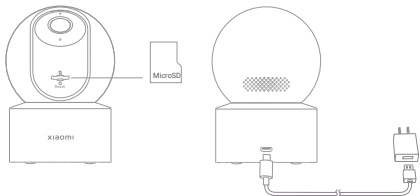

- **Indicator**

Blue light on: Connected successfully/Working normally

Blinking blue: Network error

Blinking orange rapidly: To be connected

Blinking orange slowly: Updating

**Note:**

Please use a power adapter with 5 V/2 A output from a qualified manufacturer.



## Connecting with the Mi Home/Xiaomi Home App

---

This product works with the Mi Home/Xiaomi Home app\*. Control your device with Mi Home/Xiaomi Home app.

Scan the QR code to download and install the app. You will be directed to the connection setup page if the app is installed already. Or search for "Mi Home/Xiaomi Home" in the app store to download and install it.

Open the Mi Home/Xiaomi Home app, tap "+" on the upper right, and then follow the instructions to add your device.

\* The app is referred to as Xiaomi Home app in Europe (except for Russia). The name of the app displayed on your device should be taken as the default.



2CCD476E

**Note:** The version of the app might have been updated, please follow the instructions based on the current app version. Make sure the camera turns on and the network connection is stable during connecting. The indicator is blinking orange rapidly when waiting for a connection, and turns into blue once the camera is successfully connected.

- **Restoring Factory Settings**

In case the network the camera is connected to, or the Xiaomi Account the camera is paired with has to be changed, use a pin to press and hold the reset button for about five seconds to restore factory settings. Then reconnect the network and the Mi Home/Xiaomi Home app with the camera.

**Note:** Restoring factory settings will not delete the content on the microSD card.



## Real-time Surveillance

---

In the camera's plugin of the Mi Home/Xiaomi Home app, you can view the real-time surveillance screen, adjust the sharpness of the image, adjust the horizontal angle of the camera, capture and record the screen, and make remote calls.

## Infrared Night Vision

---

The camera can automatically switch to night vision mode at night according to the change in ambient light. With built-in infrared night vision lights, the camera can clearly capture images/videos in the dark.

## Playback

---

- The playback feature of the camera is only available when a compatible microSD card is installed.
- The camera will automatically start recording video once a microSD card is installed and the camera is turned on. In the camera's plugin in the Mi Home/Xiaomi Home app, tap the playback button to enter the playback interface, then drag the timeline to select the time period to be played back. The maximum supported playback speed is 16x.



## Automatic Surveillance

---

- When the home surveillance assistant is enabled, the camera will record videos if it detects human movement and changes in real-time within its monitored area. Then you will receive notifications on the app.
- You can enable or disable the function of home surveillance assistant in the camera's plugin in the Mi Home/Xiaomi Home app.
- You can set surveillance of all-day, daytime, nighttime, or any other time meeting your demands. Alert sensitivity and alert time intervals can also be customized in the app.



## Video Sharing

---

In the camera's plugin in the Mi Home/Xiaomi Home app, you can select the device sharing option in the settings menu to share the camera with others. The person the camera is shared with needs to download the Mi Home/Xiaomi Home app and sign in with a Xiaomi Account.



## Specifications

---

Name: Xiaomi Smart Camera C200

Model: MJSXJ14CM

Input: 5 V  $\pm$  2 A

Aperture: F2.1

Item Dimensions: 109 × 75 × 75 mm

Operating Temperature: -10°C to 40°C

Wireless Connectivity: Wi-Fi IEEE 802.11 b/g/n 2.4 GHz

Storage: MicroSD card (up to 256 GB)

Resolution: 1080p

Net Weight: Approx. 256 g

Video Codec: H.265

## Cautions

---

- The operating temperature range for this camera is between -10°C and 40°C. Do not use the camera in environments with temperatures above or below the specified range.
- The camera is a precision electronic product. In order to ensure its normal operation, do not install the camera in environments with high humidity levels nor allow water to get into it.
- To improve the camera's performance, do not place its lens facing or next to a reflective surface, such as glass windows or white walls, as this will cause the image to appear overly bright in areas close to the camera and darker in areas further away, or cause the camera to produce white images.
- Make sure the camera is installed in an area with a strong Wi-Fi signal. Do not place the camera near the objects that may affect its Wi-Fi signal, such as metal objects and microwave ovens.
- Under normal use of condition, this equipment should be kept a separation distance of at least 20 cm between the antenna and the body of the user.



## WEEE Information

---



All products bearing this symbol are waste electrical and electronic equipment (WEEE as in directive 2012/19/EU) which should not be mixed with unsorted household waste. Instead, you should protect human health and the environment by handing over your waste equipment to a designated collection point for the recycling of waste electrical and electronic equipment, appointed by the government or local authorities. Correct disposal and recycling will help prevent potential negative consequences to the environment and human health. Please contact the installer or local authorities for more information about the location as well as terms and conditions of such collection points.

## EU Declaration of Conformity

---



Hereby, Shanghai Imilab Technology Co., Ltd. declares that the radio equipment type Xiaomi Smart Camera C200 is in compliance with Directive 2014/53/EU. The full text of the EU declaration of conformity is available at the following internet address: <http://www.mi.com/global/service/support/declaration.html>



## UK Declaration of Conformity

---

**UK** Hereby, Shanghai Imilab Technology Co., Ltd. declares that the  
**CA** radio equipment type Xiaomi Smart Camera C200 is in  
compliance with Radio Equipment Regulations 2017. The full  
text of the UK declaration of conformity is available at the following  
internet address:

<https://www.mi.com/uk/service/support/declaration.html>

Importer:

Beryko s.r.o.

Pod Vinicemi 931/2, 301 00 Plzeň

[www.beryko.cz](http://www.beryko.cz)

Manufactured for: Xiaomi Communications Co., Ltd.

Manufactured by: Shanghai Imilab Technology Co., Ltd.

(a Mi Ecosystem company)

Address: Room 001A, Floor 11, Block 1, No. 588 Zixing Road, Minhang

District, Shanghai, China

For further information, please go to [www.mi.com](http://www.mi.com)

User Manual Version: V1.0